

STATE DEPARTMENT OF HIGHWAYS DIVISION OF HIGHWAYS—STATE OF COLORADO

FEDERAL ROAD REGION NO	DIVISION	PROJECT NO	SHEET NO
XIII	COLORADO	BR F 050-5(7) & RF 050-5(8)	1
RIGHT OF WAY EAST OF GRANADA			REVISIONS

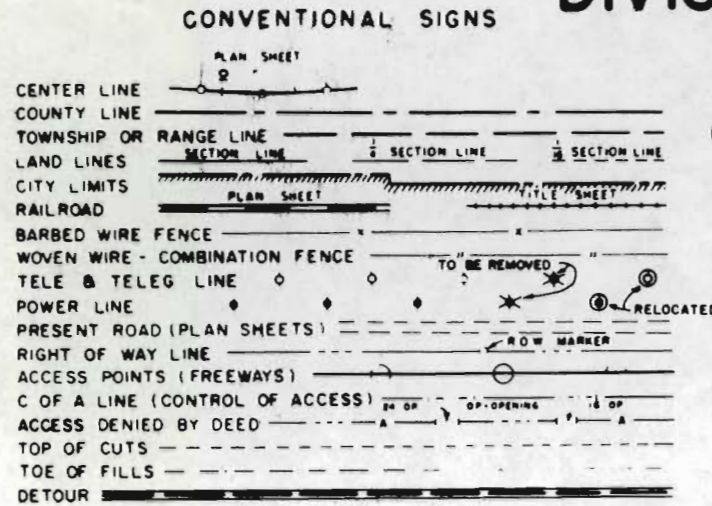

PLAN AND PROFILE OF PROPOSED
COMB. FEDERAL AID PROJECT NOS. BR F 050-5(7) & RF 050-5(8)
STATE HIGHWAY NO. 50
PROWERS COUNTY
RIGHT OF WAY

SHEET NO.
1
2
3

INDEX OF SHEETS
TITLE SHEET
TABULATION OF PROPERTIES SHEET
LINE SHEET

SCALE OF ORIGINAL DRAWINGS
PLAN SHEETS 1" = 100'
DETAIL SHEETS 1" =
OWNERSHIP MAPS 1" =

R.O.W. LENGTH OF PROJECT = 1,730'

STA. 275+50 BEGIN R.O.W. BR F 050-5(7) AND RF 050-5(8) COMBINED

STA 267+00 BEGIN CONST.
BR F 050-5(7) and RF 050-5(8)

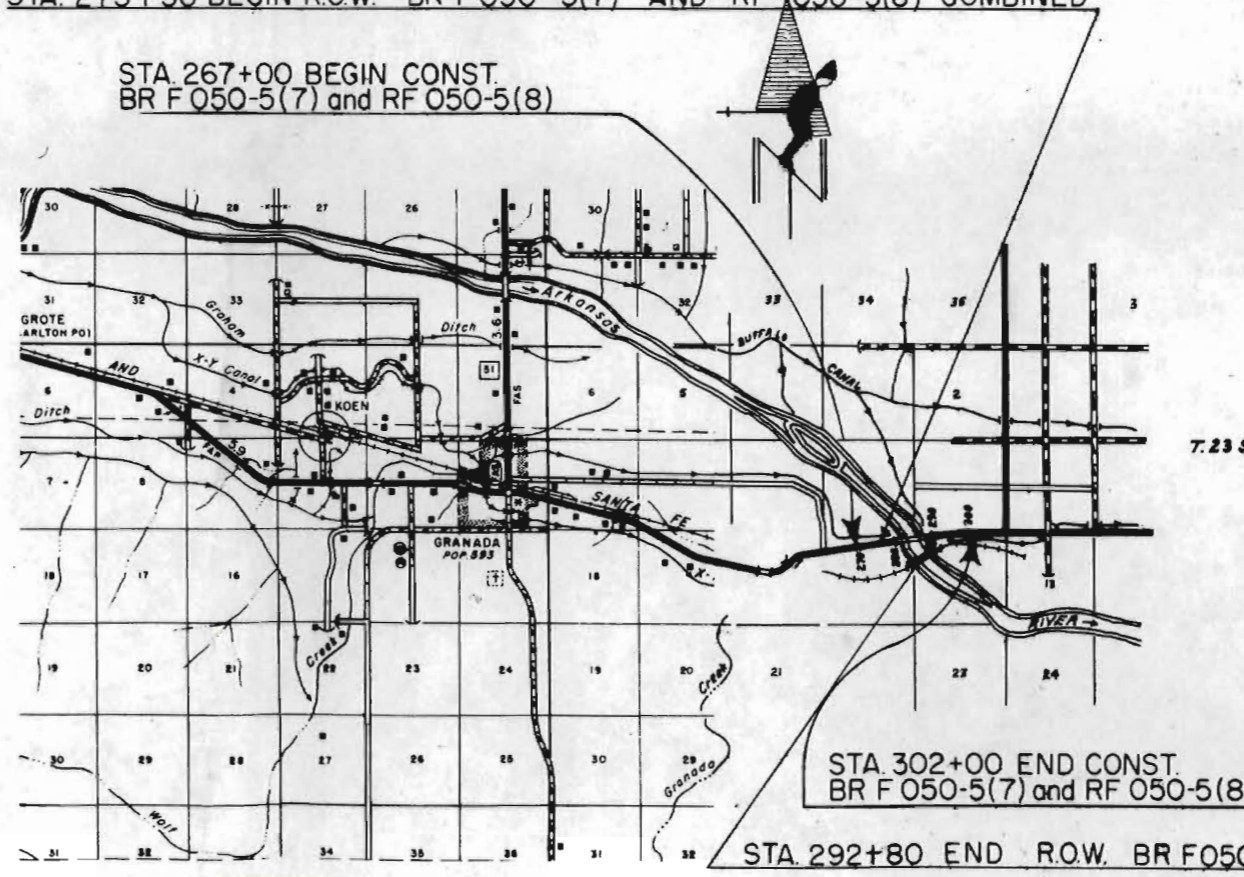

STA 302+00 END CONST.
BR F 050-5(7) and RF 050-5(8)

STA 292+80 END R.O.W. BR F 050-5(7) & RF 050-5(8) COMBINED

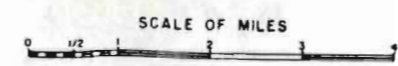

FILE COPY
DO NOT REMOVE

FEDERAL ROAD REGION NO.	DIVISION	PROJECT NO.	SHEET NO.
VIII	COLORADO	BR F050-5(7) RF 050-5(8)	3
RIGHT OF WAY EAST OF GRANADA			REVISIONS

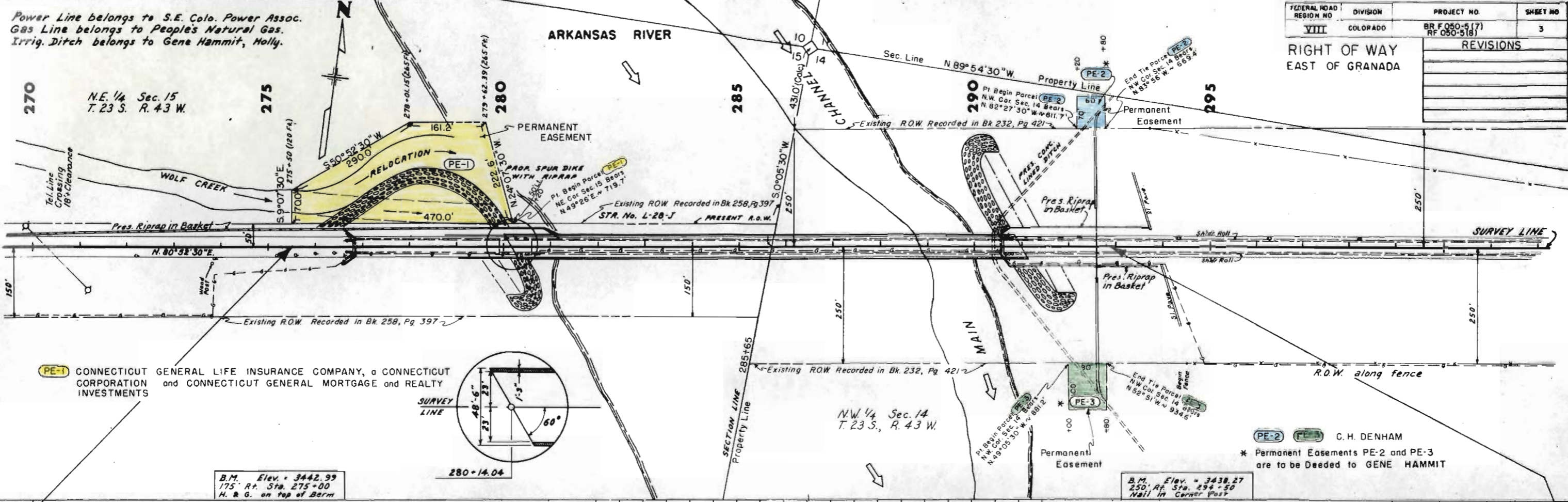

STA. 275+50 BEGIN R.O.W. BR F050-5(7) AND RF 050-5(8) COMBINED

STA. 292+80 END ROW BR F050-5(7) & RF 050-5(8) COMBINED

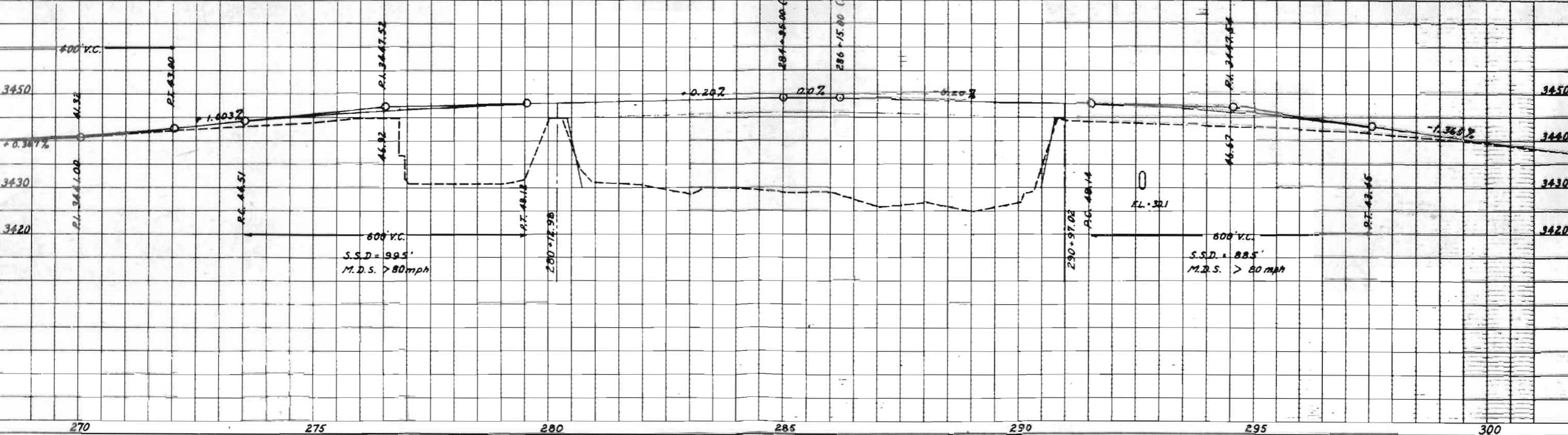

PLAN SURVEYED BY DATE
 NOTE: ALL DIMENSIONS ARE IN FEET UNLESS OTHERWISE SPECIFIED
 NO. 1

PROFILE SURVEYED BY DATE
 NOTE: ALL DIMENSIONS ARE IN FEET UNLESS OTHERWISE SPECIFIED
 NO. 1