



Region 3
222 South 6th Street Room 317
Grand Junction, Colorado 81501
Phone: (970) 248-7232 FAX: (970) 248-7233

Right of Way Plans Unit:Leslie E. Doehling

Sheet Revisions

Sheet Revisions

Sheet Revisions

Right of Way Plans

TITLE SHEET

Project Number:BR 0132-016

Project Location:Smith Fork Bridge

Project Location:E. of Crawford

Project Code:	Last Mod. Date	Subset Sheets	Sheet No.	Total No. of Sheets
15109	4/12/06		1	4

Smith Fork Bridge
E. of Crawford

CONVENTIONAL SIGNS

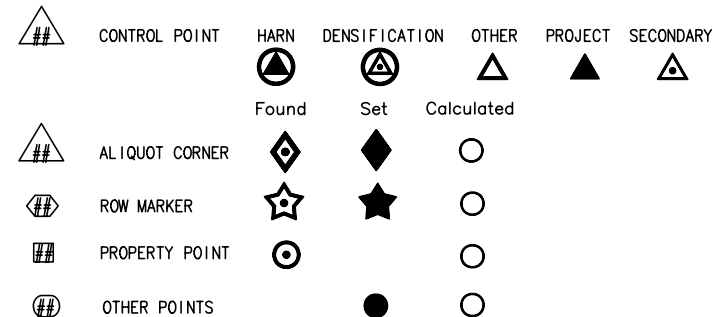
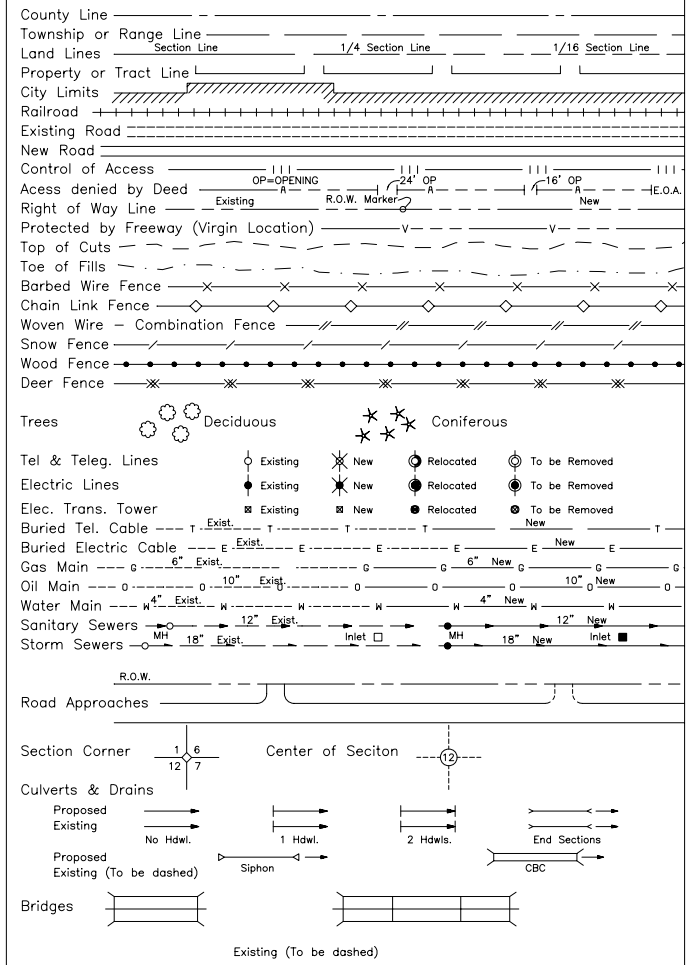

DEPARTMENT OF TRANSPORTATION
STATE OF COLORADO

RIGHT OF WAY PLAN OF PROPOSED
FEDERAL AID PROJECT NO. BR 092A-019
STATE HIGHWAY NO. 92

DELTA COUNTY
T. 15 S., R. 91 W., 6TH P.M.

SCALES OF ORIGINAL DRAWINGS

Plan Sheets 1"=100'

Ownership Sheets 1"=400'

R.O.W. Length of Project: 1933.34' (0.36 miles)

6th P.M.

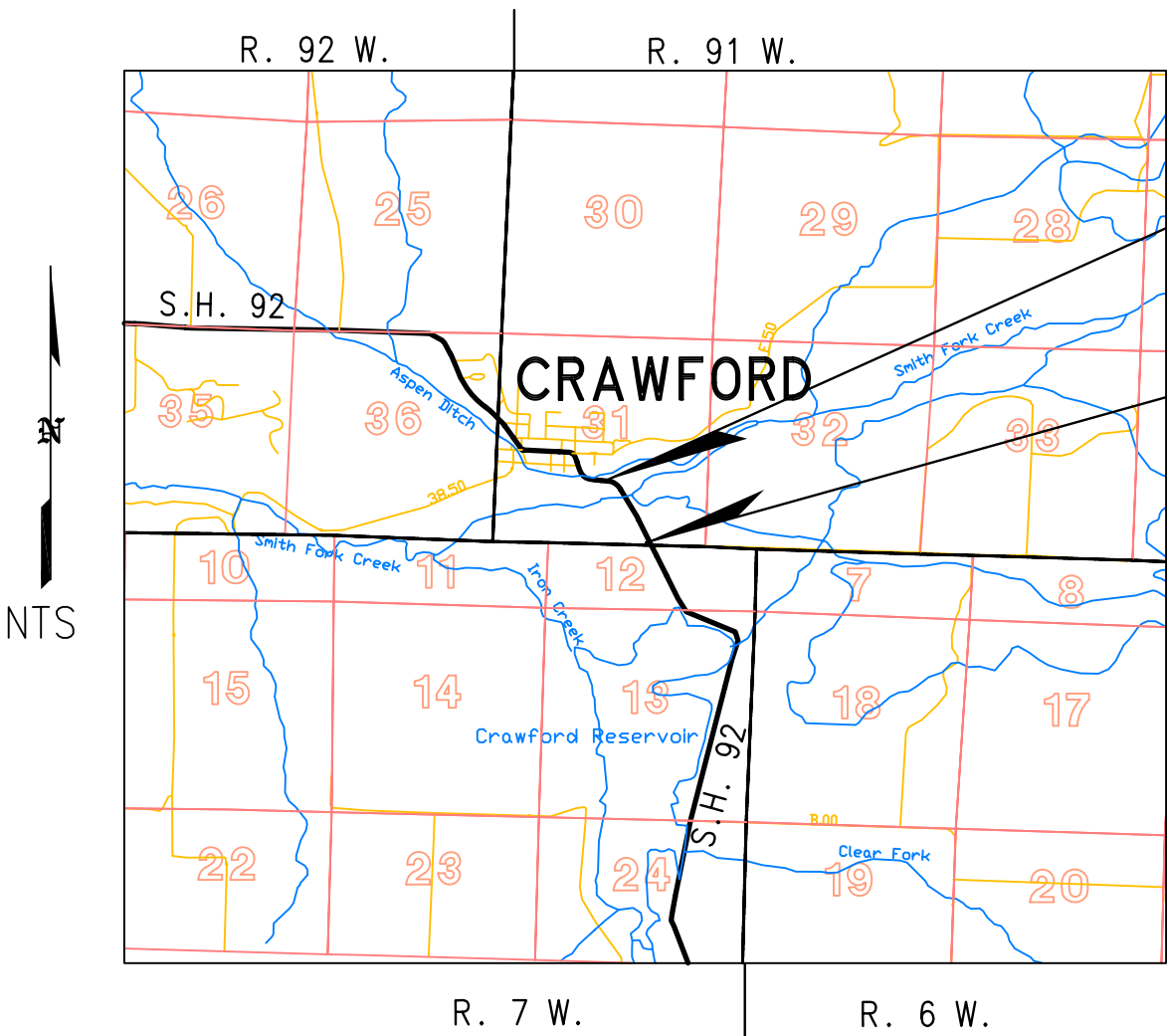

Begin R.O.W. proj. BR 092A-019, Sta. 12+06.57 =
Sta. 12+06.57 on proj. NRS 379 = M.P. 31.76

End R.O.W. proj. BR 092A-019, Sta. 31+39.91=
Sta. 31+39.91 on proj. S 0125(8) = M.P. 32.12

(6th P.M.)
T. 15 S.
T. 51 N.
(N.M.P.M.)

FILING CERTIFICATION: DEPOSITED THIS ____ DAY OF ____, 19__, AT ____, M., FOR INFORMATION
ONLY IN BOOK ____ OF THE COUNTY LAND SURVEYS/RIGHT OF WAY
SURVEYS AT PAGE ____, RECEPTION NUMBER ____
SIGNED _____
DEPT. _____

FILING CERTIFICATION: DEPOSITED THIS ____ DAY OF ____ AT ____ M., FOR INFORMATION ONLY IN BOOK ____ OF THE COUNTY LAND SURVEYS/RIGHT OF WAY SURVEYS AT PAGE ____ RECEPTION NUMBER ____

SIGNED _____ DEPT. _____



Region 3

222 South 6th Street Room 317

Grand Junction, Colorado 81501

Phone: (970) 248-7232 FAX: (970) 248-7233

Right of Way Plans Unit:Leslie E. Doehling

Sheet Revisions			Sheet Revisions			Sheet Revisions			Right of Way Plans				
									PROJECT CONTROL DIAGRAM				
									Project Number:BR 092A-019				
									Project Location:Smith Fork Bridge – SH 92				
									Project Location:DELTA COUNTY				
									Project Code:	Last Mod. Date	Subset Sheets	Sheet No.	Total No. of Sheets
									15109	02/06/2006	2 to 2B	2	4

COLORADO DEPARTMENT OF TRANSPORTATION

PROJECT CONTROL DIAGRAM

SMITH FORK BRIDGE – S.H. 92

Section 31

T. 15 S., R 91 W., 6th P.M.

DELTA COUNTY

DELTA COUNTY
MP 31.70 – MP 31.95

Construction Surveying and Monumentation Requirements

1. This Project Control Diagram represents the horizontal and vertical control for the project established by the Division. It is possible that some of the survey control monuments listed have been disturbed or obliterated. It is the Contractor's responsibility to verify the existence and stability of the control monuments before submitting a bid price.
2. All Type 1 and Type 2 monuments shall be set flush with the ground. Witness posts shall be installed 1 foot from and facing all Type 1 and Type 2 monuments, or as directed by the Project Engineer.
3. Installation of Type 3 and Type 3-A monuments shall be completed in the same day that installation is commenced. Under no circumstances shall holes in the roadway be left open overnight.
4. When installing Type 3-A monuments, the aluminum monument box shall be positively secured in the roadway surface. The monument box shall be caulked with asphalt caulking between the monument box and the edges of the roadway surface to provide a positive moisture barrier around the monument box.

5. Control survey procedures, statistical analysis, and accuracy obtained for horizontal and vertical control shall be documented in the field book.
6. Legible copies of the field books shall be submitted to the Project Engineer for review on a monthly basis.
7. It is ultimately the prime Contractors responsibility to insure that these requirements, as well as any contained in the CDOT specifications, project special provisions, and CDOT Survey Manual are fulfilled under this contract.
8. The minimum staking intervals for each item are described on the plans or in the CDOT Survey Manual. If the contractor wishes to reduce the minimum intervals, a Contract Modification Order must be negotiated and the cost of the item reduced accordingly
9. Whenever the contract includes the setting of CDOT Type 2 monuments, a Project Control Diagram, signed and sealed by the P.L.S. in responsible charge, shall be submitted to the Project Engineer. An AutoCad drawing on CD shall accompany the hard copy.

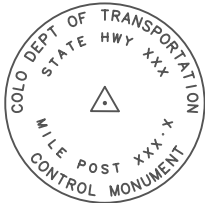

CDOT CONTROL MONUMENT
A 3.25" DIA. ALUMINUM CAP
ON A 3/4" DIA. ALUMINUM ROD

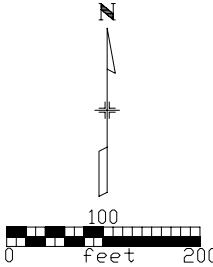

LEGEND
▲ – SET CDOT TYPE 2 CONTROL MONUMENT

Project Latitude 38°42'05.63"N
Project Longitude107°36'15.30"W
Project Elevation 1967.208m
Zone Colorado Colorado Central
Scale Factor 0.9999600666
Combined Factor 0.9996514473
Northing Reduction 380000
Easting Reduction 700000
Units are METERS.
Note: Project Coordinates=(SPC/Combined Factor)- Reduction

POINT	LATITUDE	LONGITUDE	S.P. NORTH	S.P. EAST	HEIGHT	ELEVATION	FLATTENING	SCALE FACTOR
3180	38°42'05.63403"N	107°36'15.29614"W	403300.273	731378.736	1951.547	1967.208	–1°19' 37.66015"	0.999960067
3190	38°42'01.14796"N	107°36'10.68910"W	403159.406	731486.823	1946.758	1962.410	–1°19' 34.75454"	0.999960217
3185	38°42'02.84231"N	107°36'12.80335"W	403212.819	731436.960	1946.890	1962.547	–1°19' 36.08797"	0.999960160
3195	38°41'57.68541"N	107°36'09.25449"W	403051.865	731519.008	1954.902	1970.548	–1°19' 33.84975"	0.999960334
3170	38°42'05.76227"N	107°36'21.20043"W	403307.532	731236.203	1957.376	1973.041	–1°19' 41.38393"	0.999960062

PROJECT COORDINATES(METERS):				
PNT No.	NORTHING	EASTING	ELEVATION	REMARKS
3170	23448.1546	31491.1662	1973.041	MP 31.70
3180	23440.8934	31633.7494	1967.208	MP 31.80
3185	23353.4090	31691.9930	1962.547	MP 31.85
3190	23299.9768	31741.8739	1962.410	MP 31.90
3195	23192.3985	31774.0697	1970.548	MP 31.95

PROJECT COORDINATES(FEET):				
PNT No.	NORTHING	EASTING	ELEVATION	REMARKS
3170	76929.49	103317.27	6473.21	MP 31.70
3180	76905.66	103785.06	6454.08	MP 31.80
3185	76618.64	103976.15	6438.79	MP 31.85
3190	76443.34	104139.80	6438.34	MP 31.90
3195	76090.39	104245.43	6465.04	MP 31.95

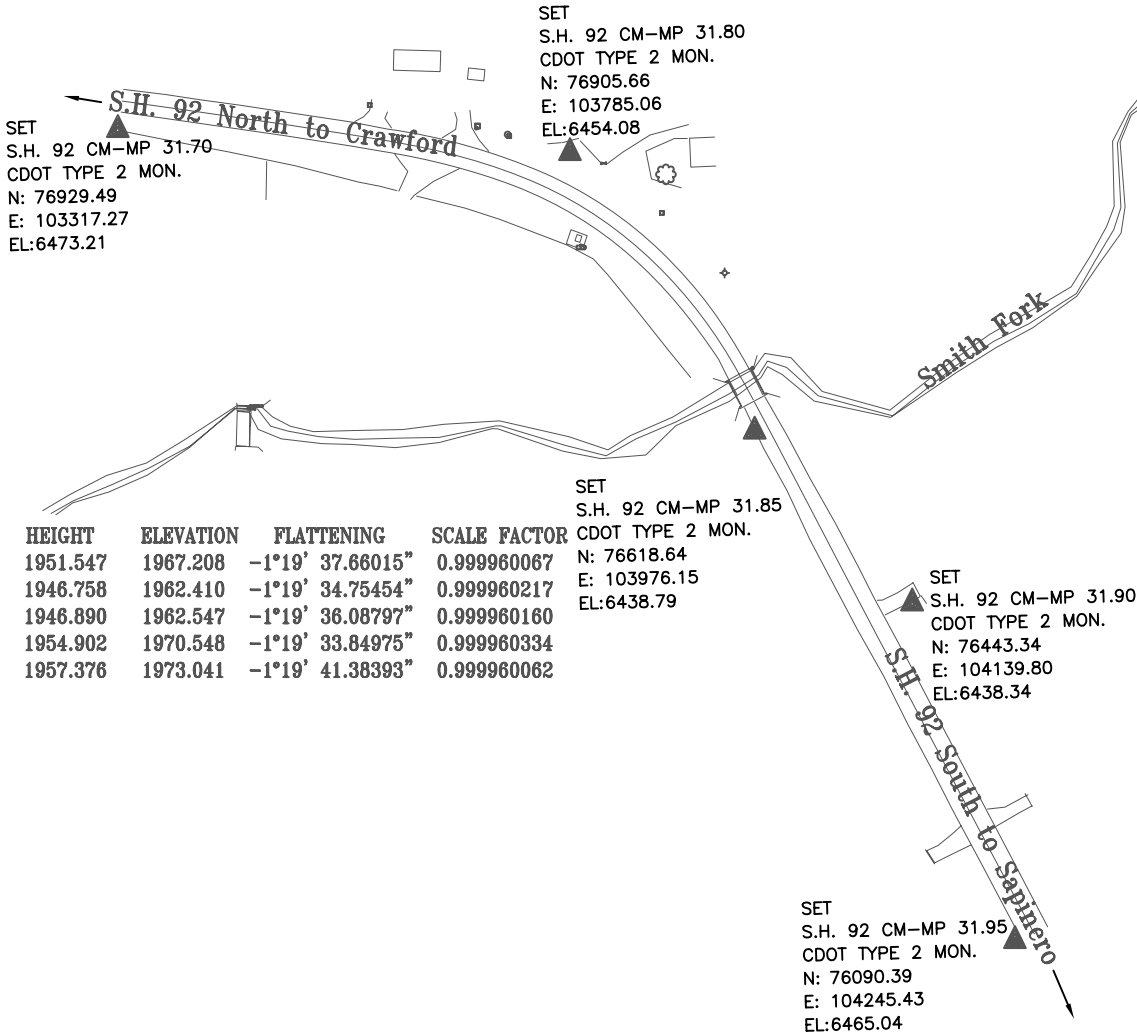

GENERAL NOTES
NOTE: This survey was conducted to provide horizontal and vertical control for highway design and construction and is for the use of the Colorado Department of Transportation. Coordinates are local project coordinates. Elevations were established by GPS survey using an elevation of 6473.21 ft. on CDOT control point "MP 31.70". The other control point elevations were established by differential levels from the control point at MP 31.70.
BASIS OF BEARING: A bearing of S 47°53'07" E, a distance of 1251.22' between set C.D.O.T. Control Markers located at Mile 31.70 and Mile 31.95 along S.H. 92, was established from a GPS Survey which used HARN (Colorado High Accuracy Reference Network) points W 429, D 19, A 426 and R 268. HARN information may be obtained from internet address http://www.ngs.noaa.gov/products_services.html.
NOTE: This survey is not a boundary survey.

NOTE: According to Colorado law you must commence any legal action based upon any defect in this survey within three years after you first discover such defect. In no event may any action based upon any defect in this survey be commenced more than ten years from the date of the certification shown.

Surveyor's Statement (Project Control Diagram):

I, Leslie E. Doehling, a professional land surveyor licensed in the State of Colorado, do hereby state to the Colorado Department of Transportation this Project Control Diagram was prepared and the field survey it represents was performed under my responsible charge and, based upon my knowledge, information and belief is in accordance with applicable standards of practice defined by Colorado Department of Transportation publications. This statement is not a guaranty or warranty, either expressed or implied.

LESLIE E. DOEHLING P.L.S. # 31551
222 South 6TH Street
Grand Junction, Co. 81501



Region 3
222 South 6th Street Room 317
Grand Junction, Colorado 81501
Phone: (970) 248-7232 FAX: (970) 248-7233

Right of Way Plans Unit:Leslie E. Doehling

Sheet Revisions

Sheet Revisions

Sheet Revisions

Right of Way Plans

Plan Sheet

Project Number:BR 092A-019

Project Location:Smith Fork Bridge

Project Location:SE of Crawford

Project Code:	Last Mod. Date	Subset Sheets	Sheet No.	Total No. of Sheets
15109	1-29-2006	2 to 2B	2A	4

Land Survey Control Diagram
T. 15 S., R. 91 W., 6th P.M.
DELTA COUNTY

Smith Fork Bridge
SE of Crawford

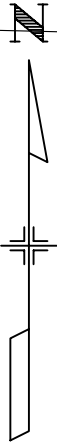
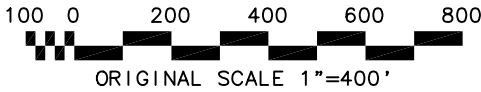

CRAWFORD

20.0 WITNESS COR LS 25972
S.H. 92
LS 1456
LS 1456
LS 12766
LS 113

Smith Fork

S.H. 92

(see Detail)

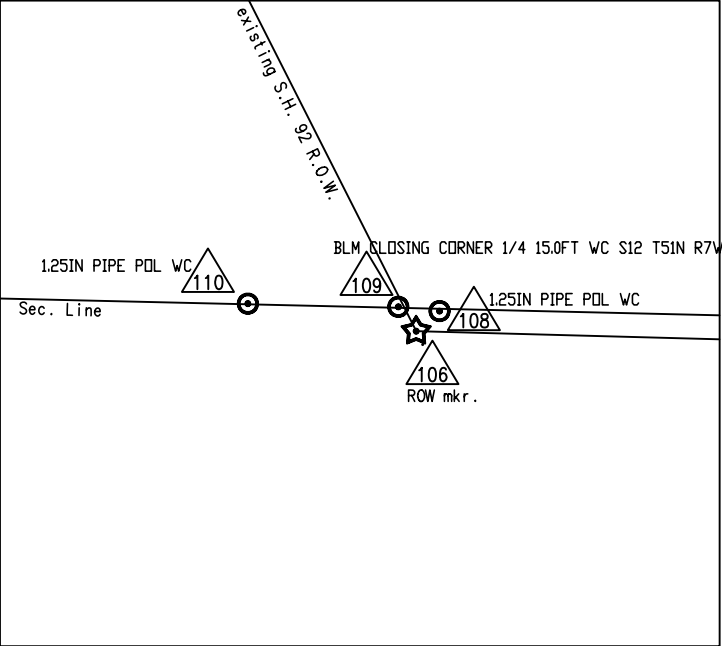

Detail
(scale 1"=25")

100
D.O.I. 1990

109 108
110 106

111 D.O.I. 15 FT. REF.
112 NAIL

107
BENT NO5 AND CAP KOUGLE AND POULS PT NO 4061-13

FILED CERTIFICATION:
DEPOSITED THIS ____ DAY OF ____ AT ____ M., FOR INFORMATION
ONLY IN BOOK ____ OF THE COUNTY LAND SURVEYS/RIGHT OF WAY
SURVEYS AT PAGE ____ RECEPTION NUMBER ____
SIGNED ____ DEPT. ____

CDOT Form #126Ra 7/00

FILED CERTIFICATION:
DEPOSITED THIS ____ DAY OF _____, 19____, AT ____M., FOR INFORMATION
ONLY IN BOOK _____ OF THE COUNTY LAND SURVEYS/RIGHT OF WAY
SURVEYS AT PAGE _____, RECEPTION NUMBER _____,
SIGNED _____,
DEPT. _____



COLORADO DEPARTMENT OF TRANSPORTATION

Region 3
222 South 6th Street Room 317
Grand Junction, Colorado 81501
Phone: (970) 248-7232 FAX: (970) 248-7233

Right of Way Plans Unit:Leslie E. Doehling

Sheet Revisions			Sheet Revisions			Sheet Revisions			Right of Way Plans				
									Plan Sheet				
									Project Number:BR 092A-019				
									Project Location:Smith Fork Bridge				
									Project Location:SE of Crawford				
									Project Code:	Last Mod. Date	Subset Sheets	Sheet No.	Total No. of Sheets
									15109	4-11-2006	2 to 2B	2B	4

Monumentation Sheet
T. 15 S., R. 91 W., 6th P.M.
DELTA COUNTY

Smith Fork Bridge
SE of Crawford

GENERAL NOTES

Pnt#	North Coordinates	East Coordinates	Remarks
100	75392.2038	103398.7690	1/4 corner DOI 1990
101	77978.7860	103510.7220	1/4 corner LS 25972 (wilmore & co)
102	76927.9785	103463.8220	prop pin LS 1456
103	76888.0722	103463.8200	prop pin LS 1456
104	76958.1411	103573.8460	20 WC LS 25972
105	76792.6056	103927.4970	prop pin LS 12766
106	75359.4983	104725.1140	ROW mkr
107	75289.8560	104762.7190	bent #5 & cap Kougle & Pouls pnt no 4061-13
108	75360.7808	104726.6090	wc
109	75361.0552	104723.9710	BLM CC 1/4 15.0' W.C. S12, T51N., T7W
110	75361.2568	104714.3460	1.25" pipe pol wc
111	75343.4152	106111.7030	DOI 15' ref
112	75328.2970	106111.9200	nail

Pnt#	North Coordinates	East Coordinates	Remarks
21	75836.942	104472.627	3.25" type 1
22	75930.016	104434.714	3.25" type 1
23	76018.416	104387.966	3.25" type 1
24	76102.145	104332.379	3.25" type 1
26	76619.979	103922.786	3.25" type 1
27	75362.490	104587.787	3.25" type 1
28	75358.633	104725.533	3.25" type 1
29	76634.104	103949.253	3.25" type 1
30	76676.479	104028.653	not set (see pnt 50)
31	76662.354	104002.187	3.25" type 1
40	76885.356	103641.428	3.25" type 1
41	76944.705	103650.240	3.25" type 1
42	76687.487	103921.022	3.25" type 1
43	76715.536	103974.062	not set (see pnt 51)
49	76045.380	104226.653	3.25" type 1
50	76667.063	104011.009	3.25" type 1 (20' WC for pnt. 30)
51	76711.116	103976.400	3.25" type 1 (5' WC for pnt. 43)

- This Right of Way Plan is not a complete boundary survey of all adjoining owners and is prepared for The Department of Transportation, State of Colorado purposes only.
- Found and set monuments are located within an error circle of radius .25' with respect to controlling monuments at a 95% confidence level.
- NOTICE: According to Colorado law you must commence any legal action based upon any defect found in this survey within three years after you first discover such defect. In no event, may any action based upon any defect in this survey be commenced more than ten years from the date of the certification shown hereon.
- All Right of Way Markers set from survey control points.
- All centerline stationing and offsets are theoretical only and may not represent the centerline as constructed.
- All coordinates listed are project coordinates.
- No guarantee as to the accuracy of the information contained on the attached drawing is either stated or implied unless this copy bears an original signature of the registered land surveyor(s) hereon named

Surveyor's Statement (Land Survey Control Diagram, ROW Plan, ROW Monumentation):

I, _____, a professional land surveyor licensed in the State of Colorado, do hereby state to the Colorado Department of Transportation that based upon my knowledge, information and belief, adequate research, calculations and evaluation of the survey evidence were performed and that these Right-of-Way Plans, and Right-of-Way monuments as depicted on these Right-of-Way Plans were set under my responsible charge in accordance with applicable standards of practice defined by Colorado Department of Transportation publications. This statement is not a guaranty or warranty, either expressed or implied.

PLS No.

Date

COLORADO DEPARTMENT OF TRANSPORTATION



Region 3
222 South 6th Street Room 317
Grand Junction, Colorado 81501
Phone: (970) 248-7232 FAX: (970) 248-7233

Right of Way Plans Unit:Leslie E. Doehling

Sheet Revisions

Sheet Revisions

Sheet Revisions

Right of Way Plans

Plan Sheet

Project Number:BR 092A-019				
Project Location:Smith Fork Bridge				
Project Location:SE of Crawford				
Project Code:	Last Mod. Date	Subset Sheets	Sheet No.	Total No. of Sheets
15109	1-29-2006		3	4

Smith Fork Bridge
SE of Crawford

R.O.W. Plan Sheet
T. 15 S., R. 91 W., 6th P.M.
DELTA COUNTY

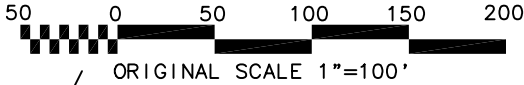

(proj. NRS 379)
Curve Data PI 14+13.70
D = 53° 41' 00" Rt
Dc = 13° 59' 55"
Tc = 207.13'
Lc = 383.49'
Rc = 409.30'

Arc = 411.60'
Chd = 396.71'
N.54°42'47"W.
Radius = 439.30'

Arc = 411.60'
Chd = 396.71'
N.54°42'47"W.
Radius = 439.30'

Mary D. DuFon
(rec. #518776)

FILED CERTIFICATION: _____
DEPOSITED THIS _____ DAY OF _____, 19____, AT _____, M., FOR INFORMATION
ONLY IN BOOK _____ OF THE COUNTY LAND SURVEYS/RIGHT OF WAY
SURVEYS AT PAGE _____, RECEPTION NUMBER _____
SIGNED _____
DEPT. _____

CRAWFORD

Begin R.O.W. proj. BR 092A-019, Sta. 12+06.57 =
Sta. 12+06.57 on proj. NRS 379 = M.P. 31.76

The Smith Fork Ranch Family Partnership LLLP,
A Colorado Limited Liability Limited Partnership

NOTE: Centerline of S.H. 92 shown is from previous projects S 0125(8) & NRS 379
NOTE: Offsets shown are to the S.H. 92 centerline from previous projects S 0125(8) & NRS 379

NOTE: existing S.H. 92 R.O.W. acquired previously on projects S 0125(8) & NRS 379

COLORADO DEPARTMENT OF TRANSPORTATION



Region 3
222 South 6th Street Room 317
Grand Junction, Colorado 81501
Phone: (970) 248-7232 FAX: (970) 248-7233

Right of Way Plans Unit:Leslie E. Doehling

Sheet Revisions

Sheet Revisions

Sheet Revisions

Right of Way Plans

Ownership Sheet

Project Number:BR 092A-019				
Project Location:Smith Fork Bridge				
Project Location:SE of Crawford				
Project Code:	Last Mod. Date	Subset Sheets	Sheet No.	Total No. of Sheets
15109	1-29-2006		4	4

Land Survey Control Diagram
T. 15 S., R. 91 W., 6th P.M.
DELTA COUNTY

Smith Fork Bridge
SE of Crawford

125 0 250 500 750 1000
ORIGINAL SCALE 1"=500'



NW1/4
Sec. 31

NE1/4
Sec. 31

NW1/4
Sec. 32

Sec. 36
Sec. 31

Sec. 31
Sec. 32

Begin R.O.W. proj. BR 092A-019, Sta. 12+06.57 =
Sta. 12+06.57 on proj. NRS 379 = M.P. 31.76

31

LS 25972 WILMORE & CO

Mary D. DuFon
(rec. #518776)

CRAWFORD

Crawford City Limits

Crawford City Limits

SW1/4
Sec. 31

SE1/4
Sec. 31

SW1/4
Sec. 32

The Smith Fork Ranch Family Partnership LLLP,
A Colorado Limited Liability Limited Partnership
(rec. #520645)

- plus lands in other sections, township and ranges -

End R.O.W. proj. BR 092A-019, Sta. 31+39.91=
Sta. 31+39.91 on proj. S 0125(8) = M.P. 32.12

T. 15 S., 6th P.M.
T. 51 N., N.M.P.M.

Sec. 31
Sec. 12

NOTE: Offsets shown are to the S.H. 92 centerline from previous projects S 0125(8) & NRS 379

NOTE: existing S.H. 92 R.O.W. acquired previously on projects S 0125(8) & NRS 379

FILING CERTIFICATION:
DEPOSITED THIS ____ DAY OF ____, 19__, AT ____, FOR INFORMATION
ONLY IN BOOK ____ OF THE COUNTY LAND SURVEYS/RIGHT OF WAY
SURVEYS AT PAGE ____, RECEPTION NUMBER ____
SIGNED _____
DEPT. _____