

STATE DEPARTMENT OF HIGHWAYS DIVISION OF HIGHWAYS — STATE OF COLORADO

PLAN AND PROFILE OF PROPOSED COMPLETED
COLORADO PROJECT NO. C39-0138-00
STATE HIGHWAY NO. 138
SEDGWICK COUNTY

AS CONSTRUCTED
REVISED DATE 7/14/71

FEDERAL ROAD DISTRICT NO.	DIVISION	PROJECT NO.	SHEET NO.
9	COLORADO	C 39-0138-00	7

INDEX OF SHEETS

TITLE PAGE, SKETCH MAP, AND TABULATION OF LENGTH AND DESIGN DATA.	SHEET NO.
TYPICAL SECTIONS AND GENERAL NOTES.	7-30-68
SUMMARY OF APPROXIMATE QUANTITIES.	4-27-70
STRUCTURE QUANTITIES.	3-1-71
PLAN SKETCH AND SURFACING TABULATION.	10-20-68
ALIGNMENT, PLAN AND PROFILE SHEETS.	10-20-68
STRUCTURE CONNECTIONS.	2-11-71
SUPPLEMENTATION AND REVISIONS OF CURVES - CORNERED HIGHWAYS.	12-20-68
INLET DESIGNING.	7-30-68
EXCAVATION AND BACKFILL FOR STRUCTURES.	10-20-68
LETTERS AND FIGURES FOR STRUCTURE NUMBERS.	10-20-68
SINGLE AND DOUBLE CONCRETE BOX CULVERTS.	10-20-68
MANHOLE AND CONCRETE BOX CULVERTS - 2:1 SIDE SLOPES (2 SHEETS)	10-20-68
TRUNK MANHOLE.	2-11-71
TRAFFIC LIGHTING FOR HIGHWAY CONSTRUCTION	(3 SHEETS)

SHEET NO.

ON PLAN, 1 IN. = 100 FT.
ON PROFILE, 1 IN. = 10 FT. HORIZONTAL
1 IN. = 10 FT. VERTICAL

GRADE LINE ON PROFILE IS SHOWN AS GRADE OF FINISHED ROAD

Contractor: Seering Paving Company
Resident Engineer: L.J. Van Rethem
Project Engineer: J.M. Wambach
Project Started: May 24, 1971
Project Completed: July 14, 1971

CONVENTIONAL SIGNS

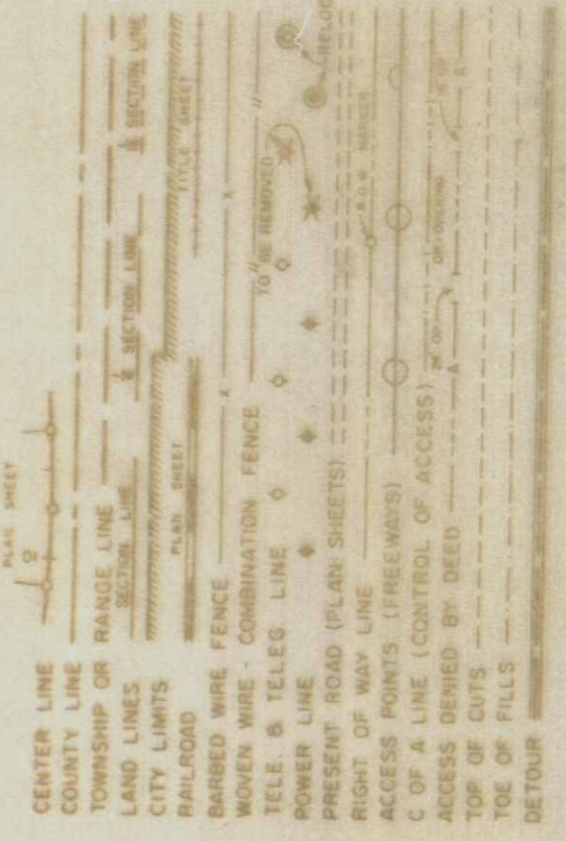

TABULATION OF LENGTH & DESIGN DATA

STATION	ROADWAY		NO WORK SECTION	MILES
	LN. FT.	LN. FT.		
STA 0+00 BEGIN C 39-0138-00 - 3152+02 END C 13-0002-18	6,217.0	4,899.0	3,275.0	3.133
83+20 JULESBURG				0.075
84+25 - 120+00				0.130
130+00 CITY LIMITS				3.772
155+15 END C 39-0138-00				
STA 185+00 APPROX. END C 13-0002-18	16,540.0	12,998.0	3,172.0	3.006
TOTALS	22,757.0	17,897.0	6,447.0	6.139

SUMMARY	
ROADWAY (NET LENGTH)	16,540.0
NO WORK SECTION	3,175.0
TOTAL (GROSS LENGTH)	19,715.0

DESIGN DATA	
MAXIMUM DEGREE OF CURVE	5° 00'
MAXIMUM GRADE	2.00%
MINIMUM 550 HORIZONTAL	2675 FT.
MINIMUM 550 VERTICAL	1175 FT.
MAXIMUM DESIGN SPEED	60 MPH

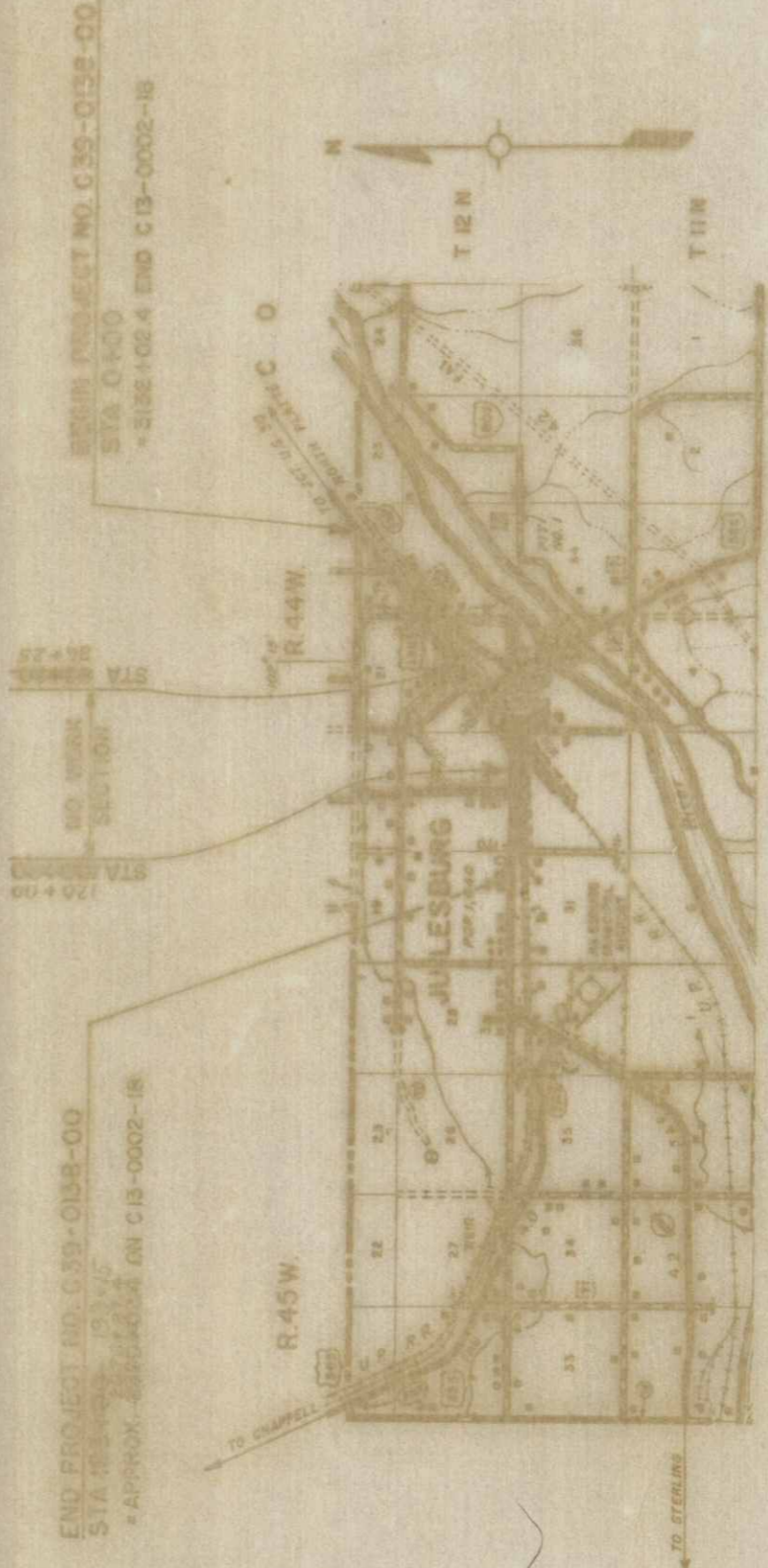

Department of Highways
State of Colorado

Final Approval As
Contracting Officer
John J. Patton
District Construction Engineer

DIVISION OF HIGHWAYS

APPROVED
Edwin E. Shumate 4-22-71
CHIEF ENGINEER DATE

BY
R. L. Baum, Deputy Chief
Engr.



AS CONSTRUCTED
REVISED DATE 2/11/71

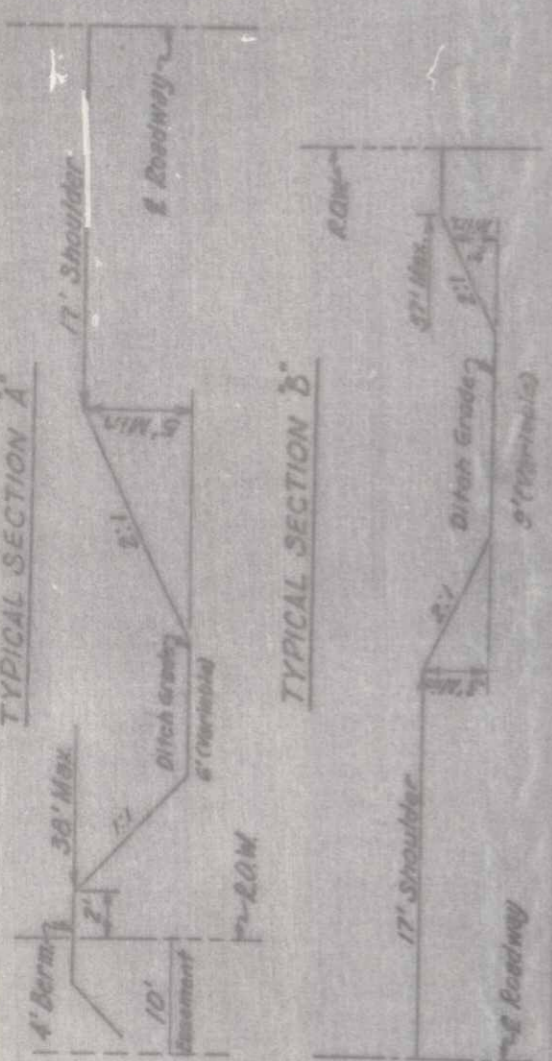

FED. ROAD DIST. NO.	STATE	PROJ. NO.	SHEET NO.	TOTAL SHEETS
122-676	COLO.	C39-038-00	6	

4-29-71 NEV
Added Riprap

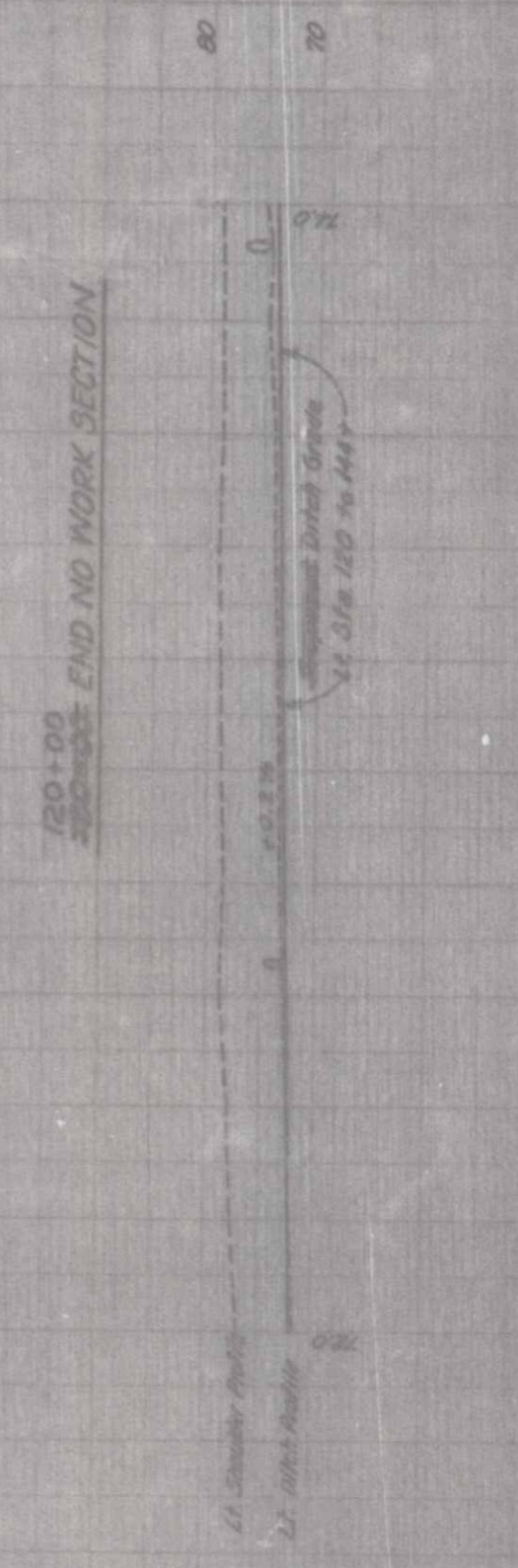

120+00
END NO WORK SECTION

Highway R.E.A.
Heldale, Colo.
and City of Silverburg

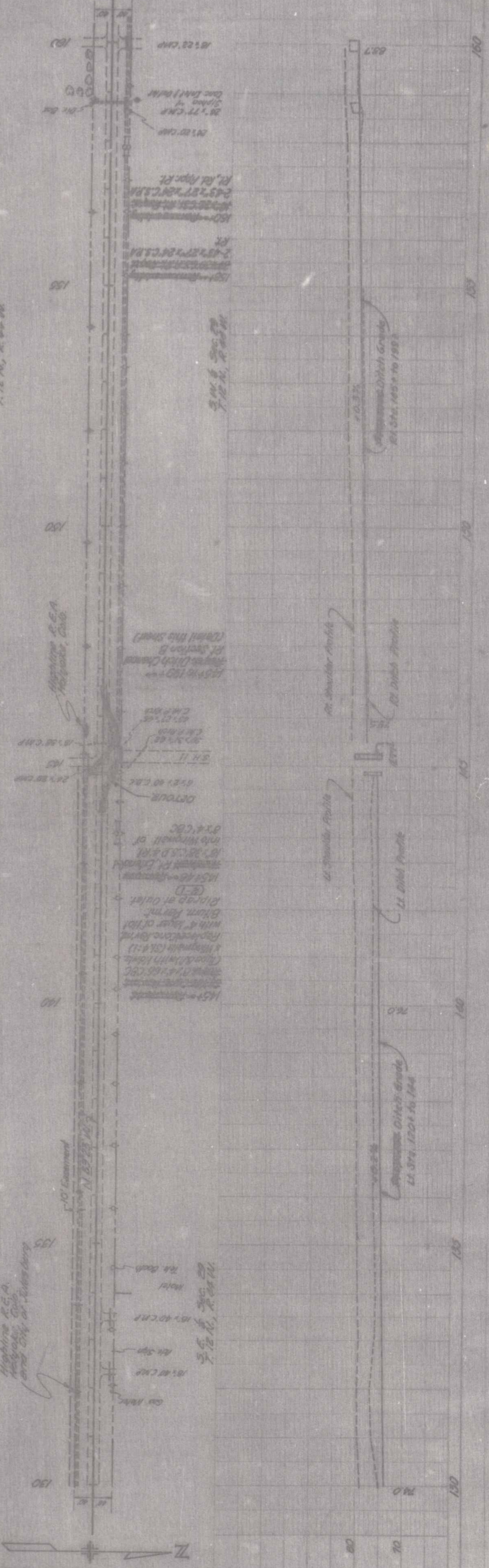

DATE	TIME

FILE NO.	STATE	PROJ. NO.	SHEET NO.	TOTAL SHEETS
101-100	COLO.	C 39-0158-00	7	8

AS CONSTRUCTED
REVISED DATE 7/14/77

N 1/2 Sec 31
T 12 N, R 68 W

N 1/2 Sec 30
T 12 N, R 68 W

STA. 165-16
END C 39-0158-00
Approx. Station on C 19-0002-18
2573+87.4

S 1/2 Sec 30
T 12 N, R 68 W

24' 40' CMP (Imp)
24' 40' CMP (Imp)
PI 172-00
Δ = 0' 10" LL
R = 1.00 CH

1971-Grading
CS RA EX. RL
2-13-77
R. RA App. RL

N 1/2 Sec 31
T 12 N, R 68 W

S 1/2 Sec 30
T 12 N, R 68 W

N 1/2 Sec 31
T 12 N, R 68 W

S 1/2 Sec 30
T 12 N, R 68 W

N 1/2 Sec 31
T 12 N, R 68 W

S 1/2 Sec 30
T 12 N, R 68 W

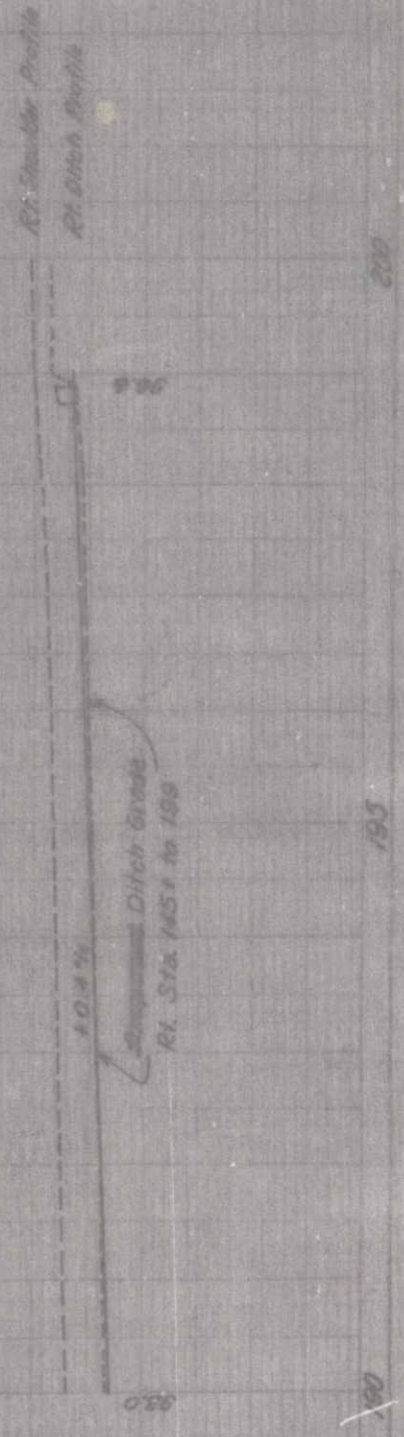
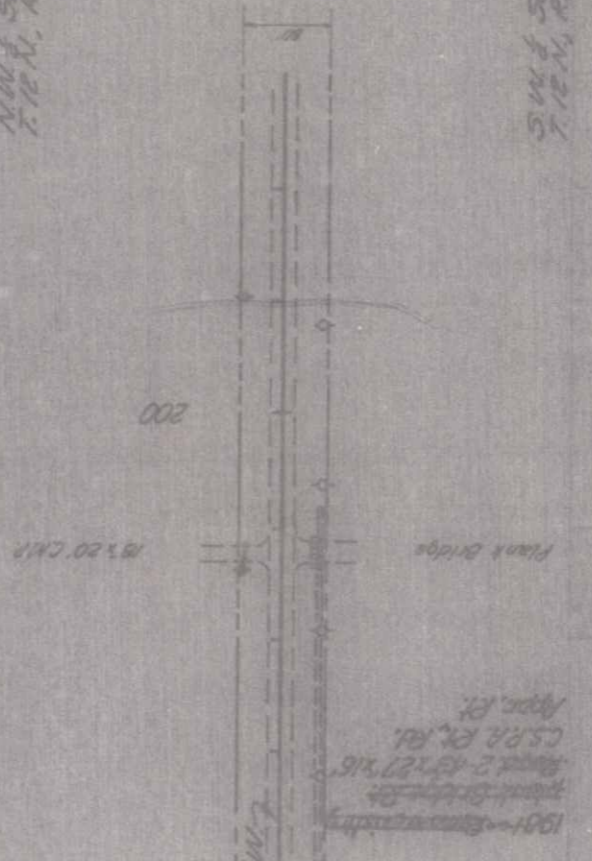
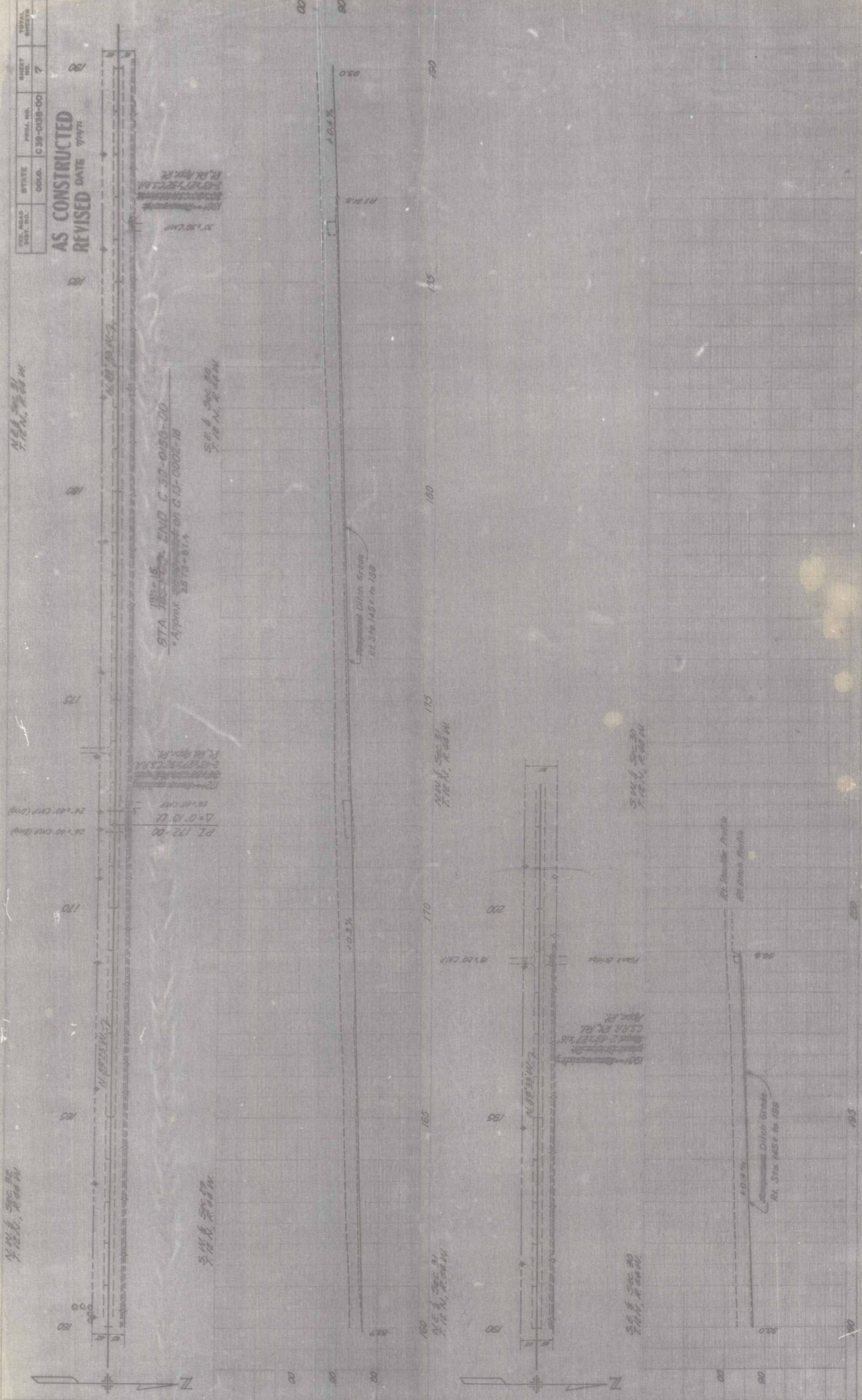
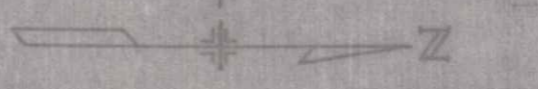
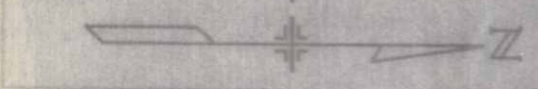

101-Grading
CS RA EX. RL
2-13-77
R. RA App. RL

1971-Grading
CS RA EX. RL
2-13-77
R. RA App. RL

Road Shoulder Profile
Ditch Profile

Proposed Ditch Grade
At Sta. 145 + to 150

Proposed Ditch Grade
At Sta. 145 + to 150

1971-Grading
CS RA EX. RL
2-13-77
R. RA App. RL

20' 1.50' CMP

R = 1.00 CH

170

175

180

185

190

195

200

205

210

215

220

225

230

235

240

195

190

185

180

175

170

165

160

155

150

145

140

135

130

125

101-Grading
CS RA EX. RL
2-13-77
R. RA App. RL

1971-Grading
CS RA EX. RL
2-13-77
R. RA App. RL