

Colorado Department of Transportation



222 South 6th Street
Room 317
Grand Junction, CO 81501
Phone: 970-248-7072 FAX: 970-248-7233

Region 3

LED

TDS

Sheet Revisions

Date	Description	Initials

Sheet Revisions

Date	Description	Initials

Sheet Revisions

Date	Description	Initials

Right of Way Plans

TITLE SHEET

Project Number: CR300-053				
Project Location: SH 65 Grand Mesa Slide Repair				
Project Location: MP 37.4 to MP 37.6				
Project Code: 12308	Last Mod. Date: 07-11-07	Subset Sheets: R 1.01	Sheet No.:	Total No. of Sheets: 9

DEPARTMENT OF TRANSPORTATION
STATE OF COLORADO

RIGHT OF WAY PLAN OF PROPOSED
PROJECT NO. CR 300-053
STATE HIGHWAY NO. 65
MESA COUNTY
RIGHT OF WAY PROJECT CODE NO. 12308
SH 65 GRAND MESA SLIDE REPAIR

<u>SHEET NO.</u>	<u>INDEX OF SHEETS</u>
RW 1.01	(1) Title Sheet
RW 2.01	(1) Tabulation of Properties
RW 3.01	(1) Control Diagram & Monument Sheet
RW 4.01	(1) Plan & Ownership Sheet
M-100-1	(3) Standard Symbols
M-629-1	(2) Survey Monuments
(9) Total Sheets	

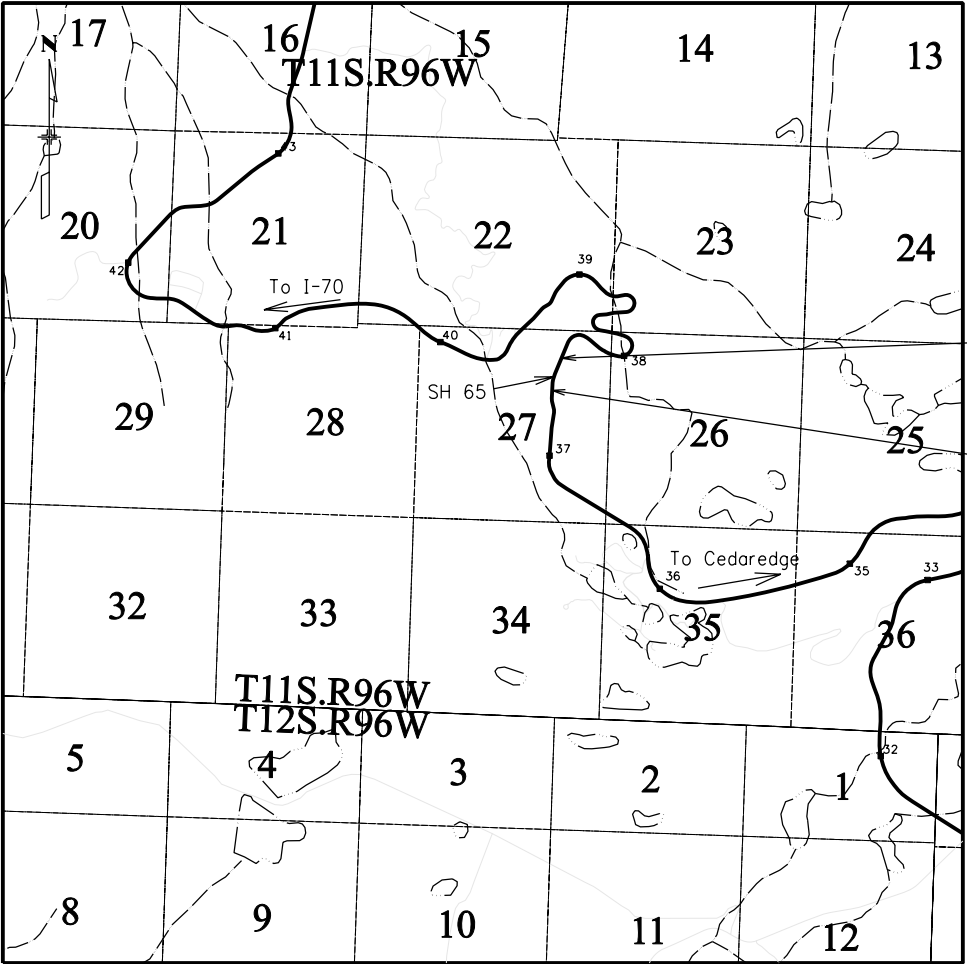

End Construction Project C 065A-020
Sta. 18+75 MP 37.6

End RDW Project CR300-053
Sta. 18+75 MP 37.6

Begin Consturction Project C 065A-020
Sta. 10+50 MP 37.4

Begin RDW Project CR300-053
Sta. 10+50 MP 37.4

PROJECT LOCATION MAP



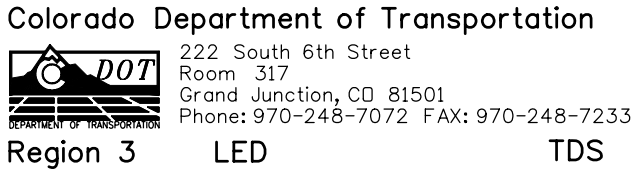

222 South 6th Street
Room 317
Grand Junction, CO 81501
Phone: 970-248-7072 FAX: 970-248-7233

Region 3 LED TDS

[illegible]

Right of Way Plans				
Tabulation of Properties				
Project Number: CR300-053				
Project Location: SH 65 Grand Mesa Slide Repair				
Project Location: SH 65				
Project Code:	Last Mod. Date	Subset Sheets	Sheet No.	Total No. of Sheets
12308	7-12-07		RW 2.01	9

[illegible]

Colorado Department of Transportation



222 South 6th Street
Room 317
Grand Junction, CO 81501
Phone: 970-248-7072 FAX: 970-248-7233

Region 3

LED

TDS

Sheet Revisions

Date	Description	Initials

Sheet Revisions

Date	Description	Initials

Sheet Revisions

Date	Description	Initials

PROJECT CONTROL DIAGRAM

Project Number: 12308 SH 65 Slide				
Project Location: SH 65				
Project Location: MP 37.4 to MP 37.6				
Project Code:	Last Mod. Date:	Subset Sheets	Sheet No.	Total No. of Sheets
12308	6-20-2007		R 3.01	9

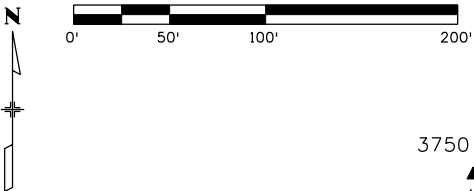

PROJECT CONTROL DIAGRAM
T 11 S, R 96 W, 6th PM
SECTION 27

Construction Surveying and Monumentation Requirements

1. This Project Control Diagram represents the horizontal and vertical control for the project established by the Division. It is possible that some of the survey control monuments listed have been disturbed or obliterated. It is the Contractor's responsibility to verify the existence and stability of the control monuments before submitting a bid price.
2. All Type 1 and Type 2 monuments shall be set flush with the ground. Witness posts shall be installed 1 foot from and facing all Type 1 and Type 2 monuments, or as directed by the Project Engineer.
3. Installation of Type 3 and Type 3-A monuments shall be completed in the same day that installation is commenced. Under no circumstances shall holes in the roadway be left open overnight.
4. When installing Type 3-A monuments, the aluminum monument box shall be positively secured in the roadway surface. The monument box shall be caulked with asphalt caulking between the monument box and the edges of the roadway surface to provide a positive moisture barrier around the monument box.

5. Control survey procedures, statistical analysis, and accuracy obtained for horizontal and vertical control shall be documented in the field book.
6. Legible copies of the field books shall be submitted to the Project Engineer for review on a monthly basis.
7. It is ultimately the prime Contractor's responsibility to insure that these requirements, as well as any contained in the CDOT specifications, project special provisions, and CDOT Survey Manual are fulfilled under this contract.
8. The minimum staking intervals for each item are described on the plans or in the CDOT Survey Manual. If the contractor wishes to reduce the minimum intervals, a Contract Modification Order must be negotiated and the cost of the item reduced accordingly.
9. Whenever the contract includes the setting of CDOT Type 2 monuments, a Project Control Diagram, signed and sealed by the P.L.S. in responsible charge, shall be submitted to the Project Engineer. An AutoCad drawing on CD shall accompany the hard copy.

GENERAL NOTES

1. *This Right of Way Plan is not a complete boundary survey of all adjoining owners and is prepared for Transportation Department purposes only.*
2. *Survey Control Points set with a higher degree of accuracy than R.O.W. markers.*
3. *NOTICE: According to Colorado law you must commence any legal action based upon any defect in this survey within three years after you first discover such defect. In no event, may any action based upon any such defect in this survey be commenced more than ten years from the date of certification shown hereon.*
4. *All R.O.W. markers set from control monuments.*
5. *All centerline and offset stationing is theoretical only and may not represent the centerline as constructed in the field. All stationing is approximate.*
6. *All coordinates listed are project coordinates only.*
7. *Field survey control precision meets the minimum horizontal control tolerances of a CDOT Type B survey (4-29-1992)*

BASIS OF BEARINGS: All bearings are based on a line connecting point 3740 and point 3750 bearing N19° 20'05"E.

BASIS OF ELEVATIONS: Project is based on a elevation of 9536.41 on Control Point 3740, a CDOT Type II Control Monument. There are no existing Bench Marks in the project area. Therefore elevation were not verified to any existing Bench Mark Datums. All other Control Points on this Project were then tied in by means of running a Bench Loop.

COORDINATE DATUM: Coordinates on this project are for the exclusive use of the CDOT for the construction of this project and are considered Project Coordinates only.

CP - Control Point Monuments set by CDOT. They were CDOT type 2 monuments, a 3-1/4" dia. aluminum control monument cap (as shown) on a 3' X 3/4" dia. finned aluminum security rod on a 3' X 3/4" dia. smooth aluminum rod.

NOTE: This control survey is for the use of the Colorado Department of Transportation personnel. The survey is not a complete Boundary Survey. Title Policy, Title Commitment, and Title Research were not part of this control survey, therefore, easements, rights, and to easements, rights of way, property boundaries, and restriction, as described in the instruments of record, were not included in this control survey.

NOTE: According to Colorado law you must commence any legal action based upon any defect in this survey within three years after you first discover such defect. In no event may any action based upon any defect in this survey be commenced more than ten years from the date of the statement shown.

NOTE: No guarantee as to the accuracy of the information contained on the attached drawing is either stated or implied unless this copy bears an original signature of the professional land surveyor hereon named.

SLIDE AREA

3745

Project number: 12308 SH 65 Slide
Route SH 65, from MP 37.4 to MP 37.6
Project location: in Mesa County, Colorado

Project Latitude 39.035884
Project Longitude 108.060079
Project Elevation 9511.50
Zone Colorado Central
Scale Factor 0.9999360920797729
Combined Factor 0.9994813514362946
Northing Reduction 1,000,000
Easting Reduction 2,000,000
Units in feet

To get from Project coordinates to S.P. coordinates:
(Project + Reduction X Combined Factor = State Plane)

Pnt No.	Northing	Easting	Height	SP North	SP East	Flattening	Scale Factor
3740	39° 03'55.08656"N	108° 06'01.81651"W	9485.342	1459244.964	2261746.785	-1° 38'24.39989"	0.999936103
3745	39° 03'58.83898"N	108° 06'00.79264"W	9460.389	1459622.122	2261838.367	-1° 38'23.75415"	0.999936092
3750	39° 04'02.00146"N	108° 05'58.98602"W	9440.808	1459937.855	2261989.947	-1° 38'22.61473"	0.999936083

SURVEY CONTROL POINTS

Point No.	Northing	Easting	Elev.	Desc.
3740	460002.19	262920.45	9536.41	MP 37.40
3745	460379.54	263012.08	9511.50	MP 37.45
3750	460695.44	263163.73	9491.93	MP 37.50

SURVEYOR STATEMENT (PROJECT CONTROL DIAGRAM)

I, Thomas D. Spor, a professional land surveyor licensed in the State of Colorado, do hereby state to the Colorado Department of Transportation this Project Control Diagram was prepared and the field survey it represents was performed under my responsible charge and, based upon my knowledge, information and belief is in accordance with applicable standards of practice defined by Colorado Department of Transportation publications. This statement is not a guaranty or warranty, either expressed or implied.

PLS No. 37988

Date

Right of Way Plans				
PLAN SHEET				
Project Number: CR300-053				
Project Location: SH 65 Grand Mesa Slide Repair				
Project Location: MP 37.4 to MP 37.6				
Project Code:	Last Mod. Date	Subset Sheets	Sheet No.	Total No. of Sheets
12308	00-00-00		RW 4.01	9

