

INDEX OF SHEETS  
 SHEET NO. 1 TITLE SHEET  
 2 TABULATION OF PRIORITIES  
 3-5 PLAN & PROFILE SHEETS  
 SHOWING RIGHT OF WAY

# COLORADO DEPARTMENT OF HIGHWAYS

PLAN AND PROFILE OF PROPOSED  
**FEDERAL AID PROJECT NO. C 29-0016-16**  
 STATE HIGHWAY NO. 6  
 BENT COUNTY

SECTION NO.	DISTRICT	PROJECT NO.
1	6	C 29-0016-16
RIGHT OF WAY		

### CONVENTIONAL SIGNS

CENTER LINE	14x18 SIGN	100 FT. SPACED
RIGHT OF WAY LINE	14x18 SIGN	100 FT. SPACED
QUANTITY LINE	14x18 SIGN	100 FT. SPACED
BOUNDARY OF TRAIL LINE	14x18 SIGN	100 FT. SPACED
LAND LINE	14x18 SIGN	100 FT. SPACED
RAILROAD	14x18 SIGN	100 FT. SPACED
BARBED WIRE FENCE	14x18 SIGN	100 FT. SPACED
CONCRETE WIRE FENCE	14x18 SIGN	100 FT. SPACED
BODY FENCE	14x18 SIGN	100 FT. SPACED
TELEPHONE & TELEGRAPH LINES	14x18 SIGN	100 FT. SPACED
POWER LINE	14x18 SIGN	100 FT. SPACED
OT-CLEAR	14x18 SIGN	100 FT. SPACED
PRESENT ROAD (Paved Surface)	14x18 SIGN	100 FT. SPACED

FILE COPY - DO NOT REMOVE FROM OFFICE

SCALE OF ORIGINAL DRAWING  
 ON PLAN 1" = 100' HORIZONTAL  
 ON PROFILE 1" = 10' VERTICAL  
 GRADE LINE OF PROFILE IS SHOWN AS GRADE OF FINISHED ROAD  
 GRADE LENGTH OF SUBJECT  
 IN LENGTH OF PROJECT

V.F.D.

FILE COPY - DO NOT REMOVE FROM OFFICE

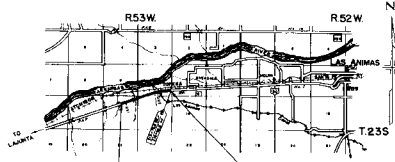

FILE COPY - DO NOT REMOVE FROM OFFICE

STA. 143+75 O.B.E.S. PROJ. C 29-0006-16  
 217 FT. STA. 143+75 ON E.A.B. 243 A-R-1

STA. 281+76.5 B.K. END C 29-0006-16  
 217 FT. STA. 281+76.5 ON E.A.B. 243 A-R-1

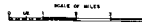

PARCEL NO.	OWNER	ADDRESS	LOCATION	AREA TOTAL CLAIM IN TRACT	IN PARCEL	ACRES TO BE ACQUIRED	Date	Lead	Temporal	Damage	Misc	Total	REMARKS
			T. 23S. R. 90 W										
	STATE OF COLORADO		SECTION 16	8401	5716	3.819				122.50		112.50	
			SECTION 15										
2	HENRY MANFORD		1/4 COR. SEC. 14	3201	5.023	3.242							
			SECTION 10										
3	HENRY A. MANFORD		LOT 4 S. 3		1.085	2.177							
			1/4 COR. LOT 3 OF SEC. 14		4.336	1.973				59.5		111.00	
4	MARY G. RATHBUN, EDWIN D. RATHBUN JR. (MARGUERITE)		1/4 COR. LOT 3 OF SEC. 14		1.892	1.446				4,400.00	275.00	4,675.00	
5	THE LAS ANIMAS CONSOLIDATED CANAL COMPANY		WEST 1/2 LOT 3 OF SEC. 14		4.709	2.249				1,400.00	200.00	1,600.00	
6	ANDREW J. BERRY		SE 1/4 COR. SEC. 14	401									
			LOT 3 OF SEC. 14		0.092	0.092							PERMANENT EASEMENT
4A	COLORADO DEPARTMENT OF HIGHWAYS		Part of LOT 3, SE 1/4		0.184	0.184							EASEMENT OF EGRESS NO. 4 EASEMENT TO THE LAS ANIMAS CONSOLIDATED CANAL CO.

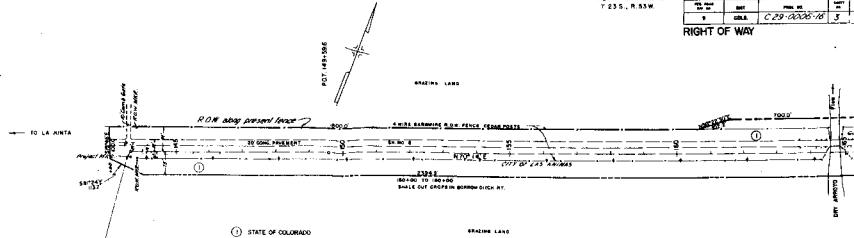

STA 143+75.0 BEGIN PROJ. C 29-0006-16  
 29 FT RTY STA 143+75.0 ON FAR 245 A-R-1

