



**COLORADO**  
Department of  
Transportation

# DOCUMENT SEPARATOR SHEET

## REGION 5 – JUNE 2017 CONVERSION

To be placed at the beginning of each separator sheet.



r500001873

**Description:**

ROW Plans 11X17

**Route # and Mile Points:**

US 491

**Originating Office:**

ROW/Survey

**File Name:**

C 4912-002\_ROW(.PDF)

**Box Location:**

29 of 38

# STATE OF COLORADO

DEPARTMENT OF TRANSPORTATION



## DEPOSITED RIGHT OF WAY PLANS MEMO

**DATE: July 18, 2013**  
**TO: Central Office Project Development Branch, ROW Services**  
**FROM: Todd Johnston, Survey Coordinator Region 5**  
**SUBJECT: Deposited ROW Plans**

REGION: 5  
PROJECT CODE: 18756  
PROJECT NUMBER: C 4912-002  
PROJECT LOCATION: US 491 MP 28.64

The Region office has completed and filed the Right of Way Plans for the above captioned project with the County Clerk and Recorder of Montezuma County.

Plat Number 1700.

Date: May 5, 2013.

Sections 15 Township 36 North, Range 16 West of the New Mexico Principal Meridian.

Highway 491, Beginning Mile Post 28.64, Ending Mile Post 28.64.

The total number of sheets deposited 3.

By   
Region ROW Plans Coordinator

Sheet Revisions		
Date	Description	Initials

Sheet Revisions		
Date	Description	Initials

**Farnsworth GROUP**  
 ENGINEERS ARCHITECTS SURVEYORS SCIENTISTS  
 4755 Forge Road, Suite 150  
 Colorado Springs, Colorado 80907  
 (719) 590-9194 / (719) 590-9111 Fax  
 www.f-w.com

Right of Way Plans			
Title Sheet			
Project Number: C 4912-002			
Project Location: US 491 MP 28.64			
PRIORITY CULVERT			
Project Code:	Last Mod. Date	Subset	Sheet No.
18756	02-21-13	1.01 of 1.01	1.01

# DEPARTMENT OF TRANSPORTATION STATE OF COLORADO

RIGHT OF WAY PLANS OF FEDERAL AID PROJECT NO. C4912-002  
 BEING A DEPENDENT RESURVEY OF THE ORIGINAL RIGHT-OF-WAY LINES  
 ESTABLISHED BY PROJECT NO. F666-2(1) SEC. 1 AND PROJECT NO. 269-D

US HIGHWAY 491  
 MONTEZUMA COUNTY

In Section 15  
 Township 36 North, Range 16 West  
 of the N.M. Principle Meridian

SHEET NO.	INDEX OF SHEETS
1.01	(1) Title Sheet
3.01-3.03	(3) Project Control Diagram
4.01-4.03	(3) Land Survey Control Diagram
5.01	(1) Monumentation Sheets
7.01	(1) Plan Sheets
(9) Total Sheets	

Scales of Original 11x17 Drawings  
 Project Control Diagram 1"=500'  
 Land Survey Control Diagram 1"=200'  
 Plan Sheets 1"=50'

Basis of Bearings: Bearings used in the calculations of coordinates are based on a grid bearing of N15° 37' 54" W from CM-MP 29.01, a 3 1/4" brass cap, State Highway Department Right-of-Way Marker FAP 269-D 135+00, to CM-MP 29.48, a CDDT Type II monument marked appropriately for its milepost location and control position. The survey data was obtained from a Global Positioning System (GPS) survey based control formerly set by CDDT on Project No. NH 4912-001.

1. This Right-of-Way Plan is not a boundary survey of the adjoining property and is prepared for the Colorado Department of Transportation purposes only.
2. For title information, Farnsworth Group Inc. relied on title commitment prepared by H.C. Peck & Associates, Inc.
3. This plan set is subject to change and may not be the most current set. It is the user's responsibility to verify with CDDT that this set is the most current. The information contained on the attached drawing is not valid unless this copy bears an original signature of the Professional Land Surveyor hereon named.
4. This right-of-way survey meets the minimum accuracy tolerances for CDDT Class B - Secondary as defined in Chapter 5 of the CDDT Survey Manual, dated Nov. 2011.

NOTICE: According to Colorado law you must commence any legal action based upon any defect in this survey within three years after you first discover such defect. In no event may any action based upon any defect in this survey be commenced more than ten years from the date of the certification shown hereon.

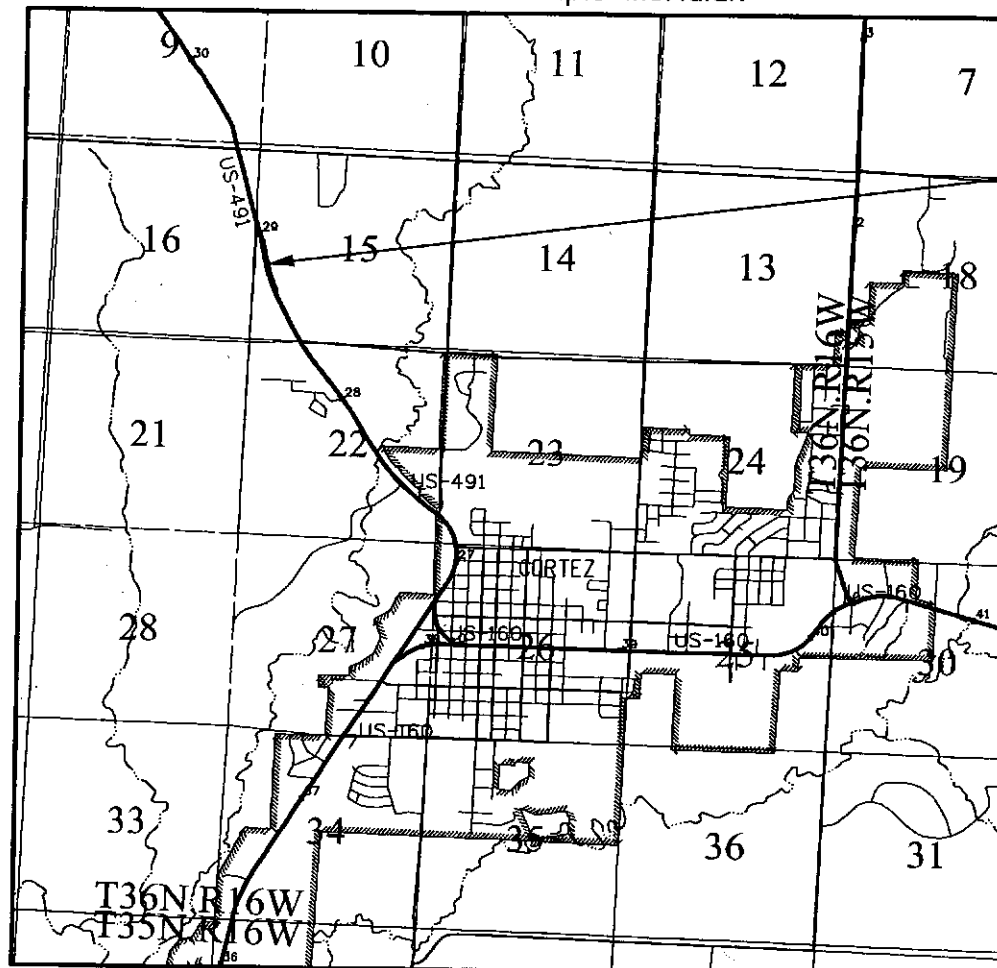
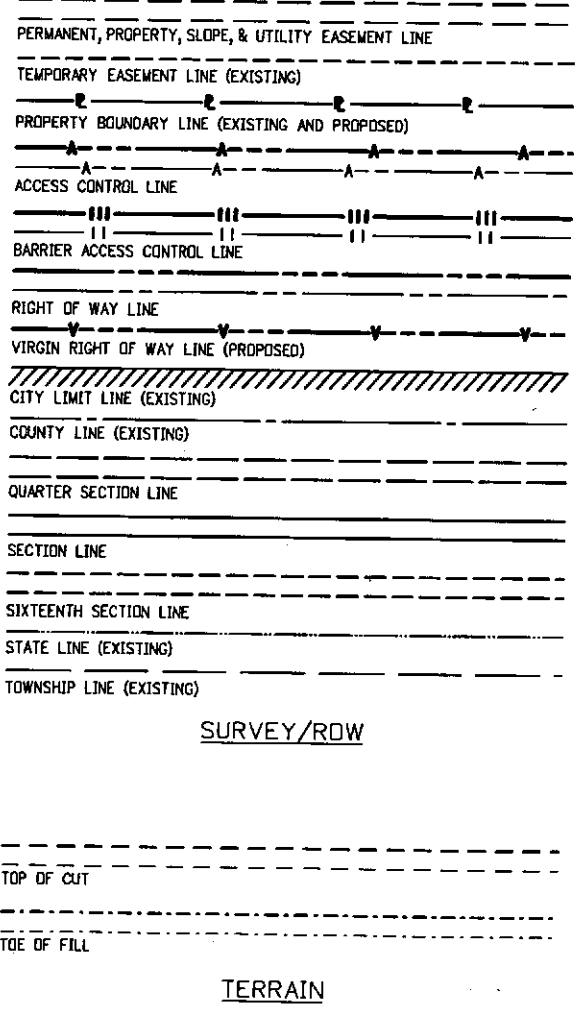
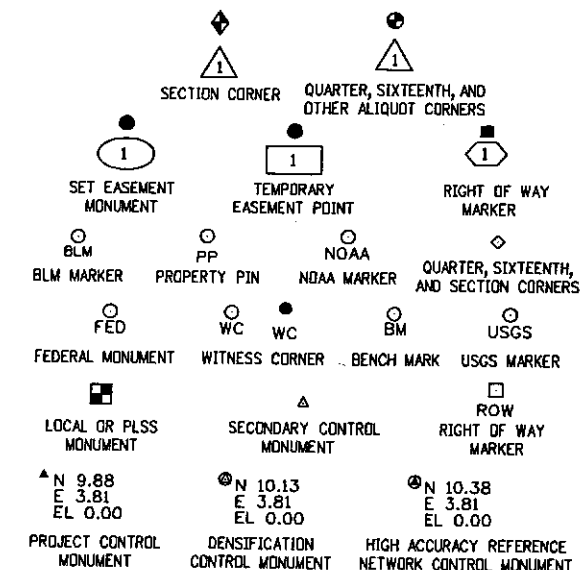

PROJECT LOCATION MAP

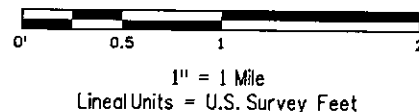

Note: For a complete listing of symbology used within this set of plans, please refer to the M-100-1 Standard Symbols of the Colorado Department of Transportation M&S Standards Publication dated July 2006.

Project Location  
 M.P. 28.64

SURVEYOR STATEMENT (ROW PLAN)  
 I, Michael L. Bouchard, a professional land surveyor licensed in the State of Colorado, do hereby state to the Colorado Department of Transportation that based upon my knowledge, information and belief, research, calculations and evaluation of the survey evidence were performed and this Right-of-Way Plan was prepared under my responsible charge in accordance with applicable standards of practice defined by Colorado Department of Transportation publications. This statement is not a guaranty or warranty, either expressed or implied.  
 PLS No. 24941

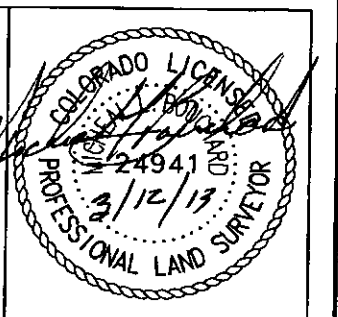

FILING CERTIFICATION: DEPOSITED THIS DAY OF AT IN BOOK OF THE COUNTY LAND SURVEYS/RIGHT OF WAY SURVEYS AT PAGE RECEPTION NUMBER  
 3/5/2013 8:03:09 AM P:\2012\0121031.00-R-5 NPS 2012\0121031.03 - US491 Cortez Culvert\18756\RDW\_Survey\Drawings\18756SURV\_ThisSheet.dgn DEPT.

Sheet Revisions			Sheet Revisions		
Date	Description	Initials	Date	Description	Initials

Project Control Diagram			
Title Sheet			
Project Number: C 4912-002			
Project Location: US 491 MP 28.64			
PRIORITY CULVERT			
Project Code:	Last Mod. Date:	Subset:	Sheet No.:
18756	02-21-13	3.01 of 3.03	3.01

# DEPARTMENT OF TRANSPORTATION STATE OF COLORADO

SHEET NO.	INDEX OF SHEETS
3.01	(1) Title Sheet
3.02	(1) Coordinate Tables
3.03	(1) Plan Sheet
(3) Total Sheets	

## PROJECT CONTROL DIAGRAM

US Highway 491 MP 28.64  
 Section 15  
 Township 36 North, Range 16 West  
 of the N.M. Principle Meridian  
 County of Montezuma

**Basis of Bearings:** Bearings used in the calculations of coordinates are based on a grid bearing of N15° 37'54"W from CM-MP 29.01, a 3 1/4" brass cap, State Highway Department Right-of-Way Marker FAP 269-D 135+00, to CM-MP 29.48, a CDDT Type II monument marked appropriately for its milepost location and control position. The survey data was obtained from a Global Positioning System (GPS) survey based control formerly set by CDDT on Project No. NH 4912-001.

**Basis of Elevations:** Project elevations are based on NGS Bench Mark CEZ C, PID: AA9894, a standard stainless steel rod in logo box, with a NAVD 88 elevation of 5921.032ft. CEZ C is a First Order Class II Benchmark, as shown on existing CDDT Project Control Diagram Sheet, Project Number NH 4912-001, Project code 17636, dated 5-15-10.

**COORDINATE DATUM:** Project coordinates are modified Colorado State Plane Southern Zone NAD '83(92) coordinates in U.S. Survey Feet. To convert Project Coordinates to meters, add the "Northing Reduction" and "Easting Reduction". Then, subtract the "Seed Point" northing and easting, divide by the "Ground Scale Factor", then add back to the "Seed Point" northing and easting.

**PROJECT COORDINATE SUMMARY:**  
 Project Latitude: 37° 23' 08.80136"N  
 Project Longitude: 108° 36' 38.74318"W  
 Project Ellipsoid Height: 1880.046m  
 Project Elevation: 1899.641m  
 Coordinate System: US State Plane 1983 (at ground)  
 Coordinate Zone: Colorado South 0503  
 Coordinate Datum: NAD 1983 (Conus)  
 Ground Scale Factor: 1.0003185798  
 Northing Reduction: 300000.000m  
 Easting Reduction: 600000.00m  
 Seed Point Northing: 389196.948  
 Seed Point Easting: 638970.444

**NOTICE:** According to Colorado law you must commence any legal action based upon any defect in this survey within three years after you first discover such defect. In no event may any action based upon any defect in this survey be commenced more than ten years from the date of the certification shown hereon.

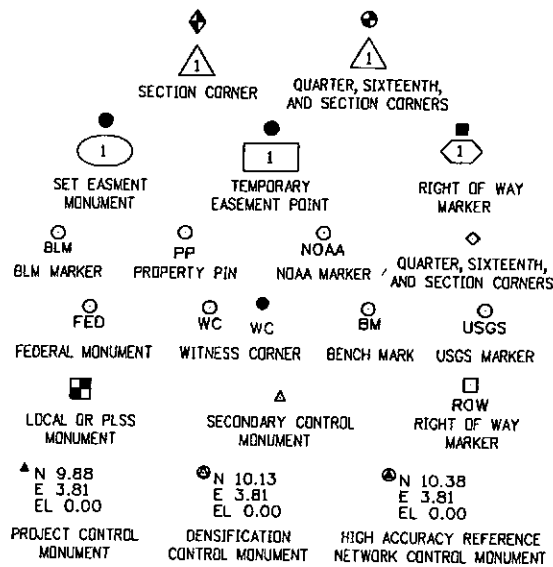

Note: For a complete listing of symbolology used within this set of plans, please refer to the M-100-1 Standard Symbols of the Colorado Department of Transportation M&S Standards Publication dated July 2006.

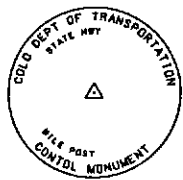

Typical Control Monument Cap  
Not to Scale

▲ CM-MP - Control Point Monuments set by CDDT. They are CDDT Type 2 monuments, a 3/4" dia. aluminum control monument cap (as shown) on a 3' x 3/4" dia. aluminum security rod on a 3' x 3/4" dia. smooth aluminum rod.

**General Notes:**

1. This Project Control Diagram is not a boundary survey of the adjoining property and is prepared for the Colorado Department of Transportation purposes only.
2. This plan set is subject to change and may not be the most current set. It is the user's responsibility to verify with CDDT that this set is the most current. The information contained on the attached drawing is not valid unless this copy bears an original signature of the Professional Land Surveyor hereon named.
3. Refer to the M-629-1 Survey Monuments of the Standard Plans dated July, 2006 found in The Colorado Department of Transportation, M & S Standards for typical survey monument descriptions.

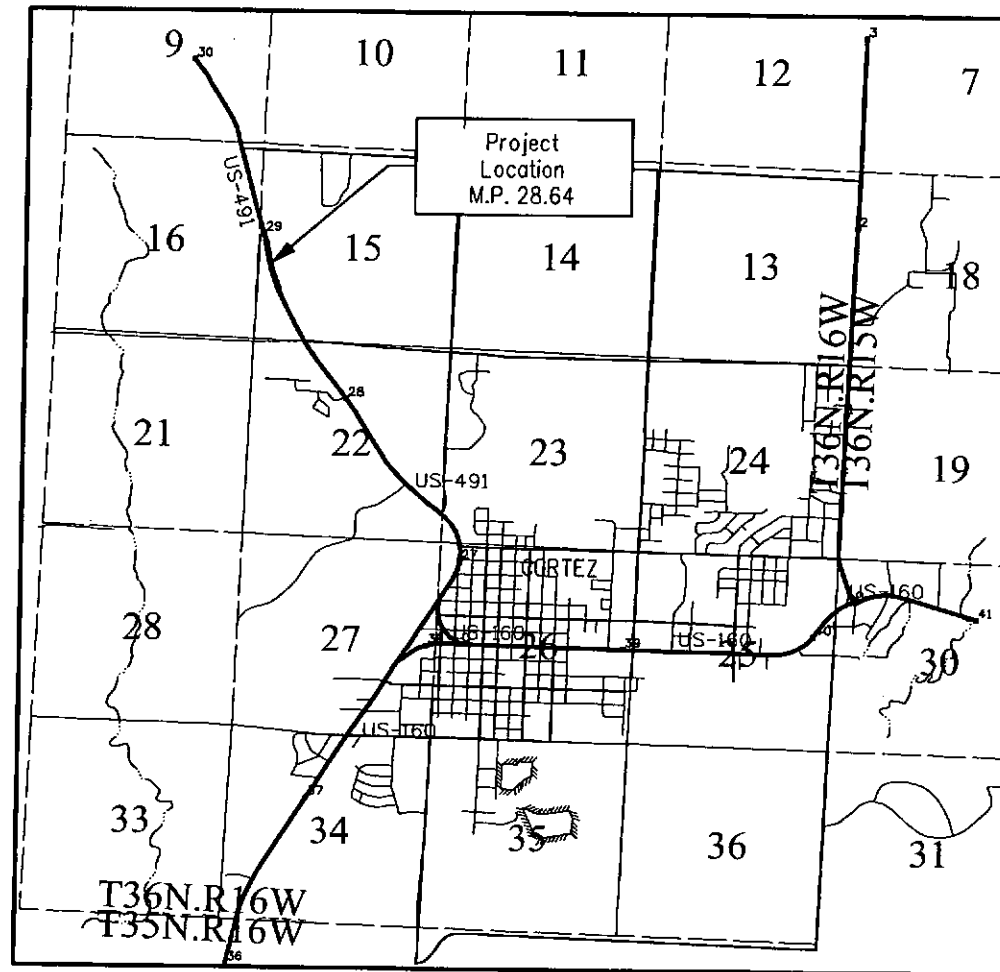

PROJECT LOCATION MAP

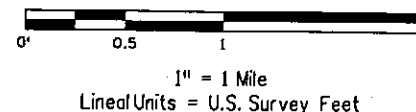

**SURVEYOR STATEMENT (PROJECT CONTROL DIAGRAM)**

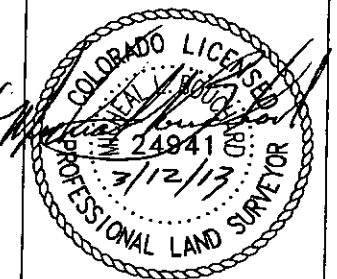

I, Michael L. Bouchard, a professional land surveyor licensed in the State of Colorado, do hereby state to the Colorado Department of Transportation this Project Control Diagram was prepared and the field survey it represents was performed under my responsible charge and, based upon my knowledge, information and belief is in accordance with applicable standards of practice defined by Colorado Department of Transportation publications. This statement is not a guaranty or warranty, either expressed or implied.

PLS No. 24941





Sheet Revisions			Sheet Revisions		
Date	Description	Initials	Date	Description	Initials

Project Control Diagram			
Monumentation Sheet			
Project Number: C 4912-002			
Project Location: US 491 MP 28.64			
PRIORITY CULVERT			
Project Code:	Last Mod. Date:	Subset:	Sheet No.:
18756	02-21-13	3.02 of 3.03	3.02

CHARN GEODETIC COORDINATE SUMMARY TABLE									
Point No.	Geodetic Coordinates NAD-83(92) (CHARN)		Ellip Height (NAVD88) (m)	Ortho Height (m)	Mapping Angle	Grid Scale Factor	NAD 83(92) Zone 8503		Description
	Latitude(N)	Longitude(W)					SP Northing(m)	SP Easting(m)	
CEZ C	37°18'05.71210"N	108°37'40.75031"W	1785.027	1804.734	-1°55'07"	0.999988312	379909.371	637133.125	NGS 3/4" Stainless Steel Rod in Sleeve
U 397	37°20'53.13257"N	108°29'54.74014"W	1897.250	1828.804	-1°50'21"	0.999981152	384691.718	648769.124	NGS 3.25" Brass Cap set in Rock Outcrop

GEODETIC COORDINATE TABLE									
Point No.	Geodetic Coordinates NAD-83(92) (CHARN)		Ellip Height (NAVD88) (m)	Ortho Height (m)	Mapping Angle	Grid Scale Factor	NAD 83(92) Zone 8503		Description
	Latitude(N)	Longitude(W)					SP Northing(m)	SP Easting(m)	
2853	37°22'22.88450"N	108°36'21.82503"W	1854.472	1874.870	-1°54'19"	0.999977613	387743.52509	639343.43700	3.25" ALUMINUM CAP - CDOT TYPE 2
2864	37°22'28.04931"N	108°36'22.93663"W	1855.783	1875.380	-1°54'19"	0.999977382	387828.38200	639317.29700	3.25" ALUMINUM CAP - CDOT TYPE 2
2875	37°22'33.19442"N	108°36'26.33417"W	1860.232	1879.830	-1°54'21"	0.999977184	388089.68900	639239.02800	3.25" ALUMINUM CAP - CDOT TYPE 2
2901	37°22'46.62892"N	108°36'29.95850"W	1870.276	1889.889	-1°54'24"	0.999976689	388506.34700	639163.67300	3.25" BRASS CAP IN CONCRETE
2927 Reset	37°22'59.04401"N	108°36'36.42708"W	1880.126	1899.712	-1°54'28"	0.999978197	388894.41100	639017.37500	3.25" ALUMINUM CAP - CDOT TYPE 2
2948	37°23'08.88136"N	108°36'38.74318"W	1880.046	1899.641	-1°54'29"	0.999975828	389196.94800	638970.44400	3.25" ALUMINUM CAP - CDOT TYPE 2
2962 Reset	37°23'15.91811"N	108°36'42.16476"W	1879.305	1898.899	-1°54'31"	0.999975561	389419.82400	638893.62700	3.25" ALUMINUM CAP - CDOT TYPE 2
2980	37°23'23.15911"N	108°36'50.80630"W	1878.518	1898.112	-1°54'36"	0.999975290	389648.55900	638708.28400	3.25" ALUMINUM CAP - CDOT TYPE 2



PROJECT COORDINATE TABLE				
Point No.	Project Coordinates		Elev(ft) (NAVD88)	Description
	Northing(ft)	Easting(ft)		
2853	287870.36	129079.65	6148.51	Set 3.25" Alum. Cap on Alum. Rod Flush w/ Ground - CDOT Control Monument Mile Post 28.53
2864	288477.64	128993.86	6152.82	Set 3.25" Alum. Cap on Alum. Rod Flush w/ Ground - CDOT Control Monument Mile Post 28.64
2875	289006.43	128736.99	6167.41	Set 3.25" Alum. Cap on Alum. Rod Flush w/ Ground - CDOT Control Monument Mile Post 28.75
2901	290373.85	128489.68	6200.41	Found 3.25" Brass Cap in Conc. - State Highway Dept. ROW Marker 135+00
2927RESET	291647.46	128009.51	6232.64	Found 3.25" Alum. Cap Flush w/ Ground - CDOT Control Monument "RESET" Mile Post 29.27
2948	292640.32	127855.53	6232.40	Found 3.25" Alum. Cap Flush w/ Ground - CDOT Control Monument Mile Post 29.48
2962RESET	293369.10	127603.46	6229.94	Found 3.25" Alum. Cap Flush w/ Ground - CDOT Control Monument "RESET" Mile Post 29.62
2980	294122.45	126995.16	6227.38	Found 3.25" Alum. Cap Flush w/ Ground - CDOT Control Monument Mile Post 29.80

2/21/2013 10:35:47 AM P:\2012\0121031\_00-R-5 NPS 2012\0121031\_03 - US491 Cortez Culvert\18756\RDW\_Survey\Drawings\18756SURV\_PCD-Coord.dgn

Colorado Department of Transportation  
 3803 North Main Avenue  
 Suite 300  
 Durango, CO 81301  
 Phone: 970-385-1400 FAX: 970-385-8365  
 Region 5 TCJ

Sheet Revisions		
Date	Description	Initials

Sheet Revisions		
Date	Description	Initials

**Farnsworth**  
 GROUP  
 ENGINEERS  
 ARCHITECTS  
 SURVEYORS  
 SCIENTISTS  
 4755 Forge Road, Suite 150  
 Colorado Springs, CO 80907  
 (719) 590-9194 / (719) 590-9111 Fax  
 www.f-w.com

Project Control Diagram			
Plan Sheet			
Project Number: C 4912-002			
Project Location: US 491 MP 28.64			
PRIORITY CULVERT			
Project Code:	Last Mod. Date	Subset	Sheet No.
18756	02-21-13	3.03 of 3.03	3.03

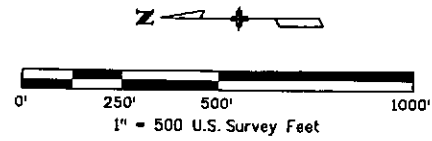

Sec 10  
 T-36-N  
 R-16-W  
 N.M.P.M.

Sec 15  
 T-36-N  
 R-16-W  
 N.M.P.M.

TO CO-184  
 2980

Sec 9  
 T-36-N  
 R-16-W  
 N.M.P.M.

Sec 16  
 T-36-N  
 R-16-W  
 N.M.P.M.

2962RESET

2948

2927RESET

2901

U.S. 491

2875

2864

2853

TO CORTEZ

2/21/2013 10:36:37 AM P:\2012\0121031.00-R-5 NPS 2012.0121031.03 - US491 Cortez Culvert\18756\ROW\_Survey\Drawings\18756SURV\_PCD-Plan01.dgn

Sheet Revisions			Sheet Revisions		
Date	Description	Initials	Date	Description	Initials

Land Survey Control Diagram			
Title Sheet			
Project Number: C 4912-002			
Project Location: US 491 MP 28.64			
PRIORITY CULVERT			
Project Code:	Last Mod. Date:	Subset:	Sheet No.:
18756	02-21-13	4.01 of 4.03	4.01

# DEPARTMENT OF TRANSPORTATION STATE OF COLORADO LAND SURVEY CONTROL DIAGRAM

US Highway 491 MP 28.64  
 Section 15  
 Township 36 North, Range 16 West  
 of the N.M. Principle Meridian  
 County of Montezuma

SHEET NO.	INDEX OF SHEETS
4.01	(1) Title Sheet
4.02	(1) Monument Coordinate Tables
4.03	(1) Plan Sheet
(3) Total Sheets	

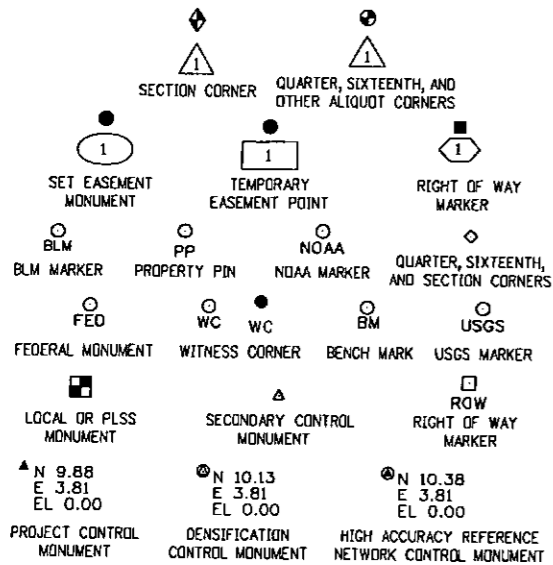

Note: For a complete listing of symbology used within this set of plans, please refer to the M-100-1 Standard Symbols of the Colorado Department of Transportation M&S Standards Publication dated July 2006.

General Notes:

1. This Land Survey Control Diagram is not a boundary survey of the adjoining property and is prepared for the Colorado Department of Transportation purposes only. No determination has been made to determine if the found monuments as shown are in their proper position or if they are at the corners they are intended to monument.
2. Easements, rights, and restrictions of record were not researched and are not shown on this diagram. The verification of the physical evidence with relation to easements, rights of ways, property boundaries, and restrictions, as described in the instruments of record, were not included in this control survey.
3. This plan set is subject to change and may not be the most current set. It is the user's responsibility to verify with CDDT that this set is the most current. The information contained on the attached drawing is not valid unless this copy bears an original signature of the Professional Land Surveyor hereon named.
4. Refer to the M-629-1 Survey Monuments of the Standard Plans dated July, 2006 found in The Colorado Department of Transportation, M & S Standards for typical survey monument descriptions.
5. All Coordinates listed are Project Coordinates only. Coordinates are carried out to two decimal places for calculation purposes and do not represent survey precisions. Survey meets CDDT "B" order precision.

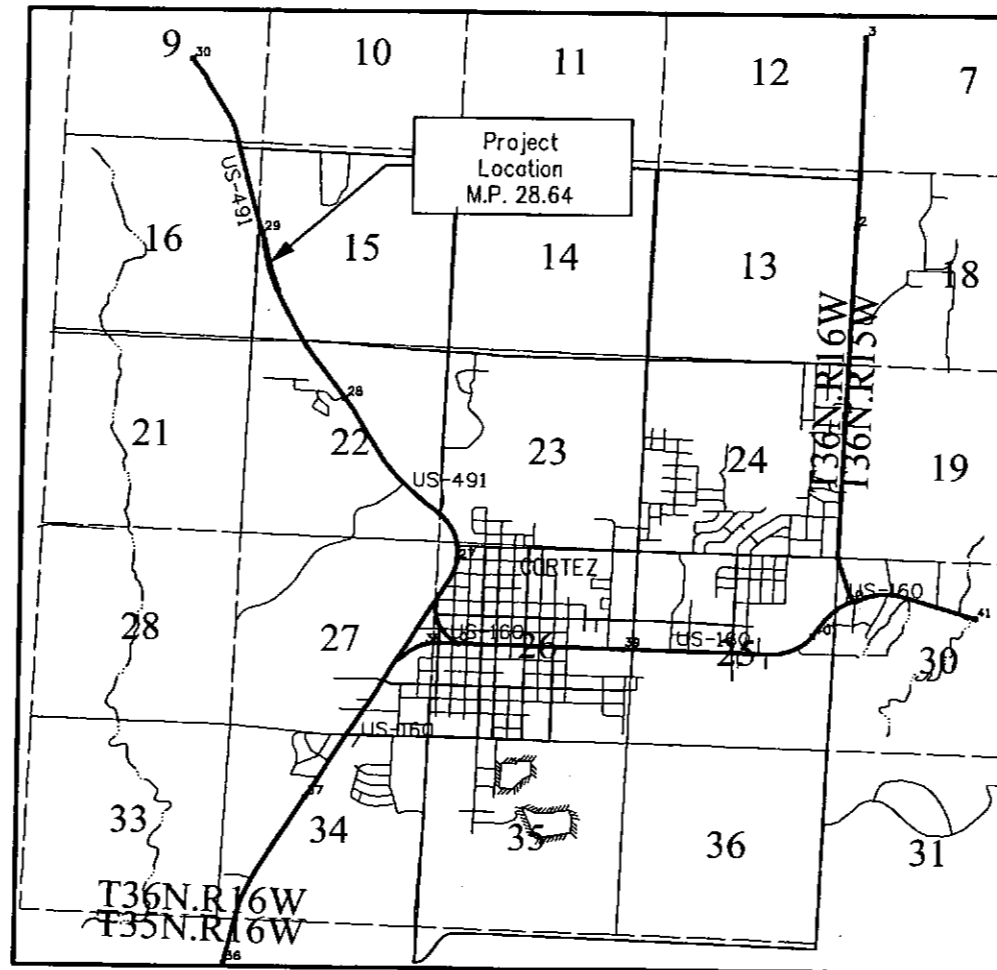

PROJECT LOCATION MAP

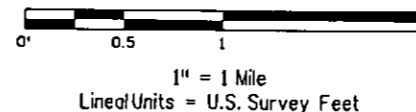

Basis of Bearings: Bearings used in the calculations of coordinates are based on a grid bearing of N15°37'54"W from CM-MP 29.01 to CM-MP 29.48. The survey data was obtained from a Global Positioning System (GPS) survey based control formerly set by CDDT on Project No. NH 4912-001.

NOTICE: According to Colorado law you must commence any legal action based upon any defect in this survey within three years after you first discover such defect. In no event may any action based upon any defect in this survey be commenced more than ten years from the date of the certification shown hereon.

SURVEYOR STATEMENT (LAND SURVEY CONTROL DIAGRAM)

I, Michael L. Bouchard, a professional land surveyor licensed in the State of Colorado, do hereby state to the Colorado Department of Transportation this Land Survey Control Diagram was prepared and the field survey it represents was performed under my responsible charge and, based upon my knowledge, information and belief is in accordance with applicable standards of practice defined by Colorado Department of Transportation publications. This statement is not a guaranty or warranty, either expressed or implied.

PLS No. 24941

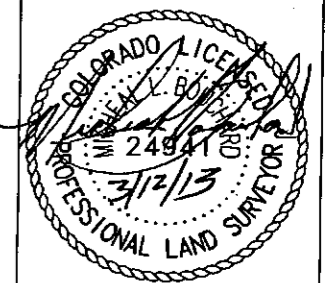

FILING CERTIFICATION: DAY OF 20 AT M. DEPOSITED THIS OF THE COUNTY LAND SURVEYS/RIGHT OF WAY SURVEYS AT PAGE RECEPTION NUMBER DEPT. SIGNED: Cortez Culvert\18756\ROW\_Survey Drawings\18756\SURV\_LSCD-Title.dgn

Sheet Revisions		
Date	Description	Initials

Sheet Revisions		
Date	Description	Initials

◇

FOUND ALIQUOT MONUMENT COORDINATE TABLE			
Point No.	Northing(ft)	Easting(ft)	Description
60116	287297.12	128190.36	Found 1.5" ALUM. CAP FLUSH W/ PAVEMENT - Not Legible

□  
ROW

FOUND R.O.W. MONUMENT COORDINATE TABLE (Controlling)			
Point No.	Northing(ft)	Easting(ft)	Description
10645	288028.51	128970.61	Found 1.5" Alum. Cap on 5/8" Rebar 0.3' Above Ground - Colo Div of Hwys ROW 111+34
10647	288674.28	128790.05	Found 1.5" Alum. Cap on 5/8" Rebar 0.3' Above Ground - Colo Div of Hwys ROW 118+00
10648	288719.67	128957.22	Found 1.5" Alum. Cap on 5/8" Rebar 0.3' Above Ground - Colo Div of Hwys ROW 118+00
2901	290373.90	128489.53	Found 3.25" Brass Cap in Conc. Flush w/ Ground - State Hwy Dept ROW Marker 135+00

○  
PP

FOUND BOUNDARY MONUMENT COORDINATE TABLE (Non-Controlling)			
Point No.	Northing(ft)	Easting(ft)	Description
10646	287555.51	129187.75	Found 1" Plastic Cap on 1/2" Rebar 0.4' Above Ground - LS 19612
10754	287696.08	129328.83	Found Square Bolt w/ 1/2" Rebar Alongside 0.4' Above Ground
60128	287391.91	129527.63	Found 1" Plastic Cap on 1/2" Rebar 0.4' Above Ground - LS 19612
10403	288604.87	128809.74	Found 1" Plastic Cap on 1/2" Rebar 0.4' Above Ground - LS 19612
10521	288164.57	128931.13	Found 1" Plastic Cap on 1/2" Rebar 0.4' Above Ground - LS 19612

Colorado Department of Transportation  
 3803 North Main Avenue  
 Suite 300  
 Durango, CO 81301  
 Phone: 970-385-1400 FAX: 970-385-8365  
 Region 5 TCJ

Sheet Revisions		
Date	Description	Initials

Sheet Revisions		
Date	Description	Initials

**Farnsworth**  
 GROUP  
 ENGINEERS  
 ARCHITECTS  
 SURVEYORS  
 SCIENTISTS  
 4755 Forge Road, Suite 150  
 Colorado Springs, CO 80907  
 (719) 590-9194 / (719) 590-9111 Fax  
 www.f-w.com

Land Survey Control Diagram			
Plan Sheet			
Project Number: C 4912-002			
Project Location: US 491 MP 28.64			
PRIORITY CULVERT			
Project Code:	Last Mod. Date:	Subset	Sheet No.:
18756	02-21-13	4.03 of 4.03	4.03

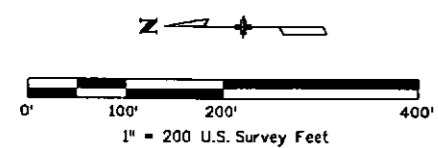

Sec15  
 T-36-N  
 R-16-W  
 N.M.P.M.

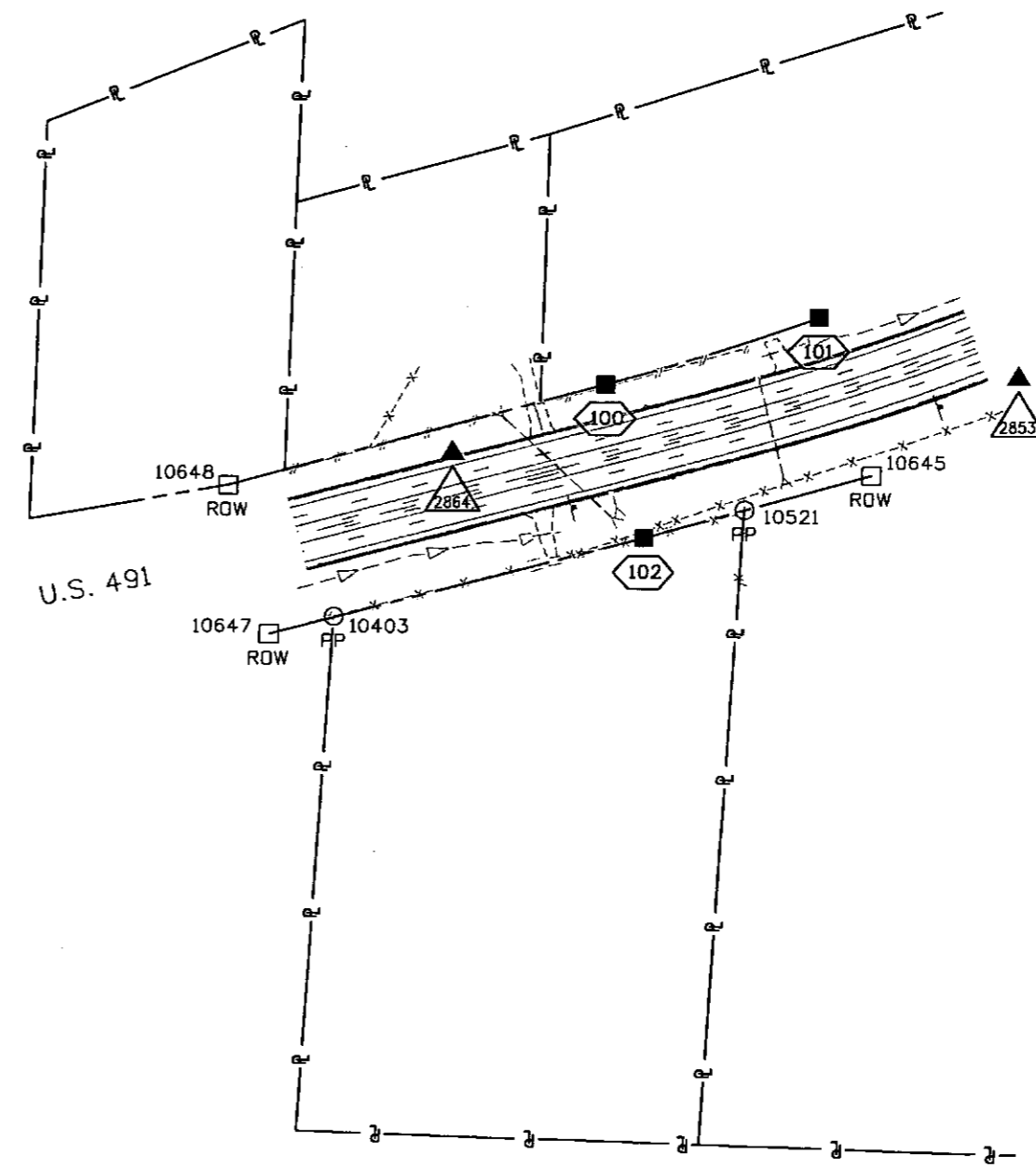

2/21/2013 10:39:18 AM P:\2012\0121031.00-R-5 NPS 2012\0121031.03 - US491 Cortez Culvert\18756SURV\_LSCD-Plan01.dgn

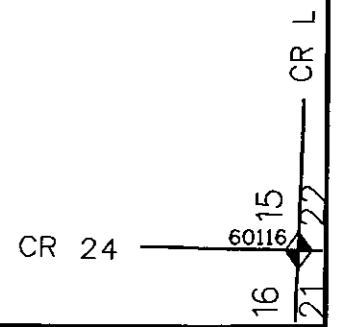

Colorado Department of Transportation  
 3803 North Main Avenue  
 Suite 300  
 Durango, CO 81301  
 Phone: 970-385-1400 FAX: 970-385-8365  
 Region 5 TCJ

Sheet Revisions		
Date	Description	Initials

Sheet Revisions		
Date	Description	Initials

**Farnsworth GROUP**  
 ENGINEERS ARCHITECTS SURVEYORS SCIENTISTS  
 4755 Forge Road, Suite 150  
 Colorado Springs, Colorado 80907  
 (719) 590-9194 / (719) 590-9111 Fax  
 www.f-w.com

Right of Way Plans Monumentation Sheet			
Project Number: C 4912-002			
Project Location: US 491 MP 28.64			
PRIORITY CULVERT			
Project Code:	Last Mod. Date	Subset	Sheet No.
18756	02-21-13	5.01 of 5.01	5.01



TABULATION OF R.O.W. MONUMENTS TO BE SET					
Point No.	Northing(ft)	Easting(ft)	Description	Station	Offset
100	288316.12	129071.31	Set CDOT Type I Aluminum Cap Stamped PLS 24941		
101	288086.63	129147.01	Set CDOT Type I Aluminum Cap Stamped PLS 24941		
102	288273.36	128899.13	Set CDOT Type I Aluminum Cap Stamped PLS 24941		

1. This Right-of-Way Plan is not a boundary survey of the adjoining property and is prepared for the Colorado Department of Transportation purposes only.
2. For title information, Farnsworth Group Inc. relied on Title Commitment prepared by H.C. Peck & Associates, Inc.
3. This plan set is subject to change and may not be the most current set. It is the user's responsibility to verify with CDOT that this set is the most current. The information contained on the attached drawing is not valid unless this copy bears an original signature of the Professional Land Surveyor hereon named.
4. This right-of-way survey meets the minimum accuracy tolerances for CDOT Class B - Secondary as defined in Chapter 5 of the CDOT Survey Manual, dated Nov. 2011.

QUANTITY OF MONUMENTS TO BE SET

CAP TYPE	MONUMENT TYPE									
	1	1A	2	2A	3	3A	4	5	5(S)	6
REFERENCE										
ROW	3									
CONTROL										
ALIQUDT CORNER										
PERMANENT EASEMENT										
PROJECT POINTS										
WITNESS POST (REQUIRED)										

General Notes:

1. This Right-of-Way Plan is not a boundary survey of the adjoining property and is prepared for the Colorado Department of Transportation purposes only.
2. For title information, Farnsworth Group Inc. relied on Title Commitment prepared by H.C. Peck & Associates, Inc.
3. Right-of-Way established using control shown on the Land Survey Control Diagram, and the coordinates are specific to this project.
4. All centerline and offset stationing may not represent the centerline as constructed in the field.
5. Refer to the M-629-1 Survey Monuments of the Standard Plans dated July 4, 2006 found in The Colorado Department of Transportation, M & S Standards for survey monument descriptions.
6. This plan set is subject to change and may not be the most current set. It is the user's responsibility to verify with CDOT that this set is the most current. The information contained on the attached drawing is not valid unless this copy bears an original signature of the Professional Land Surveyor hereon named.

Note: Type I monuments are 3/4" aluminium caps with magnet set on a 3/4" X 36" aluminium finned rod, per CDOT Standard Plan No. M-629-1 for Survey Monuments, issued July, 2012.

NOTICE: According to Colorado law you must commence any legal action based upon any defect in this survey within three years after you first discover such defect. In no event may any action based upon any defect in this survey be commenced more than ten years from the date of the certification shown hereon.

<p align="center">SURVEYOR STATEMENT (R.O.W. MONUMENTS)</p> <p>I, <u>Michael L. Bauchard</u>, a professional land surveyor licensed in the State of Colorado, do hereby state to the Colorado Department of Transportation that based upon my knowledge, information and belief, adequate research, calculations and evaluation of survey evidence were performed and the Right-of-Way monuments depicted on this Right-of-Way Plan were set under my responsible charge in accordance with applicable standards of practice defined by Colorado Department of Transportation publications. This statement is not a guaranty or warranty, either expressed or implied.</p> <p>PLS No. 24941</p>	
---	--

