

# STATE DEPARTMENT OF HIGHWAYS DIVISION OF HIGHWAYS—STATE OF COLORADO

FEDERAL ROAD REGION NO.	DIVISION	PROJECT NO.	SHEET NO.
VIII	COLORADO	DPFC 050-2 (5) Sec. I	1

  

RIGHT OF WAY W. SIDE OF CERRO SUMMIT		REVISIONS	
		6-14-77 Add Construction Sta.	T.G.
		9-26-77 Add Sec. I to Proj	G.M.
		11-15-79 Change Const. End Sta.	D.A.Z.

TITLE SHEET  
1-123  
DEC 1977  
Rec.  
Dist. II  
R.O.W.  
D.O.H.



## CONVENTIONAL SIGNS

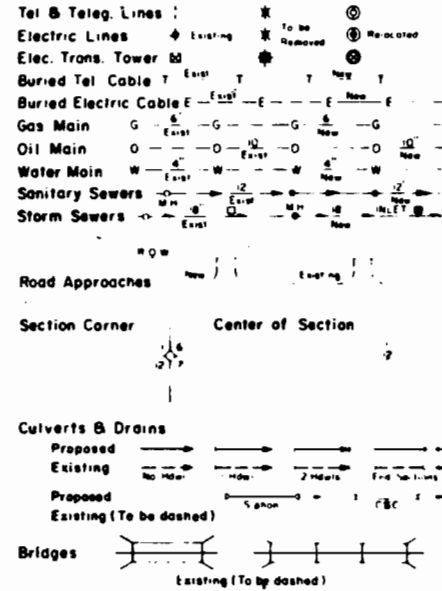
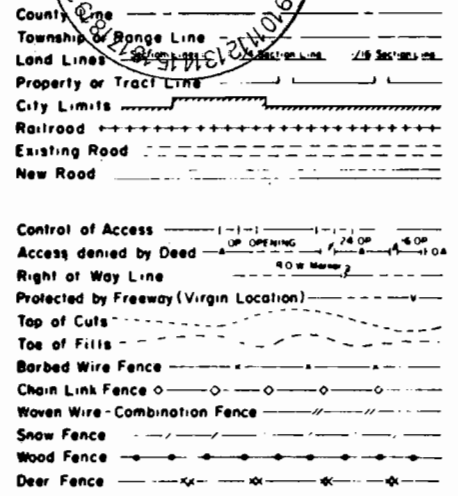

## PLAN AND PROFILE OF PROPOSED FEDERAL AID PROJECT NO. DPFC 050-2 (5) Sec. I STATE HIGHWAY NO. 50 MONTROSE COUNTY RIGHT OF WAY

SCALE OF ORIGINAL DRAWINGS  
PLAN SHEETS 1" = 100'  
DETAIL SHEETS 1" = 100'  
OWNERSHIP MAPS 1" = 200'

### INDEX OF SHEETS

SHEET NO.	TITLE SHEET
1	TITLE SHEET
2	TABULATION OF PROPERTIES SHEET
3-7	ALIGNMENT SHEETS
8-10	TOTAL OWNERSHIP SHEETS

ROW LENGTH OF PROJECT = 2.662 MILES

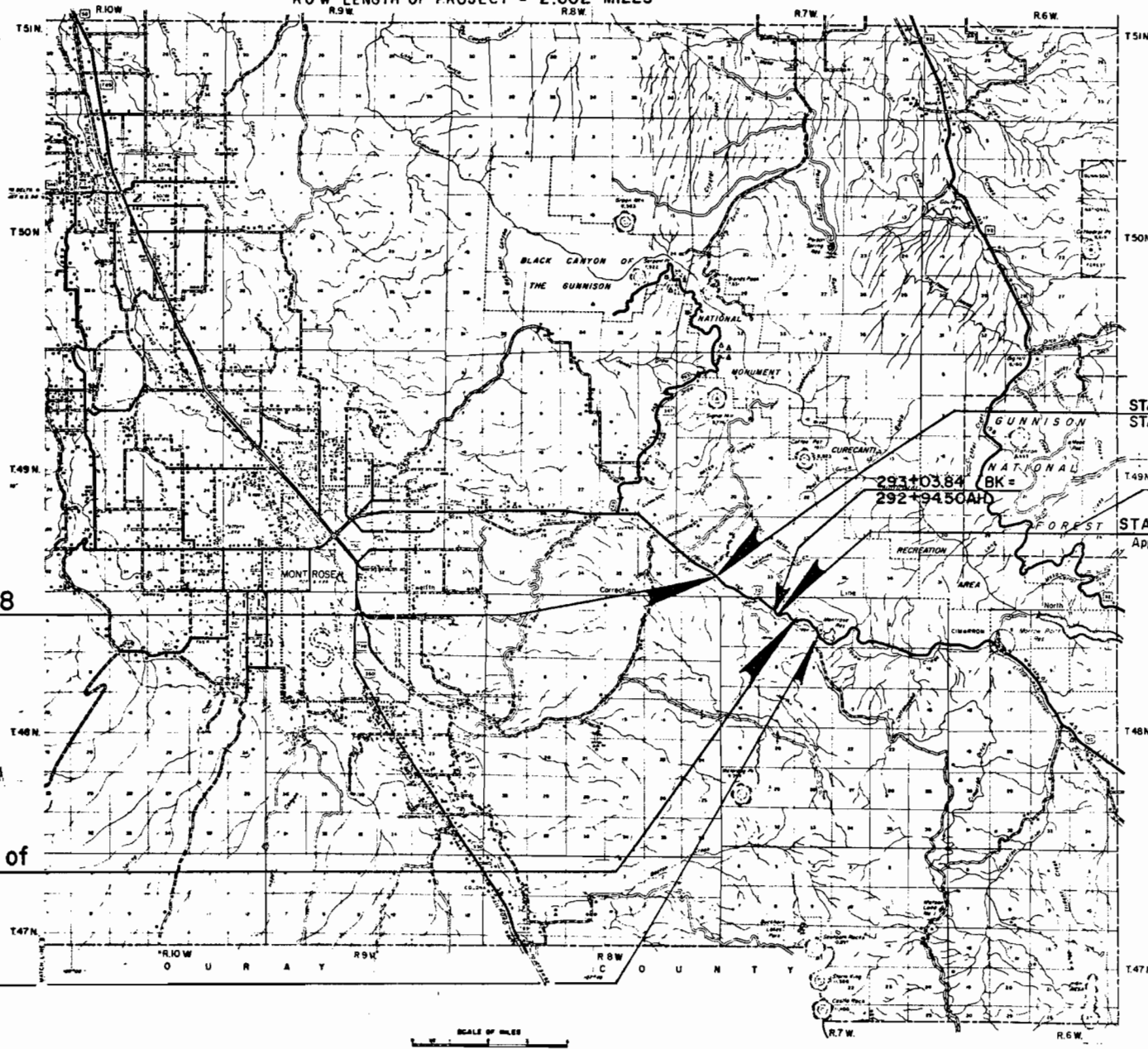

**BEGIN R.O.W. PROJ. DPFC 050-2 (5) Sec. I P.O.S.T. 193+22.8**  
STA. 462+58.2 on R.O.W. PROJ. F 021-1(5)

**END R.O.W. PROJ. DPFC 050-2 (5) Sec. I P.O.S.T. 256.0' Ah. of**  
P.I. 331+28.4 = STA. 320+55.4 on R.O.W. PROJ. F 021-1(5)

364+50 R.O.W. DPFC 050-2(5) =  
364+50 END CONST. DPFC 050-2(II) =  
289+029 ON ROW PROJECT F-258(12)

DIVISION OF HIGHWAYS

APPROVED: *[Signature]* 1/14/77  
CHIEF ENGINEER DATE

DEPARTMENT OF TRANSPORTATION  
FEDERAL HIGHWAY ADMINISTRATION

APPROVED: \_\_\_\_\_ DATE \_\_\_\_\_  
DIVISION ADMINISTRATOR