

FEDERAL ROAD DIVISION NO.	DISTRICT	PROJ. NO.	SHEET NO.	TOTAL SHEETS
5	COLORADO	DU 005-4(8)	1	

# COLORADO DEPARTMENT OF HIGHWAYS

## PLAN AND PROFILE OF PROPOSED FEDERAL AID PROJECT NO. DU 005-4(8) STATE HIGHWAY NO. 8 CITY AND COUNTY OF DENVER

### CONVENTIONAL SIGNS

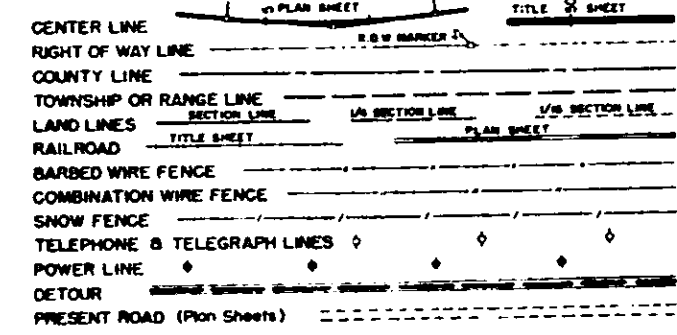

### INDEX OF SHEETS

- SHEET NO. 1 Sketch Map and Title Page
- 2-3 Typical Sections, Curb and Gutter, Driveway and Alley Details
- 4 General Notes and Tabulation of Length
- 5 Summary of Approximate Quantities
- 6 Tabulation of Surfacing
- 7 Tabulation of Curbs and Gutters
- 8 Drop Inlet Details
- 9-12 Drainage Plans
- 13 Standard Concrete Pavement Joint Details M-8-D ✓
- 14-15 Standard Roadway Construction Traffic Signs (2 Sheets) M-29-C ✓
- 16 Standard Methods of Backfill Around Structures M-60-B ✓
- 17-20 Alignment Plan and Profile
- 21 Summary of Earthwork
- 22-51 Cross Sections

#### SCALES OF ORIGINAL DRAWINGS

ON PLAN. 1 IN. = 50 FT.  
ON PROFILE. 1 IN. = 50 FT. HORIZONTAL  
1 IN. = 5 FT. VERTICAL  
GRADE LINE ON PROFILE IS SHOWN AS GRADE OF FINISHED ROAD  
GROSS LENGTH OF PROJECT 5290.5 FT. = 1.002 MILES  
NET LENGTH OF PROJECT 5290.5 FT. = 1.002 MILES

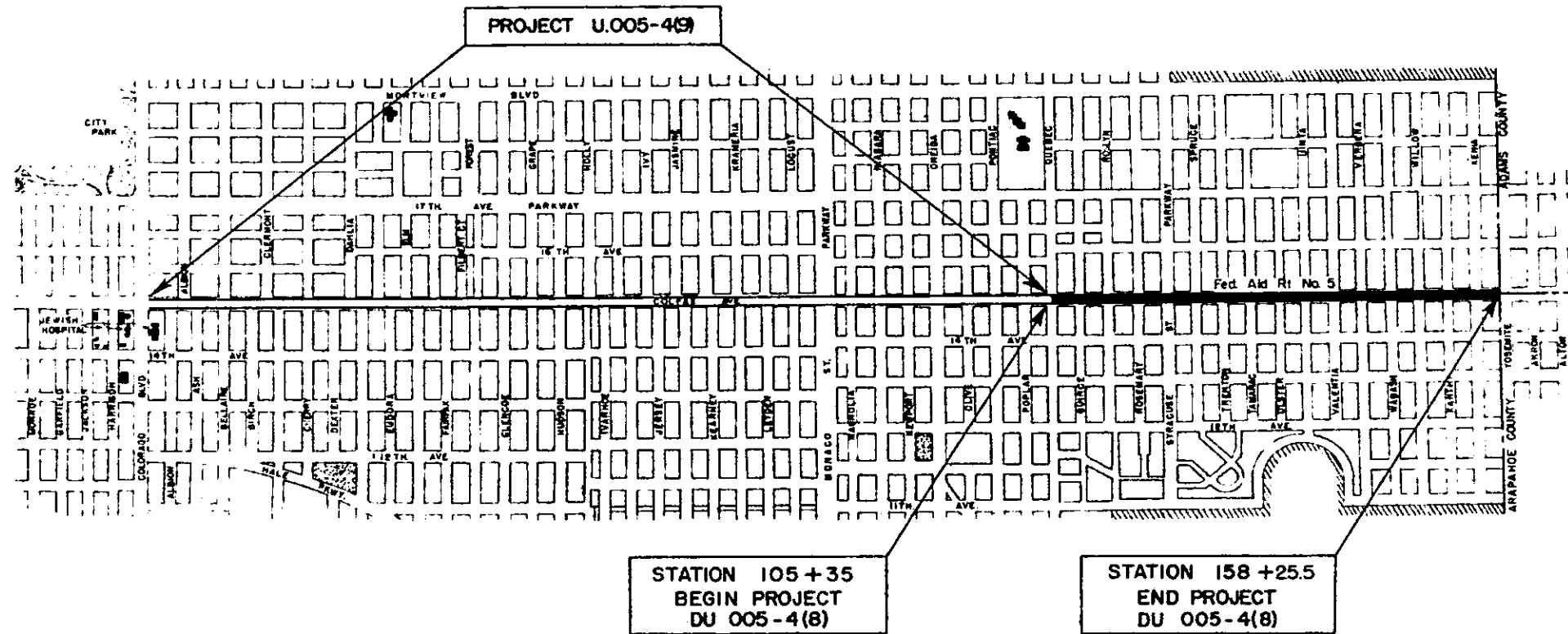

NOTICE TO BIDDERS

SEE SPECIAL PROVISION  
FOR NOTICE TO BIDDERS

COLORADO DEPARTMENT OF HIGHWAYS	
APPROVED <i>Mark H. We</i> CHIEF ENGINEER	8-21-58 DATE

DEPARTMENT OF BUREAU OF PUB	
APPROVED	DATE
DISTRICT ENGINEER	

DU 005-4(8)



Note: Alignment and grade shown on these plans are subject to modification during construction after approval by the Denver office.

FED. ROAD DIST.	DIST.	PROJ. NO.	SHEET NO.	TOTAL SHEETS
9	COLO.	DU 005-4(8)	17	

Soil data shown on the plans is obtained from best available testing laboratory information. This information is shown for convenience of the Contractor and the Department does not guarantee the accuracy of these tests. If materials not conforming to the data on plans are encountered during construction, the grading plan shown on plans will be modified where necessary to secure dense, stable embankments.

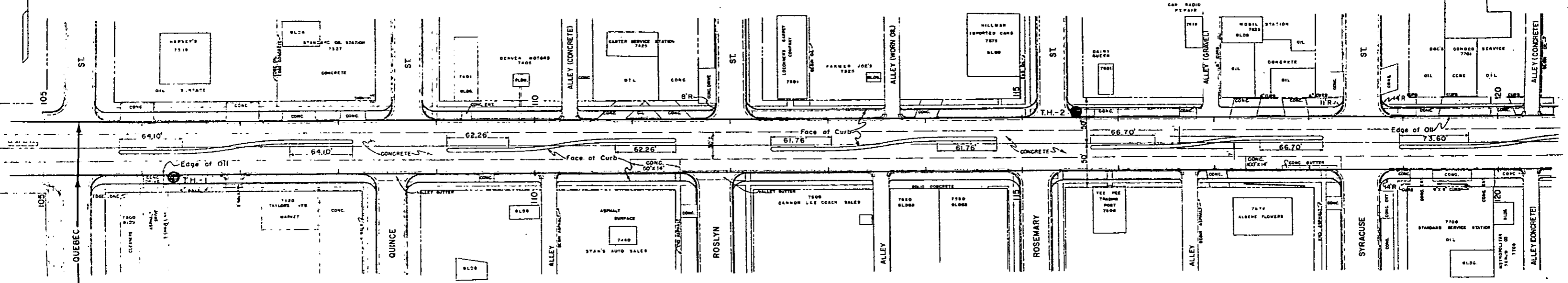

STA. 105+35.0 END PROJECT U 005-4(9)  
 BEGIN PROJECT DU 005-4(8)

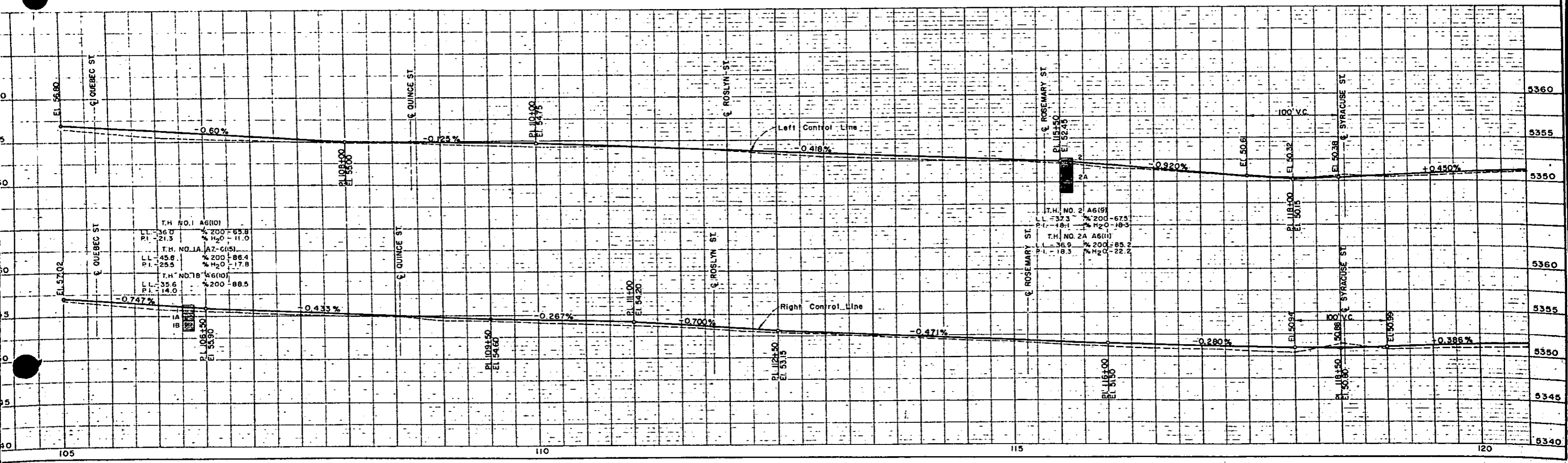



Note: Alignment and grade shown on these plans are subject to modification during construction after approval by the Denver office.

FED. ROAD DIV. NO.	DIST.	P.C.D. NO.	SHEET NO.	TOTAL SHEETS
9	COLO.	DU 005-4(8)	19	

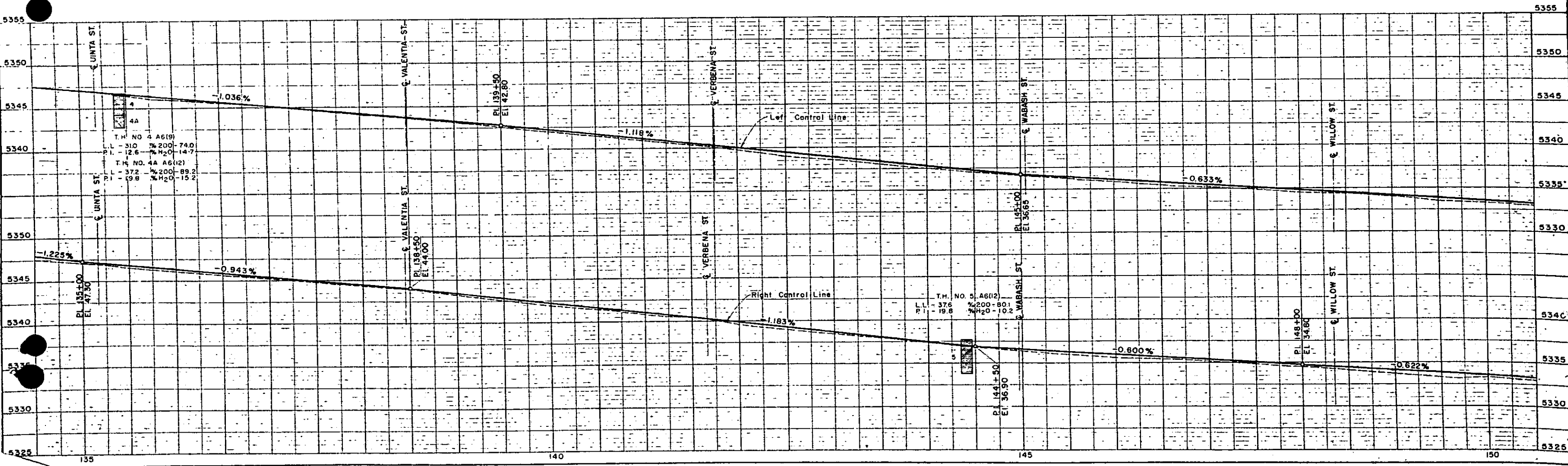
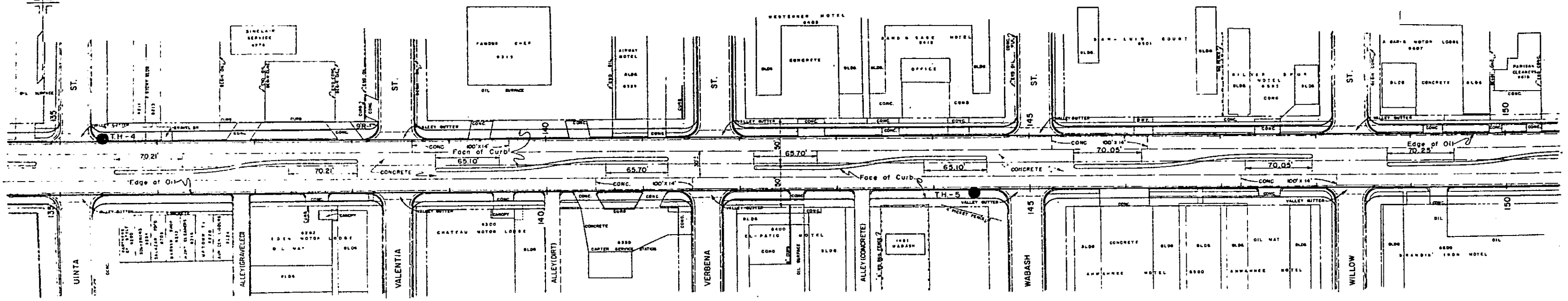

FED. ROAD DIST. NO.	DIST.	PROJ. NO.	SHEET NO.	TOTAL SHEETS
9	COLO.	DU 005-4(8)	20	

Note: Alignment and grade shown on these plans are subject to modification during construction after approval by the Denver office.

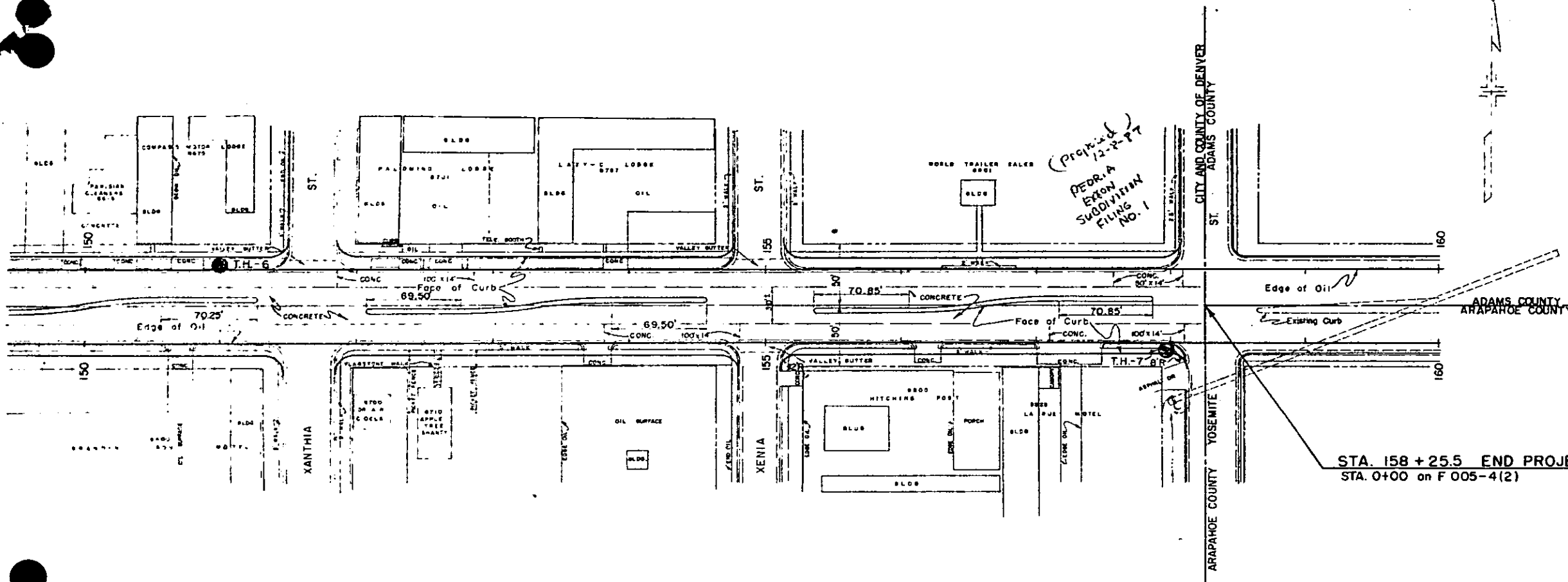

STA 158 + 25.5 END PROJECT DU 005-4(8)=  
STA. 0+00 on F 005-4(2)

