

STATE OF COLORADO
STATE HIGHWAY COMMISSION

PLAN AND PROFILE OF PROPOSED
STATE HIGHWAY

FEDERAL AID PROJECT No. 117.
EL PASO COUNTY

SCALES: PLAN 1 IN. = 100 FT.
PROFILE HOR. 1 IN. = 100 FT. VER. 1 IN. = 10'

GRADE LINE OF PROFILE IS SHOWN AS THE GRADE OF FINISHED ROAD
GROSS LENGTH OF PROJECT 4919 FT. = 0.931 MILE.
NET LENGTH OF PROJECT 4907 FT. = 0.929 MILE.

INDEX OF SHEETS

- NO. 1 TITLE PAGE
- 2 TYPICAL CROSS-SECTIONS OF IMPROVEMENT AND SUMMARY OF QUANTITIES
- 3 BRIDGE IMPROVEMENT
- 4 PLAN & PROFILE STATION 00 TO 25+00
- 5 PLAN & PROFILE STATION 25+00 TO 49+20
- 6 & 7 CROSS SECTIONS.

CONVENTIONAL SIGNS

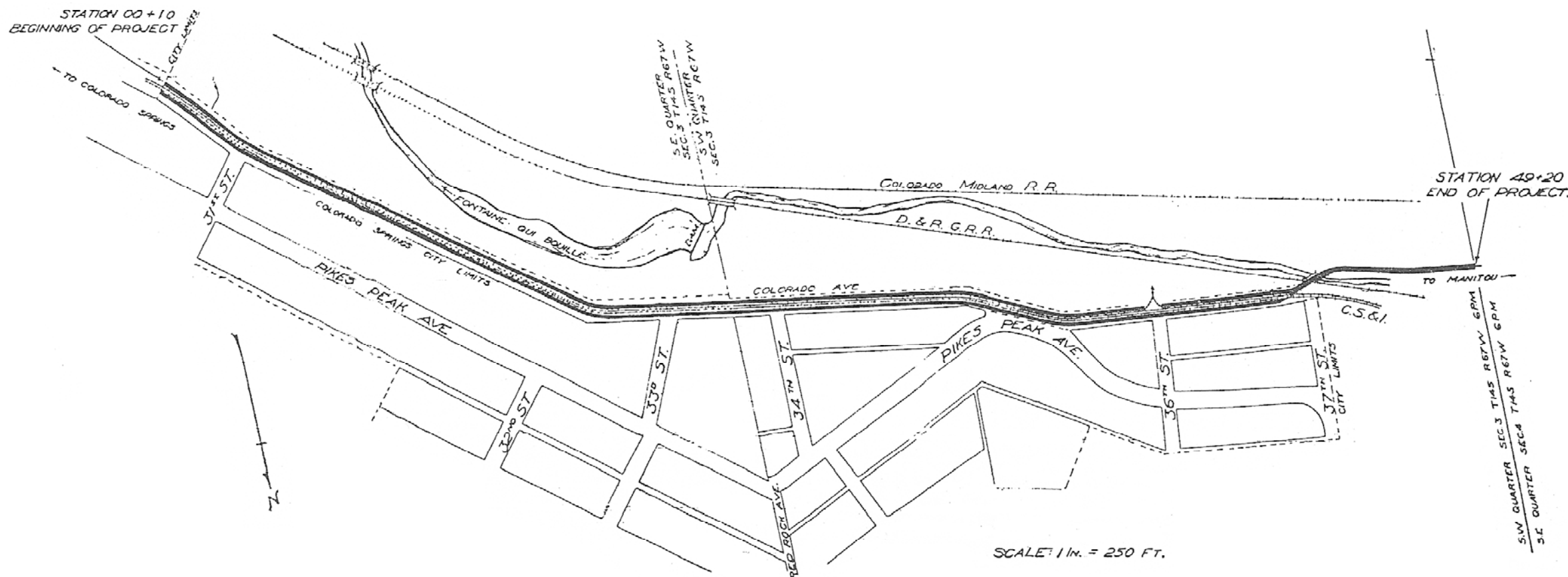
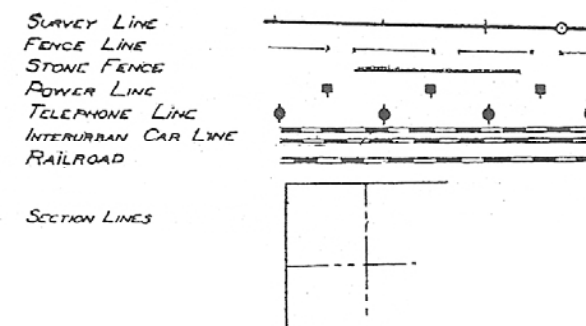

RECOMMENDED FOR APPROVAL
 [REDACTED]
 CHIEF ENGINEER Office of State Highway Commissioner
 APPROVED
 [REDACTED]
 STATE HIGHWAY COMMISSIONER
 RECOMMENDED FOR APPROVAL
 [REDACTED]
 DISTRICT ENGINEER Office of Public Roads
 RECOMMENDED FOR APPROVAL
 [REDACTED]
 CHIEF ENGINEER

