

FED. ROAD DIST. NO.	STATE	PROJ. NO.	SHEET NO.	TOTAL SHEETS
3	COLO.	FAP 351-F & E.R.P. 12	1	

COLORADO

STATE HIGHWAY DEPARTMENT

PLAN AND PROFILE OF PROPOSED FEDERAL AID PROJECT NO. 351-F AND EMERGENCY RELIEF PROJECT NO. 12 STATE HIGHWAY NO. 102 ADAMS & ARAPAHOE COUNTIES

INDEX OF SHEETS

- SHEET No. 1. SKETCH MAP AND TITLE SHEET
- 2. TYPICAL CROSS SECTION AND SUMMARY OF QUANTITIES
- 3. TABULATION OF QUANTITIES
- 4. DETAILS OF BRIDGE, STA. 911+
- 5. STANDARD CATTLE GUARD M15B
- 6. " WIRE CABLE GUARD FENCE M20G
- 7. " " FENCES WITH STEEL POSTS AND MARKER POSTS } M27A
- 8. " " STRUCTURE NUMBER LETTERING } M10A
- 9. TYPICAL SIDE APPROACH ROADS / ROADWAY CONSTRUCTION TRAFFIC SIGNS } M 2B
- 10. ALIGNMENT PLAN AND PROFILE
- 11. to 19. CROSS SECTIONS

CONVENTIONAL SIGNS

- CENTER LINE OF SURVEY 905
- RIGHT OF WAY LINES
- ONE QUARTER SECTION LINES
- SECTION LINES
- TOWNSHIP LINES
- COUNTY LINES
- BARBED WIRE FENCE
- WIRE CABLE GUARD FENCE
- POLE LINES

SCALES OF ORIGINAL TRACINGS

ON PLAN, 1 IN. = 100 FT.
ON PROFILE 1 IN. = 100 FT. HORIZONTAL
1 IN. = 10 FT. VERTICAL

GRADE LINE ON PROFILE IS SHOWN AS GRADE OF FINISHED ROAD

F.A.P. 351-F	GROSS LENGTH OF PROJECT	2800.0 FT. = 0.530 MILE
	NET LENGTH OF PROJECT	2460.58 FT. = 0.466 MILE
E.R.P. NO. 12	GROSS LENGTH OF PROJECT	339.42 FT. = 0.064 MILE
	NET LENGTH OF PROJECT	

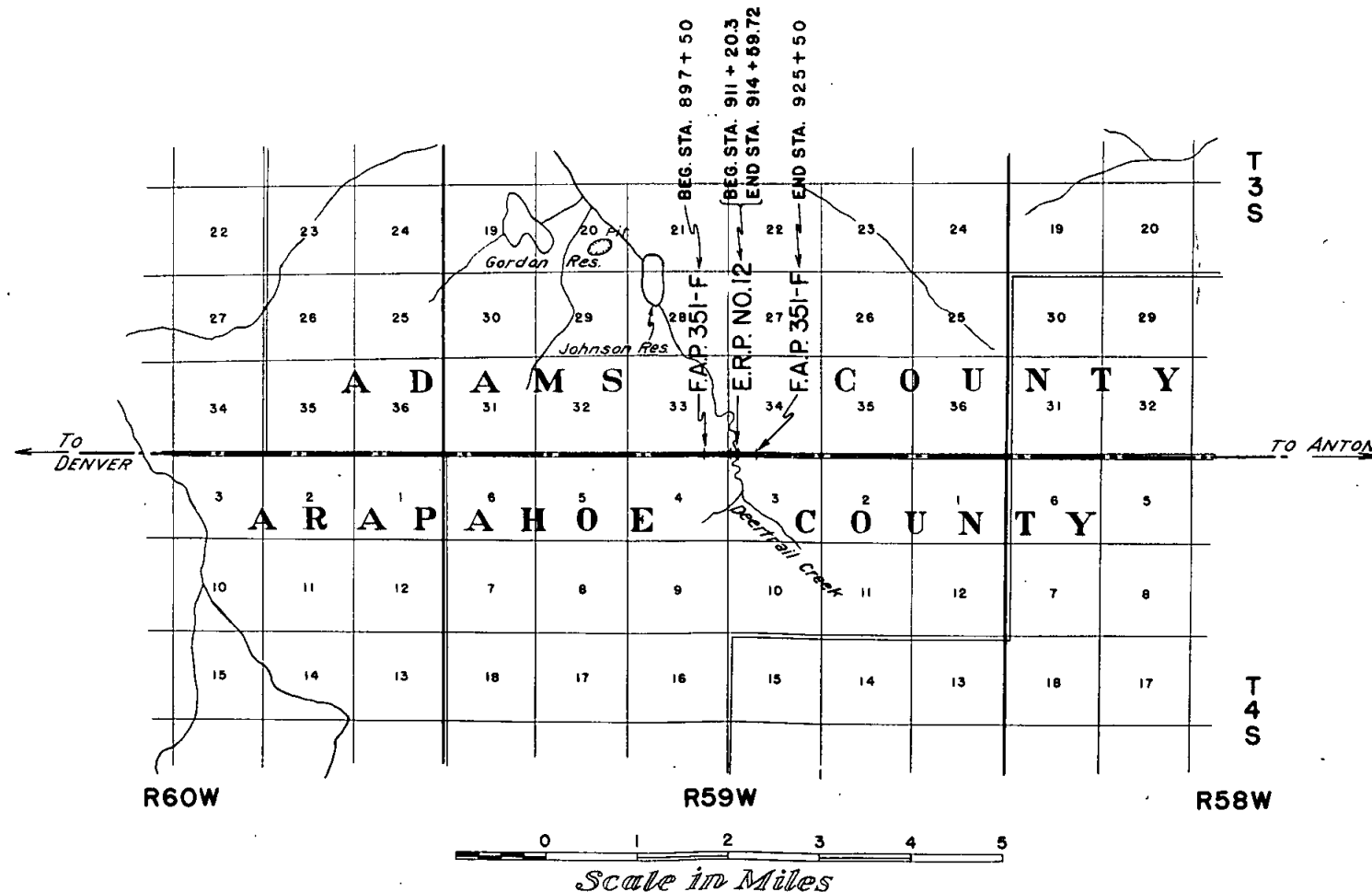

Note:-- It is recommended that bidders on this Project go over the plan details with one of the following field representatives of this department.

E.E. Montgomery, Division Engineer, located at Denver, Colo.
B.T. Miller, Resident

RECOMMENDED FOR APPROVAL 1/21/36

J. E. Montgomery
ASSISTANT ENGINEER

APPROVED
Chas. D. Vail
STATE HIGHWAY ENGINEER

RECOMMENDED FOR APPROVAL

DIST. ENG. BUREAU PUBLIC ROADS
RECOMMENDED FOR APPROVAL

CHIEF ENG. BUREAU PUBLIC ROADS
APPROVED

DIRECTOR BUREAU PUBLIC ROADS

FED. ROAD DIST. NO.	STATE	PROJ. NO.	SHEET NO.	TOTAL SHEETS
3	COLO.	F.A.P. 351-F & E.R.P. 12	10	

Sta. 901+50
Reqd. for road approaches Rt. & Lt.:
2 Driveway Gates.
200 cu. yds. embankment.
80 tons Gravel or Crushed Rock surfacing.
2-24"x32" C.M.P. side drains.
1 Cattle Guard Lt.
Remove & Rebuild 500 lin. ft. of fence.

Sta. 911+20.3 to 914+59.72
Reqd. Timber Pile Bridge - 15 spans @ 22'-6"
as per details shown on sheet No. 4.
Reqd. 34,000 cu. yds. uncl. excavation for
channel change.
Excavated material to be used as follows:
Main road embankment Sta. 902 to 911+20 17,743 cu. yds.
" " " Sta. 914+60 to 920+50 2,388 " "
Detour " " Sta. 896 to 925 4,000 " "
Filling old channel North of road 5,000 " "
" " " South " " 4,869 " "
Total 34,000 cu. yds.

Sta. 925+20
Reqd. double 36"x60" C.M.P.
cross culvert. (2-24' pcs. & 4-18' pcs.)
72 lin. ft. of this pipe to be
used temporarily in Detour.
Remove Bridge.

Sta. 925+50
Reqd. 100 cu. yds. embank.
for Road approaches Rt. & Lt.
" 24"x30" " " Lt.
" 24"x30" " " Lt.

Sta. 963+70.7
Sta. of Section Cor.

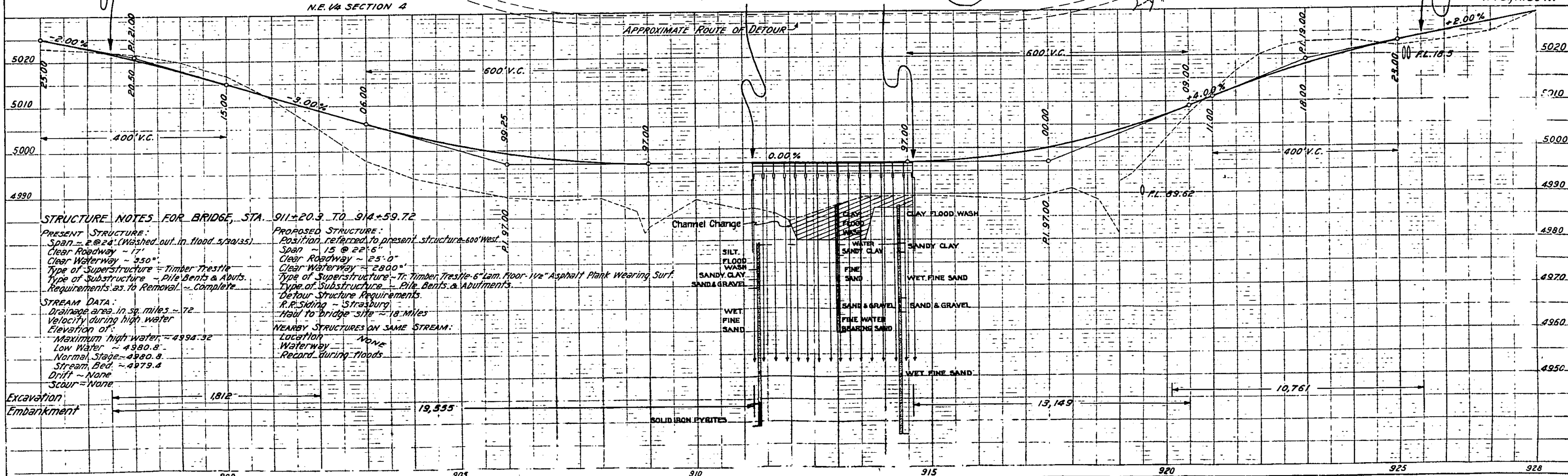
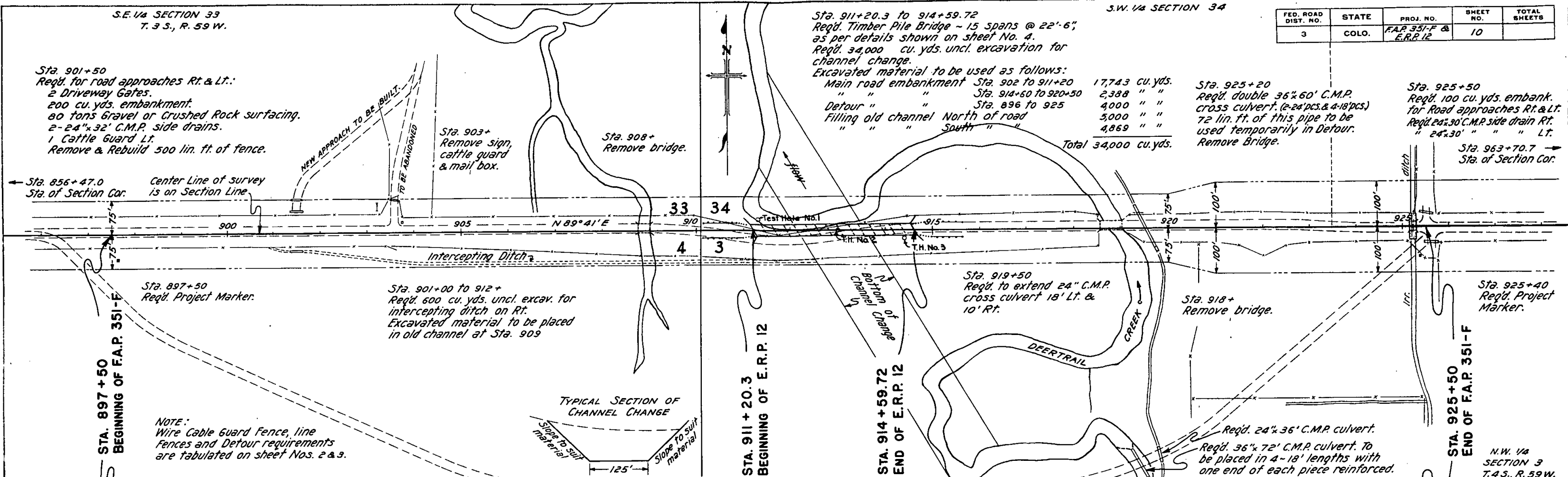

STRUCTURE NOTES FOR BRIDGE, STA. 911+20.3 TO 914+59.72

PRESENT STRUCTURE:
Span - 2 @ 24' (washed out in flood 5/30/35)
Clear Roadway - 17'
Clear Waterway - 550"
Type of Superstructure - Timber Trestle
Type of Substructure - Pile Bents & Abutts.
Requirements as to Removal - Complete

PROPOSED STRUCTURE:
Position referred to present structure - 600' West.
Span - 15 @ 22'-6"
Clear Roadway - 25'-0"
Clear Waterway - 2800"
Type of Superstructure - Tr. Timber Trestle - 6" Lam. Floor - 1/2" Asphalt Plank Wearing Surf.
Type of Substructure - Pile Bents & Abutments
Detour Structure Requirements:
R.R. Siding - Strasburg
Haul to bridge site - 18 Miles

STREAM DATA:
Drainage area in sq. miles - 72
Velocity during high water
Elevation of:
Maximum high water - 4998.32
Low Water - 4980.8
Normal Stage - 4980.8
Stream Bed - 4979.4
Drift - None
Scour - None

NEARBY STRUCTURES ON SAME STREAM:
Location - None
Waterway - None
Record during floods