

NOTE:
 Alignment and Grades as shown are subject to modification during construction after approval by the Denver Office.
 Soil data shown on the plans is obtained from best available testing laboratory information. This information is shown for the convenience of the Contractor and the Department does not guarantee the accuracy of these tests. If materials not conforming to the data on the plans are encountered during construction the grading plan shown on the plans will be modified where necessary to secure dense, stable embankments.

All Telephone Poles owned by
 Plains Cooperative Telephone Assoc., Toes, Colo.

All Power Poles owned by
 Y & W Electric Assoc., Akron, Colo.

STA. 2480+00 BEGIN F 013-1(7) =

$\Delta = 3^{\circ}23'30''$
 $D = 2^{\circ}00'$
 $T = 848'$
 $L = 1692'$
 $R = 20830'$

NE 1/4, SEC. 4,
 T.4S, R.54W

N 1/2, N 1/2, SEC. 3,
 T.4S, R.54W

TEST NO. 1/A	TEST NO. 3/B
PI. 6.4 L. 24.5 -200, 14% A-2-4(1) C.B.R. 297 R. 69	PI. 6.4 L. 24.5 -200, 98% A-4(1) C.B.R. 3.0 R. 69

TEST NO. 7/A	TEST NO. 7/B
OIL MAT	SIMILAR TO NO. 1/A
REF. R. 69	REF. C.B.R. 297

TEST NO. 7/C	TEST NO. 7/D
SIMILAR TO NO. 1/A	SIMILAR TO NO. 3/B
REF. R. 69	REF. C.B.R. 3.0

TEST NO. 8/A	TEST NO. 8/B
OIL MAT	SIMILAR TO NO. 1/A
REF. R. 69	REF. C.B.R. 297

TEST NO. 8/C	TEST NO. 8/D
SIMILAR TO NO. 1/A	SIMILAR TO NO. 3/B
REF. R. 69	REF. C.B.R. 3.0

TEST NO. 8/E	TEST NO. 8/F
OIL MAT	SIMILAR TO NO. 1/A
REF. R. 69	REF. C.B.R. 297

TEST NO. 8/G	TEST NO. 8/H
SIMILAR TO NO. 1/A	SIMILAR TO NO. 3/B
REF. R. 69	REF. C.B.R. 3.0

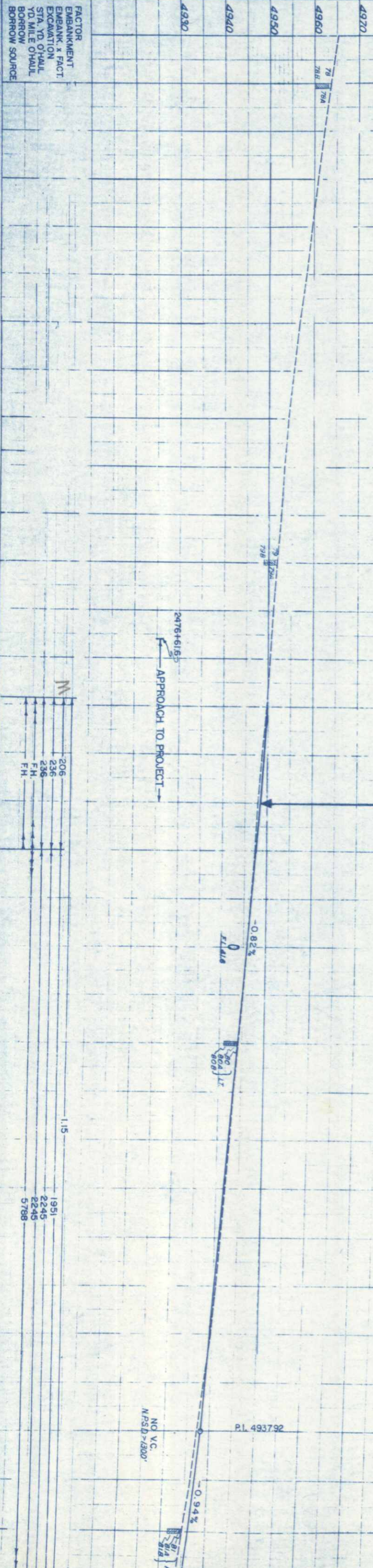

NOTE:
 Right of Way Markers are to be
 Removed at the following locations:
 Sta. 2536+20 Lt., 2538+20 Lt., 2545+31 Lt. & Rt.,
 2554+13 Lt. & Rt., 2588+75 Rt. & 2642+65 Lt. & Rt.

FED. ROAD DIST.	PROJ. NO.	SHEET NO.	TOTAL SHEETS
9	F 013-1(7)	3/	

FED. ROAD REG. NO.	DIST.	PROJ. NO.	SHEET NO.	TOTAL SHEETS
9	COLO.	F 013-(17)	32	

S1/2, SEC. 34, T3S, R34W.

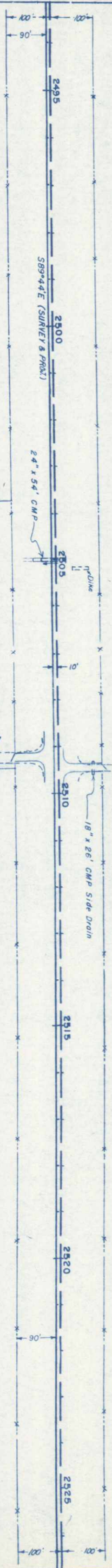

2505+00 - Extend 24" x 54' C.M.P.
18' Rt, Outlet Ditch

2509+50 - Req'd. Road Approach
Rt & Lt, Remove 18" C.M.P. Lt.

N1/2, N1/2, SEC. 3, T4S, R34W.

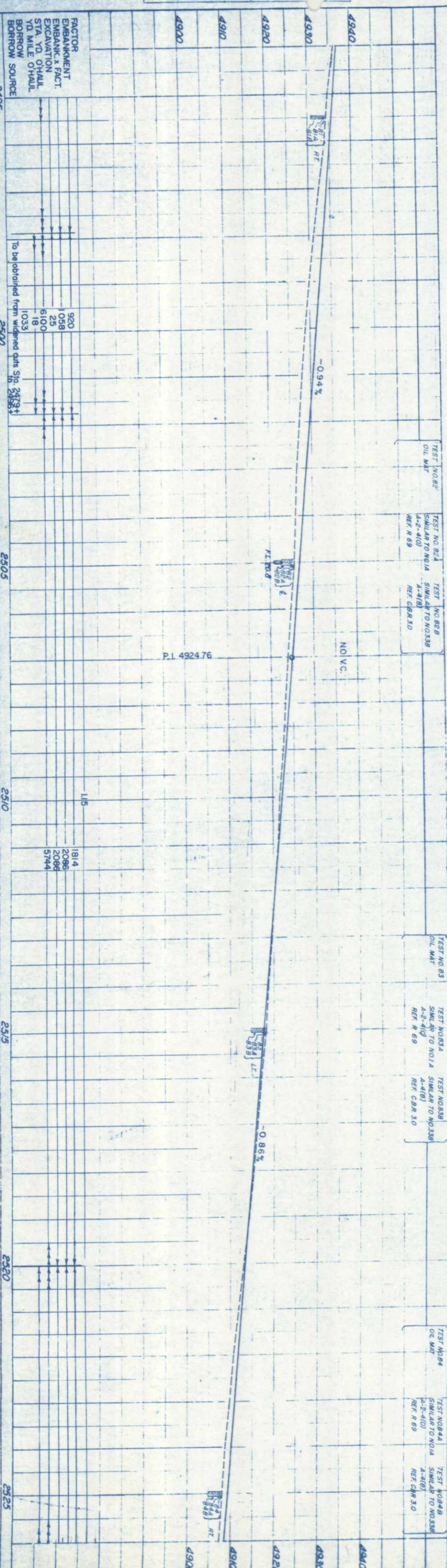

P.I. 492476

L15

1814
2086
5744

FACTOR
EMBANKMENT
EXCAVATION
STA. TO CHALL
YD. MILE O'HALL
BORROW SOURCE

920
1058
25
6100
18
1033
To be obtained from widened cuts Sta. 2479+
2488+

7620
STRUCTURE NOTED VS. CHFD

FED. ROAD DIST. NO.	DIST.	PROJ. NO.	SHEET NO.	TOTAL SHEETS
9	COLO.	F 013-1(7)	33	

Rev. 12-8-59 - H.E.P. Road Approaches and Cross Culvert.
D. S. M.

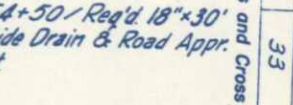
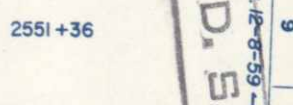
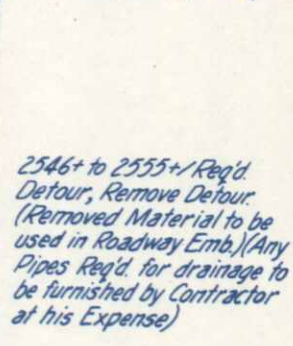
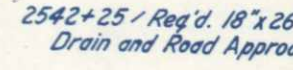
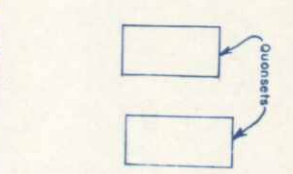

2529+00 / Req'd. 18"x28' Side Drain & Road Approach Rt. & Lt.
 D.O.H. Maint. Shed

2534+60 / Req'd. 36"x84' Cross Culvert (Relay 36"x48' CMP from 2535+10 and Extend 36'). Ditches (W=2').
 U.S.C. B.G.S.B.M. No. X-57
 88' Lt. of Δ Sta. 2535+12
 Elevation 4899.42

2534+50 / Req'd. 18"x28' Side Drain & Road Approach Rt.

2535+10 / Relay 36"x48' C.M.P. as Cross Culvert at 2534+60.

2533+20 / Req'd. 18"x46' Side Drain & 35' Road Approach, Lt.

2534+84 / Req'd. 35' Road Approach, Lt.

2535+50 / Req'd. 35' Road Approach, Lt.
 2536+09 / Req'd. 35' Road Approach, Lt.

2537+17 / Req'd. 18"x60' Side Drain & Ditches Lt., Road Approach Rt. & Lt.
 U.S.C. B.G.S.B.M. No. X-57
 Garage, Windmill, Store & P.O., Post Office

Sta 2537+17.5 Sec. Corner 3rd Rt.

2538+50 / Req'd. 18"x46' Side Drain & 35' Road Approach Rt.
 Church

2541+00 / Req'd. 18"x46' Side Drain & 35' Road Approach Rt.
 3 Pumps Gas Tank & Pumping, Garage, House

2542+25 / Req'd. 18"x26' Side Drain and Road Approach, Lt.
 Snow Fence, Conc. S.D., 24"x20"

2546+ to 2555+ / Req'd. Detour, Remove Detour. (Removed Material to be used in Roadway Emb.) (Any Pipes Req'd. for drainage to be furnished by Contractor at his Expense)

2547+20 / Req'd. 8" Embankment Protector (Type 1) Rt & Lt, Conc. Slope & Ditch Paving at Outlets (Details on Sh. No. 4)
 N1/2, N1/2, SEC. 2, T4S, R54W.

2549+69 ~ 2551+64 / Req'd. Bridge (Details on Sh. Nos. 7-13) Remove Bridge

2549+98 Treated Timber Bridge No. F-23-D

2551+36 BRIDGE

2554+50 / Req'd. 18"x30' Side Drain & Road Appr. Lt.

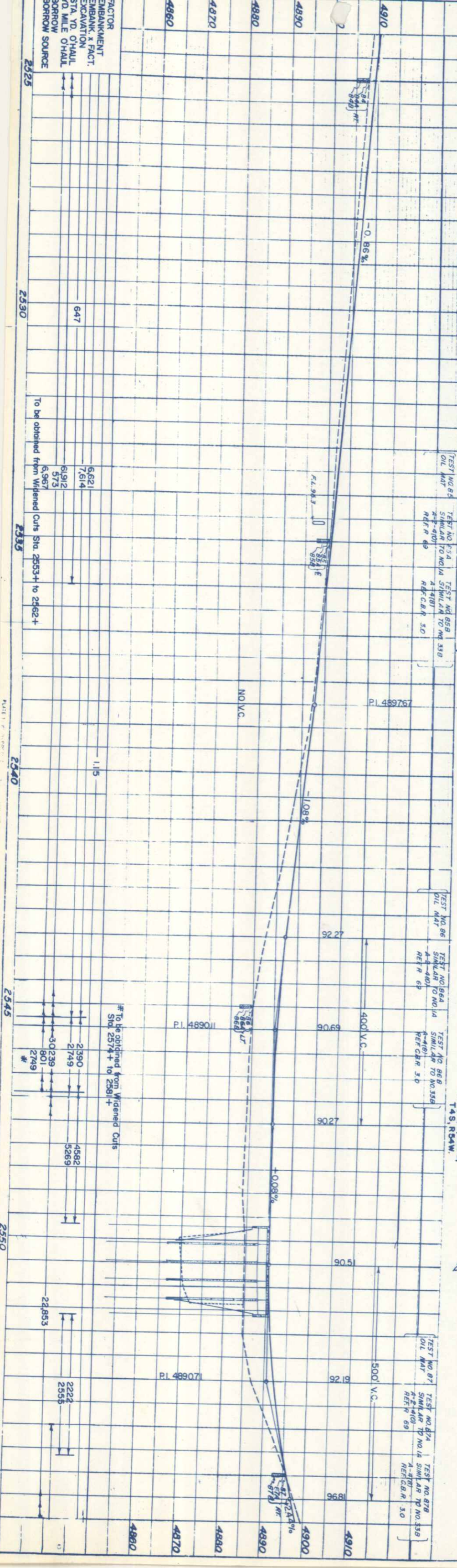

FACTORY
 EMBANKMENT
 EXCAVATION
 STA. YD. CHAUL
 TO MILE CHAUL
 BORROW SOURCE

To be obtained from Widened Cuts Sta. 2533+ to 2562+

647	6.821
	7.614
	8.1912
	5.73
	6.967

* To be obtained from Widened Cuts Sta. 2574+ to 2581+

2390	4.582
2749	5.269
30239	
801	
2749	

2222	4.880
2555	4.870
	4.860
	4.890
	4.900
	4.910

TEST NO. 85 OIL MAT. SIMILAR TO NO. 14 REFER 69
 TEST NO. 85A SIMILAR TO NO. 14 REFER 69
 TEST NO. 85B REFER 69
 TEST NO. 85C REFER 69
 TEST NO. 85D REFER 69
 TEST NO. 85E REFER 69
 TEST NO. 85F REFER 69
 TEST NO. 85G REFER 69
 TEST NO. 85H REFER 69
 TEST NO. 85I REFER 69
 TEST NO. 85J REFER 69
 TEST NO. 85K REFER 69
 TEST NO. 85L REFER 69
 TEST NO. 85M REFER 69
 TEST NO. 85N REFER 69
 TEST NO. 85O REFER 69
 TEST NO. 85P REFER 69
 TEST NO. 85Q REFER 69
 TEST NO. 85R REFER 69
 TEST NO. 85S REFER 69
 TEST NO. 85T REFER 69
 TEST NO. 85U REFER 69
 TEST NO. 85V REFER 69
 TEST NO. 85W REFER 69
 TEST NO. 85X REFER 69
 TEST NO. 85Y REFER 69
 TEST NO. 85Z REFER 69

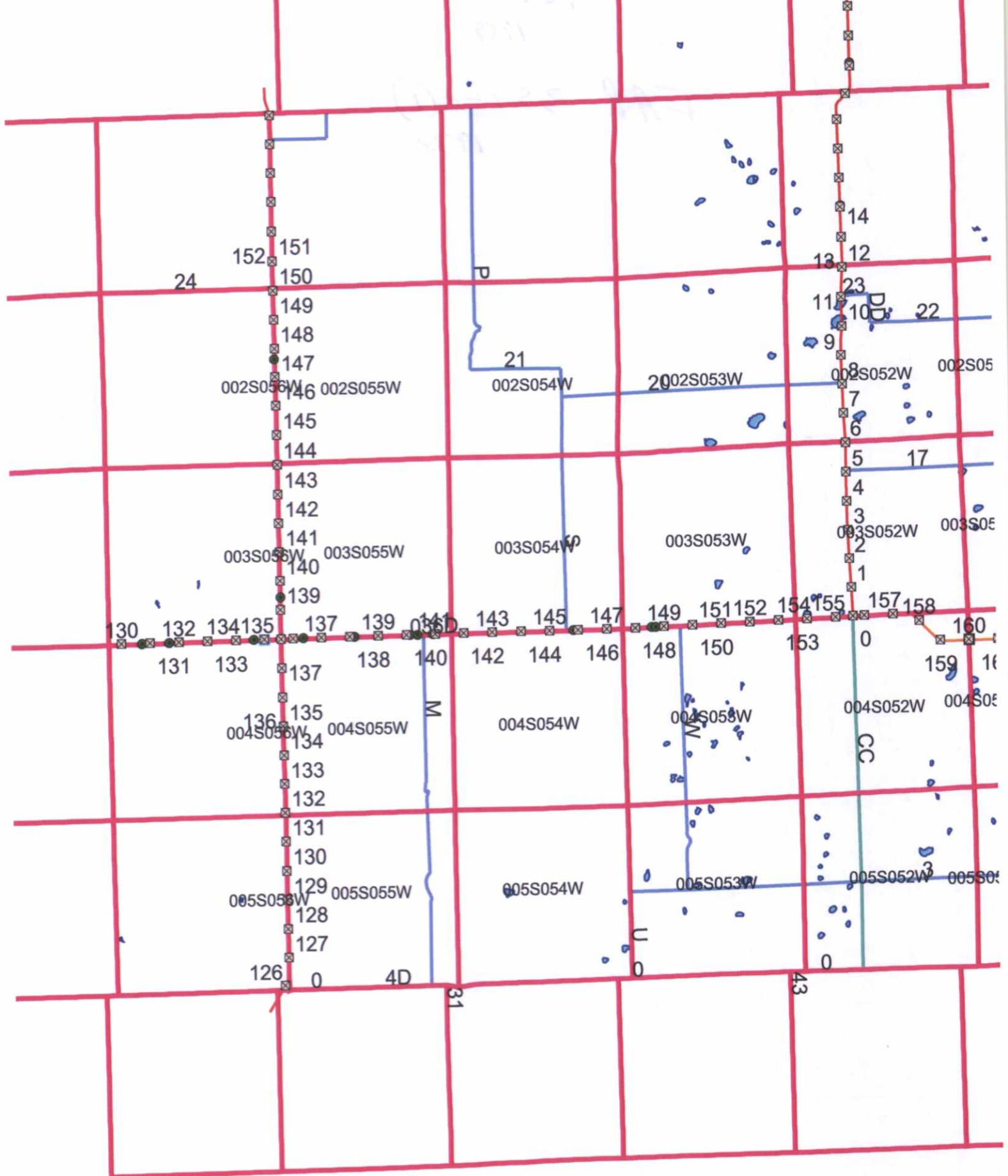

24

152 151

150

149

148

147

002S056W 002S055W

146

145

144

143

142

141

003S056W 003S055W

140

139

130

132

134

135

137

138

140

142

144

146

148

150

153

155

157

158

160

131

133

137

138

140

142

144

146

148

150

153

155

157

158

159

16

136 135

004S056W 004S055W

134

133

132

131

130

129

005S056W 005S055W

128

127

126

4D

31

005S054W

005S053W

005S052W

005S051W

004S054W

004S053W

004S052W

004S051W

003S054W

003S053W

003S052W

003S051W

002S054W

002S053W

002S052W

002S051W

21

2002S053W

23

22

14

12

11

9

8

7

6

5

4

3

2

1

0

16

15

14

13

12

11

10

9

8

7

6

5

4

3

2

1

0

16

15

14

13

12

11

10

9

8

7

6

5

4

3

2

1

0

16

15

14

13

12

11

10

9

8

7

6

5

4

3

2

1

0

16

15

14

13

12

11

10

9

8

7

6

5

4

3

2

1

0

16

15

14

13

12

11

10

9

8

7

6

5

4

3

2

1

0

16

15

14

13

12

11

10

9

8

7

6

5

4

3

2

1

0

16

15

14

13

12

11

10

9

8

7

6

5

4

3

2

1

0

16

15

14

13

12

11

10

9

8

7

6

5

4

3

2

1

0

16

15

14

13

12

11

10

9

8

7

6

5

4

3

2

1

0

16

15

14

13

12

11

10

9

8

7

6

5

4

3

2

1

0

16

15

14

13

12

11

10

9

8

7

6

5

4

3

2

1

0

16

15

14

13

12

11

10

9

8

7

6

5

4

3

2

1

0

16

15

14

13

12

11

10

9

8

7

6

5

4

3