

| FEDERAL ROAD REGION NO. | DIVISION | PROJ. NO. | SHEET NO. | TOTAL SHEETS |
|-------------------------|----------|------------|-----------|--------------|
| 1 | COLORADO | F 029-1(4) | 1 | |

COLORADO DEPARTMENT OF HIGHWAYS

PLAN AND PROFILE OF PROPOSED FEDERAL AID PROJECT NO. F 029-1(4) STATE HIGHWAY NO. 2 CITY & COUNTY OF DENVER

INDEX OF SHEETS

- | | | |
|-----------|---|--|
| SHEET NO. | <ul style="list-style-type: none"> 1. Sketch Map & Title Page 2. Typical Sections 3. Typical Median Island Detail, Detail of Curbs & Gutters, Typical Driveway Plan and Tab. of Removing Concrete Pavement 4. General Notes - Tab. of Length & Design Data & Tab. of Sections 5. Summary of Approximate Quantities 6. Tabulation of Curbs & Gutters 7. Tabulation of Surfacing 8. Tabulation of Storm Sewers 9-11. Manhole and Drop Inlet Details 12. Detail of C.B.C. at Sta 238+13 & Sta 238+46 13-17. Drainage Plans 18. DELETED 19. Standard No.12 and No.13 Concrete Inlets 20-21. Standard Roadway Construction Traffic Signs 22. Standard Single and Double Concrete Box Culverts 23. Standard Wingwalls for Various Types of Concrete Box Culverts 24. Standard Methods of Backfill Around Structures 25. Reinforced Concrete Culvert Pipe and Concrete Sewer Pipe 26. Standard End & Angle Sections, & Expansion Joints for Conc. Pipe 27-31. Alignment Plan and Profile 32. Summary of Earthwork Quantities 33-62. Cross Sections | <ul style="list-style-type: none"> M-12-E-13 M-29-C M-50-B M-50-BW M-60-B M-112-F M-118-B |
|-----------|---|--|

CONVENTIONAL SIGNS

| | |
|-----------------------------|--|
| CENTER LINE | |
| RIGHT OF WAY LINE | |
| COUNTY LINE | |
| TOWNSHIP OR RANGE LINE | |
| LAND LINES | |
| RAILROAD | |
| BARBED WIRE FENCE | |
| COMBINATION WIRE FENCE | |
| SNOW FENCE | |
| TELEPHONE & TELEGRAPH LINES | |
| POWER LINE | |
| DETOUR | |
| PRESENT ROAD (Plan Sheets) | |

SCALES OF ORIGINAL DRAWINGS

ON PLAN. 1 IN. = 50 FT.
ON PROFILE 1 IN. = 50 FT. HORIZONTAL
1 IN. = 10 FT. VERTICAL
GRADE LINE ON PROFILE IS SHOWN AS GRADE OF FINISHED ROAD
GROSS LENGTH OF PROJECT 5782.4 FT. = 1.095 MILES
NET LENGTH OF PROJECT 5782.4 FT. = 1.095 MILES

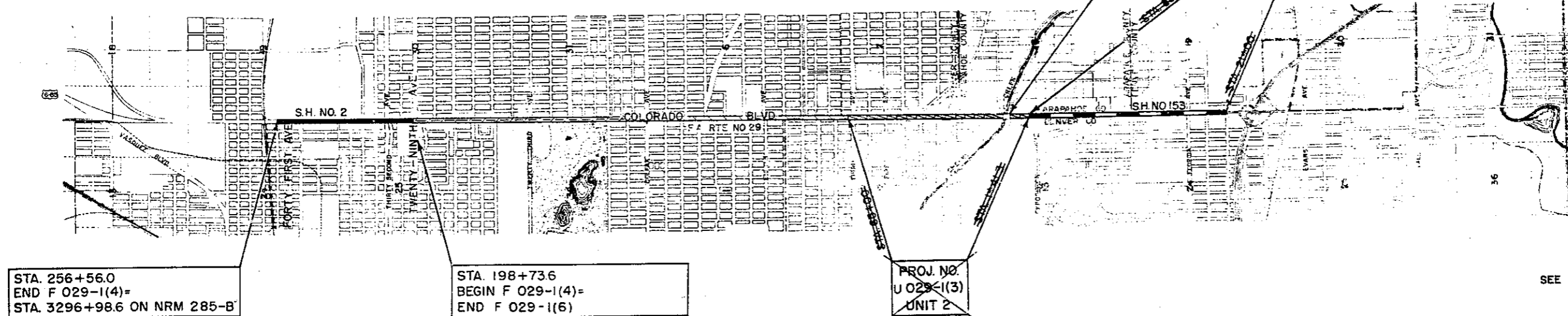
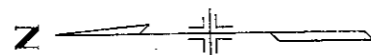

SCALE
0 1000 2000 3000
SCALE IN FEET
SEE SPECIAL PROVISIONS FOR
NOTICE TO BIDDERS

COLORADO
DEPARTMENT OF HIGHWAYS

APPROVED:

CHIEF ENGINEER 12-11-51
DATE

DEPARTMENT OF COMMERCE
BUREAU OF PUBLIC ROADS

APPROVED: _____ DATE _____
DIVISION ENGINEER

| FED. ROAD DIST. NO. | DIST. | PROJ. NO. | SHEET NO. | TOTAL SHEETS |
|---------------------|-------|------------|-----------|--------------|
| 9 | COLO. | F 029-1(4) | 27 | |



The cross hatched area in the median shall have the underlying pavement removed and the area will then be backfilled with top soil. The remaining median areas are to be Plant Mixed Asphaltic Surfaced.

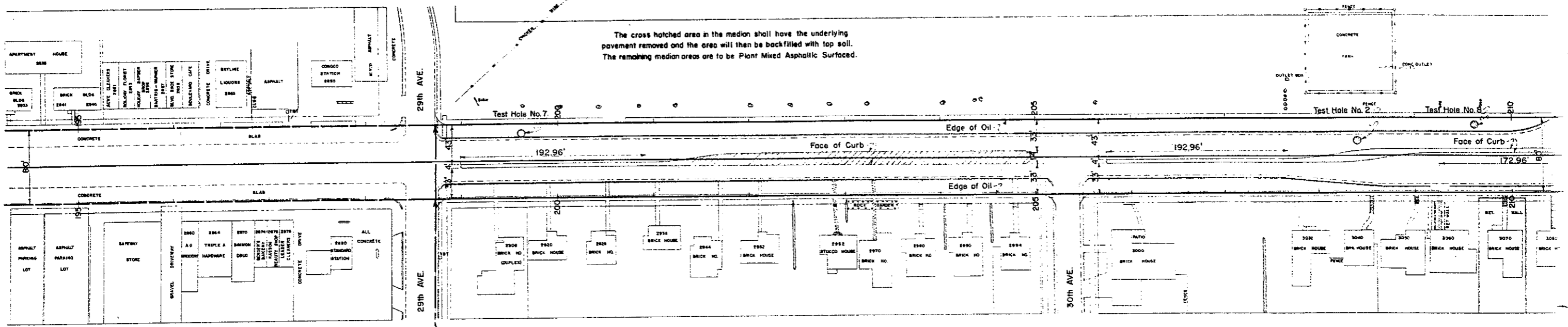

STA. 198+73.6
 BEGIN F 029-1(4) =
 END F 029-1(6)

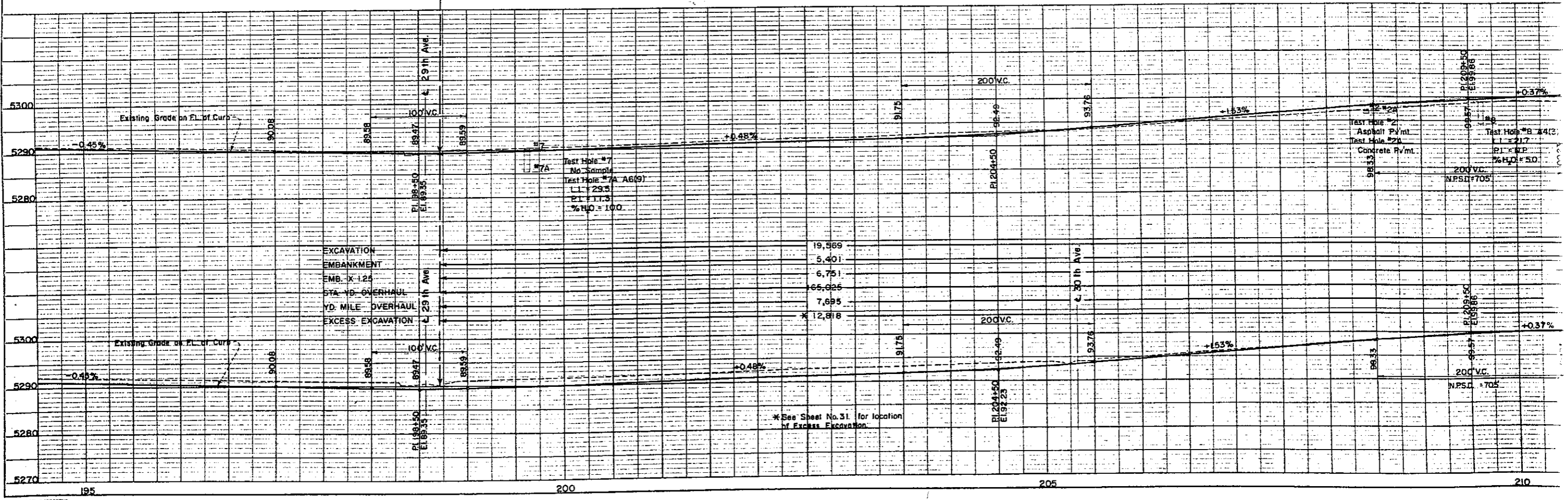

* See Sheet No. 31 for location of Excess Excavation.

| PLAN | DATE | BY | CHKD. |
|-----------|------|----|-------|
| REVISED | | | |
| ADJUSTED | | | |
| RECHECKED | | | |
| BY | | | |

| PROFILE | DATE | BY | CHKD. |
|-----------|------|----|-------|
| REVISED | | | |
| ADJUSTED | | | |
| RECHECKED | | | |
| BY | | | |

| FED ROAD DIST NO | DIST | PROJ. NO. | SHEET NO | TOTAL SHEETS |
|------------------|------|------------|----------|--------------|
| 9 | COLO | F 029-1(4) | 28 | |

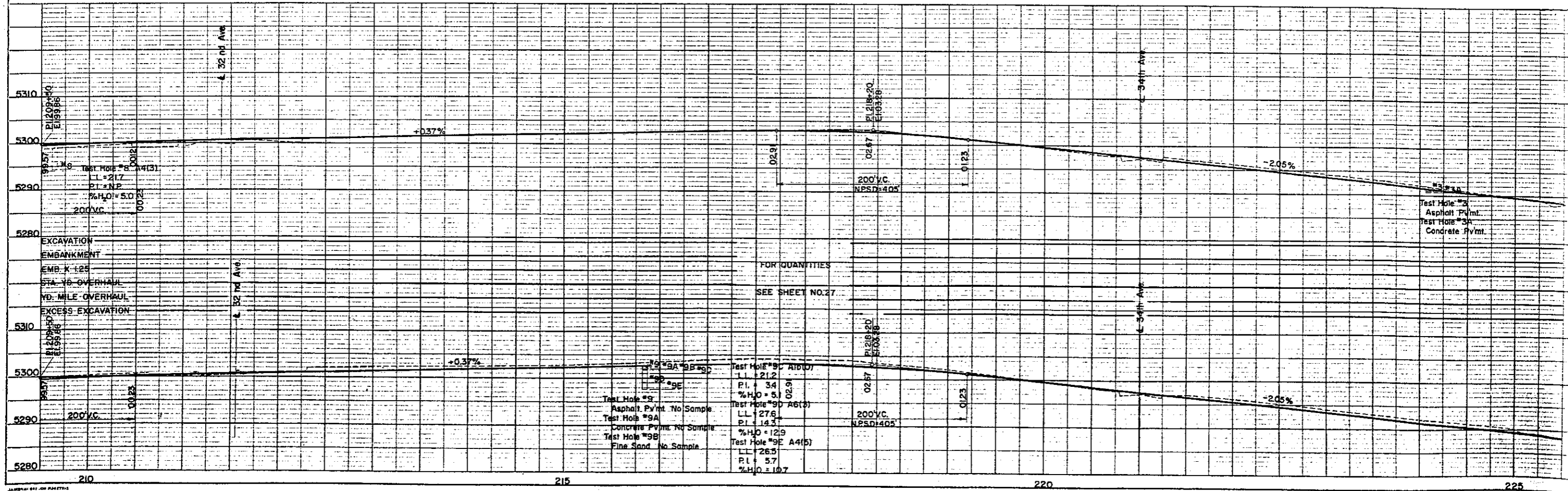
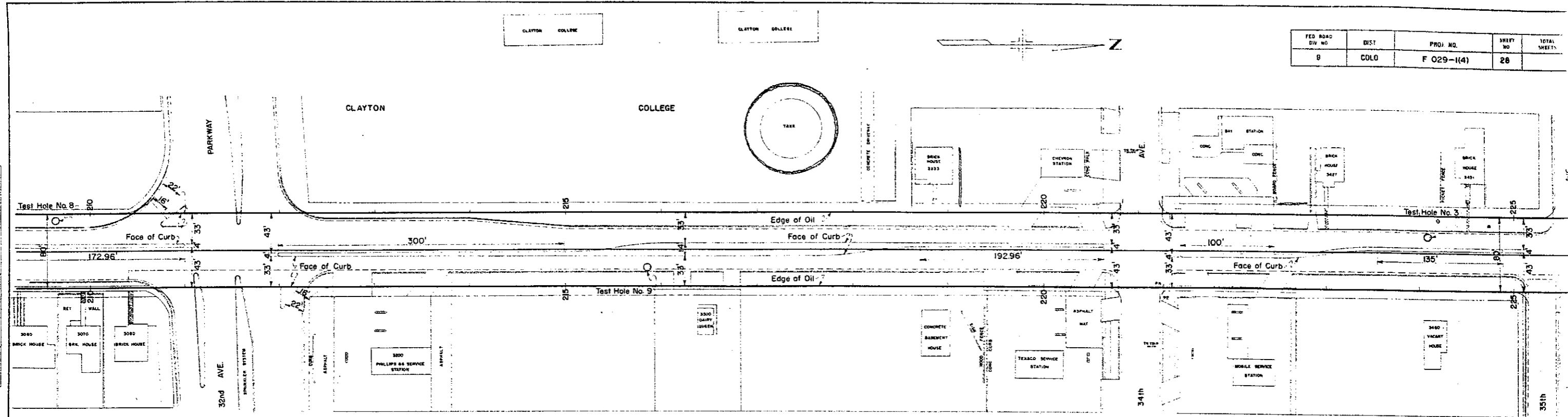

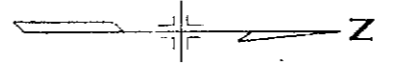

| FED. ROAD DIV. NO. | DIST. | PROJ. NO. | SHEET NO. | TOTAL SHEETS |
|--------------------|-------|------------|-----------|--------------|
| 9 | COLO. | F 029-1(4) | 29 | |

| BRICK HOUSE | WOOD HOUSE | OTHER | OTHER |
|-------------|------------|-------|-------|
| 341 | 342 | 343 | 344 |

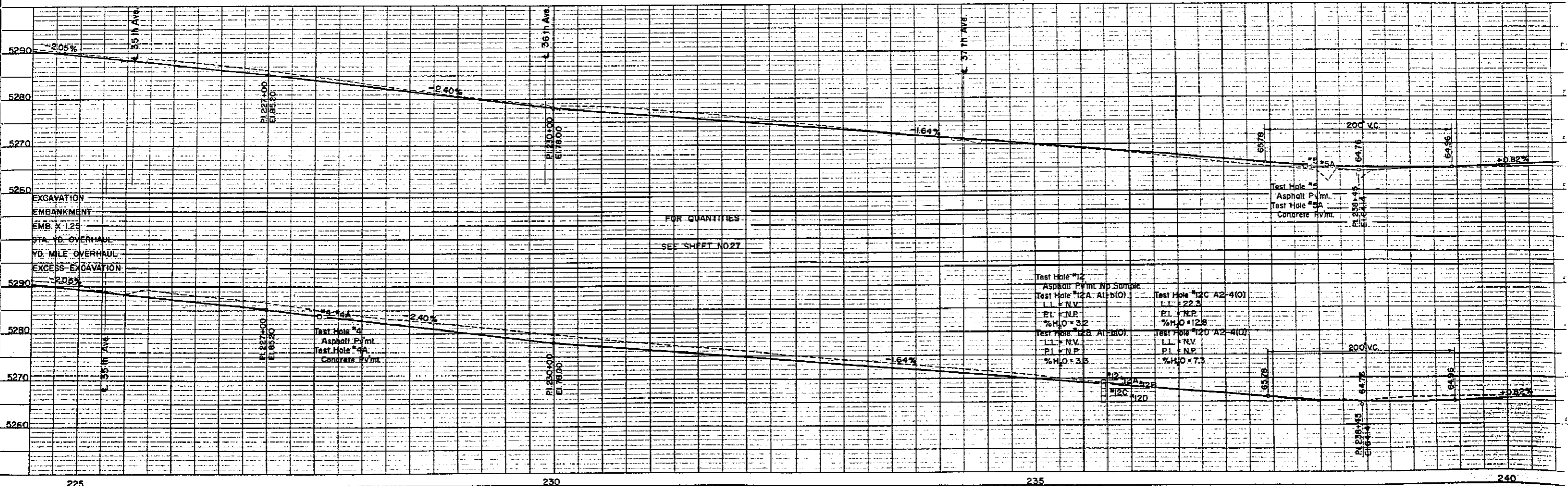
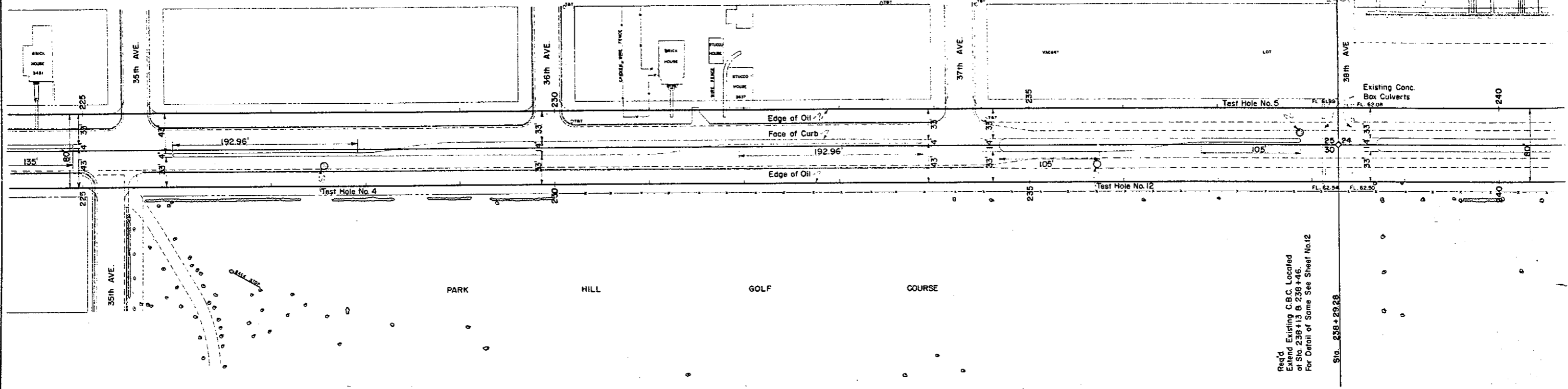

NOTE: ALL DIMENSIONS ARE IN FEET UNLESS NOTED OTHERWISE.

EXCAVATION
EMBANKMENT
EMB. X 125
STA. TO OVERHAUL
YD. MILE OVERHAUL
EXCESS EXCAVATION

Req'd
Extend Existing C.B.C. Located
at Sta. 236+13.8, 236+45.
For Detail of Same See Sheet No. 12

Sta. 238+29.28

| FEED ROAD | DIST. | PROJ. NO. | SHEET NO. | TOTAL SHEETS |
|-----------|-------|------------|-----------|--------------|
| 0 | COLO | F 029-1(4) | 31 | |

Rev. Grading to end of Str. - 1-6-59 - E.E.O.

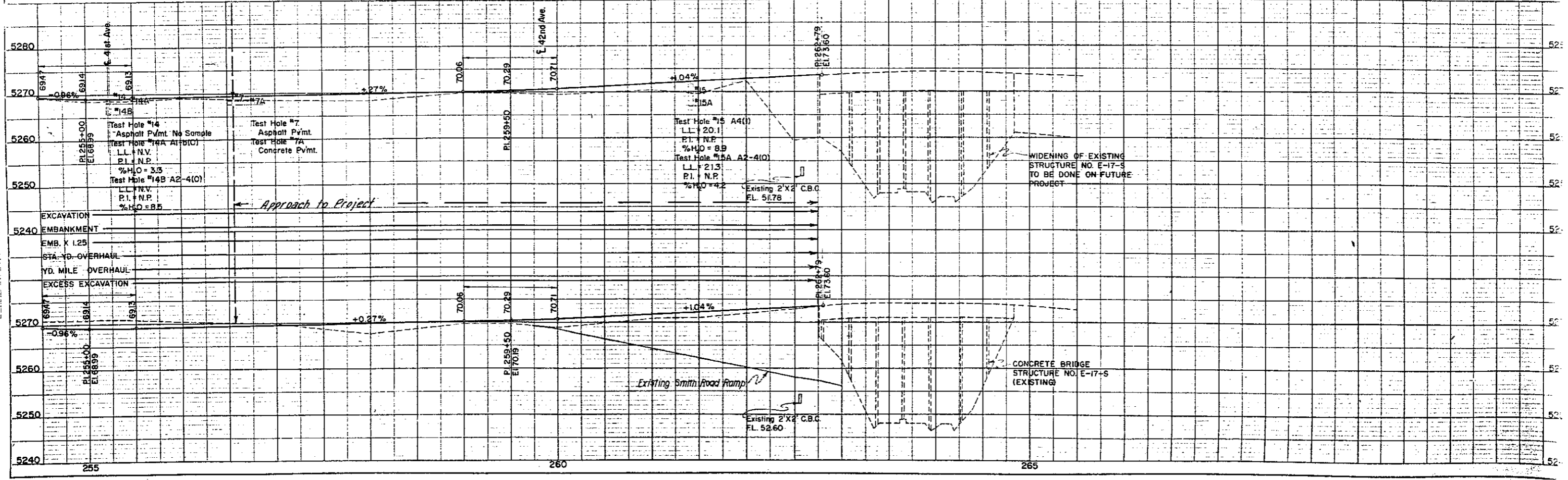
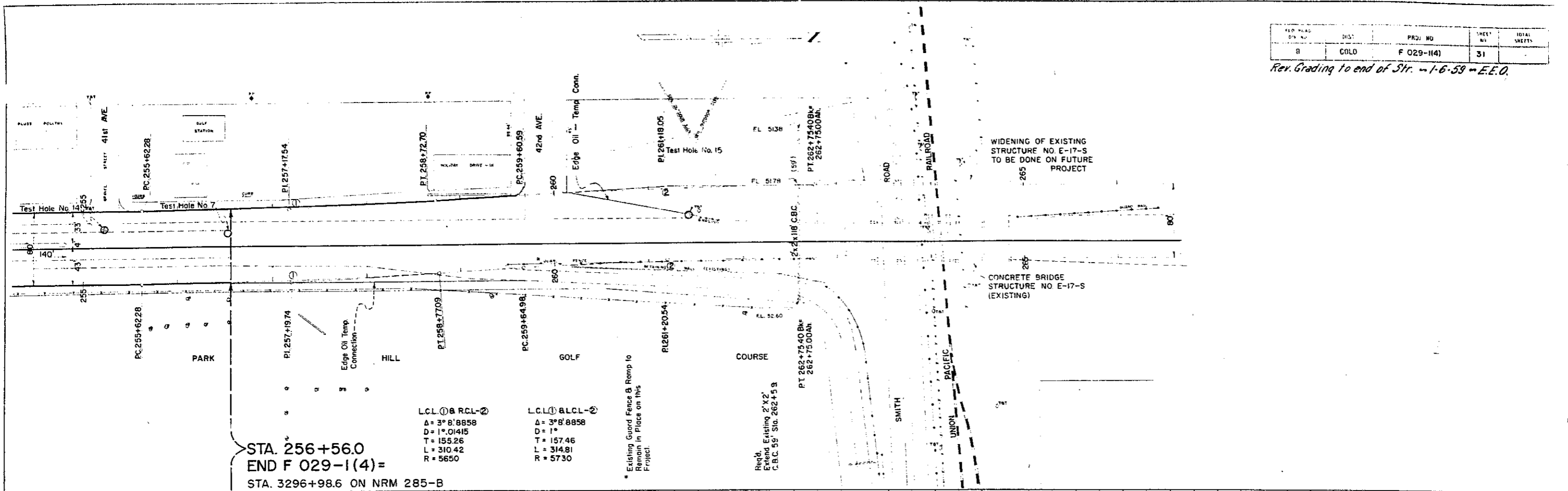

B * 1/2" = 1' 0" (Vertical)
 1" = 100' (Horizontal)

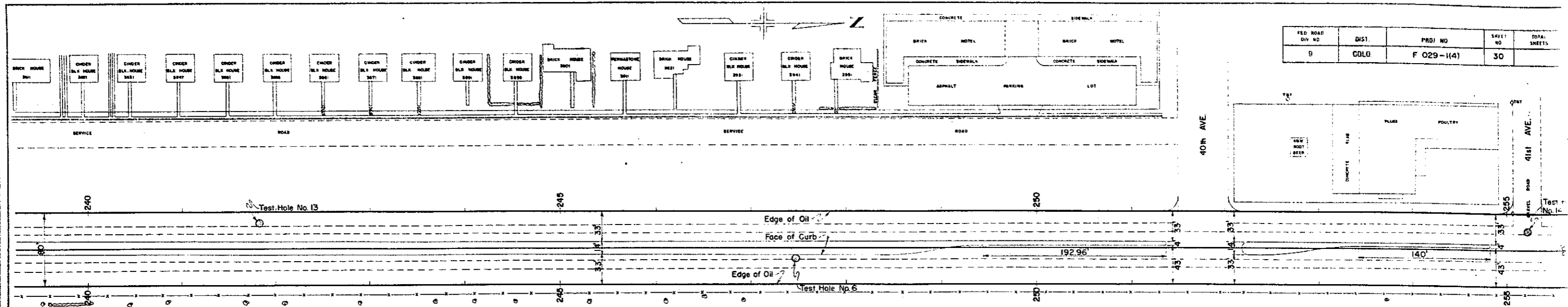

| | | | | |
|--------------------|-------|------------|-----------|--------------|
| FED. ROAD DIV. NO. | DIST. | PROJ. NO. | SHEET NO. | TOTAL SHEETS |
| 9 | COLO. | F 029-1(4) | 30 | |

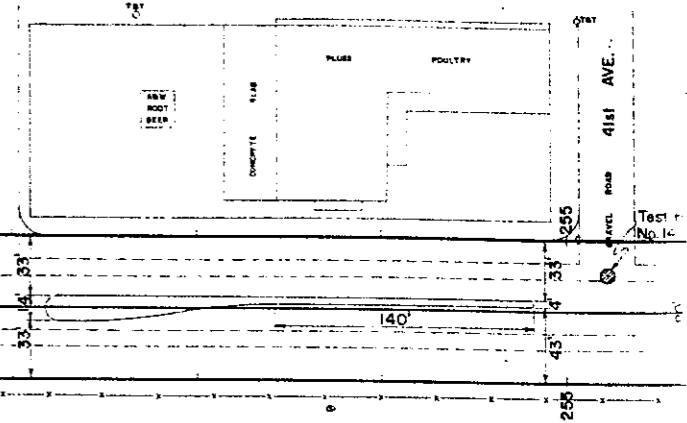

WITH ROAD AND SIDEWALK CENTERLINE OF WAY CHECKED
 NO. 10

PARK HILL GOLF COURSE

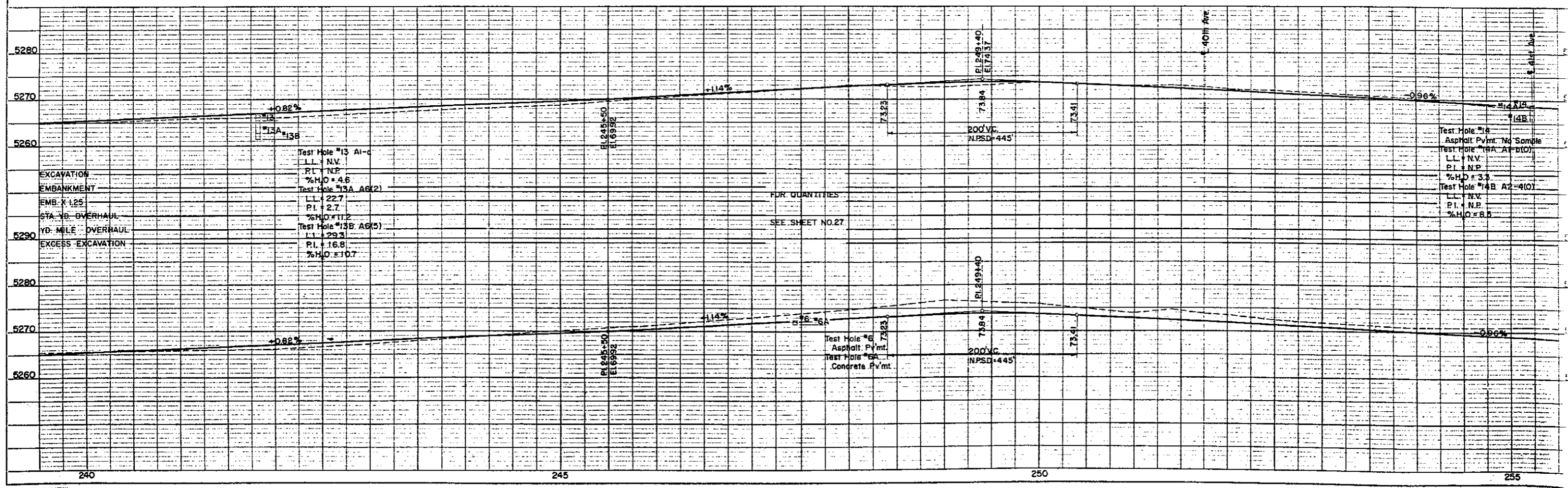

WITH ROAD AND SIDEWALK CENTERLINE OF WAY CHECKED
 NO. 10

FOR QUANTITIES
SEE SHEET NO. 27

Test Hole #14
Asphalt Pymt. No Sample
Test Hole #14A A1-B(10)
LL = N.V.
PI = N.P.
%H₂O = 3.3
Test Hole #14B A2-B(10)
LL = N.V.
PI = N.P.
%H₂O = 8.8