

# COLORADO DEPARTMENT OF HIGHWAYS

## PLAN AND PROFILE OF PROPOSED FEDERAL AID PROJECT NO. F 029-1(5) STATE HIGHWAY NO. 153 CITY & COUNTY OF DENVER

### INDEX OF SHEETS

SHEET NO.	1	Sketch Map & Title Page.	
	2	Typical Sections.	
	3	Typical Median Island Detail, Details of Curbs & Gutters & Typical Driveway Plan.	
	4	General Notes — Tabulation of Length — Tabulation of Sections and Summary of Earthwork.	
	5	Summary of Approximate Quantities.	
	6	Tabulation of Curbs & Gutters.	
	7	Tabulation of Surfacing.	
	8-9	Tabulation of Storm Sewers.	
	10-14	Manhole & Drop Inlet Details.	
	15-19	Drainage Plans.	
	20	Standard Concrete Pavement Joint Details.	M-8-D
	21-22	Standard Roadway Const Traffic Signs.	M-29-C
	23	Reinforced Concrete Culvert Pipe and Concrete Sewer Pipe.	M-112-F
	24	Sprinkler System Details and Summary.	
	25-26	Details of Median Island Sprinkler System.	
	27-31	Alignment Plan and Profile.	
	32-78	Gross Sections.	

### CONVENTIONAL SIGNS

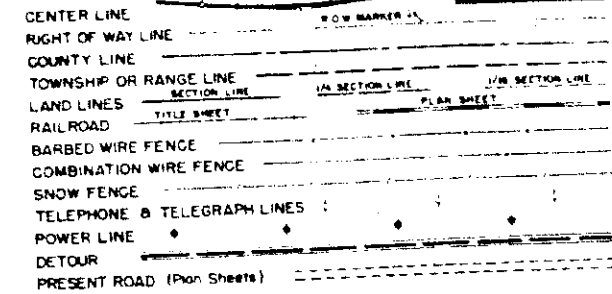

#### SCALES OF ORIGINAL DRAWINGS

ON PLAN. 1 IN. = 50 FT.  
 ON PROFILE 1 IN. = 50 FT. HORIZONTAL  
 1 IN. = 10 FT. VERTICAL  
 GRADE LINE ON PROFILE IS SHOWN AS GRADE OF FINISHED ROAD  
 GROSS LENGTH OF PROJECT 6,393.8 FT. = 1.211 MILES  
 NET LENGTH OF PROJECT 6,393.8 FT. = 1.211 MILES

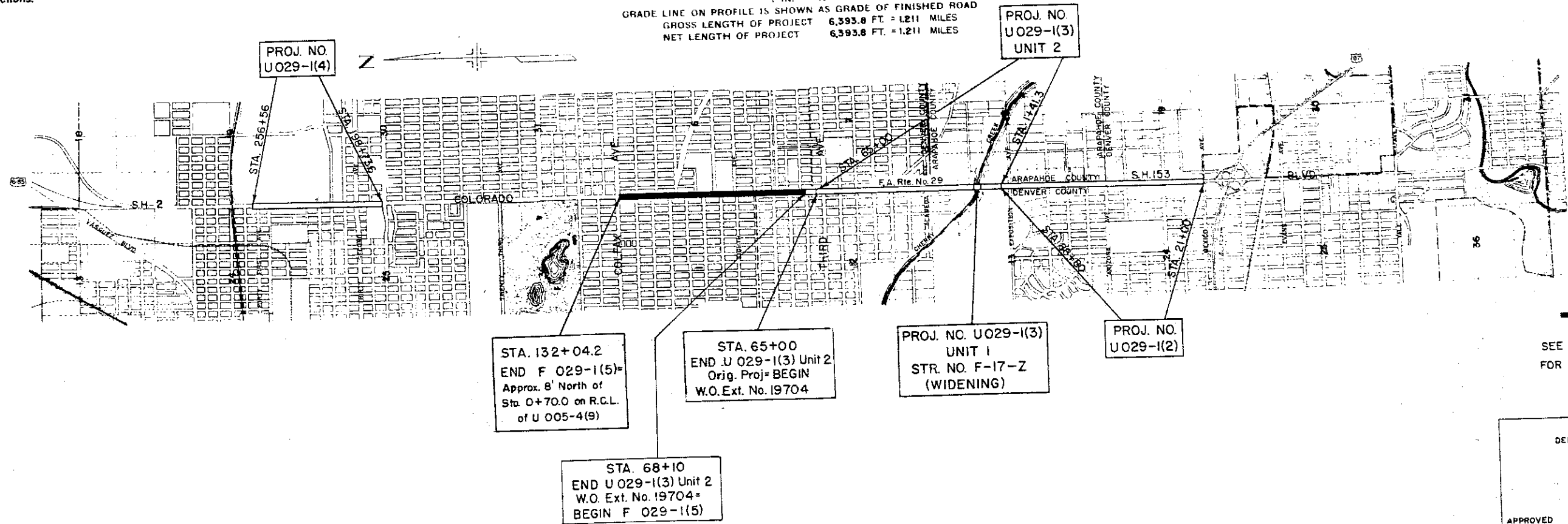

SCALE  
 1" = 500 FT.  
 SCALE IN FEET  
 SEE SPECIAL PROVISIONS  
 FOR NOTICE TO BIDDERS

STA. 132+04.2  
 END F 029-1(5) =  
 Approx. 8' North of  
 Sta. 0+70.0 on R.C.L.  
 of U 005-4(9)

STA. 65+00  
 END U 029-1(3) Unit 2  
 Orig. Proj = BEGIN  
 W.O. Ext. No. 19704

STA. 68+10  
 END U 029-1(3) Unit 2  
 W.O. Ext. No. 19704 =  
 BEGIN F 029-1(5)

PROJ. NO. U029-1(3)  
 UNIT 1  
 STR. NO. F-17-Z  
 (WIDENING)

PROJ. NO.  
 U029-1(2)

PROJ. NO.  
 U029-1(3)  
 UNIT 2

PROJ. NO.  
 U029-1(4)

COLORADO  
DEPARTMENT OF HIGHWAYS

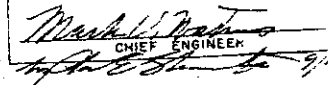
APPROVED:  
  
 CHIEF ENGINEER

DEPARTMENT OF COMMERCE  
 BUREAU OF PUBLIC ROADS

APPROVED:  
 \_\_\_\_\_  
 DIVISION ENGINEER

FILE NO.	DIST.	PROJ. NO.	SHEET NO.	TOTAL SHEETS
9	COLO.	F 029-1(5)	27	

Note:  
For details of Sprinkler System from Alameda to 3rd Ave. See Sheet 25.



The cross hatched areas in the median are to be Plant Mixed Asphaltic Surfaced The remaining median areas are to have the underlying pavement removed and then backfilled with top soil.

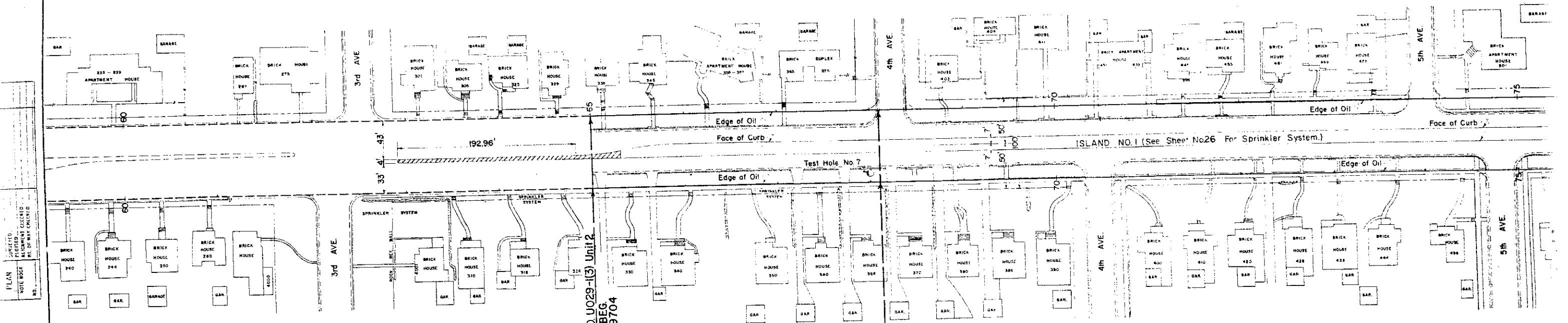

NOTE: Surfacing Quantities to Sta. 70+50± Constructed by Work Order No. 19704. (Proj. No. U029-1(3) Unit 2)

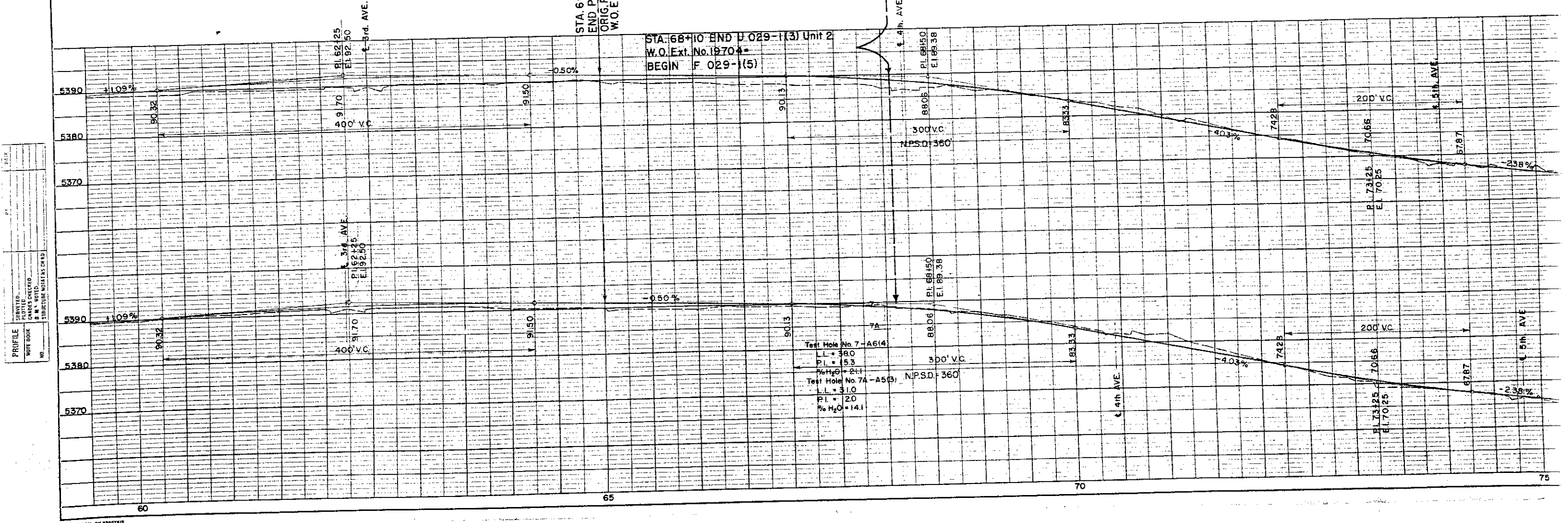

PROFILE

DATE	BY
DESIGNED	CHECKED
PLOTTED	NOTED
NOTED	STRUCTURE NOTED
NO.	

PLAN

DESIGNED	CHECKED
PLOTTED	NOTED
NOTED	STRUCTURE NOTED
NO.	

FED. ROAD DIV. NO.	DIST.	PROJ. NO.	SHEET NO.
9	COLO.	F 029-(15)	28

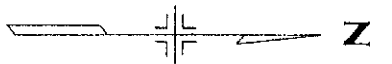

NOTE: SEE SHEET 16 FOR DIMENSIONS OF MEDIAN ISLAND AND CHANNELIZATION AT 6TH AND 7TH AVENUES

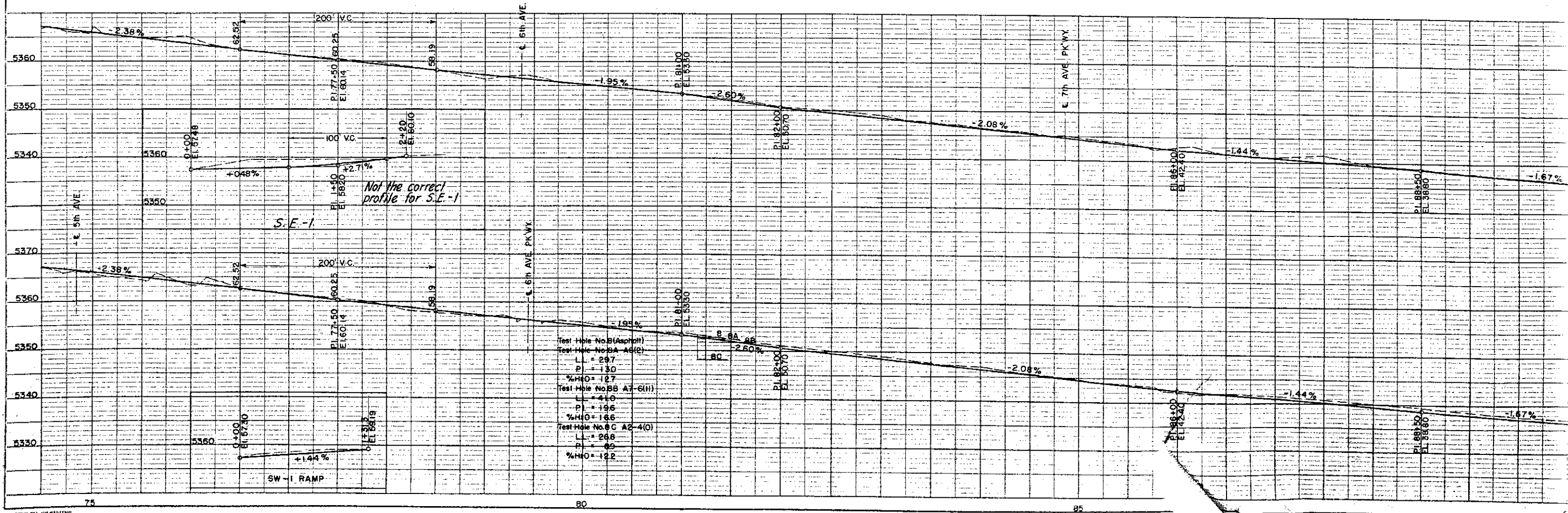
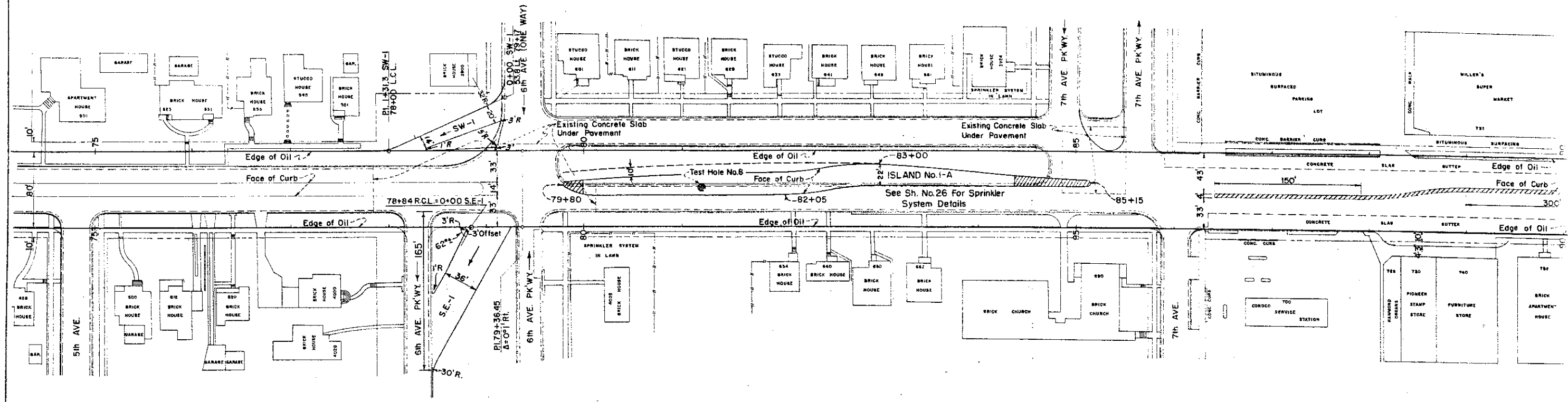

PLAN SURVEYED  
PLOTTED  
ALIGNED CHECKED  
BY DE WAY CHILCO  
DATE

PROFILE SURVEYED  
PLOTTED  
CHECKED  
BY DE WAY CHILCO  
DATE

Test Hole No. 8 (Asphalt)  
 Test Hole No. 8A As(2)  
 L = 29.7  
 P = 13.0  
 %H10 = 12.7  
 Test Hole No. 8B As-6(H)  
 L = 4.0  
 P = 19.6  
 %H10 = 16.6  
 Test Hole No. 8C A2-4(O)  
 L = 24.8  
 P = 0.0  
 %H10 = 12.2

FED. ROAD DIV. NO.	DIST.	PROJ. NO.
9	COLD	F 029-1(5)

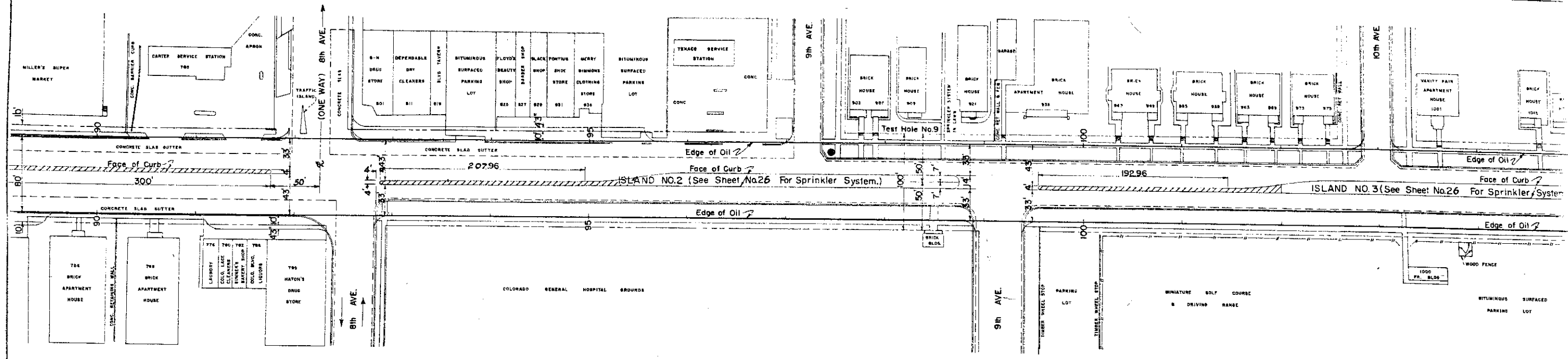
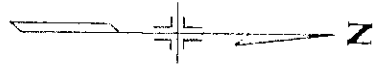

PLAN  
 DATE  
 DRAWN BY  
 CHECKED BY  
 APPROVED BY  
 TITLE

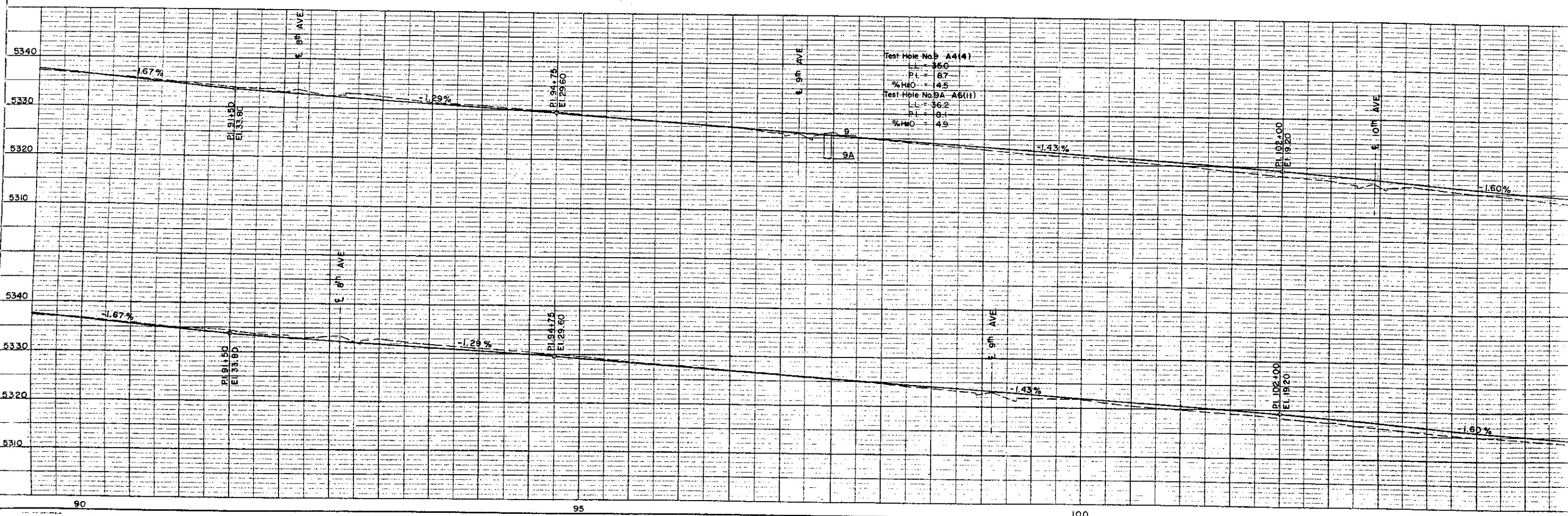

PROFILE  
 DATE  
 DRAWN BY  
 CHECKED BY  
 APPROVED BY  
 TITLE

90

95

100



