

FED. ROAD DIST. NO.	STATE	F.A.P. PROJ. NO.	SHEET NO.	TOTAL SHEETS
3	COLO.	F. 230 (6)	1	

Revised Oct. 20, 1947 - G.S. REV. 11.P.K. 5-20-48 For Const. Div. No. 2

# COLORADO STATE HIGHWAY DEPARTMENT

## PLAN AND PROFILE OF PROPOSED FEDERAL AID PROJECT NO. F 230 (6) STATE HIGHWAY NO. 1 DOUGLAS COUNTY

### INDEX OF SHEETS (Original Contract)

1. TITLE SHEET
2. TYPICAL SECTION AND SUMMARY OF QUANTITIES
3. LIST OF STRUCTURES, SURFACING PLAN, FENCING REQUIREMENTS
4. DETAIL OF JOINT FOR EXTENDING CMP CULVERTS, DETAIL OF JOINT FOR CBC EXTENSION, SUMMARY OF DETOUR QUANTITIES, GUARD FENCE AND GUARD POSTS, AND R.O.W. MARKERS
5. GENERAL LAYOUT FOR DOUBLE 10' X 15' CBC STATION 21+25
6. BOX DETAILS-10' X 15' CBC STATION 21+25
7. WING DETAILS-10' X 15' CBC STATION 21+25
8. LAYOUT OF ALIGNMENT TO SHOW ASCENDING AND DESCENDING LANES
9. SUMMARY OF QUANTITIES (ORIGINAL CONTRACT)
10. DELETED
11. STANDARD HEADWALLS FOR CMP CULVERTS M-102-G
12. CONCRETE BOX CULVERTS M-103-F
13. STANDARD WIRE CABLE GUARD FENCE M-20-B
14. STANDARD WIRE FENCES (TREATED WOODEN POSTS) M-24-G
15. STANDARD LETTERS & FIGURES FOR YEAR & STRUCTURE NUMBERS M-10-B
16. DELETED
17. TYPICAL SIDE APPR. ROADS, FLARING, SLOPE TREATMENT & WIDENING M-2-C
18. STANDARD MARKER POSTS M-7-B
19. STANDARD EMBANKMENT PROTECTORS M-13-B
20. CONTOUR, INTERCEPTING, AND DRAINAGE DITCHES M-107-B
- 20a. STANDARD ROADWAY CONSTRUCTION TRAFFIC SIGNS M-2-D
- 21-22. PLAN PROFILE
- 23-40. CROSS SECTIONS
41. SUMMARY OF EARTHWORK QUANTITIES.

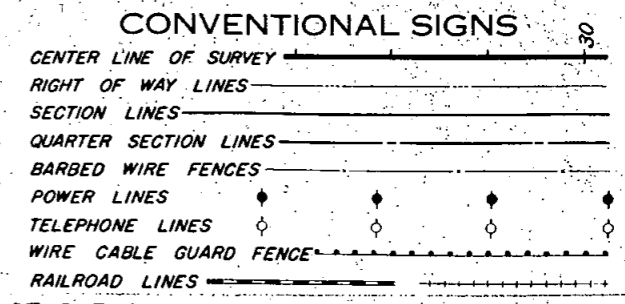

### INDEX OF SHEETS CONSTRUCTION DIVISION NUMBER 2

SHEET No 1x	SKETCH MAP AND TITLE PAGE, TABULATION OF LENGTH AND DESIGN DATA	
" 2x	TYPICAL SECTION, SUMMARY OF QUANTITIES AND SURFACING PLAN	
" 3x	LIST OF STRUCTURES	
" 4x-6x	DETAILS OF CONCRETE I BEAM SPAN, STA. 35+34.52 TO 35+79.52	
" 7x	LAYOUT OF ALIGNMENT TO SHOW ASCENDING AND DESCENDING LANES	
" 8x	STANDARD METAL PLATE GUARD FENCE - BEAM TYPES (SPEC. REV.)	M 21 B
" 9x	STANDARD LETTERS & FIGURES FOR YEAR & STRUCTURE NUMBERS	M 10 B
" 10x	STANDARD MARKER POSTS	M 7 B
" 11x	STANDARD TIMBER GUARD POSTS	M 19 B
" 12x	STANDARD WIRE CABLE GUARD FENCE	M 20 B
" 13x	STANDARD WIRE FENCES (TREATED WOODEN POSTS)	M 24 G
" 14x	STANDARD METHODS FOR SUPERELEVATION & WIDENING OF CURVES	M 1 B
" 15x	TYPICAL SIDE APPROACH ROADS, FLARING, CUT SLOPE TREATMENT AND WIDENING AT BRIDGES	M 2 C
" 16x	STANDARD ROADWAY CONSTRUCTION TRAFFIC SIGNS	M 2 D
" 17x	STANDARD EMBANKMENT PROTECTORS	M 13 B
" 18x-19x	ALIGNMENT PLAN AND PROFILE	
" 20x-36x	CROSS SECTIONS	
" 37x	SUMMARY OF EARTHWORK QUANTITIES & TABULATION OF INTERCEPTING DITCHES	

**SCALES OF ORIGINAL TRACINGS**  
 ON PLAN, 1 IN. = 100 FT.  
 ON PROFILE, 1 IN. = 100 FT. HORIZONTAL  
 1 IN. = 10 FT. VERTICAL  
 GRADE LINE ON PROFILE IS SHOWN AS GRADE OF FINISHED ROAD  
 GROSS LENGTH OF PROJECT = 2900 LIN. FT. = 0.549 MILES  
 NET LENGTH OF PROJECT = 2655 LIN. FT. = 0.540 MILES

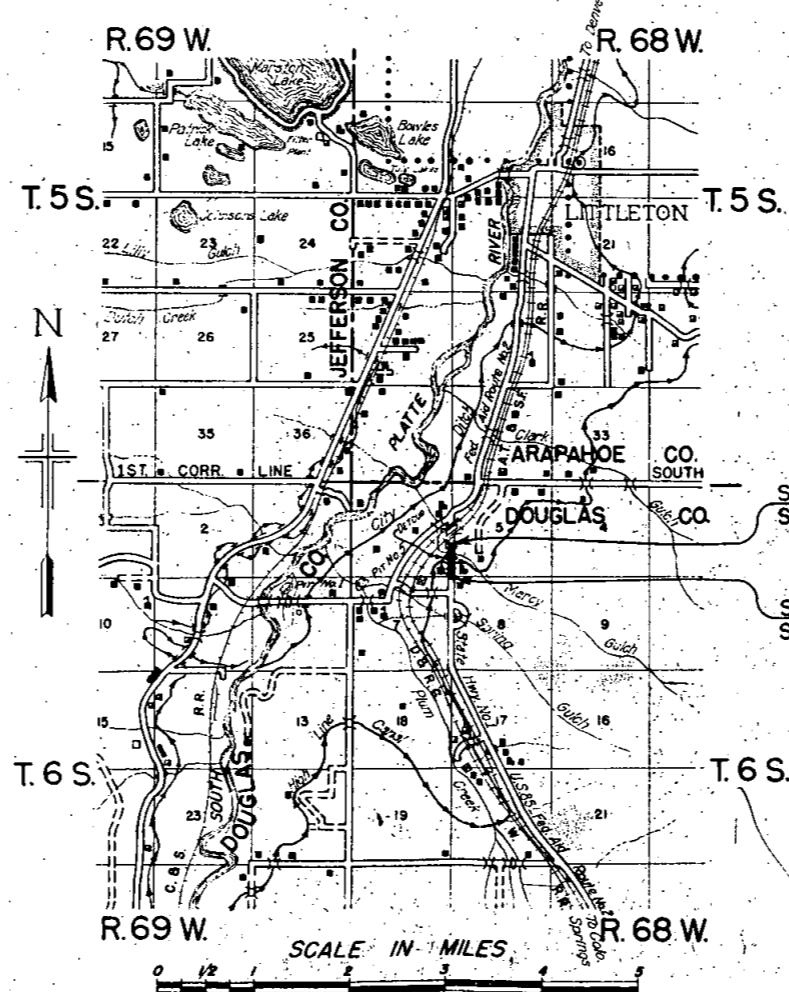

*It is recommended that bidders on this project go over the plan details with one of the following field representatives of this department.*  
 E. E. Montgomery, Division Engineer, Denver, Colorado.  
 Fred W. Miller, Resident Engineer, Denver, Colorado.

TABULATION OF LENGTH & DESIGN DATA

STATION	ROADWAY		BRIDGES	
	LIN. FT.	LIN. FT.	LOADING	
16+00 Begin F 230(6)				
21+06 C.B.C. End Marcy Gulch	506.0		37.0	H-20
21+43 C.B.C. End		1391.5		
35+34.5 Bridge End High Line Canal			45.0	H-20
35+79.5 Bridge End		920.5		
45+00 End F 230(6)				
<b>TOTALS</b>	<b>2818.0</b>	<b>82.0</b>		
<b>SUMMARY</b>				
F 230(6) Roadway	2818.0 Ft. = 0.533 Miles			
F 230(6) Bridges	82.0 Ft. = 0.016 Miles			
Total F 230(6)	2900.0 Ft. = 0.549 Miles			
<b>DESIGN DATA</b>				
Maximum Degree of Curve	None			
Maximum Grade	6%			
Minimum N.P.S.D. Horizontal	>1300 Ft.			
Minimum N.P.S.D. Vertical	630 Ft.			
Maximum Design Speed	65 M.P.H.			

RECOMMENDED FOR APPROVAL

ASSISTANT ENGINEER \_\_\_\_\_ DATE \_\_\_\_\_

APPROVED

STATE HIGHWAY ENGINEER \_\_\_\_\_ DATE 2-25-46

RECOMMENDED FOR APPROVAL DATE \_\_\_\_\_

DISTRICT ENGINEER  
PUBLIC ROADS ADMINISTRATION  
FEDERAL WORKS AGENCY

APPROVED DATE \_\_\_\_\_

DIVISION ENGINEER  
PUBLIC ROADS ADMINISTRATION  
FEDERAL WORKS AGENCY





