



Region 1
Address: 18500 East Colfax Avenue
Aurora, CO 80011
Phone: (303) 757-9744 FAX: (303) 757-9746

Survey Unit: Joseph P. Conway

Sheet Revisions

mm/yy	xxxx	xxx

I-70 E.B. MP 202.3 To MP 203.1
SEC. 26, T5S, R 78 W
6th PRINCIPLE MERIDAN
SUMMIT COUNTY COLORADO

Project Control Diagram

Project Control Diagram				
Plan Sheet				
Project Number: IM 0702-246				
Project Location: Frisco On Ramp				
Project Location:				
Project Code	Last Mod. Date	Subsect Sheets	Sheet No.	Total No. of Sheets
14819	05-21-04	1 of 3		

GEODETTIC COORDINATE SUMMARY TABLE
(ADJUSTED FIELD DATA)

POINT NAME	GEODETTIC COORDINATES NAD-83(92) (CHARN)		ELLIP. HEIGHT	ELEV. (NAVD '88)m	MAPPING ANGLE	SCALE	NAD 83(92) ZONE 0502	
	LATITUDE(N)	LONGITUDE(W)					NORTHING (m)	EASTING (m)
I-70 CM-MP 202.2	39° 35' 29.39408" N	106° 05' 55.81743" W	2758.533	2769.760	-0° 22' 39.65100"	0.99997249	500143.618	862963.099
I-70 CM-MP 202.3	39° 35' 33.09693" N	106° 05' 44.57619" W	2756.743	2769.260	-0° 22' 32.56100"	0.99997264	500256.047	863232.065
I-70 CM-MP 202.6	39° 35' 46.29370" N	106° 05' 37.91331" W	2766.574	2777.830	-0° 22' 28.35900"	0.99997319	500661.985	863393.700
I-70 CM-MP 202.8	39° 35' 55.13933" N	106° 05' 25.80913" W	2784.400	2784.400	-0° 22' 20.72500"	0.99997356	500932.896	863684.261
I-70 CM-MP 203.0	39° 36' 03.21551" N	106° 05' 23.07940" W	2787.771	2799.060	-0° 22' 19.00400"	0.99997390	501181.538	863751.003
I-70 CM-MP 203.2	39° 36' 08.59508" N	106° 05' 08.89562" W	2779.227	2790.530	-0° 22' 10.05800"	0.99997413	501345.251	864090.454
SH 9 CM-MP 97.03	39° 35' 27.46197" N	106° 05' 41.27921" W	2749.214	2761.777	-0° 22' 30.48243"	0.999972419	500081.754	863309.592

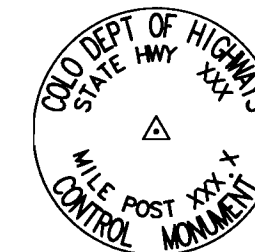

Typical Control Monument Cap
Not to Scale

PROJECT COORDINATE SUMMARY TABLE
(ADJUSTED FIELD DATA)

POINT NAME	PROJECT COORDINATES		ELEV(ft)	DESCRIPTION
	NORTH (ft)	EAST (ft)		
I-70 CM-MP 202.2	1641667.41	2832583.17	9087.12	CDOT Type II Control Monument
I-70 CM-MP 202.3	1642036.44	2833466.02	9085.48	CDOT Type II Control Monument
I-70 CM-MP 202.6	1643368.89	2833996.57	9113.60	CDOT Type II Control Monument
I-70 CM-MP 202.8	1644258.13	2834950.30	9135.15	CDOT Type II Control Monument
I-70 CM-MP 203.0 (OVERLOOK)	1645074.27	2835189.38	9183.25	CDOT Type II Control Monument
I-70 CM-MP 203.2	1645611.64	2836283.59	9155.26	CDOT Type II Control Monument
SH 9 CM-MP 97.03	1641464.38	2833720.50	9080.75	CDOT Type II Control Monument

BASIS OF BEARINGS: All bearings are based on a line connecting CM-MP 202.2 (CDOT Type II alum cap) to CM-MP 202.3 (CDOT Type II alum cap) as bearing of N67°18'55"W.

BASIS OF ELEVATIONS: Project is based on a elevation of 9085.48 (ft) on CM-MP 202.3 a CDOT Type II Control Monument. The bench loops were ran along I-70 from Copper Mountain (Milepost 195.5) to Beaver Brook (Milepost 247.8) on I-70 Corridor Control Project.

COORDINATE DATUM: Project coordinates are Colorado State Plane Central Zone NAD '83(92) coordinates. The combined elevation/scale factor used to modify the coordinates from state plane to project coordinates was 1.000475081 in order to obtain uniformity with SH 9 South Survey (Frisco to Breckenridge - STA 009A-021). Then coordinates were converted to US Feet (no truncation).

▲ CP - Control Point Monuments set by CDOT. They are CDOT type 2 monuments, a 3-1/4" dia. aluminum control monument cap (as shown) on a 3" X 3/4" dia. finned aluminum security rod on a 3" X 3/4" dia. smooth aluminum rod.

NOTE: This control survey is for the use of the Colorado Department of Transportation personnel. The survey is not a complete boundary survey and does not subdivide land. Title Commitment and Title Research were not part of this control survey, therefore, easement, rights, and restrictions of record are not shown. The verification of the physical evidence with relation to easements, rights of way, property boundaries, and restriction, as described in the instruments of record, were not included in this control survey.

NOTE: According to Colorado law you must commence any legal action based upon any defect in this survey within three years after you first discover such defect. In no event may any action based upon any defect in this survey be commenced more than ten years from the date of the statement shown hereon.

NOTE: No guarantee as to the accuracy of the information contained on the attached drawing is either stated or implied unless this copy bears an original signature of the professional land surveyor hereon named.

SURVEYORS STATEMENT: I, Farid K. Yazdani, a Professional Land Surveyor in the State of Colorado, hereby state that this Project Control Diagram was prepared under my direct supervision this 21st day of May 2004, from a field survey performed under my supervision and checking for and on behalf of the Department of Transportation, State of Colorado, and is not a Land Survey Plat or Right-of-Way Survey Plat and to the best of my knowledge and belief this control survey, as shown, meets the minimum horizontal control tolerances of a Type B Survey and this topographic survey, as shown, meets the minimum horizontal control tolerances of a Type D Survey as listed in the Colorado Department of Transportation Survey Manual Chapter Three (Revised 4/29/92).

CONSTRUCTION SURVEYING AND MONUMENTATION REQUIREMENTS:

- This Control Survey Diagram represents the horizontal and vertical control for the project established by the Division. It is possible that some of the survey control monuments listed have been disturbed or obliterated. It is the Contractor's responsibility to verify the existence and stability of the control monuments before submitting a bid price.
- All Type 1 and Type 2 monuments shall be set flush with the ground. Witness posts shall be installed 2 foot from and facing all Type 1 and Type 2 monuments, or as directed by the Project Engineer.
- Installation of Type 3 and Type 3-A monuments shall be completed in the same day that installation is commenced. Under no circumstances shall holes in the roadway be left open overnight.
- When installing Type 3-A monuments, the aluminum access cover shall be positively secured in the roadway. The access cover shall be caulked with asphalt caulking between the cover and the edges of the roadway surface to provide a positive moisture barrier around the access cover.
- Control survey procedures, statistical analysis, and accuracy obtained for horizontal and vertical control shall be documented in the field book.
- Legible copies of the field books shall be submitted to the Project Engineer for review on a monthly basis.
- It is ultimately the prime Contractors responsibility to insure that these requirements, as well as any contained in the CDOT specifications, project special provisions, and CDOT Survey Manual are fulfilled under this contract.
- The minimum staking intervals for each item are described on the plans or in the CDOT Survey Manual. If the contractor wishes to reduce the minimum intervals, a Contract Modification Order must be negotiated and the cost of the item reduced accordingly.

FARID K YAZDANI PLS #36560

NAME OF PLS AND PLS #



Region 1
 Address: 18500 East Colfax Avenue
 Aurora, CO 80011
 Phone: (303) 757-9744 FAX: (303) 757-9746

Survey Unit: Joseph P. Conway

Sheet Revisions		
mm/yy	xxxx	xxx

I-70 E.B. MP 202.3 To MP 203.1
 SEC. 26, T5S, R 78 W
 6th PRINCIPLE MERIDAN
 SUMMIT COUNTY COLORADO

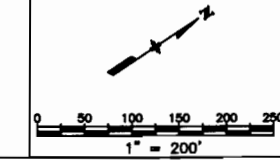

Project Control Diagram				
Plan Sheet				
Project Number: IM 0702-246				
Project Location: Frisco On Ramp				
Project Location:				
Project Code	Last Mod. Date	Subset Sheets	Sheet No.	Total No. of Sheets
14819	05-21-04	2 of 3		

THIS MONUMENT IS LOCATED AT THE END OF ON RAMP TO I-70 WEST BOUND NEAR GORE AREA.

FOUND
 I-70 CM-MP 202.2
 GPS PROJECT STATION
 N: 1641667.41
 E: 2832583.17
 EL:9087.12

FOUND
 I-70 CM-MP 202.3
 GPS PROJECT STATION
 N: 1642036.44
 E: 2833466.02
 EL:9085.48

FOUND
 I-70 CM-MP 202.6
 GPS PROJECT STATION
 N: 1643368.89
 E: 2833996.57
 EL:9113.60

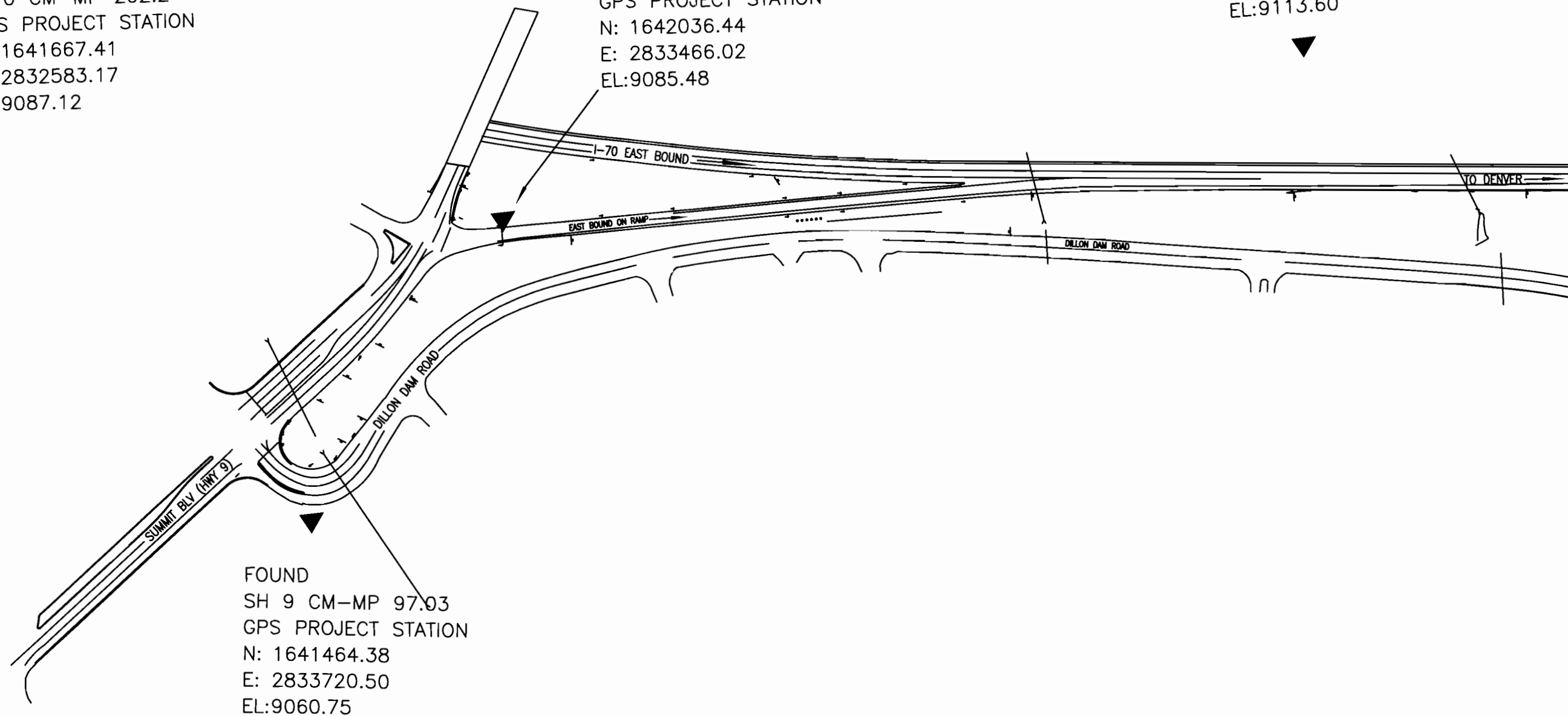

FOUND
 SH 9 CM-MP 97.03
 GPS PROJECT STATION
 N: 1641464.38
 E: 2833720.50
 EL:9060.75



Region 1
Address: 18500 East Colfax Avenue
Aurora, CO 80011
Phone: (303) 757-9744 FAX: (303) 757-9746

Survey Unit: Joseph P. Conway

Sheet Revisions		
mm/yy	xxxxx	xxx

I-70 E.B. MP 202.3 To MP 203.1
SEC. 26, T5S, R 78 W
6th PRINCIPLE MERIDAN
SUMMIT COUNTY COLORADO

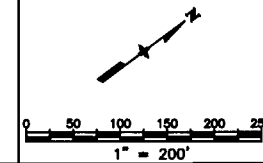

Project Control Diagram				
Plan Sheet				
Project Number: IM 0702-246				
Project Location: Frisco On Ramp				
Project Location:				
Project Code	Last Mod. Date	Subest Sheets	Sheet No.	Total No. of Sheets
14819	05-21-04	3 of 3		

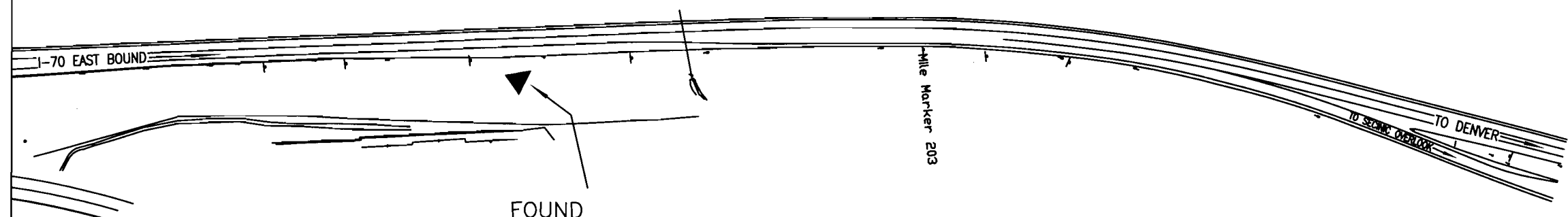

FOUND
 I-70 CM-MP 203.0 (OVERLOOK)
 GPS PROJECT STATION
 N: 1645074.27
 E: 2835169.38
 EL: 9183.25

FOUND
 I-70 CM-MP 203.2
 GPS PROJECT STATION
 N: 1645611.64
 E: 2836283.59
 EL: 9155.26

FOUND
 I-70 CM-MP 202.8
 GPS PROJECT STATION
 N: 1644258.13
 E: 2834950.31
 EL: 9135.15