

| | | | | | | | |
|----------------|---------|------|------------------|----------|---------------|-----------|--------------|
| AS CONSTRUCTED | | | FED. ROAD REGION | DIVISION | PROJ. NO. | SHEET NO. | SHEET TOTALS |
| NO REVISIONS | REVISED | VOID | VII | COLO. | IR 070-5(050) | | |

DEPARTMENT OF TRANSPORTATION - STATE OF COLORADO

SURVEY CONTROL DIAGRAM

Project IR 070-5(050)
 Interstate 70 MP 416.65
 Structures G-26-S and G-26-U
 Sec. 4, T. 9 S., R. 47 W., 6th P.M.
 Kit Carson County, Colorado

**COORDINATE SUMMARY TABLE
 (UNADJUSTED FIELD DATA)**

| POINT. | NORTHING | EASTING | ELEV. (ft) |
|------------------|----------|----------|------------|
| CM-MP 416.65 | 10142.78 | 11878.52 | 4363.63 |
| WORK PT. 1 | 10150.02 | 10000.02 | 4412.59 |
| STA 2410+00 RT | 10000.00 | 10000.00 | 4417.62 |
| STA 2410+00 LT | 10311.79 | 10000.05 | --- |
| STA 2438+17.2 RT | 10000.18 | 12817.67 | 4360.08 |
| STA 2438+17.2 LT | 10300.62 | 12816.44 | 4362.53 |
| STA 2447+72.2 RT | 10040.96 | 13782.91 | 4359.14 |
| STA 2447+72.2 LT | 10340.15 | 13757.87 | --- |
| BM NE COR G-26-S | --- | --- | 4364.81 |



TYPICAL CONTROL MONUMENT



TYPICAL R-O-W MARKERS

**DISTANCE SUMMARY TABLE
 (UNADJUSTED FIELD DATA)**

| OCCUPIED POINT | AHEAD POINT | MEAN HORIZ. DIST. (±.02') |
|------------------|------------------|---------------------------|
| CM-MP 416.65 | STA 2410+00 RT | 1883.94 |
| STA 2410+00 RT | WORK PT. 1 | 150.02 |
| WORK PT. 1 | CM-MP 416.65 | 1878.51 |
| CM-MP 416.65 | STA 2438+17.2 RT | 949.92 |
| STA 2438+17.2 RT | WORK PT. 1 | 2821.63 |

BASIS OF BEARINGS: Bearings used in the calculation of coordinates are based on an assumed bearing of N 85°39'12" E from the right Right-Of-Way marker (as described below) at Station 2410+00 to CM-MP 416.65 (as described below), as calculated from the centerline bearing of Interstate-70 for construction project I-70-5(21)413.

▲ CM-MP - Control Monuments are set CDOT type 2 monuments, a 3-1/4" aluminum control monument cap (as shown) on a 3' X 3/4" finned aluminum rod on a 3' X 3/4" straight aluminum rod.

△ WORK PT. - Work points are set oak hubs with guard stakes and lathes.

○ RIGHT-OF-WAY Markers are brass caps (as shown) in concrete.

⊗ MISCELLANEOUS SURVEY MONUMENTS (see diagram for specific descriptions).

NOTE: Angles were calculated using the Law of Cosines from the measured distances. Coordinates were determined from measured distances and calculated angles.

NOTE: It is possible that some of the survey control monuments listed have been disturbed or obliterated. It is the contractor's responsibility to verify the existence and stability of the control monuments before submitting a bid price.

NOTE: If construction activity disturbs any R-O-W marker, property pin, or other survey monument, it is the contractor's responsibility to replace, restore, or rehabilitate the monument according to State Statutes and the rules and regulations set forth by the State Board of Registration for Professional Engineers and Professional Land Surveyors.

NOTE: A presurvey conference is required before all construction projects begin.

NOTE: This control survey is for the use of Colorado Department of Transportation personnel. The survey is not a complete Boundary Survey. The rectification of the physical evidence with the recorded documents was not requested on this project. Research into and depiction of Right-Of-Ways and easements was not requested on this project.

NOTE: According to Colorado law you must commence any legal action based upon any defect in this survey within three years after you first discover such defect. In no event may any action based upon any defect in this survey be commenced more than ten years from the date of the certification shown.

NOTE: No guarantee as to the accuracy of the information contained on the attached plat is either stated or implied unless this copy bears an original signature of the professional land surveyor hereon named.

I, Joseph P. Conway, a Professional Land Surveyor in the State of Colorado, hereby certify that this Control Survey Diagram was prepared under my supervision this _____ day of _____, from a field survey performed under my supervision from February 4, 1991 to February 28, 1991, and checking for and on behalf of the Department of Transportation, State of Colorado, and is not a Land Survey Plat or Right-of-Way Survey Plat; and to the best of my knowledge and belief this control survey, as shown, meets the minimum horizontal control tolerances of a Type B Survey listed in the Colorado Department of Highways Survey Manual Chapter Three (Revised 7/1/89).

Joseph P. Conway L.S. 25618

STATE OF COLORADO
 STATE DEPARTMENT OF TRANSPORTATION
 DIVISION OF HIGHWAYS
 C.D.D.T. FORM NO. 126
 REV. JULY 1991

AS CONSTRUCTED
 NO REVISIONS REVISED VOID

| FED. ROAD REGION | DIVISION | PROJ. NO. | SHEET NO. | SHEET TOTALS |
|------------------|----------|---------------|-----------|--------------|
| VIII | COLO. | IR 070-5(050) | | |

DEPARTMENT OF TRANSPORTATION - STATE OF COLORADO SURVEY CONTROL DIAGRAM

Project IR 070-5(050)
 Interstate 70 MP 416.65
 Structures G-26-S and G-26-U
 Sec. 4, T. 9 S., R. 47 W., 6th P.M.
 Kit Carson County, Colorado

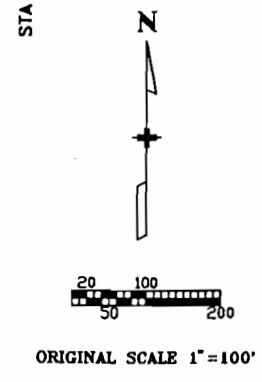
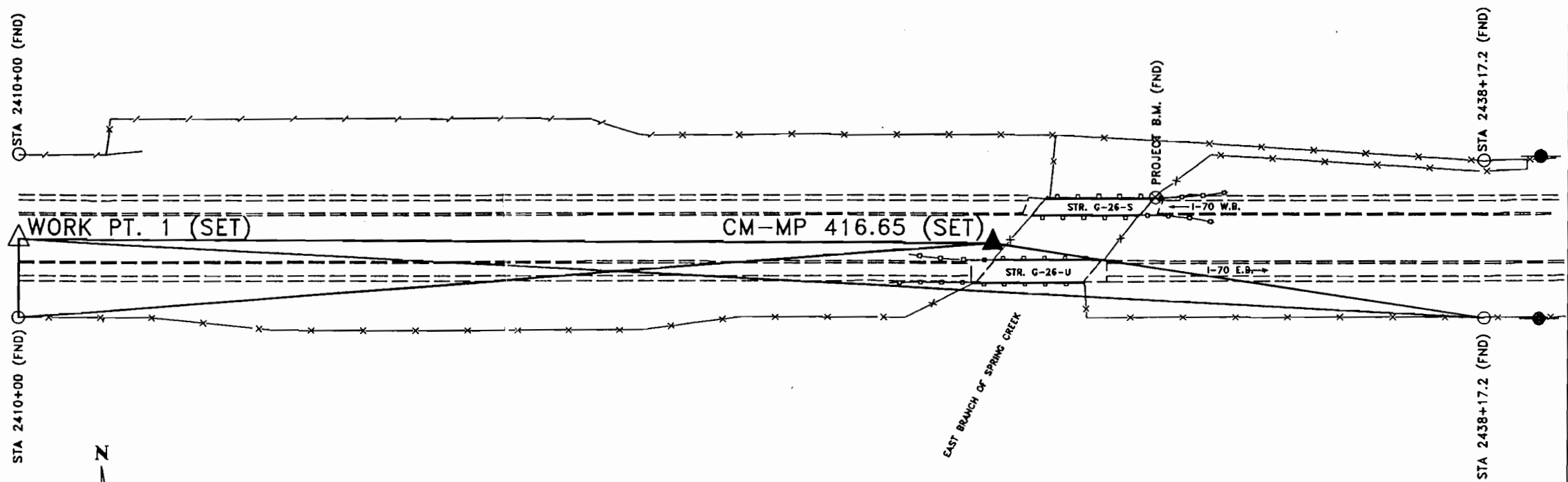

- CM-MP - CONTROL MONUMENT
- WORK POINTS
- RIGHT-OF-WAY MARKERS
- MISCELLANEOUS SURVEY MONUMENTS

STATE OF COLORADO
 STATE DEPARTMENT OF TRANSPORTATION
 DIVISION OF HIGHWAYS
 C.D.T. FORM NO. 126
 REV. JULY 1994

AS CONSTRUCTED
 NO REVISIONS REVISED VOID

| FED. ROAD REGION | DIVISION | PROJ. NO. | SHEET NO. | SHEET TOTALS |
|------------------|----------|---------------|-----------|--------------|
| VIII | COLO. | IR 070-5(050) | | |

DEPARTMENT OF TRANSPORTATION - STATE OF COLORADO SURVEY CONTROL DIAGRAM

Project IR 070-5(050)
 Interstate 70 MP 416.65
 Structures G-26-S and G-26-U
 Sec. 4, T. 9 S., R. 47 W., 6th P.M.
 Kit Carson County, Colorado

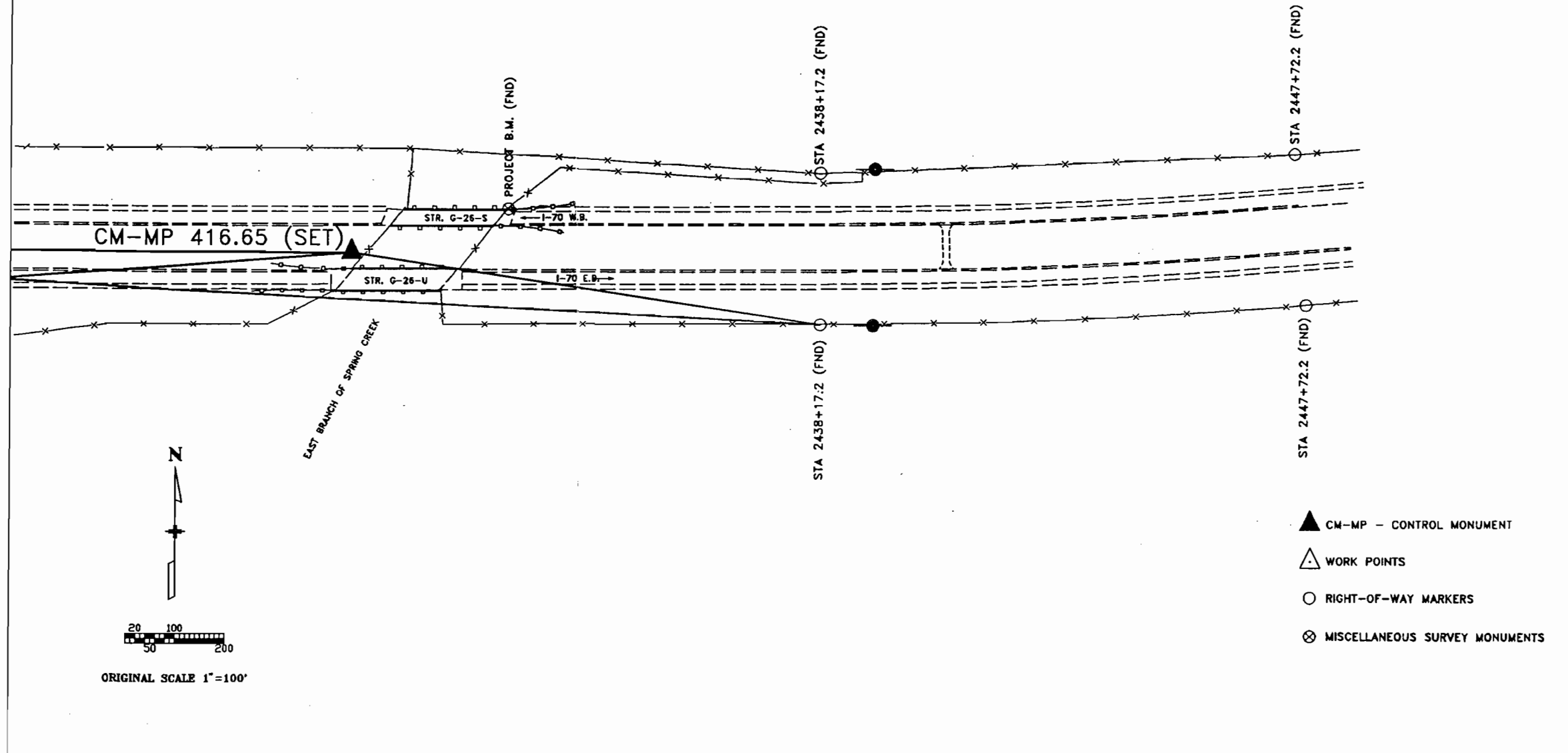

- ▲ CM-MP - CONTROL MONUMENT
- △ WORK POINTS
- RIGHT-OF-WAY MARKERS
- ⊗ MISCELLANEOUS SURVEY MONUMENTS