

FOREST HIGHWAY CONSTRUCTION RECORD

STATE Colorado ROUTE NO. 26
 ROUTE NAME South St. Vrain
 LENGTH 35.3 miles CLASS 2

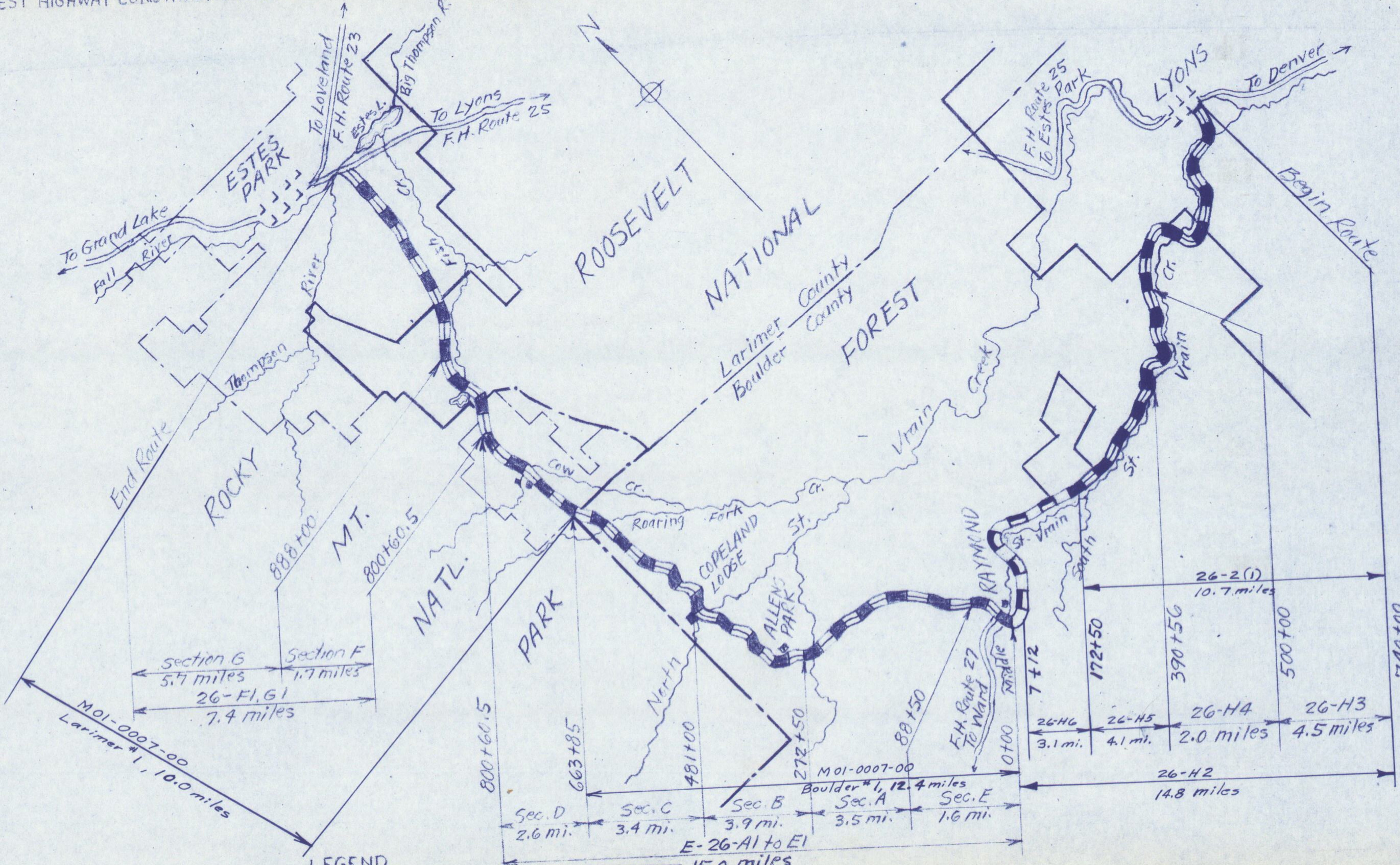

LEGEND

Other ROADS	UNIMPROVED	GRADED	REINFORCED SUBGRADE	BASE COURSE	SURFACE TREATMENT	RD. OR PLANT MIX BIT	CONCRETE
-------------	------------	--------	---------------------	-------------	-------------------	----------------------	----------

Section G 5.7 miles
 Section F 1.7 miles
 26-F1, G1 7.4 miles
 M01-0007-00 Larimer #1, 10.0 miles
 Section D 2.6 mi.
 Section C 3.4 mi.
 Section B 3.9 mi.
 Section A 3.5 mi.
 Section E 1.6 mi.
 E-26-A1 to E1 15.0 miles
 Boulder #1, 12.4 miles
 26-2(i) 10.7 miles
 26-H6 3.1 mi.
 26-H5 4.1 mi.
 26-H4 2.0 miles
 26-H3 4.5 miles
 26-H2 14.8 miles
 800+60.5
 663+85
 481+00
 272+50
 88+50
 0+00
 172+50
 390+56
 500+00
 740+00

FOREST HIGHWAY CONSTRUCTION RECORD

Colorado Forest Highway Route 26, South St. Vrain

DIRECT CONSTRUCTION BY B. P. R.

PROJECT	TYPE	LENGTH MILES	GRADED ROADWAY SH. TO SH.	COMPACTED SURFACING				CONSTRUCTION DATE MONTH AND YEAR		FOREST HIGHWAY FUNDS			OTHER FUNDS	
				WIDTH		THICKNESS		BEGAN	COMPLETED	FOREST HIGHWAY	B. P. R. ACTIVE PROJECTS	OTHER FEDERAL	STATE & LOCAL	
				BASE	TOP	BASE	TOP							
26-A	Cont. Grad. & sel. mat'l. surf.	(3.462)	20'					8-1925	12-1925	29,180.40				
26-B	Cont. Grad. & sel. mat'l. surf.	(3.953)	20'					7-1926	12-1926	65,700.39				
26-C	Cont. Grad. & sel. mat'l. surf.	(3.450)	20'					7-1927	6-1928	67,544.12				
26-D	Cont. Grad. & sel. mat'l. surf.	(2.573)	20'					8-1928	5-1929	26,531.86				
26-E	Cont. Grad. & sel. mat'l. surf.	(1.591)	20'					3-1931	7-1931	36,448.10				
E-26-A1 - E1	Cont. Bit. surf. (plant-mix)	(15.029)			20'		2"	9-1932	7-1933	77,258.99				
NR-26-F	Cont. Grad. & sel. mat'l. surf.	(1.647)	24'					4-1934	10-1934	72,276.34				
26-G	Cont. Grad. & sel. mat'l. surf.	(5.725)*	24'					10-1934	7-1935	152,757.00				
26-H and H1	Cont. Betterments & base treatment	(14.793)	20'		16'		1"	2-1936	10-1936	67,464.73				
26-F1, G1	Cont. Bit. surf. (road-mix)	(7.372)*	24'		20'		2 1/2"	8-1936	10-1936	54,750.00				
26-H2	D.L. Betterments	(14.793)						11-1939	9-1940	42,500.00				
26-I (Transferred to F.H. Route 25)														
26-H3	Cont. Grad. & bit. stab. base	4.547	30'	24'		4"		3-1955	8-1955	444,017.65				
26-H4	Cont. Grad. & bit. stab. base	2.026	32'	26'		4"		4-1956	10-1956	365,653.82				
26-Post Construction--Fiscal Year 1957		(4.546)						2-1956	2-1958	13,798.65				
26-Post Construction--Fiscal Year 1958		(10.644)						8-1957	6-1958	18,696.82				
26-H5	Cont. Grading & bit. stab. base	4.144	32'	26'		4"		1-1960	11-1960	763,367.16				
26-H6	Cont. Grading & bit. stab. base	3.125	36'	32'		4"		6-1962	7-1963	999,523.14				
26-2(1)	Bit. surf.	10.716						4-1965			9,265.00			
SURVEY COSTS										102,490.83				
* 0.152 mile transferred to F.H. Route 25 due to change in Forest Highway System.										3,397,960.00	9,265.00			

