

| Sheet Revisions | | |
|-----------------|-------------|----------|
| Date | Description | Initials |
| | | |
| | | |
| | | |
| | | |
| | | |

| Sheet Revisions | | |
|-----------------|-------------|----------|
| Date | Description | Initials |
| | | |
| | | |
| | | |
| | | |
| | | |

| Right of Way Plans | | | |
|---------------------------------|----------------|--------------|-----------|
| Title Sheet | | | |
| Project Number: NHPP 0402-093 | | | |
| Project Location: US 40 - CRAIG | | | |
| SIGNAL REPLACEMENT | | | |
| Project Code: | Last Mod. Date | Subset | Sheet No. |
| 20969 | 05-18-2016 | 1.01 of 1.01 | 1.01 |

DEPARTMENT OF TRANSPORTATION STATE OF COLORADO

RIGHT OF WAY PLANS OF PROPOSED PROJECT NO. NHPP 0402-093 U.S. HIGHWAY NO. 40 MOFFAT COUNTY

| SHEET NO. | INDEX OF SHEETS |
|-------------------------------------|---|
| 1.01 | (1) Title Sheet |
| - | (NA) Tabulation of Properties |
| 3.01-3.03 | (3) Project Control Diagram |
| 4.01-4.05 | (5) Land Survey Control Diagram |
| - | (NA) Monumentation Sheets |
| - | (NA) Tabulation of Road Approach Sheets |
| 7.01 | (1) Exhibit |
| - | (NA) Ownership Map |
| - | (10) Total Sheets |
| Scales of Original 11"x17" Drawings | |
| Plan Sheets 1"=50' | |

Basis of Bearings: Bearings used in the calculations of coordinates are based on a grid bearing of S88°01'53"E from CM-MP 89.8 to CM-MP 90.6. Both monuments are 1" brass caps, marked appropriately for their milepost location and control position. The survey data was obtained from a Global Positioning System (GPS) survey based on the Colorado High Accuracy Reference Network (CHARN).

1. This Right-of-Way Plan is not a boundary survey of the adjoining property and is prepared for the Colorado Department of Transportation purposes only.
2. For title information, The Colorado Department of Transportation relied on Title Commitments prepared by H.C. Peck & Associates, Inc. for Farnsworth Group.
3. This plan set is subject to change and may not be the most current set. It is the user's responsibility to verify with CDDT that this set is the most current. The information contained on the attached drawing is not valid unless this copy bears an original signature of the Professional Land Surveyor hereon named.

NOTICE: According to Colorado law you must commence any legal action based upon any defect in this survey within three years after you first discover such defect. In no event may any action based upon any defect in this survey be commenced more than ten years from the date of the certification shown hereon.

COLORADO DEPARTMENT OF TRANSPORTATION
STATE HIGHWAY PROJECT
ROW PLANS AUTHORIZED: *[Signature]* 8/4/16
DATE
FOS TIM WILSONMANSON
CDDT RIGHT OF WAY MANAGER

SURVEYOR STATEMENT (PROJECT CONTROL DIAGRAM)
I, Jeffrey P. Eickelman, a professional land surveyor licensed in the State of Colorado, do hereby state to the Colorado Department of Transportation that based upon my knowledge, information and belief, research, calculations and evaluation of the survey evidence were performed and this Right-of-Way Plan was prepared under my responsible charge in accordance with applicable standards of practice defined by Colorado Department of Transportation publications. This statement is not a guaranty or warranty, either expressed or implied.
PLS No. 29034

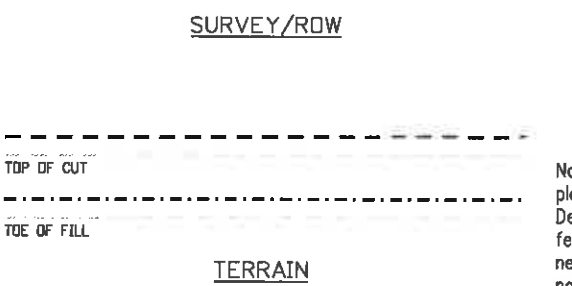
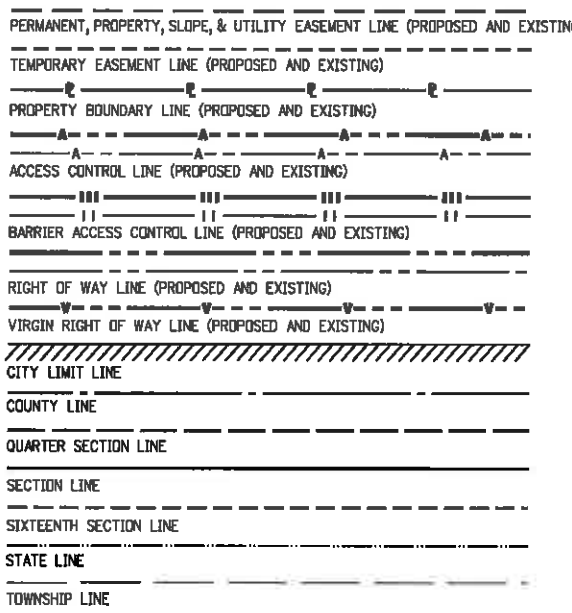
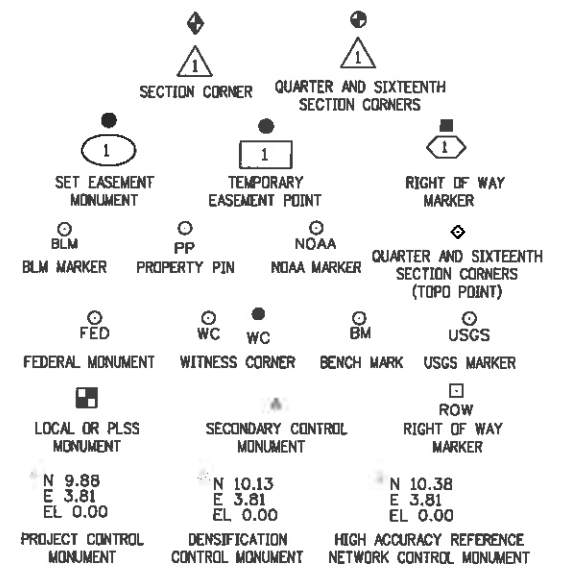
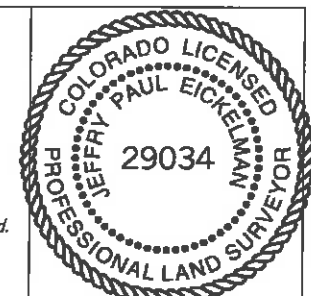

Note: For a complete listing of symbology used within this set of plans, please refer to the M-100-1 Standard Symbols of the Colorado Department of Transportation M&S Standards Publication. Existing topo features are shown as screened weight (gray scale). Proposed or new features are shown as full weight without screening, except as noted with the word (proposed).

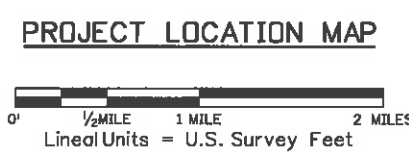

Project Location
US Hwy 40 at
Finley/Mack Lane
M.P. 89.8

Project Location
US Hwy 40 at
State Hwy 13A
M.P. 89.2

Project Location
State Hwy 13 at
6th Street
M.P. 89.9

Project Location
US Hwy 40 at
State Hwy 13B
M.P. 90.6

8/4/2016 8:46:02 AM P:\2015\0151184-00 - Craig Intersections\20969\ROW_Survey\Drawings\20969ROW_TitleSheet.dgn
FILING CERTIFICATION: DEPOSITED THIS DAY OF AT IN BOOK OF THE COUNTY LAND SURVEYS/RIGHT OF WAY SURVEYS AT PAGE RECEPTION NUMBER DEPT.



Sheet Revisions

| Date | Description | Initials |
|------|-------------|----------|
| | | |
| | | |
| | | |
| | | |
| | | |

Sheet Revisions

| Date | Description | Initials |
|------|-------------|----------|
| | | |
| | | |
| | | |
| | | |
| | | |

ENGINEERS
ARCHITECTS
SURVEYORS
SCIENTISTS

Farnsworth
GROUP

4755 FORGE ROAD, SUITE 150
COLORADO SPRINGS, COLORADO 80907
(719) 590-9194 / (719) 590-9111 Fax
www.f-w.com

Project Control Diagram

Title Sheet

Project Number: NHPP 0402-093

Project Location: US 40 - CRAIG

SIGNAL REPLACEMENT

| Project Code: | Last Mod. Date | Subset | Sheet No. |
|---------------|----------------|--------------|-----------|
| 20969 | 05-18-2016 | 3.01 of 3.03 | 3.01 |

DEPARTMENT OF TRANSPORTATION STATE OF COLORADO

PROJECT CONTROL DIAGRAM

US 40 at MM89.3, US 40 at MM89.9, and SH 13 at MM89.8
Sections 35 and 36, Township 7 North, Range 91 West and
Sections 1 and 2, Township 6 North, Range 91 West
of the 6th Principal Meridian
County of Moffat

SHEET NO.

3.01
3.02
3.03

INDEX OF SHEETS

(1) Title Sheet
(1) Coordinate Tables
(1) Plan Sheet
(3) Total Sheets

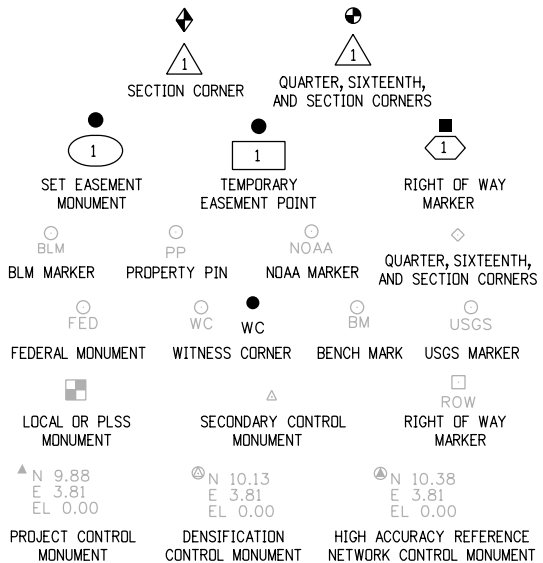

Note: For a complete listing of symbolology used within this set of plans, please refer to the M-100-1 Standard Symbols of the Colorado Department of Transportation M&S Standards Publication dated July 2006. Existing features are shown as screened weight (gray scale). Proposed or new features are shown as full weight without screening.

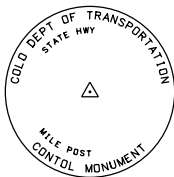

Typical Control Monument Cap
Not to Scale

▲ CM-MP - Control Point Monuments set by CDOT. They are CDOT Type 2 monuments, a 3/4" dia. aluminum control monument cap (as shown) on a 3' x 3/4" dia. aluminum security rod on a 3' x 3/4" dia. smooth aluminum rod.

General Notes:

1. This Project Control Diagram is not a boundary survey of the adjoining property and is prepared for the Colorado Department of Transportation purposes only.
2. This plan set is subject to change and may not be the most current set. It is the user's responsibility to verify with CDOT that this set is the most current. The information contained on the attached drawing is not valid unless this copy bears an original signature of the Professional Land Surveyor hereon named.
3. Refer to the M-629-1 Survey Monuments of the Standard Plans dated July, 2006 found in The Colorado Department of Transportation, M & S Standards for typical survey monument descriptions.

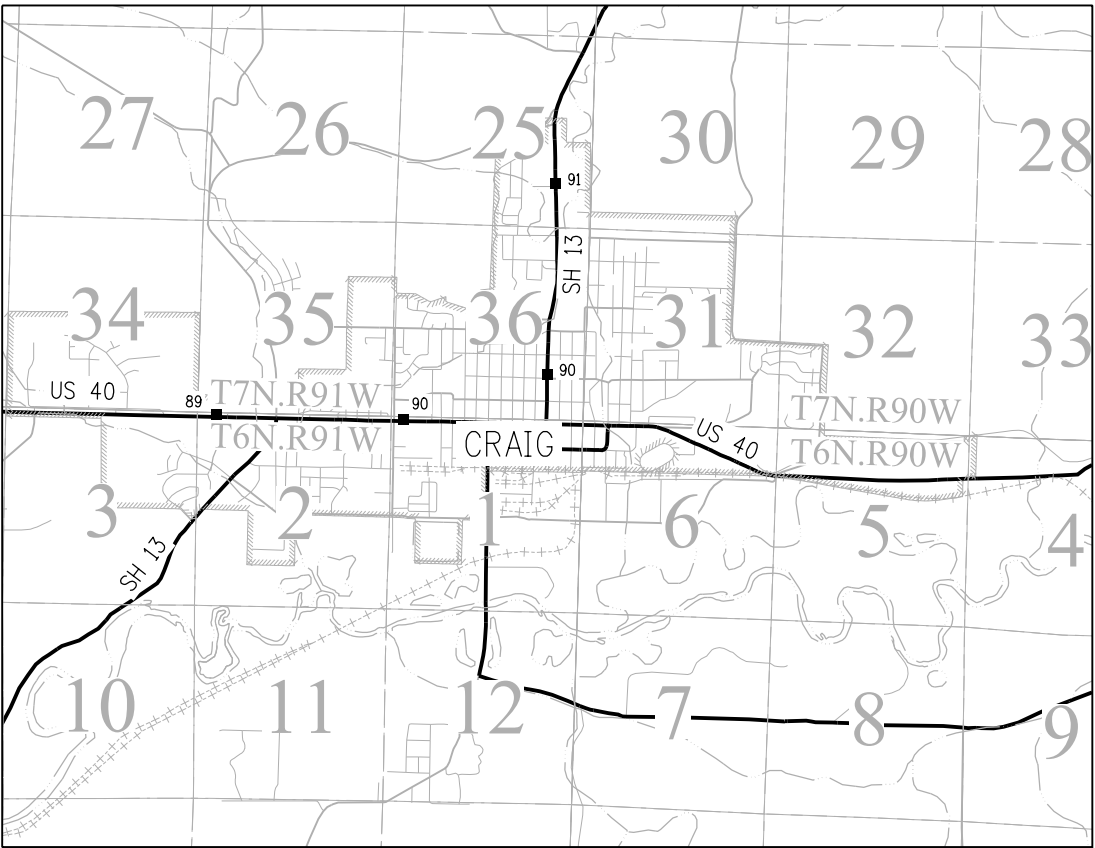

PROJECT LOCATION MAP

0' 1/2 MILE 1 MILE 2 MILES
Lineal Units = U.S. Survey Feet



SURVEYOR STATEMENT (PROJECT CONTROL DIAGRAM)

I, Jeffrey P. Eickelman, a professional land surveyor licensed in the State of Colorado, do hereby state to the Colorado Department of Transportation this Project Control Diagram was prepared and the field survey it represents was performed under my responsible charge and, based upon my knowledge, information and belief is in accordance with applicable standards of practice defined by Colorado Department of Transportation publications. This statement is not a guaranty or warranty, either expressed or implied.

PLS No. 29034



| Sheet Revisions | | |
|-----------------|-------------|----------|
| Date | Description | Initials |
| | | |
| | | |
| | | |
| | | |
| | | |
| | | |

| Sheet Revisions | | |
|-----------------|-------------|----------|
| Date | Description | Initials |
| | | |
| | | |
| | | |
| | | |
| | | |
| | | |

ENGINEERS
ARCHITECTS
SURVEYORS
SCIENTISTS

Farnsworth
GROUP

1099 MAIN AVE. SUITE 302
DURANGO, CO 81301
(970) 403-5822 / (719) 591-9111 Fax
www.f-w.com

| Project Control Diagram | | | | |
|---------------------------------|----------------|--------------|-----------|--|
| Coordinate Tables | | | | |
| Project Number: NHPP 0402-093 | | | | |
| Project Location: US 40 - CRAIG | | | | |
| SIGNAL REPLACEMENT | | | | |
| Project Code: | Last Mod. Date | Subset | Sheet No. | |
| 20969 | 05-18-2016 | 3.02 of 3.03 | 3.02 | |

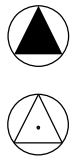

| CHARN GEODETIC COORDINATE SUMMARY TABLE | | | | | | | | | | | |
|---|---|-------------------|---------------------------|----------------------------|---------------|-------------------|-----------------------------|----------------|----------------------|---------------------|--------------------------|
| Point No. | Geodetic Coordinates NAD-83(2011) (CHARN) | | Elip Height (NAVD88) (ft) | Ortho Height (NAVD88) (ft) | Mapping Angle | Grid Scale Factor | NAD83(2011) North Zone 0501 | | Project Coordinates | | Description |
| | Latitude(N) | Longitude(W) | | | | | SP Northing(ft) | SP Easting(ft) | Northing(SurveyFeet) | Easting(SurveyFeet) | |
| CAG B | 40°29'36.08720" | -107°31'28.86541" | 6138.531 | 6186.38 | -1°18'30" | 0.999672949 | 1428999.103 | 2436929.779 | 29467.617 | 437728.780 | FOUND DEEP ROD (PACS) |
| M 154 | 40°29'07.32377" | -107°33'46.78370" | 6337.476 | 6385.51 | -1°19'59" | 0.999662882 | 1426334.722 | 2426209.682 | 26802.367 | 427005.216 | USGS BENCHMARK M154 1934 |

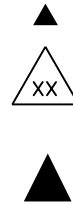

| GEODETIC COORDINATE TABLE | | | | | | | | | | | |
|---------------------------|---|-------------------|---------------------------|----------------------------|---------------|-------------------|-----------------------------|----------------|----------------------|---------------------|--|
| Point No. | Geodetic Coordinates NAD-83(2011) (CHARN) | | Elip Height (NAVD88) (ft) | Ortho Height (NAVD88) (ft) | Mapping Angle | Grid Scale Factor | NAD83(2011) North Zone 0501 | | Project Coordinates | | Description |
| | Latitude(N) | Longitude(W) | | | | | SP Northing(ft) | SP Easting(ft) | Northing(SurveyFeet) | Easting(SurveyFeet) | |
| CAG B | 40°29'36.08720" | -107°31'28.86541" | 6138.531 | 6186.38 | -1°18'30" | 0.999672949 | 1428999.103 | 2436929.779 | 29467.639 | 437728.792 | FOUND DEEP ROD (PACS) |
| M154 | 40°29'07.32377" | -107°33'46.78370" | 6337.476 | 6385.51 | -1°19'59" | 0.999662882 | 1426334.722 | 2426209.682 | 26802.384 | 427005.180 | USGS BENCHMARK M154 1934 |
| M898 | 40°30'51.41592" | -107°33'46.59598" | 6138.456 | 6186.80 | -1°19'59" | 0.999674562 | 1436865.238 | 2426469.218 | 37336.354 | 427264.803 | FOUND CDOT TYPE 5(S) MOMUMENT - M898 US40 |
| M899 | 40°30'58.44751" | -107°32'50.67195" | 6147.190 | 6195.40 | -1°19'22" | 0.999674303 | 1437476.525 | 2430803.699 | 37947.840 | 431600.704 | FOUND CDOT TYPE 5(S) MOMUMENT - M899 SH13B |
| M902 | 40°30'51.55876" | -107°33'15.53279" | 6141.656 | 6190.00 | -1°19'39" | 0.999674413 | 1436823.997 | 2428868.028 | 37295.100 | 429664.398 | FOUND CDOT TYPE 5(S) MOMUMENT - M902 |
| M906 | 40°30'50.92169" | -107°32'48.67701" | 6144.298 | 6192.44 | -1°19'21" | 0.999674273 | 1436711.585 | 2430940.151 | 37182.650 | 431737.200 | FOUND CDOT TYPE 5(S) MONUMENT - M906 |

Project Coordinates Northing US Survey Feet = (State Plane Coordinate Northing * 1.000327877 - 1,400,000).
Project Coordinates Easting US Survey Feet = (State Plane Coordinate Easting * 1.000327877 - 2,000,000).



| PROJECT COORDINATE TABLE | | | | |
|--------------------------|---------------------|-------------|-------------------|--|
| Point No. | Project Coordinates | | Elev(ft) (NAVD88) | Description |
| | Northing(ft) | Easting(ft) | | |
| CAG B | 29467.639 | 437728.792 | 6186.38 | FOUND DEEP ROD (PACS) |
| M154 | 26802.384 | 427005.180 | 6385.51 | USGS BENCHMARK M154 1934 |
| M898 | 37336.409 | 427264.820 | 6186.80 | FOUND CDOT TYPE 5(S) CONTROL MONUMENT - M898 US40 |
| M899 | 37947.840 | 431600.704 | 6195.40 | FOUND CDOT TYPE 5(S) CONTROL MONUMENT - M899 SH13B |
| M902 | 37295.090 | 429664.406 | 6190.00 | FOUND CDOT TYPE 5(S) CONTROL MONUMENT - M902 |
| M906 | 37182.691 | 431737.190 | 6192.44 | FOUND CDOT TYPE 5(S) CONTROL MONUMENT - M906 |

| SUPPLEMENTAL PROJECT COORDINATE TABLE | | | | |
|---------------------------------------|---------------------|-------------|-------------------|--|
| Point No. | Project Coordinates | | Elev(ft) (NAVD88) | Description |
| | Northing(ft) | Easting(ft) | | |
| M903 | 37279.817 | 429905.686 | 6190.52 | CDOT TYPE 5(S) PROJECT CONTROL MONUMENT - M903 |
| 300 | 37249.980 | 431592.990 | 6191.84 | USGS BENCHMARK M154 1934 |
| 301 | 37182.060 | 431661.700 | 6192.02 | FOUND CDOT TYPE 5S CONTROL MONUMENT - M898 SH13B |
| 302 | 37864.930 | 431659.120 | 6194.14 | FOUND CDOT TYPE 5S CONTROL MONUMENT - M899 SH13B |



222 South 6th Street
Grand Junction, CO 81501
Phone: 970-683-6234 FAX: 970-683-6249

Region 3

LED

Sheet Revisions

| Date | Description | Initials |
|------|-------------|----------|
| | | |
| | | |
| | | |
| | | |
| | | |
| | | |

Sheet Revisions

| Date | Description | Initials |
|------|-------------|----------|
| | | |
| | | |
| | | |
| | | |
| | | |
| | | |

ENGINEERS
ARCHITECTS
SURVEYORS
SCIENTISTS



4755 FORGE ROAD, SUITE 150
COLORADO SPRINGS, COLORADO 80907
(719) 590-9194 / (719) 590-9111 Fax
www.f-w.com

Project Control Diagram

Plan Sheet

Project Number: NHPP 0402-093

Project Location: US 40 - CRAIG

SIGNAL REPLACEMENT

| Project Code: | Last Mod. Date | Subset | Sheet No. |
|---------------|----------------|--------------|-----------|
| 20969 | 05-18-2016 | 3.03 of 3.03 | 3.03 |

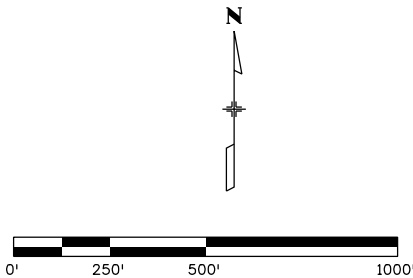

35

36

T7N.R91W

T6N.R91W

2

1

MP 89.8
N:37336.35
E:427264.80
EL:6186.80

US HWY 40

MP 90.2
N:37295.10
E:429664.40
EL:6190.00

MP 90.3
N:37279.82
E:429905.69
EL:6190.52

MP 89.9
N:37947.84
E:431600.70
EL:6195.40

302
N:37864.93
E:431659.12
EL:6194.14

300
N:37249.98
E:431592.99
EL:6191.84

MP 90.6
N:37182.65
E:431737.20
EL:6192.44

301
N:37182.06
E:431661.70
EL:6192.02

GPS M154
N:26802.38
E:427005.18
EL:6385.51

GPS CAG B
N:29467.64
E:437728.79
EL:6186.38





Sheet Revisions

| Date | Description | Initials |
|------|-------------|----------|
| | | |
| | | |
| | | |
| | | |
| | | |

Sheet Revisions

| Date | Description | Initials |
|------|-------------|----------|
| | | |
| | | |
| | | |
| | | |
| | | |

ENGINEERS
ARCHITECTS
SURVEYORS
SCIENTISTS

Farnsworth
GROUP

4755 FORGE ROAD, SUITE 150
COLORADO SPRINGS, COLORADO 80907
(719) 590-9194 / (719) 590-9111 Fax
www.f-w.com

Land Survey Control Diagram

Title Sheet

Project Number: NHPP 0402-093

Project Location: US 40 - CRAIG

SIGNAL REPLACEMENT

| Project Code: | Last Mod. Date | Subset | Sheet No. |
|---------------|----------------|--------------|-----------|
| 20969 | 05-18-2016 | 4.01 of 4.05 | 4.01 |

DEPARTMENT OF TRANSPORTATION STATE OF COLORADO

LAND SURVEY CONTROL DIAGRAM

US 40 at MM89.3, US 40 at MM89.9, and SH 13 at MM89.8
Sections 35 and 36, Township 7 North, Range 91 West and
Sections 1 and 2, Township 6 North, Range 91 West
of the 6th Principal Meridian
County of Moffat

SHEET NO.

4.01
4.02
4.03-4.05

INDEX OF SHEETS

- (1) Title Sheet
(1) Monument Coordinate Tables
(3) Plan Sheet
(5) Total Sheets

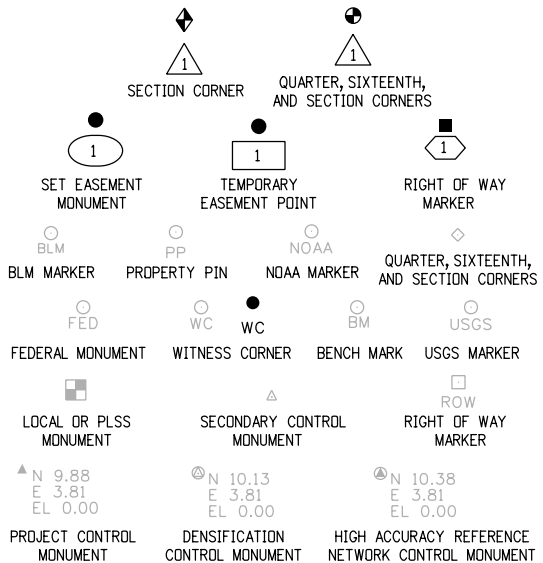

Note: For a complete listing of symbology used within this set of plans, please refer to the M-100-1 Standard Symbols of the Colorado Department of Transportation M&S Standards Publication. Existing features are shown as screened weight (gray scale). Proposed or new features are shown as full weight without screening.

General Notes:

1. This Land Survey Control Diagram is not a boundary survey of the adjoining property and is prepared for the Colorado Department of Transportation purposes only. No determination has been made to determine if the found monuments as shown are in their proper position or if they are at the corners they are intended to monument.
2. Title policy, title commitment, and title research are not part of this survey, therefore easements, rights, and restrictions of record were not researched and are not shown on this diagram. The verification of the physical evidence with relation to easements, rights of ways, property boundaries, and restrictions, as described in the instruments of record, were not included in this control survey.
3. This plan set is subject to change and may not be the most current set. It is the user's responsibility to verify with CDOT that this set is the most current. The information contained on the attached drawing is not valid unless this copy bears an original signature of the Professional Land Surveyor hereon named.
4. Refer to the M-629-1 Survey Monuments of the Standard Plans found in The Colorado Department of Transportation, M & S Standards for typical survey monument descriptions.

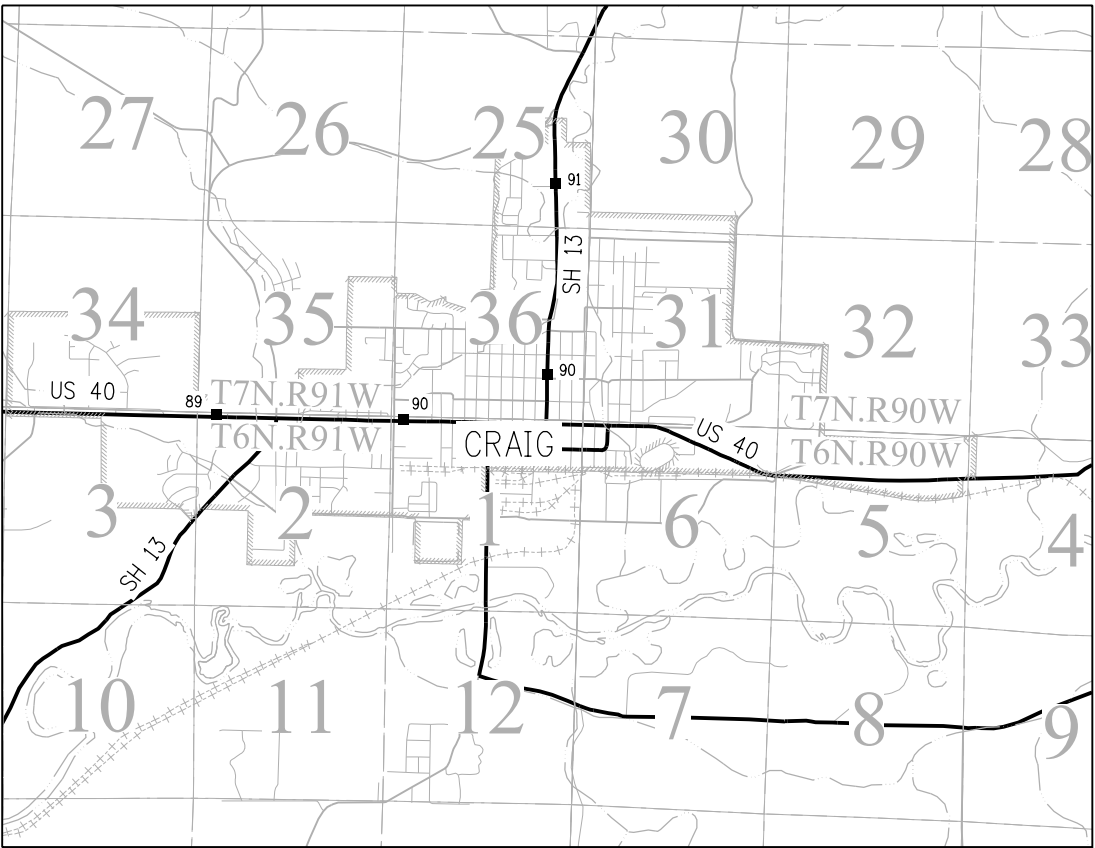

PROJECT LOCATION MAP



SURVEYOR STATEMENT (PROJECT CONTROL DIAGRAM)

I, Jeffrey P. Eickelman, a professional land surveyor licensed in the State of Colorado, do hereby state to the Colorado Department of Transportation this Land Survey Control Diagram was prepared and the field survey it represents was performed under my responsible charge and, based upon my knowledge, information and belief is in accordance with applicable standards of practice defined by Colorado Department of Transportation publications. This statement is not a guaranty or warranty, either expressed or implied.

PLS No. 29034





222 South 6th Street
Grand Junction, CO 81501
Phone: 970-683-6234 FAX: 970-683-6249

Region 3

LED

Sheet Revisions

| Date | Description | Initials |
|------|-------------|----------|
| | | |
| | | |
| | | |
| | | |
| | | |
| | | |

Sheet Revisions

| Date | Description | Initials |
|------|-------------|----------|
| | | |
| | | |
| | | |
| | | |
| | | |
| | | |

ENGINEERS
ARCHITECTS
SURVEYORS
SCIENTISTS



1099 MAIN AVE. SUITE 302
DURANGO, CO 81301
(970) 403-5822 / (719) 591-9111 Fax
www.f-w.com

Land Survey Control Diagram

Monument Coordinate Tables

Project Number: NHPP 0402-093

Project Location: US 40 - CRAIG

SIGNAL REPLACEMENT

| Project Code: | Last Mod. Date | Subset | Sheet No. |
|---------------|----------------|--------------|-----------|
| 20969 | 05-18-2016 | 4.02 of 4.05 | 4.02 |

◇

FOUND ALIQUOT MONUMENT COORDINATE TABLE

| Point No. | Northing(ft) | Easting(ft) | Description |
|-----------|--------------|-------------|-------------------------------|
| 31569 | 37287.45 | 427333.96 | NO. 4 REBAR IN BOX |
| 31575 | 37244.39 | 429980.91 | RANGE BOX FULL OF WATER |
| 31604 | 37201.37 | 432626.11 | 2" ALUMINUM CAP - NOT LEGIBLE |

○

FOUND MISC. MONUMENT COORDINATE TABLE

| Point No. | Northing(ft) | Easting(ft) | Description |
|-----------|--------------|-------------|---------------------------------|
| 32594 | 37403.48 | 424101.54 | 3" BRASS CAP - POSSIBLE CDOT BM |
| | | | |
| | | | |
| | | | |
| | | | |
| | | | |

○
PP

FOUND BOUNDARY MONUMENT COORDINATE TABLE

| Point No. | Northing(ft) | Easting(ft) | Description |
|-----------|--------------|-------------|--------------------------------------|
| 31100 | 37176.23 | 431885.47 | 1.25" WASHER - PLS 14815 |
| 31421 | 37851.52 | 431866.21 | NO. 4 REBAR - NO CAP |
| 31422 | 37852.46 | 431821.36 | 1.25" YPC - EPPR ASSOC. INC. |
| 31518 | 37253.32 | 431441.44 | MAG NAIL |
| 31519 | 37253.73 | 431416.45 | MAG NAIL |
| 31560 | 37289.20 | 429593.13 | 1.25" YPC - NOT LEGIBLE |
| 31561 | 37288.31 | 429659.65 | 2" PIPE IN CONCRETE |
| 31562 | 37309.41 | 428961.30 | 1.5" WASHER - EPP & ASSOC. PLS 14815 |
| 31563 | 37313.77 | 428691.14 | 1.25" YPC - EPP & ASSOC. PLS 14815 |
| 31565 | 37316.39 | 428531.34 | 1.5" WASHER - EPP & ASSOC. PLS 14815 |
| 31567 | 37336.36 | 427379.99 | 1" OPC - LW POWERS PLS 13901 |
| 31570 | 37936.16 | 427393.06 | 1" OPC - LW POWERS PLS 13901 |
| 31578 | 36731.25 | 431578.57 | 1/4" STEEL ROD IN CONCRETE |
| 31581 | 36956.04 | 431581.64 | 1.25" ALUM. WASHER - PLS14815 |
| 31584 | 37006.06 | 431582.51 | 1.25" ALUM. WASHER - PLS14815 |
| 31587 | 36930.04 | 431659.20 | 1/4" IRON ROD - POSSIBLE 2' WC |
| 31590 | 38624.66 | 431689.00 | NO. 5 REBAR - NO CAP |
| 31591 | 38774.46 | 431691.31 | 1.25" YPC - EPP & ASSOC. PLS 14815 |
| 31592 | 38824.71 | 431692.24 | 1" STEEL ROD |
| 31593 | 38874.66 | 431692.52 | 2" O.D. PIPE |
| 31594 | 39000.91 | 431614.88 | NO. 5 REBAR W/ RPC - NOT LEGIBLE |
| 31595 | 38751.24 | 431611.52 | NO. 5 REBAR - NO CAP |
| 31596 | 38416.52 | 431605.32 | NO. 4 REBAR - NO CAP |
| 31597 | 38316.18 | 431604.13 | 1.25" YPC - EPP & ASSOC. PLS 14815 |
| 31598 | 37234.96 | 427668.49 | CHISELD CROSS |
| 31599 | 37233.13 | 427784.39 | 1.25" YPC - EPP & ASSOC. PLS 14815 |
| 31600 | 37322.98 | 428145.46 | NO. 5 REBAR - NO CAP |
| 31602 | 37227.09 | 428149.23 | NO. 5 REBAR - NO CAP |
| 32238 | 37446.20 | 423954.63 | NO. 5 REBAR W/ RPC - NOT LEGIBLE |
| 32445 | 37204.68 | 423977.26 | NO. 5 REBAR W/ RPC - NOT LEGIBLE |
| 32980 | 37044.67 | 427093.17 | NO. 5 REBAR W/ YPC - PLS 14823 |
| 32981 | 37040.32 | 427301.30 | NO. 5 REBAR - BENT, NO CAP |
| 32987 | 37443.49 | 423868.18 | NO. 5 REBAR - NO CAP |



222 South 6th Street
Grand Junction, CO 81501
Phone: 970-683-6234 FAX: 970-683-6249

Region 3

LED

Sheet Revisions

| Date | Description | Initials |
|------|-------------|----------|
| | | |
| | | |
| | | |
| | | |
| | | |

Sheet Revisions

| Date | Description | Initials |
|------|-------------|----------|
| | | |
| | | |
| | | |
| | | |
| | | |

ENGINEERS
ARCHITECTS
SURVEYORS
SCIENTISTS

Farnsworth
GROUP

1099 MAIN AVE. SUITE 302
DURANGO, CO 81301
(970) 403-5822 / (719) 591-9111 Fax
www.f-w.com

Land Survey Control Diagram

Plan Sheet

Project Number: NHPP 0402-093

Project Location: US 40 - CRAIG

SIGNAL REPLACEMENT

| Project Code: | Last Mod. Date | Subset | Sheet No. |
|---------------|----------------|--------------|-----------|
| 20969 | 05-18-2016 | 4.03 of 4.05 | 4.03 |

WEST LINE, SW 1/4, SEC. 35

EAST LINE, SW 1/4, SEC. 35
(PROJECTED)

WEST LINE, NW 1/4, SEC. 2

EAST LINE, NW 1/4, SEC. 2
(PROJECTED)

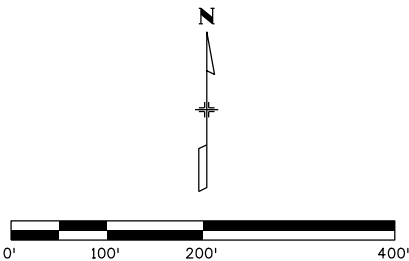

SW 1/4 SEC 35
T-7-N R-91-W
6th PM

065735300011
SCHERR, PIUS
MISC. CRAIG TRACTS

SOUTH LINE, SW 1/4, SEC. 35
(PROJECTED)

US 40

COUNTY ROAD 7

STATE HIGHWAY 13

32445
PP

32238
PP
32987
PP

32991
PP

BM 32594

085502200005
SUNSTONE OUTPARCEL, LLC
PART OF LOTS 3-5, BLOCK 5
RIVERVIEW SUBDIVISION

085502210001
THOMPSON, J.
LOT 1
TUCKER MINOR

085502210002
TUCKER, BLAINE A.
LOT 4
TUCKER MINOR

NW 1/4 SEC 2
T-6-N R-91-W
6th PM



222 South 6th Street
Grand Junction, CO 81501
Phone: 970-683-6234 FAX: 970-683-6249

Region 3

LED

Sheet Revisions

| Date | Description | Initials |
|------|-------------|----------|
| | | |
| | | |
| | | |
| | | |
| | | |

Sheet Revisions

| Date | Description | Initials |
|------|-------------|----------|
| | | |
| | | |
| | | |
| | | |
| | | |

ENGINEERS
ARCHITECTS
SURVEYORS
SCIENTISTS

Farnsworth
GROUP

1099 MAIN AVE. SUITE 302
DURANGO, CO 81301
(970) 403-5822 / (719) 591-9111 Fax
www.f-w.com

Land Survey Control Diagram

Plan Sheet

Project Number: NHPP 0402-093

Project Location: US 40 - CRAIG

SIGNAL REPLACEMENT

| Project Code: | Last Mod. Date | Subset | Sheet No. |
|---------------|----------------|--------------|-----------|
| 20969 | 05-18-2016 | 4.04 of 4.05 | 4.04 |

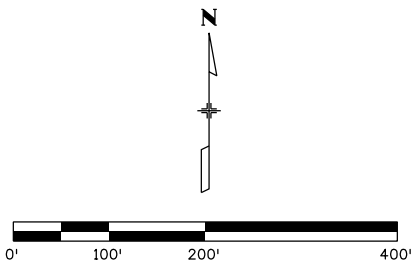

SE 1/4 SEC 35
T-7-N R-91-W
6th PM

SW 1/4 SEC 36
T-7-N R-91-W
6th PM

NW 1/4 SEC 1
T-6-N R-91-W
6th PM

5/20/2016 10:10:34 AM P:\2015\0151184.00 - Craig Intersections\20969\ROW_Survey\Drawings\20969SURV_LSCD-Plan02.dgn



222 South 6th Street
Grand Junction, CO 81501
Phone: 970-683-6234 FAX: 970-683-6249

Region 3

LED

Sheet Revisions

| Date | Description | Initials |
|------|-------------|----------|
| | | |
| | | |
| | | |
| | | |
| | | |
| | | |

Sheet Revisions

| Date | Description | Initials |
|------|-------------|----------|
| | | |
| | | |
| | | |
| | | |
| | | |
| | | |

ENGINEERS
ARCHITECTS
SURVEYORS
SCIENTISTS



Farnsworth
GROUP
1099 MAIN AVE. SUITE 302
DURANGO, CO 81301
(970) 403-5822 / (719) 591-9111 Fax
www.f-w.com

Land Survey Control Diagram

Plan Sheet

| | | | |
|---------------------------------|----------------|--------------|-----------|
| Project Number: NHPP 0402-093 | | | |
| Project Location: US 40 - CRAIG | | | |
| SIGNAL REPLACEMENT | | | |
| Project Code: | Last Mod. Date | Subset | Sheet No. |
| 20969 | 05-18-2016 | 4.05 of 4.05 | 4.05 |

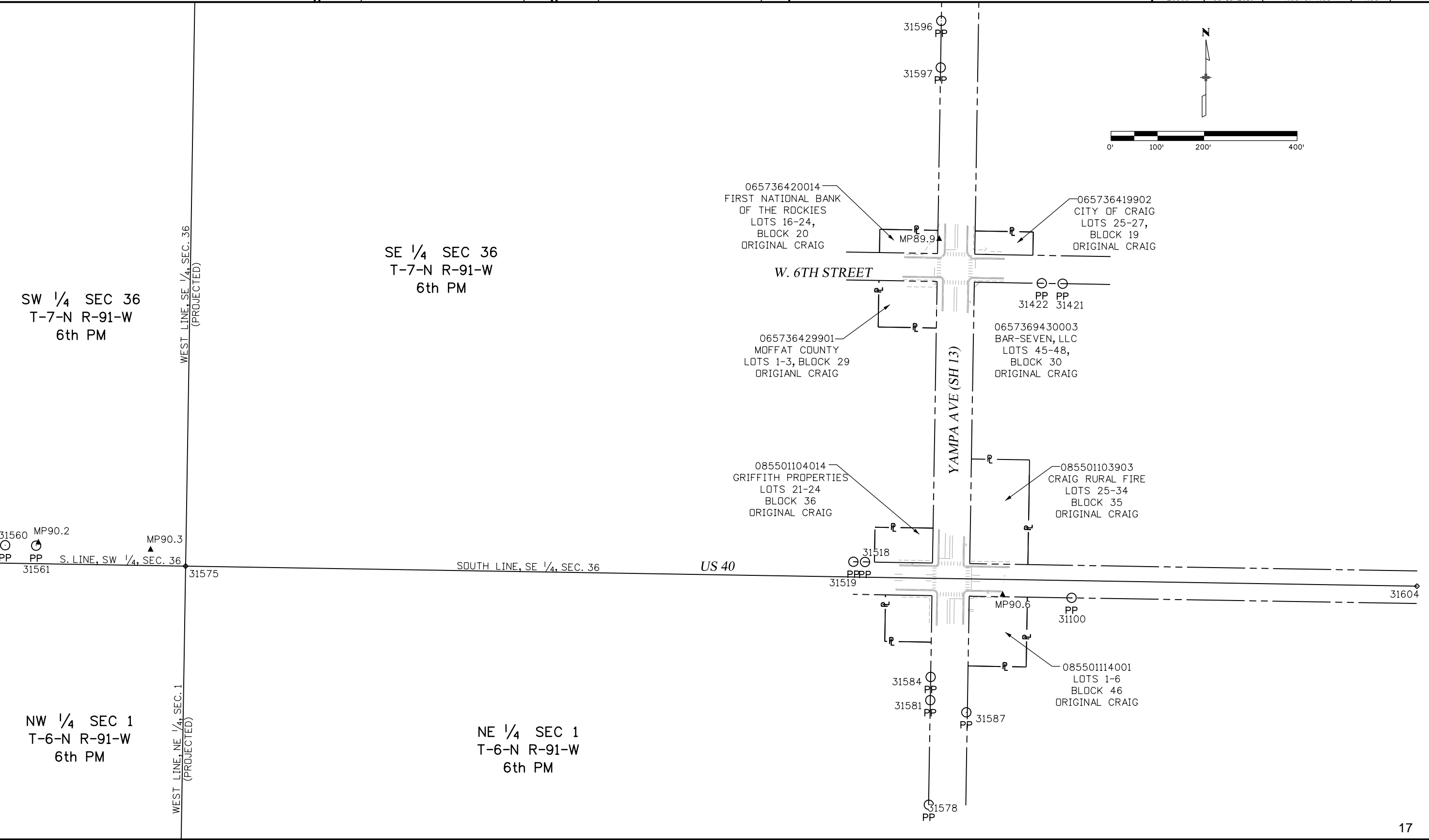

5/20/2016 10:10:35 AM P:\2015\0151184.00 - Craig Intersections\20969 ROW_Survey\Drawings\20969SURV_LSCD-Plan03.dgn

| Sheet Revisions | | |
|-----------------|-------------|----------|
| Date | Description | Initials |
| | | |
| | | |
| | | |
| | | |
| | | |

| Sheet Revisions | | |
|-----------------|-------------|----------|
| Date | Description | Initials |
| | | |
| | | |
| | | |
| | | |
| | | |

| Right of Way Plans | | | |
|---------------------------------|----------------|--------------|-----------|
| Exhibit | | | |
| Project Number: NHPP 0402-093 | | | |
| Project Location: US 40 - CRAIG | | | |
| SIGNAL REPLACEMENT | | | |
| Project Code: | Last Mod. Date | Subset | Sheet No. |
| 20969 | 05-18-2016 | 7.01 of 7.01 | 7.01 |

| TABULATION OF TEMPORARY EASEMENT POINTS TO BE STAKED | | | |
|--|--------------|-------------|--------------------------|
| Point No. | Northing(ft) | Easting(ft) | Description |
| 500 | 37914.81 | 431677.31 | TEMPORARY EASEMENT STAKE |
| 501 | 37922.81 | 431677.44 | TEMPORARY EASEMENT STAKE |
| 502 | 37922.64 | 431687.44 | TEMPORARY EASEMENT STAKE |
| 503 | 37914.64 | 431687.31 | TEMPORARY EASEMENT STAKE |

