

| Computer File Information           |                                |
|-------------------------------------|--------------------------------|
| Creation Date: MAR/23/1998          | Initials: KAW                  |
| Last Modification Date: MAR/30/1998 | Initials: KAW                  |
| Full Path: D:\11957\CSD\            |                                |
| Drawing File Name: 11957CSD         |                                |
| Acad Ver. 13_c4                     | Scale: 1cm = 50m Units: METERS |

Colorado Department of Transportation  
 Region I Right of Way  
 18500 E. COLFAX  
 AURORA, CO 80011  
 Phone: 303-757-9744 FAX: 303-757-9746  
 Survey Coordinator Joseph P. Conway



| Revisions |  |
|-----------|--|
|           |  |
|           |  |
|           |  |
|           |  |

| Revisions |  |
|-----------|--|
|           |  |
|           |  |
|           |  |
|           |  |

| CONTROL SURVEY DIAGRAM PLAN SHEET |               |
|-----------------------------------|---------------|
| NH 2854-070                       |               |
| Kenosha Pass - Jct. S.H. 9        |               |
| Project Code: 11957               | Sheet Number: |

SH 285 MP 182.9 to MP 199.2  
 Jefferson Site - Secs. 5 and 8, T 8 S, R 75 W, 6th P.M.  
 Michigan Hill Road Site - Sec. 18, T 8 S, R 75 W, 6th P.M.  
 Elkhorn Road Site - Secs. 33 and 34, T 8 S, R 76 W, 6th P.M.  
 Fairplay Site - Secs. 33 and 34, T 9 S, R 77 W, 6th P.M.  
 PARK COUNTY, COLORADO

GEODETTIC COORDINATE SUMMARY TABLE  
 (ADJUSTED FIELD DATA)

| POINT NAME                     | GEODETTIC COORDINATES NAD-83(92) (CHARN) |                      | ELEV. (NAVD '88)m | MAPPING ANGLE     | SCALE       | NAD 83(92) ZONE 0502 |             |
|--------------------------------|--|----------------------|-------------------|-------------------|-------------|----------------------|-------------|
|                                | LATITUDE(N)                              | LONGITUDE(W)         |                   |                   |             | NORTHING (m)         | EASTING (m) |
| BURNETT P&C LS 11944           | 39° 13' 15.75711" N                      | 105° 59' 36.19056" W | 3013.637          | -0° 18' 40.22483" | 0.999938096 | 458962.670           | 871797.700  |
| DOH ROW STA 364+06.7           | 39° 13' 16.18925" N                      | 105° 59' 40.76269" W | 3016.656          | -0° 18' 43.10843" | 0.999938101 | 459976.592           | 871688.106  |
| DOH ROW STA 497+60             | 39° 18' 41.87919" N                      | 105° 53' 6.34591" W  | 2947.924          | -0° 14' 34.35389" | 0.999942645 | 468974.060           | 881191.173  |
| DOH ROW STA 509+60             | 39° 18' 52.40094" N                      | 105° 52' 59.15336" W | 2969.085          | -0° 14' 29.81762" | 0.999942834 | 469297.793           | 881364.841  |
| US 285 CM-MP 192.68            | 39° 18' 58.57635" N                      | 105° 52' 51.94296" W | 2972.303          | -0° 14' 25.27010" | 0.999942945 | 469487.500           | 881538.361  |
| US 285 CM-MP 196.8             | 39° 21' 10.91370" N                      | 105° 49' 36.15807" W | 2886.228          | -0° 12' 21.79061" | 0.999945555 | 473551.182           | 886242.839  |
| DOH ROW STA 760+06.3           | 39° 21' 20.08927" N                      | 105° 49' 17.40361" W | 2889.232          | -0° 12' 9.96237"  | 0.999945752 | 473831.533           | 886692.849  |
| BURNETT P&C LS 11944           | 39° 21' 33.17438" N                      | 105° 49' 2.60170" W  | 2887.214          | -0° 12' 0.62696"  | 0.999946035 | 474233.801           | 887048.624  |
| DOH ROW STA 850+82.4           | 39° 22' 31.51510" N                      | 105° 48' 10.37937" W | 2896.959          | -0° 11' 27.69088" | 0.999947347 | 476021.630           | 888304.789  |
| DOH ROW NO STATION             | 39° 22' 31.50262" N                      | 105° 48' 8.69921" W  | 2896.041          | -0° 11' 26.63122" | 0.999947346 | 476021.112           | 888345.001  |
| FHWA "T-250"                   | 39° 22' 32.57229" N                      | 105° 48' 7.69316" W  | 2896.701          | -0° 11' 25.99672" | 0.999947371 | 47606.018            | 888369.189  |
| ROW "302" PROJ "BRF 285-4(30)" | 39° 22' 43.67141" N                      | 105° 47' 56.53878" W | 2899.342          | -0° 11' 18.96176" | 0.999947630 | 47640.408            | 888637.281  |

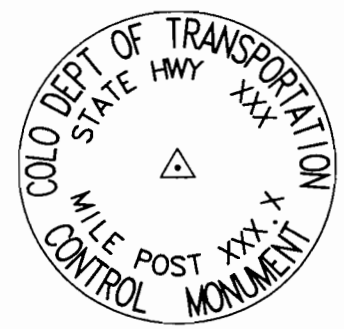

TYPICAL:  
 CM-MP - Control Monuments were set by CDDT. They were CDDT type 2 monuments, a 3-1/4" dia. aluminum control monument cap (as shown) on a 3" X 3/4" dia. flinned aluminum security rod on a 3" X 3/4" dia. smooth aluminum rod.

BASIS OF BEARINGS: Bearings used in the calculation of coordinates are based on a grid bearing of N 57°59'09" E from US 285 CM-MP 196.8 to DOH ROW Sta 760+06.3 as obtained from a Global Positioning System (GPS) survey based on the Colorado High Accuracy Reference Network (CHARN).

BASIS OF ELEVATIONS: Project is based on a U.S. Coast and Geodetic Survey (USCGS) benchmark L 303 1951 a 3-1/4" brass cap set in concrete irrigation headwall with an NAVD '88 and project elevation of 2895.475m. L 303 1951 is part of Colorado Line 89, a first order second class line leveled in 1951.

COORDINATE DATUM: Project coordinates are modified Colorado State Plane Central Zone NAD '83(92) coordinates. State Plane coordinates were modified to a mean project elevation of 2930.000m. The combined elevation/scale correction factor used to modify the coordinates was 1.000515548. Project Coordinates were truncated by 400,000 in the Northing and 800,000 in the Easting after conversion from state plane coordinates. The CHARN is based on the NAD '83 (92) datum.

NOTE: The topography for the Jefferson Site, Michigan Hill Road Site and Elkhorn Road Site was surveyed by Mountain Surveying and Mapping, 8751 E. Hampden Ave., Suite B-1, Denver, CO, 80231 (303)306-1858. The Fairplay Site was surveyed by Colorado Department of Transportation personnel.

NOTE: This control survey is for the use of Colorado Department of Transportation personnel. The survey is not a complete boundary survey and does not subdivide land. Title policy, title commitment, and title research were not part of this control survey, therefore, easements, rights, and restrictions of record are not shown. The verification of the physical evidence with relation to easements, rights of way, property boundaries, and restrictions, as described in the instruments of record, was not included in this control survey.

NOTE: According to Colorado law you must commence any legal action based upon any defect in this survey within three years after you first discover such defect. In no event may any action based upon any defect in this survey be commenced more than ten years from the date of the statement shown.

SURVEYORS STATEMENT: I, Kevin A. Williams, a Professional Land Surveyor in the State of Colorado, hereby state that this Control Survey Diagram was prepared under my supervision this 24th day of March, 1998, from a field survey performed under my supervision from December 1997 to March 1998, and checking for and on behalf of the Department of Transportation, State of Colorado, and is not a Land Survey Plat or Right-of-Way Survey Plat and to the best of my knowledge and belief this control survey, as shown, meets the minimum horizontal control tolerances of a Type B Survey.

Kevin A. Williams, L.S. 28294

PROJECT COORDINATE SUMMARY TABLE  
 (ADJUSTED FIELD DATA)

| POINT NAME                 | PROJECT COORDINATES |           | ELEV(m)  | DESCRIPTION                       |
|----------------------------|---------------------|-----------|----------|-----------------------------------|
|                            | NORTH (m)           | EAST (m)  |          |                                   |
| BURNETT P&C LS 11944       | 59199.287           | 72247.154 | 3013.637 | 1-1/2" ALUMINUM CAP ON #5 REBAR   |
| DOH ROW STA 364+06.7       | 59213.216           | 72137.503 | 3016.656 | 3-1/4" Brass Cap in Concrete Post |
| DOH ROW STA 497+60         | 69215.839           | 81645.469 | 2947.924 | 3-1/4" Brass Cap in Concrete Post |
| DOH ROW STA 509+60         | 69539.739           | 81819.228 | 2969.085 | 3-1/4" Brass Cap in Concrete Post |
| US 285 CM-MP 192.68        | 69729.543           | 81992.837 | 2972.303 | CDDT Type II Control Monument     |
| US 285 CM-MP 196.8         | 73794.320           | 86699.740 | 2886.228 | CDDT Type II Control Monument     |
| DOH ROW STA 760+06.3       | 74075.816           | 87149.982 | 2889.232 | 3-1/4" Brass Cap in Concrete Post |
| BURNETT P&C LS 11944       | 74478.291           | 87505.940 | 2887.214 | 1-1/2" ALUMINUM CAP ON #5 REBAR   |
| DOH ROW STA 850+82.4       | 76274.046           | 88762.753 | 2896.959 | 3-1/4" Brass Cap in Concrete Post |
| DOH ROW NO STATION         | 76273.527           | 88802.985 | 2896.041 | 3-1/4" Brass Cap in Concrete Post |
| FHWA "T-250"               | 76306.450           | 88827.186 | 2896.701 | 1-1/2" ALUMINUM CAP               |
| ROW "302" PROJ "BRF 285-4" | 76648.016           | 89095.417 | 2899.342 | CDDT Type I R-D-W Monument        |

CONSTRUCTION SURVEYING AND MONUMENTATION REQUIREMENTS:

- This Control Survey Diagram represents the horizontal and vertical control for the project established by the Department. It is possible that some of the survey control monuments listed have been disturbed or obliterated. It is the Contractor's responsibility to verify the existence and stability of the control monuments before submitting a bid price.
- All Type 1 and Type 2 monuments shall be set flush with the ground. Witness posts shall be installed 1 foot from and facing all Type 1 and Type 2 monuments, or as directed by the Project Engineer.
- Installation of Type 3 and Type 3-A monuments shall be completed in the same day that installation is commenced. Under no circumstances shall holes in the roadway be left open overnight.
- When installing Type 3-A monuments, the aluminum access cover shall be positively secured to the PVC pipe with screws or glue. The access cover shall be caulked with asphalt caulking between the cover and the edges of the roadway surface to provide a positive moisture barrier around the access cover.
- Control survey procedures, statistical analysis, and accuracy obtained for horizontal and vertical control shall be documented in the field book.
- Legible copies of the field books shall be submitted to the Project Engineer for review on a monthly basis.
- It is ultimately the prime Contractor's responsibility to insure that these requirements, as well as any contained in the CDDT specifications, project special provisions, and CDDT Survey Manual are fulfilled under this contract.
- The minimum staking intervals for each item are described on the plans or in the CDDT Survey Manual. If the contractor wishes to reduce the minimum intervals, a Contract Modification Order must be negotiated and the cost of the item reduced accordingly.

FILING CERTIFICATION: I, \_\_\_\_\_, AT \_\_\_\_\_, FOR INFORMATION DEPOSITED THIS \_\_\_\_\_ DAY OF \_\_\_\_\_ OF THE COUNTY LAND SURVEYS/RIGHT OF WAY SURVEYS AT PAGE \_\_\_\_\_ RECEPTION NUMBER \_\_\_\_\_ SIGNED \_\_\_\_\_ DEPT. \_\_\_\_\_

| Computer File Information           |                                |
|-------------------------------------|--------------------------------|
| Creation Date: MAR/23/1998          | Initials: KAW                  |
| Last Modification Date: MAR/30/1998 | Initials: KAW                  |
| Full Path: D:\11957\CSD\            |                                |
| Drawing File Name: 11957CSD         |                                |
| Acad Ver. 13_c4                     | Scale: 1cm = 50m Units: METERS |

Colorado Department of Transportation  
 Region I Right of Way  
 18500 E. COLFAX  
 AURORA, CO 80011  
 Phone: 303-757-9744 FAX: 303-757-9746  
 Survey Coordinator Joseph P. Conway

| Revisions |  |
|-----------|--|
|           |  |
|           |  |
|           |  |
|           |  |
|           |  |
|           |  |

| Revisions |  |
|-----------|--|
|           |  |
|           |  |
|           |  |
|           |  |
|           |  |
|           |  |

| CONTROL SURVEY DIAGRAM<br>PLAN SHEET |               |
|--------------------------------------|---------------|
| NH 2854-070                          |               |
| Kenosha Pass - Jct. S.H. 9           |               |
| Project Code: 11957                  | Sheet Number: |

SH 285 MP 182.9 to MP 199.2  
 Jefferson Site - Secs. 5 and 8, T 8 S, R 75 W, 6th P.M.  
 Michigan Hill Road Site - Sec. 18, T 8 S, R 75 W, 6th P.M.  
 Elkhorn Road Site - Secs. 33 and 34, T 8 S, R 76 W, 6th P.M.  
 Fairplay Site - Secs. 33 and 34, T 9 S, R 77 W, 6th P.M.  
 PARK COUNTY, COLORADO

FILING CERTIFICATION: DAY OF 19\_\_ AT \_\_ M., FOR INFORMATION  
 DEPOSITED THIS DAY OF THE COUNTY LAND SURVEYS/RIGHT OF WAY  
 SURVEYS AT PAGE RECEPTION NUMBER  
 SIGNED DEPT.

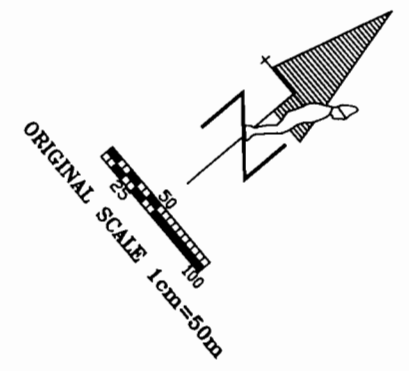
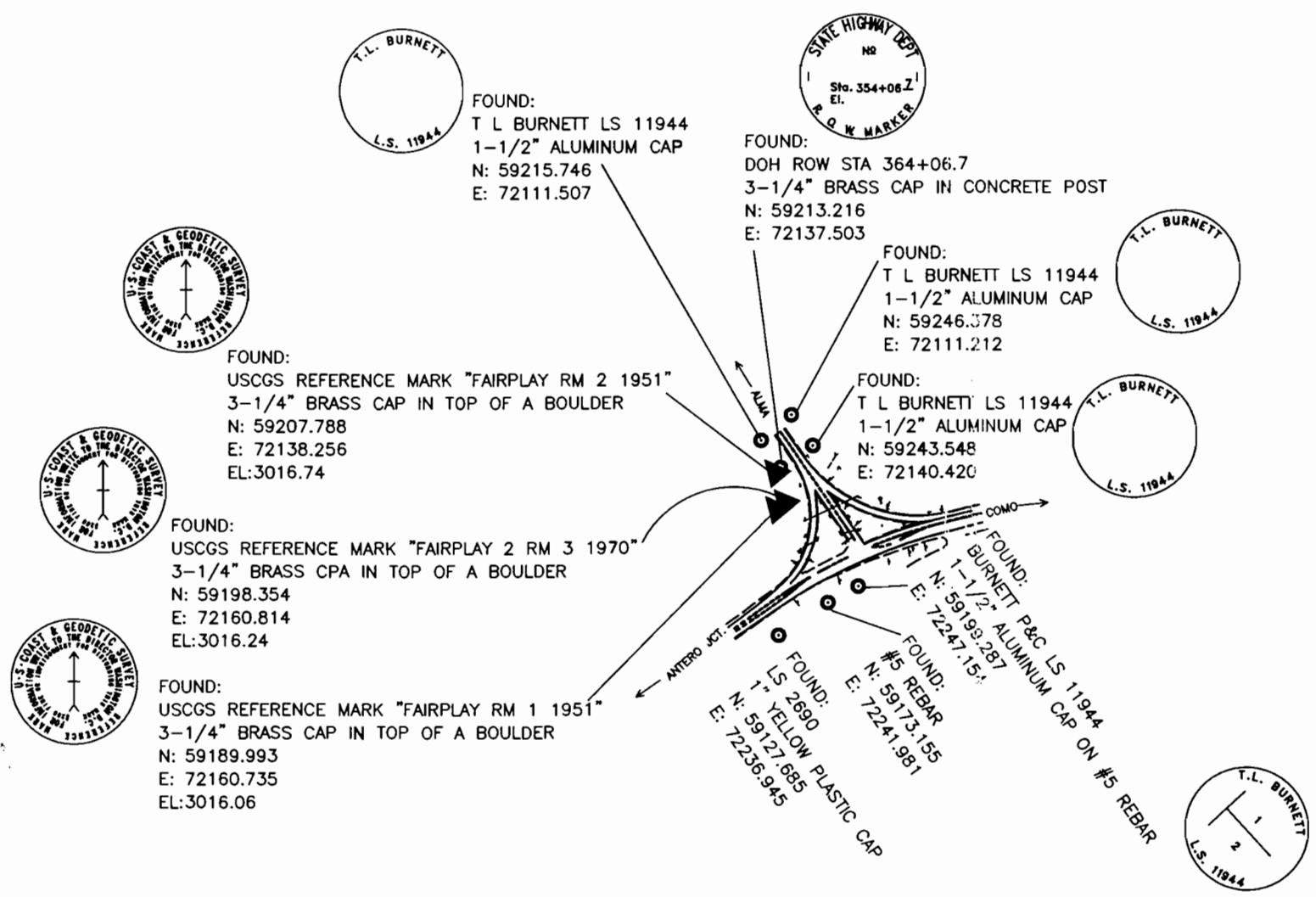

## FAIRPLAY SITE US 285 M.P. 182.9 TO 183.1

| Computer File Information           |                                |
|-------------------------------------|--------------------------------|
| Creation Date: MAR/23/1998          | Initials: KAW                  |
| Last Modification Date: MAR/30/1998 | Initials: KAW                  |
| Full Path: D:\11957\CSD\            |                                |
| Drawing File Name: 11957CSD         |                                |
| Acad Ver. 13_c4                     | Scale: 1cm = 50m Units: METERS |

Colorado Department of Transportation  
 Region I Right of Way  
 18500 E. COLFAX  
 AURORA, CO 80011  
 Phone: 303-757-9744 FAX: 303-757-9746  
 Survey Coordinator Joseph P. Conway

| Revisions |  |
|-----------|--|
|           |  |
|           |  |
|           |  |
|           |  |
|           |  |

| Revisions |  |
|-----------|--|
|           |  |
|           |  |
|           |  |
|           |  |
|           |  |

| CONTROL SURVEY DIAGRAM<br>PLAN SHEET |               |
|--------------------------------------|---------------|
| NH 2854-070                          |               |
| Kenosha Pass - Jct. S.H. 9           |               |
| Project Code: 11957                  | Sheet Number: |

SH 285 MP 182.9 to MP 199.2  
 Jefferson Site - Secs. 5 and 8, T 8 S, R 75 W, 6th P.M.  
 Michigan Hill Road Site - Sec. 18, T 8 S, R 75 W, 6th P.M.  
 Elkhorn Road Site - Secs. 33 and 34, T 8 S, R 76 W, 6th P.M.  
 Fairplay Site - Secs. 33 and 34, T 9 S, R 77 W, 6th P.M.  
 PARK COUNTY, COLORADO

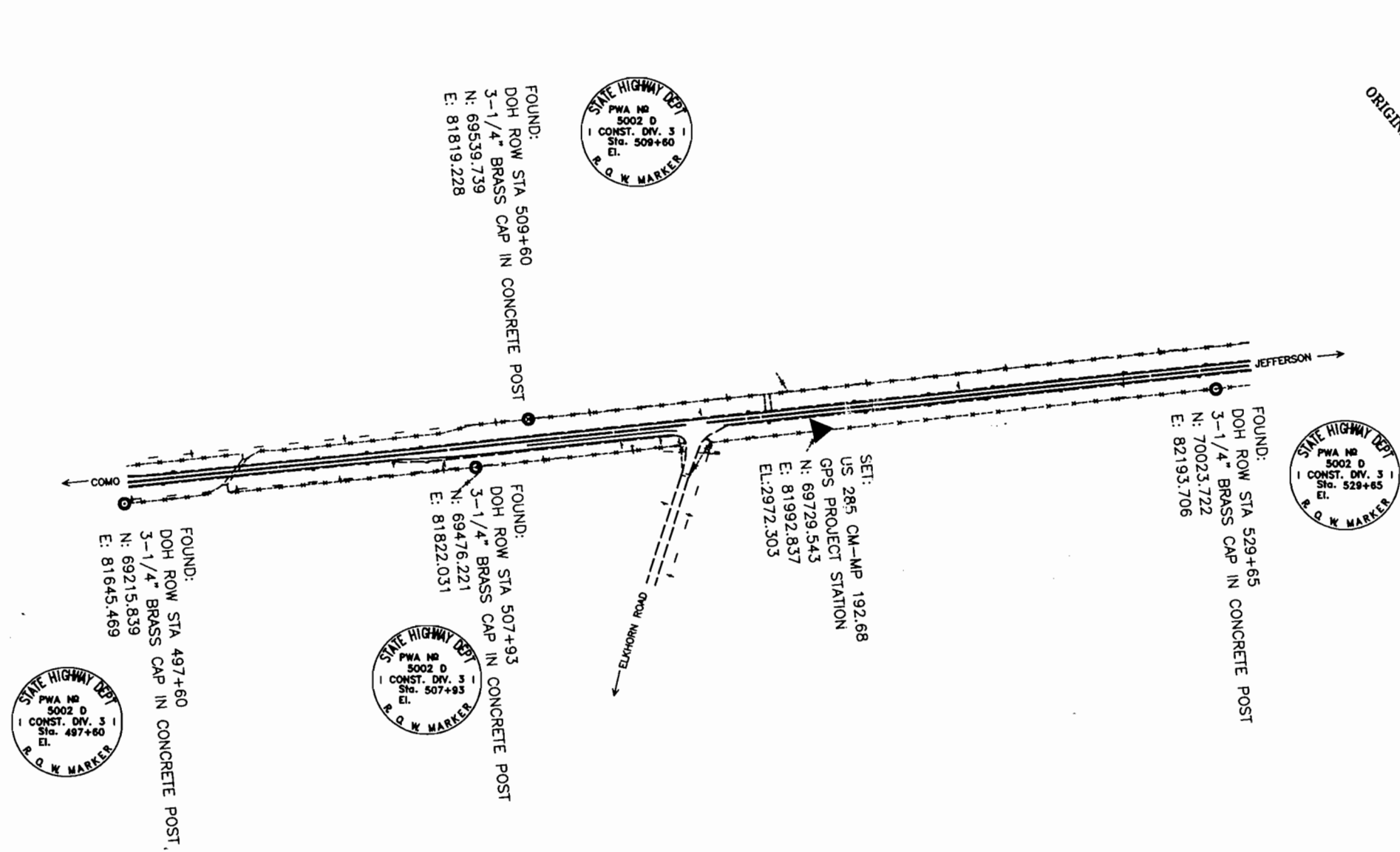

ELKHORN ROAD SITE  
 US 285 M.P. 192.3 TO 193.0

FILING CERTIFICATION: DAY OF 19 AT M., FOR INFORMATION DEPOSITED THIS DAY OF THE COUNTY LAND SURVEYS/RIGHT OF WAY SURVEYS AT PAGE RECEPTION NUMBER  
 SIGNED \_\_\_\_\_ DEPT. \_\_\_\_\_

| Computer File Information           |                                |
|-------------------------------------|--------------------------------|
| Creation Date: MAR/23/1998          | Initials: KAW                  |
| Last Modification Date: MAR/30/1998 | Initials: KAW                  |
| Full Path: D:\11957\CSD\            |                                |
| Drawing File Name: 11957CSD         |                                |
| Acad Ver. 13_c4                     | Scale: 1cm = 50m Units: METERS |

Colorado Department of Transportation  
 Region I Right of Way  
 18500 E. COLFAX  
 AURORA, CO 80011  
 Phone: 303-757-9744 FAX: 303-757-9746  
 Survey Coordinator Joseph P. Conway

| Revisions |  |
|-----------|--|
|           |  |
|           |  |
|           |  |
|           |  |
|           |  |

| Revisions |  |
|-----------|--|
|           |  |
|           |  |
|           |  |
|           |  |
|           |  |

| CONTROL SURVEY DIAGRAM<br>PLAN SHEET |               |
|--------------------------------------|---------------|
| NH 2854-070                          |               |
| Kenosha Pass - Jct. S.H. 9           |               |
| Project Code: 11957                  | Sheet Number: |

SH 285 MP 182.9 to MP 199.2  
 Jefferson Site - Secs. 5 and 8, T 8 S, R 75 W, 6th P.M.  
 Michigan Hill Road Site - Sec. 18, T 8 S, R 75 W, 6th P.M.  
 Elkhorn Road Site - Secs. 33 and 34, T 8 S, R 76 W, 6th P.M.  
 Fairplay Site - Secs. 33 and 34, T 9 S, R 77 W, 6th P.M.  
 PARK COUNTY, COLORADO

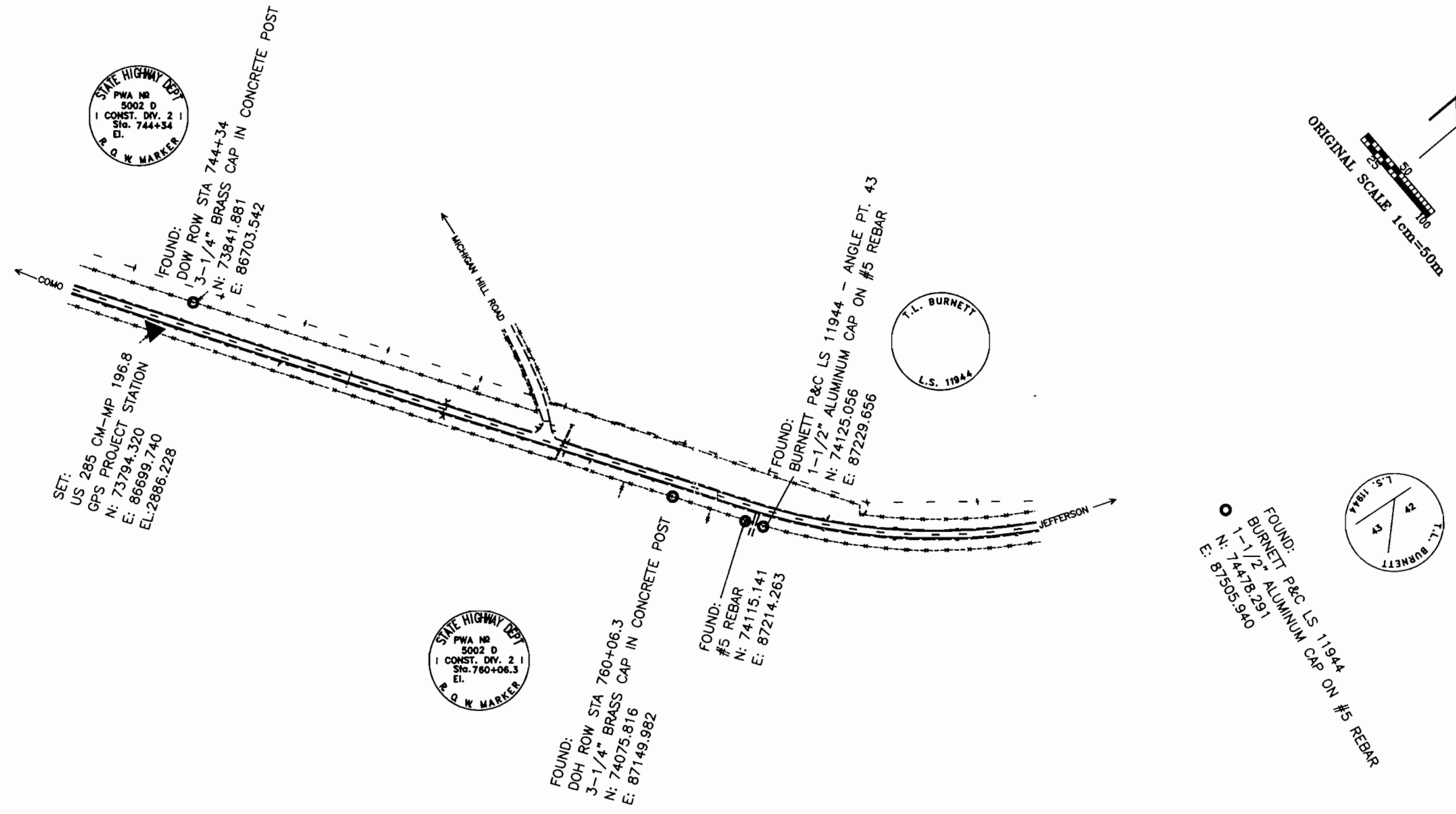

# MICHIGAN HILL ROAD SITE US 285 M.P. 196.8 TO 197.2

FILING CERTIFICATION: DEPOSITED THIS \_\_\_ DAY OF \_\_\_ 19\_\_\_ AT \_\_\_ M., FOR INFORMATION ONLY IN BOOK \_\_\_ OF THE COUNTY LAND SURVEYS/RIGHT OF WAY SURVEYS AT PAGE \_\_\_ RECEPTION NUMBER \_\_\_\_\_  
 SIGNED \_\_\_\_\_ DEPT. \_\_\_\_\_

| Computer File Information           |                                |
|-------------------------------------|--------------------------------|
| Creation Date: MAR/23/1998          | Initials: KAW                  |
| Last Modification Date: MAR/30/1998 | Initials: KAW                  |
| Full Path: D:\11957\CSD\            |                                |
| Drawing File Name: 11957CSD         |                                |
| Acad Ver. 13_c4                     | Scale: 1cm = 50m Units: METERS |

Colorado Department of Transportation  
 Region I Right of Way  
 18500 E. COLFAX  
 AURORA, CO 80011  
 Phone: 303-757-9744 FAX: 303-757-9746  
 Survey Coordinator Joseph P. Conway

| Revisions |  |
|-----------|--|
|           |  |
|           |  |
|           |  |
|           |  |
|           |  |

| Revisions |  |
|-----------|--|
|           |  |
|           |  |
|           |  |
|           |  |
|           |  |

| CONTROL SURVEY DIAGRAM<br>PLAN SHEET |               |
|--------------------------------------|---------------|
| NH 2854-070                          |               |
| Kenosha Pass - Jct. S.H. 9           |               |
| Project Code: 11957                  | Sheet Number: |

SH 285 MP 182.9 to MP 199.2  
 Jefferson Site - Secs. 5 and 8, T 8 S, R 75 W, 6th P.M.  
 Michigan Hill Road Site - Sec. 18, T 8 S, R 75 W, 6th P.M.  
 Elkhorn Road Site - Secs. 33 and 34, T 8 S, R 76 W, 6th P.M.  
 Fairplay Site - Secs. 33 and 34, T 9 S, R 77 W, 6th P.M.  
 PARK COUNTY, COLORADO

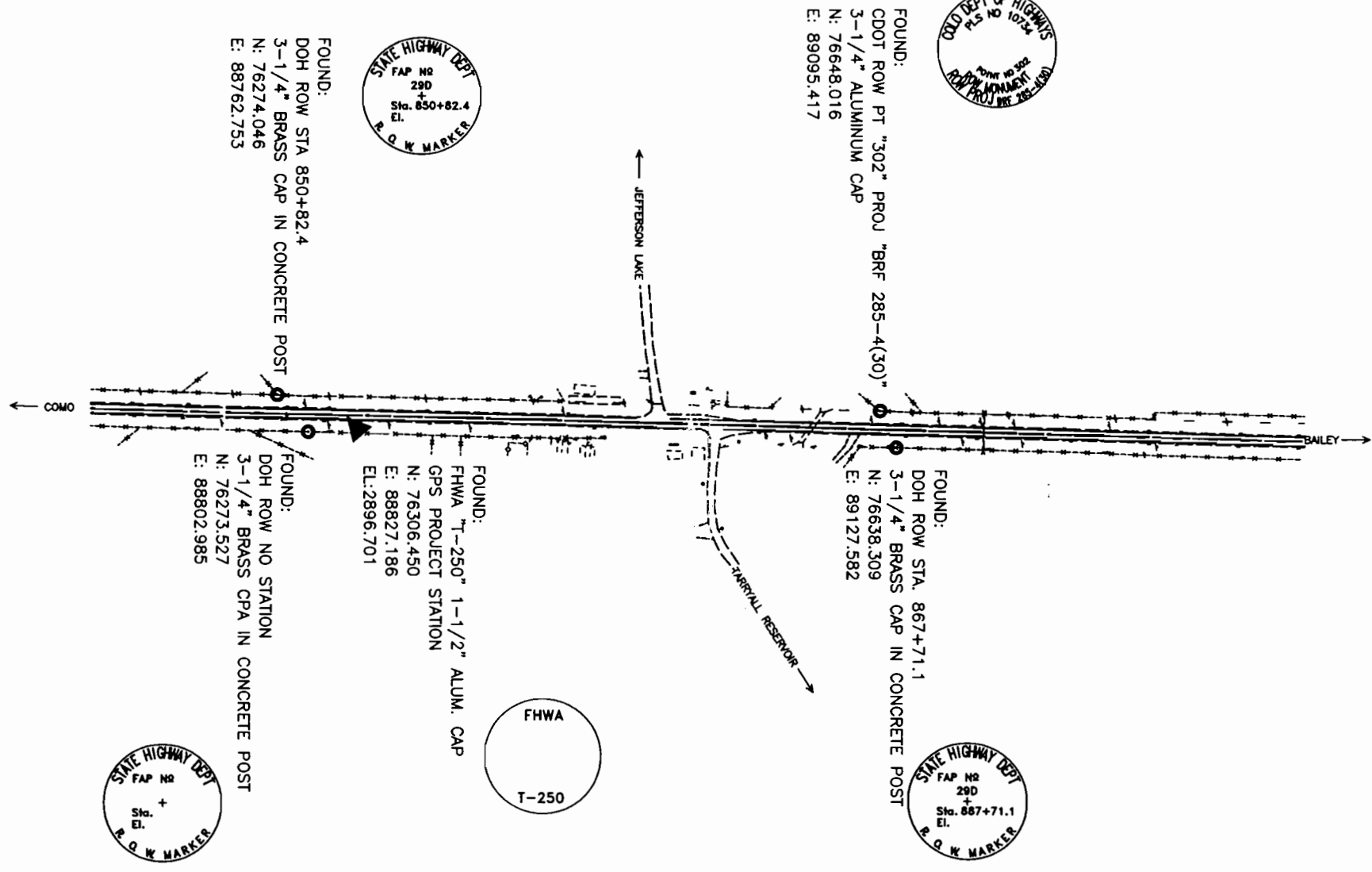
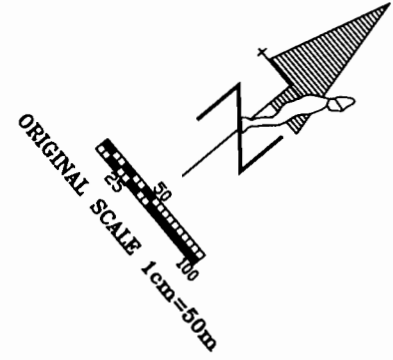

FILING CERTIFICATION: DAY OF \_\_\_\_\_, AT \_\_\_\_\_, FOR INFORMATION  
 DEPOSITED THIS \_\_\_\_\_ OF THE COUNTY LAND SURVEYS/RIGHT OF WAY  
 ONLY IN BOOK \_\_\_\_\_ SURVEYS AT PAGE \_\_\_\_\_ RECEPTION NUMBER \_\_\_\_\_  
 SIGNED \_\_\_\_\_ DEPT. \_\_\_\_\_

JEFFERSON SITE  
 US 285 M.P. 198.6 TO 199.2