

DEPARTMENT OF TRANSPORTATION - STATE OF COLORADO

CONTROL SURVEY DIAGRAM

PROJECT NH 2873-086
SH 287 MP122.8 TO MP 133.2

SECTIONS 8, 9, 15, 16, 21, 22, 27, 28, 33 & 34, T. 15 S, R. 48 W,
SECTIONS 3, 9, 10, 15, 16, 21, 22, 27, 28, 33 & 34, T. 16 S, R. 48 W,
CHEYENNE COUNTY, COLORADO

- EXISTING CDOT TYPE 2 MONUMENT
3 1/4" DIA. ALUM. CONTROL MONUMENT CAP (SEE DETAIL) ON
A 3" x 3/4" DIA. FINNED ALUM. SECURITY ROD ON A 3" x
3/4" DIA. SMOOTH ALUM. ROD.
- RESURVEYED CDOT TYPE 2 MONUMENT
3 1/4" DIA. ALUM. CONTROL MONUMENT CAP (SEE DETAIL) ON
A 3" x 3/4" DIA. FINNED ALUM. SECURITY ROD ON A 3" x
3/4" DIA. SMOOTH ALUM. ROD.
- 3" DIA. US COAST AND GEODETIC SURVEY BRASS DISK IN A
1' x 1' CONCRETE BASE

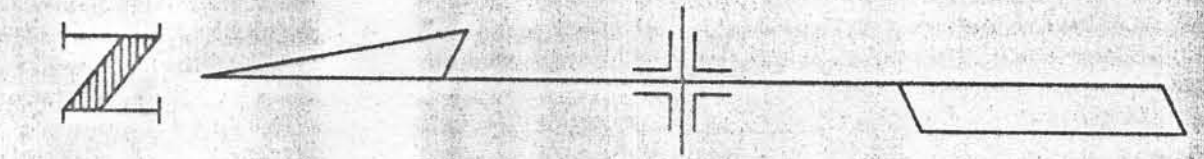

GRID NORTH
AS ESTABLISHED BY A GPS
SURVEY TIED INTO THE
CHARN

Scale 1 : 60000

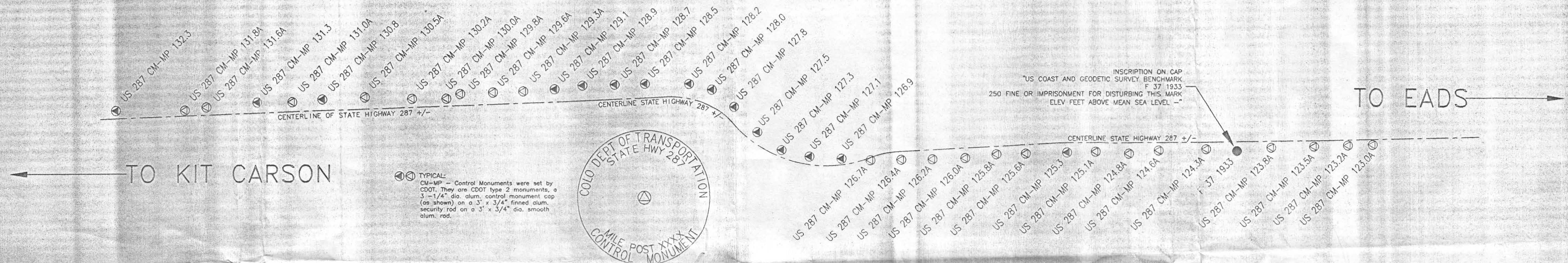

TABULATION OF GPS PROJECT CONTROL POINTS

POINT	NAD 83/92 GEODETIC COORDINATES		COLORADO CENTRAL STATE PLANE		CONVERGENCE	SCALE	ELLIPSOID ELEV. (m)	POINT	PROJECT COORDINATES		MONUMENT DESCRIPTION	
	LATITUDE	LONGITUDE	NORTHING (m)	EASTING (m)					NORTHING (m)	EASTING (m)		ELEV. (m)
123.0A	38° 37' 9.26353" N	102° 47' 8.84615" W	395572.753	1150736.963	1'42"42.56467"	0.999971037	1254.276	123.0A	95668.810	151016.397	1276.752	CDOT TYPE 2 CONTROL MONUMENT

NOTES

- BASIS OF ELEVATIONS:** Project is based on the U.S. Coast and Geodetic Survey (USCGS) benchmark F 37 1933, a 3 inch brass cap set in concrete on a post with an NAVD 88 elevation of 1285.837m, and a project elevation of 1286.396m. F 37 is part of Colorado line 20, a first order second class line leveled in 1933.
- COORDINATE DATUM:** Project coordinates are modified Colorado State Plane Central zone, North American Datum of 1983, 1992 adjustment coordinates. State Plane coordinates were modified to a mean project elevation of 1296.1040m. The combined elevation/scale correction factor used to modify the coordinates was 1.000242304. Project coordinates were truncated by 300,000 in the Northing and 1,000,000 in the Easting. The CHARN is based on the WGS 84 (92) datum.
- BASIS OF BEARINGS:** Bearings used in the calculation of coordinates are based on a grid bearing of N 01°53' 03" W from US 287 CM-MP 123.0 to US 287 CM-MP 123.5 as obtained from a Global Positioning System (GPS) survey based on the Colorado High Accuracy Reference Network (CHARN).
- The stations reported with a mark identifier containing a subscript "A" are points that were resurveyed using fast static GPS observations tying into the following existing stations US 287 CM-MP 132.3, US 287 CM-MP 131.3, US 287 CM-MP 130.8, US 287 CM-MP 129.1, US 287 CM-MP 126.9 and US 287 CM-MP 125.3.
- Scale factors, project datums, existing coordinate information and project coordinate truncation applied were obtained from the Control Survey Diagram listing original control for CDOT project NH 2873-086 as prepared by Joseph P. Conway, US 25618, said Survey Control Diagram is located at sheet 47 in the plans for said CDOT project.
- Project Elevations listed hereon were obtained by differential leveling techniques.
- According to Colorado law you must commence any legal action based upon any defect in this survey within three years after you first discover such defect. In no event may any action based upon any defect in this survey be commenced more than ten years from the date of the statement shown.

SURVEYORS STATEMENT

I, Joe R. Zylstra, a Professional Land Surveyor in the State of Colorado, hereby state that this Control Survey Diagram was prepared under my supervision this 23rd day of October 1998, from a field survey performed under my supervision from 8.13.98 to 8.19.98 and checking for and on the behalf of the Colorado Department of Transportation, State of Colorado, and is not a land survey plat or Right-Of-Way plat and to the best of my knowledge and belief this control survey, as shown, meets the minimum horizontal tolerances of a Type B survey.

 Joe R. Zylstra PLS 11434

Computer File Information		Sheet Revisions		Colorado Department of Transportation		As Constructed		COORDINATE SYSTEM & SURVEY CONTROL		Project No./Code	
Creation Date:	10/20/98 Initials: LD			 18500 East Colfax Avenue Aurora, Colorado 80011 Phone: (303) 757-9744 FAX: (303) 757-9746		No. Revisions:		Designer: LD Structure: ERST. Detailer: LD Numbers: DRAFT		NH 2873 - 086	
Last Modification Date:	10/20/98 Initials: LD					Region 1				Revised:	
Full Path:	\\980204\980204.DWG					Void:		Sheet Subst:		Sheet Number	
Drawing File Name:	980204.DWG							Subset Sheets:			
Acad Ver.:	R14 Scale: 1:6000 Units: METRIC							of 1			



DEPARTMENT OF TRANSPORTATION - STATE OF COLORADO CONTROL SURVEY DIAGRAM

Project 2873 - 086
S.H. 287 MP 122.8 to MP 133.2
Sections 8, 9, 15, 16, 21, 22,
27, 28, 33, & 34, T.15 S., R. 48 W.
Sections 3, 9, 10, 15, 16, 21, 22,
27, 28, 33, & 34, T. 16 S. R. 48 W.
CHEYENNE COUNTY, COLORADO

AS CONSTRUCTED

NO REVISIONS REVISED VOID

FEDERAL ROAD REGION NO.	DIVISION	PROJECT NO.	SHEET NUMBER
XIII	COLORADO	2873 - 086	

KIT CARSON - SOUTH

COORDINATE SUMMARY TABLE
(ADJUSTED FIELD DATA)

POINT NAME	GEODETIC COORDINATES NAD-83(92) (CHARN)		ELEVATION (NAVD '88)m	MAPPING ANGLE	SCALE	NAD 83(92) ZONE CENTRAL		DESCRIPTION
	LATITUDE(N)	LONGITUDE(W)				NORTHING (m)	EASTING (m)	
A 25 1929	38° 47' 12.00490"	102° 41' 29.41866"	1289.099	1° 46' 16.63805"	0.999950878	414398.845	1158369.659	3" Brass USCGS Cap
ROW MARKER 158+75 LT	38° 43' 16.29556"	102° 46' 32.49739"	1292.866	1° 43' 5.48946"	0.999957753	406911.333	1151276.533	1 1/2" Aluminum Cap on #5 Rebar
ROW MARKER 158+75 RT	38° 43' 16.25338"	102° 46' 35.02023"	1293.629	1° 43' 3.89833"	0.999957754	406908.206	1151215.658	1 1/2" Aluminum Cap on #5 Rebar
ROW MARKER 161+50 RT	38° 43' 13.54627"	102° 46' 34.96239"	1292.506	1° 43' 3.93481"	0.999957841	406824.812	1151219.557	1 1/2" Aluminum Cap on #5 Rebar
ROW MARKER 267+25 RT	38° 41' 29.06888"	102° 48' 33.57782"	1302.601	1° 43' 4.80817"	0.999961310	403605.771	1151349.576	1 1/2" Aluminum Cap on #5 Rebar
ROW MARKER 108+77 LT	38° 44' 5.50316"	102° 48' 33.82982"	1301.954	1° 43' 4.77537"	0.999956210	408427.141	1151203.707	1 1/2" Aluminum Cap on #5 Rebar
ROW MARKER 108+62.9 RT	38° 44' 5.37133"	102° 46' 36.66601"	1303.890	1° 43' 2.86036"	0.999956214	408420.880	1151130.528	1 1/2" Aluminum Cap on #5 Rebar
ROW MARKER 55+62.0 LT	38° 44' 58.14394"	102° 46' 35.33458"	1299.106	1° 43' 3.70007"	0.999954623	410048.350	1151113.893	1 1/2" Aluminum Cap on #5 Rebar
ROW MARKER 55+62.0 RT	38° 44' 58.09908"	102° 46' 37.85906"	1298.712	1° 43' 2.10791"	0.999954624	410045.140	1151053.005	1 1/2" Aluminum Cap on #5 Rebar
ROW MARKER 52+98.7 LT	38° 45' 0.72201"	102° 46' 35.36995"	1298.987	1° 43' 3.67776"	0.999954547	410127.783	1151110.657	1 1/2" Aluminum Cap on #5 Rebar
ROW MARKER 52+98.7 RT	38° 45' 1.20704"	102° 46' 37.89661"	1299.114	1° 43' 2.08425"	0.999954532	410140.904	1151049.222	1 1/2" Aluminum Cap on #5 Rebar
ROW MARKER 1370+85.7 RT	38° 45' 33.37679"	102° 46' 37.87006"	1300.857	1° 43' 2.10097"	0.999953596	411132.429	1151020.147	1 1/2" Aluminum Cap on #5 Rebar
ROW MARKER 1367+85.7 RT	38° 45' 36.23446"	102° 46' 37.99317"	1300.537	1° 43' 2.02333"	0.999953514	411220.417	1151014.530	1 1/2" Aluminum Cap on #5 Rebar
ROW MARKER 1349+87.3 RT	38° 45' 47.26895"	102° 46' 51.31908"	1302.133	1° 42' 53.61881"	0.999953199	411550.877	1150682.767	1 1/2" Aluminum Cap on #5 Rebar
ROW MARKER 1347+13.2 RT	38° 45' 47.54566"	102° 46' 54.55490"	1302.826	1° 42' 51.57802"	0.999953191	411557.069	1150604.428	1 1/2" Aluminum Cap on #5 Rebar
ROW MARKER 1346+87.3 RT	38° 45' 48.30478"	102° 46' 56.52204"	1303.738	1° 42' 50.33736"	0.999953170	411579.045	1150556.259	1 1/2" Aluminum Cap on #5 Rebar
F 37 1933	38° 37' 59.90759"	102° 47' 10.15369"	1286.396	1° 42' 41.74003"	0.999969017	397132.708	1150658.705	3" Brass USCGS Cap
CP 71	38° 37' 0.11792"	102° 47' 9.90204"	1278.271	1° 42' 41.89874"	0.999971408	395290.114	1150719.855	CDOT Type 2 Control Monument
CP 70	38° 36' 53.73426"	102° 47' 8.78110"	1274.380	1° 42' 42.60570"	0.999971668	395094.173	1150752.840	CDOT Type 2 Control Monument
C 37 1933	38° 44' 37.44448"	102° 47' 42.19473"	1302.447	1° 42' 21.53208"	0.999955239	409362.140	1149519.183	3" Brass USCGS Cap
US 287 CM-MP 133.1	38° 45' 41.39882"	102° 46' 37.81478"	1303.286	1° 43' 2.13584"	0.999953368	411379.655	1151014.065	CDOT Type 2 Control Monument
US 287 CM-MP 133.0	38° 45' 34.52106"	102° 46' 38.01146"	1300.810	1° 43' 3.27317"	0.999953563	411189.042	1151063.936	CDOT Type 2 Control Monument
US 287 CM-MP 132.8	38° 45' 23.32284"	102° 46' 35.40498"	1300.261	1° 43' 3.65567"	0.999953886	410824.333	1151088.922	CDOT Type 2 Control Monument
US 287 CM-MP 132.5	38° 45' 11.26372"	102° 46' 35.46162"	1299.432	1° 43' 3.61995"	0.999954237	410452.624	1151098.701	CDOT Type 2 Control Monument
US 287 CM-MP 132.3	38° 44' 58.12890"	102° 46' 35.38356"	1298.937	1° 43' 3.66918"	0.999954623	410047.851	1151112.725	CDOT Type 2 Control Monument
US 287 CM-MP 132.0	38° 44' 41.75718"	102° 46' 34.92108"	1298.098	1° 43' 3.98086"	0.999955110	409543.592	1151139.020	CDOT Type 2 Control Monument
US 287 CM-MP 131.8	38° 44' 32.42497"	102° 46' 36.24332"	1298.215	1° 43' 3.12694"	0.999955390	409255.007	1151115.730	CDOT Type 2 Control Monument
US 287 CM-MP 131.6	38° 44' 24.41221"	102° 46' 35.21151"	1299.008	1° 43' 3.77769"	0.999955633	409008.792	1151148.042	CDOT Type 2 Control Monument
US 287 CM-MP 131.3	38° 44' 5.04034"	102° 46' 33.70319"	1302.352	1° 43' 4.72897"	0.999956225	408412.823	1151202.358	CDOT Type 2 Control Monument
US 287 CM-MP 131.0	38° 43' 51.68118"	102° 46' 34.05010"	1302.680	1° 43' 4.51013"	0.999956638	408000.829	1151208.331	CDOT Type 2 Control Monument
US 287 CM-MP 130.8	38° 43' 40.61985"	102° 46' 33.30392"	1298.519	1° 43' 4.98079"	0.999956983	407660.448	1151234.573	CDOT Type 2 Control Monument
US 287 CM-MP 130.5	38° 43' 24.74533"	102° 46' 32.83396"	1295.287	1° 43' 5.27719"	0.999957484	407171.520	1151260.595	CDOT Type 2 Control Monument
US 287 CM-MP 130.2	38° 43' 12.17800"	102° 46' 33.15220"	1293.528	1° 43' 5.07648"	0.999957885	406783.952	1151264.530	CDOT Type 2 Control Monument
US 287 CM-MP 130.0	38° 42' 59.75083"	102° 46' 33.11001"	1292.982	1° 43' 5.10309"	0.999958284	406400.985	1151277.037	CDOT Type 2 Control Monument
US 287 CM-MP 129.8	38° 42' 49.23480"	102° 46' 32.65625"	1290.912	1° 43' 5.38927"	0.999958625	406077.179	1151297.716	CDOT Type 2 Control Monument
US 287 CM-MP 129.6	38° 42' 37.02790"	102° 46' 32.39675"	1291.196	1° 43' 5.55293"	0.999959024	405701.138	1151315.269	CDOT Type 2 Control Monument
US 287 CM-MP 129.3	38° 42' 25.75434"	102° 46' 32.28936"	1293.618	1° 43' 5.82066"	0.999959398	405353.754	1151328.285	CDOT Type 2 Control Monument
US 287 CM-MP 129.1	38° 42' 14.06670"	102° 46' 31.73807"	1295.883	1° 43' 5.98838"	0.999959784	404993.929	1151352.405	CDOT Type 2 Control Monument
US 287 CM-MP 128.9	38° 42' 2.97847"	102° 46' 31.53102"	1300.662	1° 43' 6.09894"	0.999960156	404652.329	1151367.658	CDOT Type 2 Control Monument
US 287 CM-MP 128.7	38° 41' 50.63643"	102° 46' 31.75795"	1300.052	1° 43' 5.95581"	0.999960573	404271.772	1151373.589	CDOT Type 2 Control Monument
US 287 CM-MP 128.5	38° 41' 39.84545"	102° 46' 31.84676"	1301.199	1° 43' 6.02594"	0.999960940	403939.284	1151386.252	CDOT Type 2 Control Monument
US 287 CM-MP 128.2	38° 41' 23.51350"	102° 46' 32.29299"	1303.635	1° 43' 5.81837"	0.999961501	403435.429	1151385.742	CDOT Type 2 Control Monument
US 287 CM-MP 128.0	38° 41' 14.69281"	102° 46' 35.31784"	1304.763	1° 43' 3.71076"	0.999961807	403161.370	1151320.833	CDOT Type 2 Control Monument
US 287 CM-MP 127.8	38° 41' 6.42670"	102° 46' 43.74249"	1300.564	1° 42' 58.39729"	0.999962095	402900.506	1151124.950	CDOT Type 2 Control Monument
US 287 CM-MP 127.5	38° 40' 57.91700"	102° 46' 55.79424"	1299.650	1° 42' 50.79638"	0.999962393	402629.511	1150841.659	CDOT Type 2 Control Monument
US 287 CM-MP 127.3	38° 40' 49.10055"	102° 47' 4.58182"	1299.672	1° 42' 45.25414"	0.999962704	402351.428	1150637.491	CDOT Type 2 Control Monument
US 287 CM-MP 127.1	38° 40' 38.72969"	102° 47' 8.00723"	1299.925	1° 42' 43.09378"	0.999963072	402029.314	1150564.290	CDOT Type 2 Control Monument
US 287 CM-MP 126.9	38° 40' 27.38204"	102° 47' 8.30286"	1299.699	1° 42' 42.90732"	0.999963477	401679.355	1150567.600	CDOT Type 2 Control Monument
US 287 CM-MP 126.7	38° 40' 18.56891"	102° 47' 9.62383"	1299.899	1° 42' 42.07420"	0.999963866	401345.129	1150545.644	CDOT Type 2 Control Monument
US 287 CM-MP 126.4	38° 40' 5.13786"	102° 47' 9.84138"	1297.981	1° 42' 41.93700"	0.999964280	400992.649	1150550.916	CDOT Type 2 Control Monument
US 287 CM-MP 126.2	38° 39' 53.53925"	102° 47' 10.05373"	1297.248	1° 42' 41.80370"	0.999964704	400635.021	1150556.467	CDOT Type 2 Control Monument
US 287 CM-MP 126.0	38° 39' 41.34465"	102° 47' 9.95047"	1297.134	1° 42' 41.86819"	0.999965152	400259.246	1150570.193	CDOT Type 2 Control Monument
US 287 CM-MP 125.8	38° 39' 29.71981"	102° 47' 8.57173"	1299.686	1° 42' 42.73775"	0.999965583	399901.952	1150614.219	CDOT Type 2 Control Monument
US 287 CM-MP 125.6	38° 39' 18.81954"	102° 47' 8.69290"	1298.367	1° 42' 42.66133"	0.999965990	399585.907	1150621.331	CDOT Type 2 Control Monument
US 287 CM-MP 125.3	38° 39' 3.43713"	102° 47' 8.73288"	1296.865	1° 42' 42.63624"	0.999966569	399091.777	1150634.539	CDOT Type 2 Control Monument
US 287 CM-MP 125.1	38° 38' 52.79147"	102° 47' 8.76295"	1295.281	1° 42' 42.61715"	0.999966972	398763.646	1150643.613	CDOT Type 2 Control Monument
US 287 CM-MP 124.8	38° 38' 40.49343"	102° 47' 8.80721"	1293.254	1° 42' 42.58923"	0.999967442	398384.576	1150653.872	CDOT Type 2 Control Monument
US 287 CM-MP 124.6	38° 38' 29.37510"	102° 47' 8.90127"	1292.451	1° 42' 42.52991"	0.999967870	398041.830	1150661.839	CDOT Type 2 Control Monument
US 287 CM-MP 124.3	38° 38' 11.37505"	102° 47' 8.89315"	1285.352	1° 42' 42.53503"	0.999968568	397487.057	1150678.615	CDOT Type 2 Control Monument
US 287 CM-MP 124.0	38° 37' 59.69363"	102° 47' 9.00089"	1285.242	1° 42' 42.46709"	0.999969026	397126.946	1150686.771	CDOT Type 2 Control Monument
US 287 CM-MP 123.8	38° 37' 47.08888"	102° 47' 8.96637"	1283.142	1° 42' 42.48885"	0.999969523	396738.480	1150699.215	CDOT Type 2 Control Monument
US 287 CM-MP 123.5	38° 37' 34.95488"	102° 47' 8.92528"	1284.385	1° 42' 42.51478"	0.999970005	396384.522	1150711.366	CDOT Type 2 Control Monument
US 287 CM-MP 123.2	38° 37' 18.49565"	102° 47' 8.87599"	1278.419	1° 42' 42.54586"	0.999970664	395857.275	1150727.738	CDOT Type 2 Control Monument
US 287 CM-MP 123.0	38° 37' 8.71134"	102° 47' 8.82457"	1276.695	1° 42' 42.57829"	0.999971059	395555.750	1150737.994	CDOT Type 2 Control Monument

PROJECT COORDINATE SUMMARY TABLE
(ADJUSTED FIELD DATA)

POINT NAME	PROJECT COORDINATES		ELEV(m)	DESCRIPTION
	NORTH (m)	EAST (m)		
F 37 1933	97229.144	150938.120	1286.396	3" Brass USCGS Cap
CP 71	95386.102	150999.285	1278.271	CDOT Type 2 Control Monument
CP 70	95190.114	151032.279	1274.380	CDOT Type 2 Control Monument
US 287 CM-MP 133.1	111479.551	151293.566	1303.286	CDOT Type 2 Control Monument
US 287 CM-MP 133.0	111268.886	151343.450	1300.810	CDOT Type 2 Control Monument
US 287 CM-MP 132.8	1109			



AS CONSTRUCTED		
NO REVISIONS	REVISED	VOID

FEDERAL ROAD REGION NO.	DIVISION	PROJECT NO.	SHEET NUMBER
XXXI	COLORADO	2873 - 086	

KIT CARSON - SOUTH

DEPARTMENT OF TRANSPORTATION - STATE OF COLORADO CONTROL SURVEY DIAGRAM

Project 2873 - 086
 S.H. 287 MP 122.8 to MP 133.2
 Sections 8, 9, 15, 16, 21, 22,
 27, 28, 33, & 34, T.15 S., R. 48 W.
 Sections 3, 9, 10, 15, 16, 21, 22,
 27, 28, 33, & 34, T. 16 S. R. 48 W.
 CHEYENNE COUNTY, COLORADO

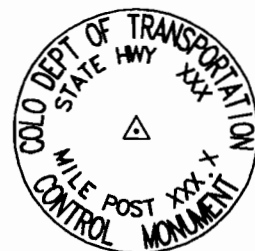
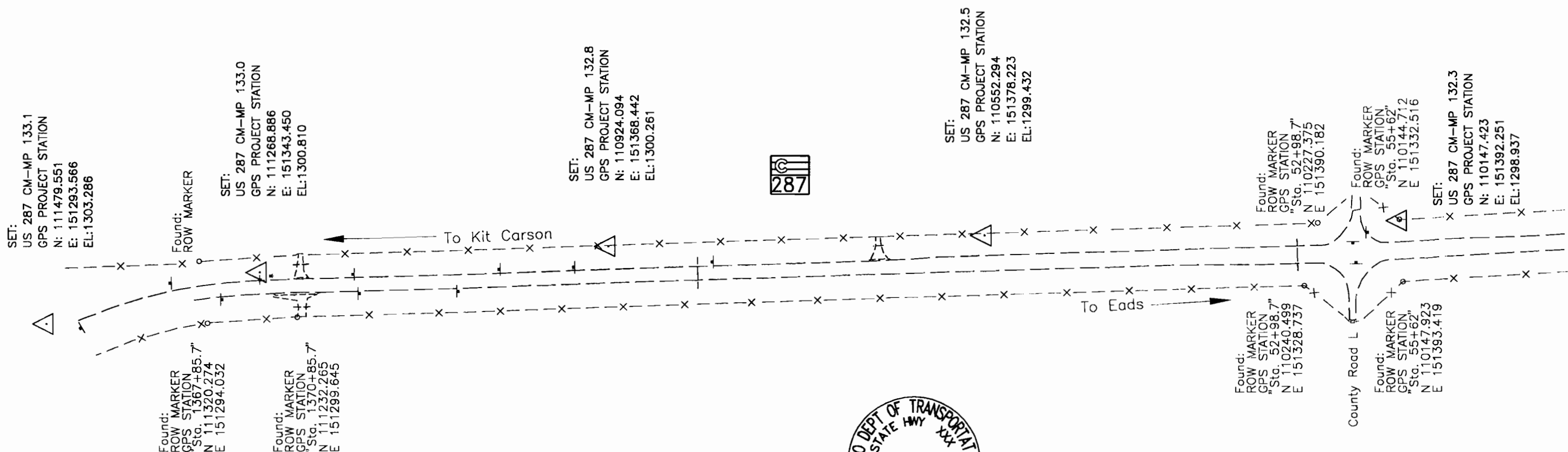
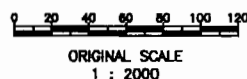

TYPICAL:
 Colorado Division of Highways 1 1/2" Aluminum Cap (as shown) on a No. 5 rebar. All caps have a Station stamped into the washer.

TYPICAL:
 CM-MP - Control Monuments were set CDOT. They were CDOT type 2 monuments, a 3-1/4" dia. aluminum control monument cap (as shown) on a 3" X 3/4" dia. finned aluminum security rod on a 3" X 3/4" dia. smooth aluminum rod.



AS CONSTRUCTED		
NO REVISIONS	REVISED	VOID

FEDERAL ROAD REGION NO.	DIVISION	PROJECT NO.	SHEET NUMBER
XIII	COLORADO	2873 - 086	

KIT CARSON - SOUTH

DEPARTMENT OF TRANSPORTATION - STATE OF COLORADO CONTROL SURVEY DIAGRAM

Project 2873 - 086
 S.H. 287 MP 122.8 to MP 133.2
 Sections 8, 9, 15, 16, 21, 22,
 27, 28, 33, & 34, T.15 S., R. 48 W.
 Sections 3, 9, 10, 15, 16, 21, 22,
 27, 28, 33, & 34, T. 16 S. R. 48 W.
 CHEYENNE COUNTY, COLORADO

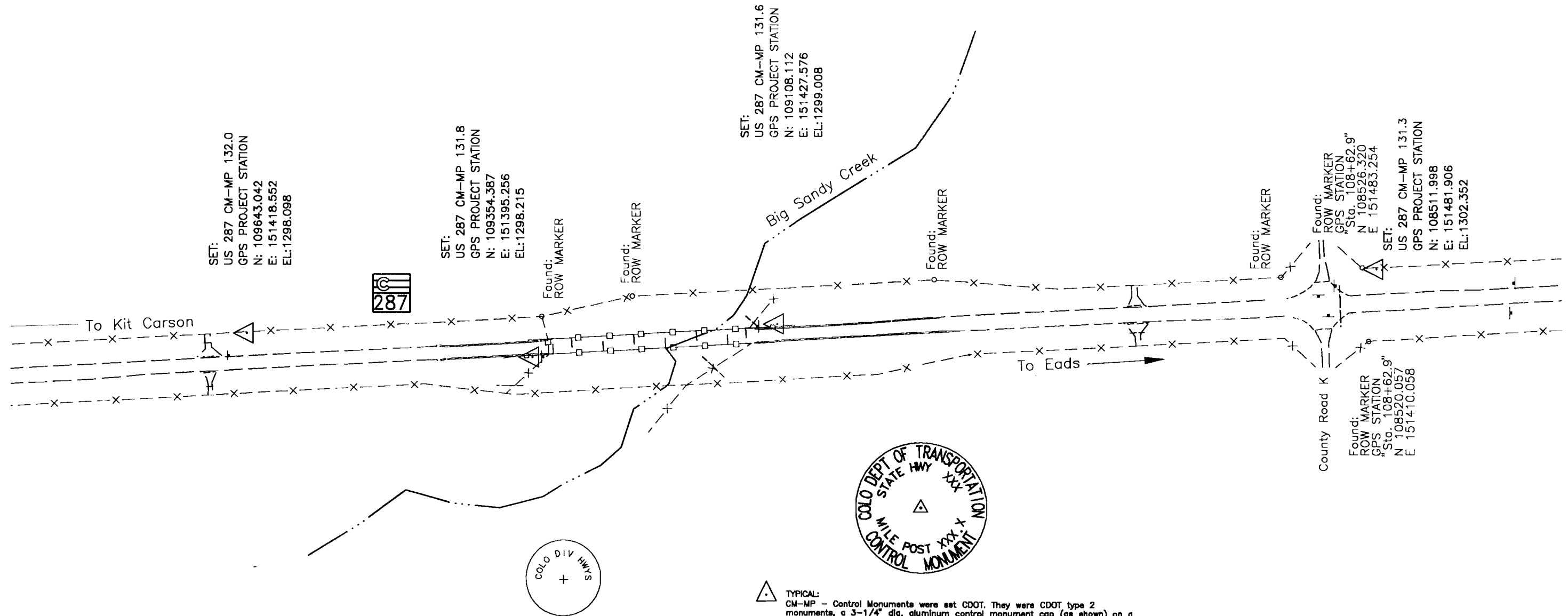
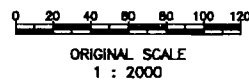

TYPICAL:
 CM-MP - Control Monuments were set CDOT. They were CDOT type 2 monuments, a 3-1/4" dia. aluminum control monument cap (as shown) on a 3' X 3/4" dia. finned aluminum security rod on a 3' X 3/4" dia. smooth aluminum rod.

TYPICAL:
 Colorado Division of Highways 1 1/2" Aluminum Cap (as shown) on a No. 5 rebar. All caps have a Station stamped into the washer.



AS CONSTRUCTED		
NO REVISIONS	REVISED	VOID

FEDERAL ROAD REGION NO.	DIVISION	PROJECT NO.	SHEET NUMBER
XIII	COLORADO	2873 - 086	

KIT CARSON - SOUTH

DEPARTMENT OF TRANSPORTATION - STATE OF COLORADO CONTROL SURVEY DIAGRAM

Project 2873 - 086
 S.H. 287 MP 122.8 to MP 133.2
 Sections 8, 9, 15, 16, 21, 22,
 27, 28, 33, & 34, T.15 S., R. 48 W.
 Sections 3, 9, 10, 15, 16, 21, 22,
 27, 28, 33, & 34, T. 16 S. R. 48 W.
 CHEYENNE COUNTY, COLORADO

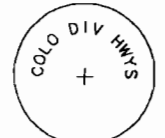
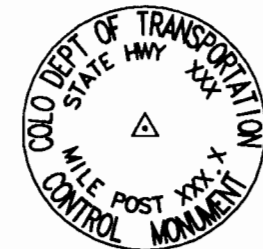
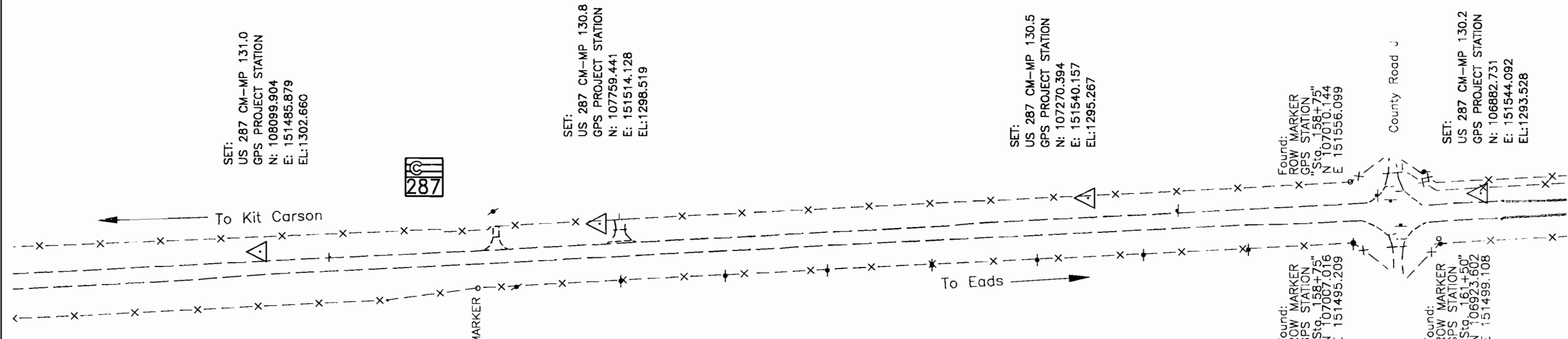
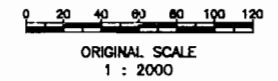

TYPICAL:
 CM-MP - Control Monuments were set CDOT. They were CDOT type 2 monuments, a 3-1/4" dia. aluminum control monument cap (as shown) on a 3" X 3/4" dia. finned aluminum security rod on a 3" X 3/4" dia. smooth aluminum rod.

TYPICAL:
 Colorado Division of Highways 1 1/2" Aluminum Cap (as shown) on a No. 5 rebar. All caps have a Station stamped into the washer.



AS CONSTRUCTED		
NO REVISIONS	REVISED	VOID

FEDERAL ROAD REGION NO.	DIVISION	PROJECT NO.	SHEET NUMBER
811C	COLORADO	2873 - 086	

KIT CARSON - SOUTH

DEPARTMENT OF TRANSPORTATION - STATE OF COLORADO CONTROL SURVEY DIAGRAM

Project 2873 - 086
 S.H. 287 MP 122.8 to MP 133.2
 Sections 8, 9, 15, 16, 21, 22,
 27, 28, 33, & 34, T.15 S., R. 48 W.
 Sections 3, 9, 10, 15, 16, 21, 22,
 27, 28, 33, & 34, T. 16 S. R. 48 W.
 CHEYENNE COUNTY, COLORADO

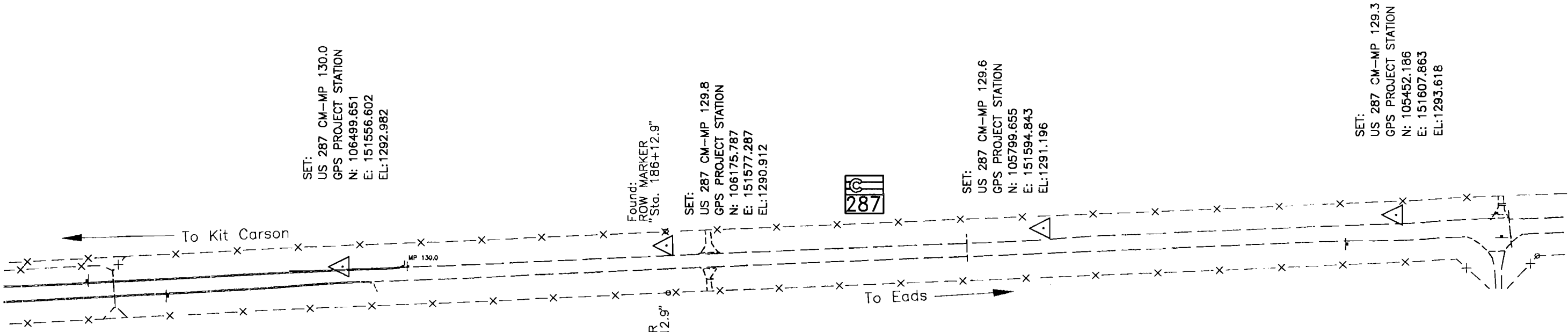
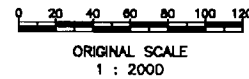

SET:
 US 287 CM-MP 130.0
 GPS PROJECT STATION
 N: 106499.651
 E: 151556.602
 EL: 1292.982

Found:
 ROW MARKER
 Sta. 186+12.9'

SET:
 US 287 CM-MP 129.8
 GPS PROJECT STATION
 N: 106175.787
 E: 151577.287
 EL: 1290.912

SET:
 US 287 CM-MP 129.6
 GPS PROJECT STATION
 N: 105799.655
 E: 151594.843
 EL: 1291.196

SET:
 US 287 CM-MP 129.3
 GPS PROJECT STATION
 N: 105452.186
 E: 151607.863
 EL: 1293.618

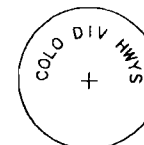
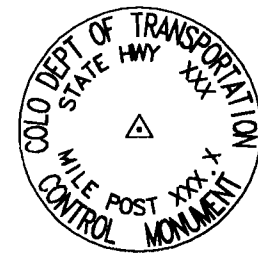

TYPICAL:
 CM-MP - Control Monuments were set CDOT. They were CDOT type 2 monuments, a 3-1/4" dia. aluminum control monument cap (as shown) on a 3" X 3/4" dia. finned aluminum security rod on a 3" X 3/4" dia. smooth aluminum rod.

TYPICAL:
 Colorado Division of Highways 1 1/2" Aluminum Cap (as shown) on a No. 5 rebar. All caps have a Station stamped into the washer.



AS CONSTRUCTED		
NO REVISIONS	REVISED	VOID

FEDERAL ROAD REGION NO.	DIVISION	PROJECT NO.	SHEET NUMBER
3811	COLORADO	2873 -- 086	

KIT CARSON - SOUTH

DEPARTMENT OF TRANSPORTATION - STATE OF COLORADO CONTROL SURVEY DIAGRAM

Project 2873 - 086
 S.H. 287 MP 122.8 to MP 133.2
 Sections 8, 9, 15, 16, 21, 22,
 27, 28, 33, & 34, T.15 S., R. 48 W.
 Sections 3, 9, 10, 15, 16, 21, 22,
 27, 28, 33, & 34, T. 16 S. R. 48 W.
 CHEYENNE COUNTY, COLORADO

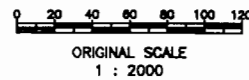

SET:
 US 287 CM-MP 129.1
 GPS PROJECT STATION
 N: 105092.274
 E: 151631.989
 EL: 1295.863



SET:
 US 287 CM-MP 128.9
 GPS PROJECT STATION
 N: 104750.591
 E: 151647.245
 EL: 1300.662

SET:
 US 287 CM-MP 128.7
 GPS PROJECT STATION
 N: 104369.941
 E: 151653.178
 EL: 1300.052

SET:
 US 287 CM-MP 128.5
 GPS PROJECT STATION
 N: 104037.353
 E: 151665.844
 EL: 1301.199

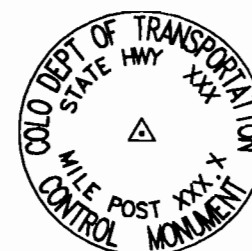
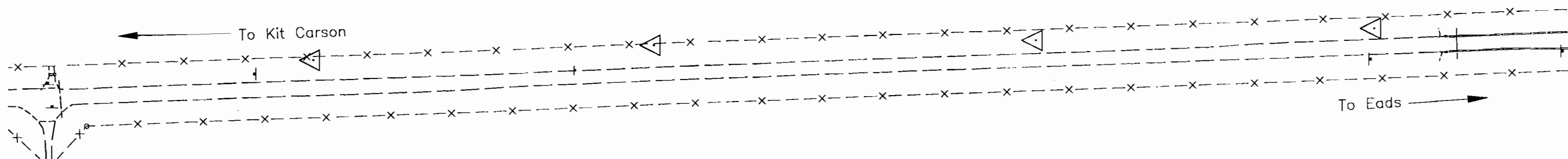

TYPICAL:
 CM-MP - Control Monuments were set CDOT. They were CDOT type 2 monuments, a 3-1/4" dia. aluminum control monument cap (as shown) on a 3' X 3/4" dia. flined aluminum security rod on a 3' X 3/4" dia. smooth aluminum rod.



AS CONSTRUCTED		
NO REVISIONS	REVISED	VOID

FEDERAL ROAD REGION NO.	DIVISION	PROJECT NO.	SHEET NUMBER
XIII	COLORADO	2873 - 086	

KIT CARSON - SOUTH

DEPARTMENT OF TRANSPORTATION - STATE OF COLORADO CONTROL SURVEY DIAGRAM

Project 2873 - 086
 S.H. 287 MP 122.8 to MP 133.2
 Sections 8, 9, 15, 16, 21, 22,
 27, 28, 33, & 34, T.15 S., R. 48 W.
 Sections 3, 9, 10, 15, 16, 21, 22,
 27, 28, 33, & 34, T. 16 S. R. 48 W.
 CHEYENNE COUNTY, COLORADO

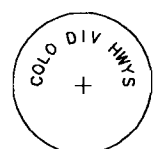
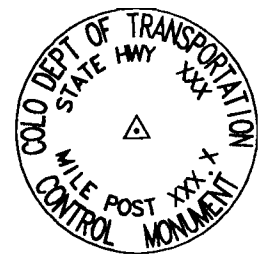
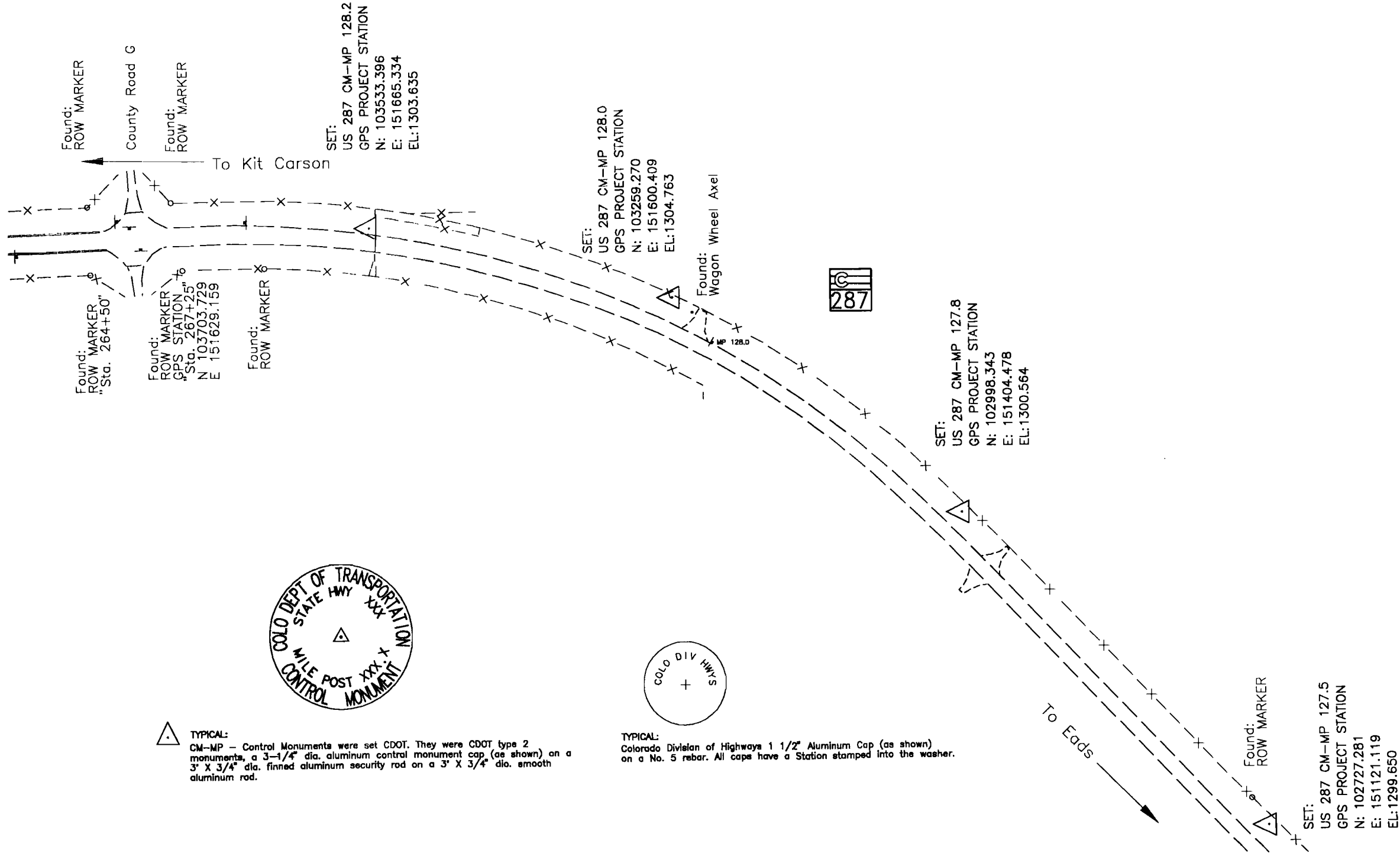
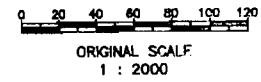

TYPICAL:
 CM-MP - Control Monuments were set CDOT. They were CDOT type 2 monuments, a 3-1/4" dia. aluminum control monument cap (as shown) on a 3" X 3/4" dia. finned aluminum security rod on a 3" X 3/4" dia. smooth aluminum rod.

TYPICAL:
 Colorado Division of Highways 1 1/2" Aluminum Cap (as shown) on a No. 5 rebar. All caps have a Station stamped into the washer.

SET:
 US 287 CM-MP 127.5
 GPS PROJECT STATION
 N: 102727.281
 E: 151121.119
 EL: 1299.650



AS CONSTRUCTED		
NO REVISIONS	REVISED	VOID

FEDERAL ROAD REGION NO.	DIVISION	PROJECT NO.	SHEET NUMBER
VIII	COLORADO	2873 - 086	

KIT CARSON - SOUTH

DEPARTMENT OF TRANSPORTATION - STATE OF COLORADO CONTROL SURVEY DIAGRAM

Project 2873 - 086
 S.H. 287 MP 122.8 to MP 133.2
 Sections 8, 9, 15, 16, 21, 22,
 27, 28, 33, & 34, T.15 S., R. 48 W.
 Sections 3, 9, 10, 15, 16, 21, 22,
 27, 28, 33, & 34, T. 16 S. R. 48 W.
 CHEYENNE COUNTY, COLORADO

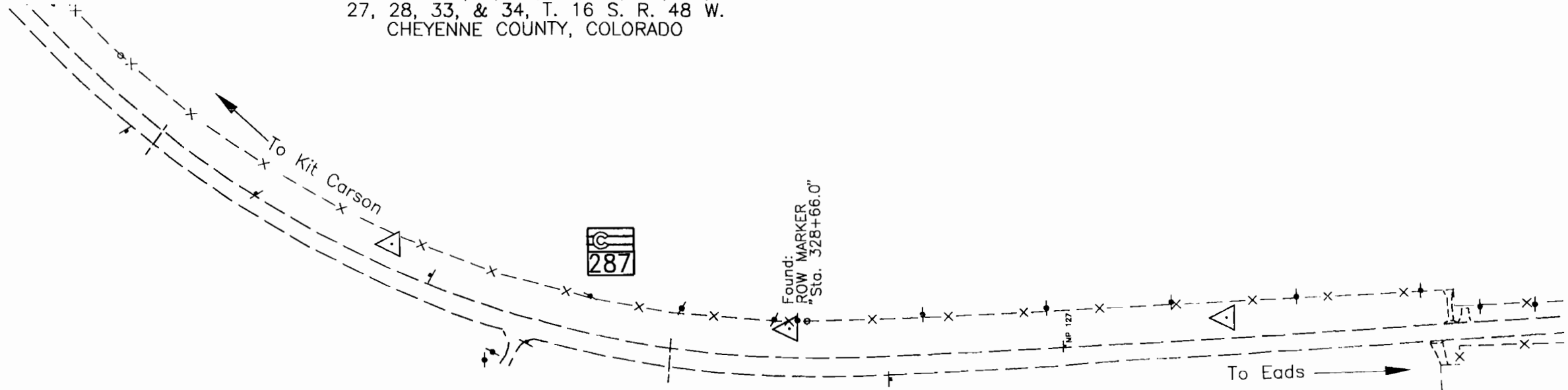
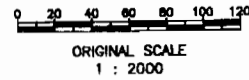

SET:
 US 287 CM-MP 127.3
 GPS PROJECT STATION
 N: 102449.132
 E: 150916.901
 EL:1299.672

SET:
 US 287 CM-MP 127.1
 GPS PROJECT STATION
 N: 102126.939
 E: 150843.682
 EL:1299.925

SET:
 US 287 CM-MP 126.9
 GPS PROJECT STATION
 N: 101776.895
 E: 150846.994
 EL:1299.699

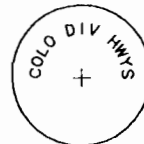

TYPICAL:
 CM-MP - Control Monuments were set CDOT. They were CDOT type 2 monuments, a 3-1/4" dia. aluminum control monument cap (as shown) on a 3" X 3/4" dia. finned aluminum security rod on a 3" X 3/4" dia. smooth aluminum rod.

TYPICAL:
 Colorado Division of Highways 1 1/2" Aluminum Cap (as shown) on a No. 5 rebar. All caps have a Station stamped into the washer.



AS CONSTRUCTED		
NO REVISIONS	REVISED	VOID

FEDERAL ROAD REGION NO.	DIVISION	PROJECT NO.	SHEET NUMBER
511	COLORADO	2873 - 086	

KIT CARSON - SOUTH

DEPARTMENT OF TRANSPORTATION - STATE OF COLORADO CONTROL SURVEY DIAGRAM

Project 2873 - 086
 S.H. 287 MP 122.8 to MP 133.2
 Sections 8, 9, 15, 16, 21, 22,
 27, 28, 33, & 34, T.15 S., R. 48 W.
 Sections 3, 9, 10, 15, 16, 21, 22,
 27, 28, 33, & 34, T. 16 S. R. 48 W.
 CHEYENNE COUNTY, COLORADO

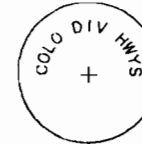
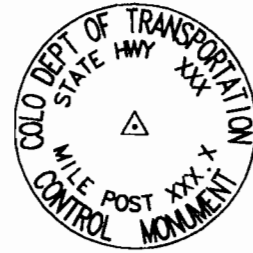
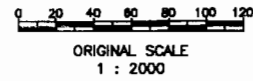

TYPICAL:
 CM-MP - Control Monuments were set CDOT. They were CDOT type 2 monuments, a 3-1/4" dia. aluminum control monument cap (as shown) on a 3' X 3/4" dia. finned aluminum security rod on a 3' X 3/4" dia. smooth aluminum rod.

TYPICAL:
 Colorado Division of Highways 1 1/2" Aluminum Cap (as shown) on a No. 5 rebar. All caps have a Station stamped into the washer.

SET:
 US 287 CM-MP 126.7
 GPS PROJECT STATION
 N: 101442.588
 E: 150825.032
 EL: 1299.699

SET:
 US 287 CM-MP 126.4
 GPS PROJECT STATION
 N: 101090.022
 E: 150830.305
 EL: 1297.981



SET:
 US 287 CM-MP 126.2
 GPS PROJECT STATION
 N: 100732.307
 E: 150835.857
 EL: 1297.248

SET:
 US 287 CM-MP 126.0
 GPS PROJECT STATION
 N: 100356.441
 E: 150849.587
 EL: 1297.134

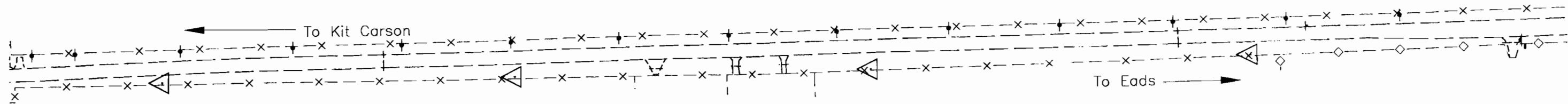



AS CONSTRUCTED		
NO REVISIONS <input type="checkbox"/>	REVISED <input type="checkbox"/>	VOID <input type="checkbox"/>

FEDERAL ROAD REGION NO.	DIVISION	PROJECT NO.	SHEET NUMBER
XIII	COLORADO	2873 - 086	

KIT CARSON - SOUTH

DEPARTMENT OF TRANSPORTATION - STATE OF COLORADO CONTROL SURVEY DIAGRAM

Project 2873 - 086
 S.H. 287 MP 122.8 to MP 133.2
 Sections 8, 9, 15, 16, 21, 22,
 27, 28, 33, & 34, T.15 S., R. 48 W.
 Sections 3, 9, 10, 15, 16, 21, 22,
 27, 28, 33, & 34, T. 16 S. R. 48 W.
 CHEYENNE COUNTY, COLORADO

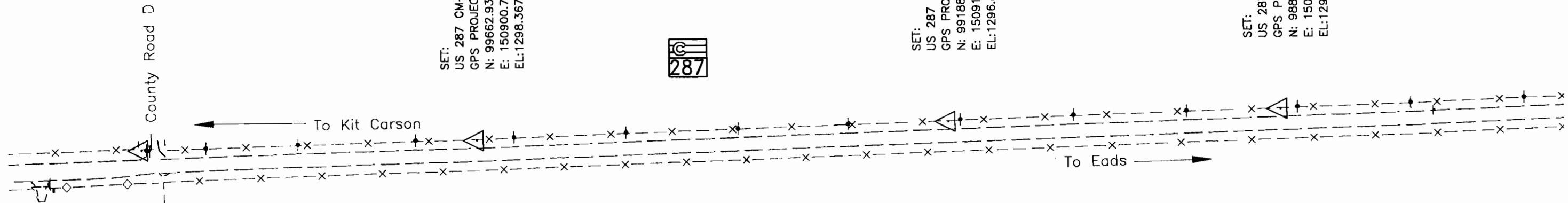
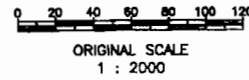

SET:
 US 287 CM-MP 125.8
 GPS PROJECT STATION
 N: 99999.061
 E: 150893.624
 EL: 1299.686

SET:
 US 287 CM-MP 125.6
 GPS PROJECT STATION
 N: 99662.934
 E: 150900.738
 EL: 1298.367

SET:
 US 287 CM-MP 125.3
 GPS PROJECT STATION
 N: 99188.689
 E: 150913.949
 EL: 1296.865

SET:
 US 287 CM-MP 125.1
 GPS PROJECT STATION
 N: 98860.478
 E: 150923.025
 EL: 1295.281

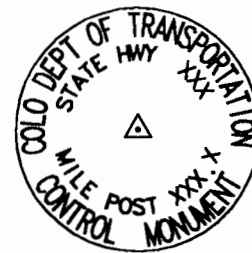

TYPICAL:
 CM-MP - Control Monuments were set CDOT. They were CDOT type 2 monuments, a 3-1/4" dia. aluminum control monument cap (as shown) on a 3' X 3/4" dia. finned aluminum security rod on a 3' X 3/4" dia. smooth aluminum rod.



AS CONSTRUCTED		
NO REVISIONS	REVISED	VOID

FEDERAL ROAD REGION NO.	DIVISION	PROJECT NO.	SHEET NUMBER
8	COLORADO	2873 - 086	

KIT CARSON - SOUTH

DEPARTMENT OF TRANSPORTATION - STATE OF COLORADO CONTROL SURVEY DIAGRAM

Project 2873 - 086
 S.H. 287 MP 122.8 to MP 133.2
 Sections 8, 9, 15, 16, 21, 22,
 27, 28, 33, & 34, T.15 S., R. 48 W.
 Sections 3, 9, 10, 15, 16, 21, 22,
 27, 28, 33, & 34, T. 16 S. R. 48 W.
 CHEYENNE COUNTY, COLORADO

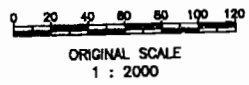

SET:
 US 287 CM-MP 124.8
 GPS PROJECT STATION
 N: 98481.316
 E: 150933.286
 EL: 1293.254

County Road C

SET:
 US 287 CM-MP 124.6
 GPS PROJECT STATION
 N: 98138.487
 E: 150941.255
 EL: 1292.451



SET:
 US 287 CM-MP 124.3
 GPS PROJECT STATION
 N: 97583.579
 E: 150958.036
 EL: 1285.352

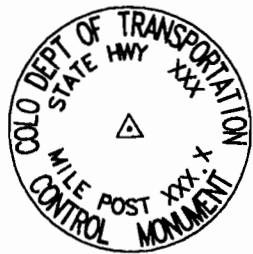
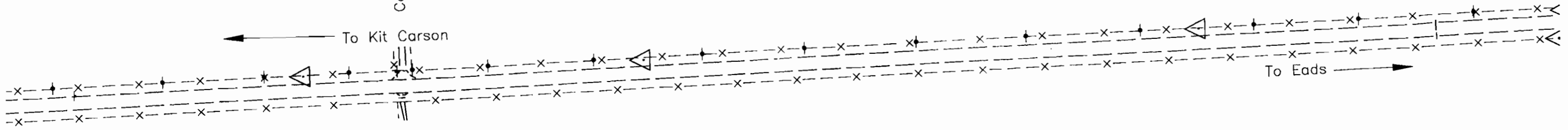

TYPICAL:
 CM-MP - Control Monuments were set CDOT. They were CDOT type 2 monuments, a 3-1/4" dia. aluminum control monument cap (as shown) on a 3" X 3/4" dia. finned aluminum security rod on a 3" X 3/4" dia. smooth aluminum rod.



AS CONSTRUCTED		
NO REVISIONS	REVISED	VOID

FEDERAL ROAD REGION NO.	DIVISION	PROJECT NO.	SHEET NUMBER
38	COLORADO	2873 - 086	

KIT CARSON - SOUTH

DEPARTMENT OF TRANSPORTATION - STATE OF COLORADO CONTROL SURVEY DIAGRAM

Project 2873 - 086
 S.H. 287 MP 122.8 to MP 133.2
 Sections 8, 9, 15, 16, 21, 22,
 27, 28, 33, & 34, T.15 S., R. 48 W.
 Sections 3, 9, 10, 15, 16, 21, 22,
 27, 28, 33, & 34, T. 16 S. R. 48 W.
 CHEYENNE COUNTY, COLORADO

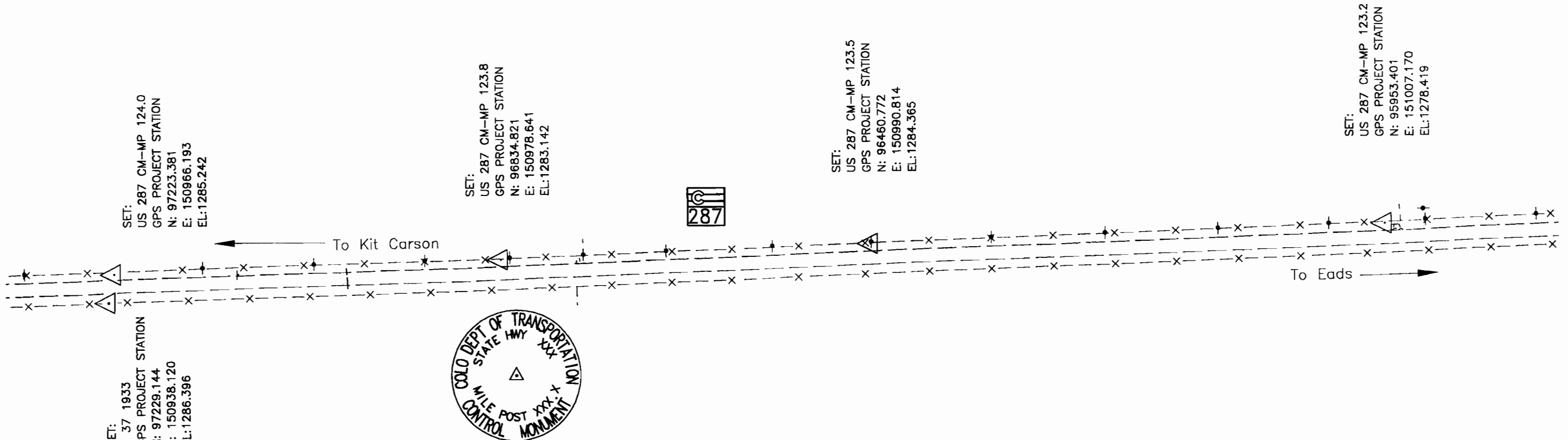
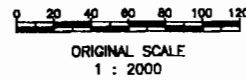

SET:
 US 287 CM-MP 124.0
 GPS PROJECT STATION
 N: 97223.381
 E: 150966.193
 EL: 1285.242

SET:
 US 287 CM-MP 123.8
 GPS PROJECT STATION
 N: 96834.821
 E: 150978.641
 EL: 1283.142

SET:
 US 287 CM-MP 123.5
 GPS PROJECT STATION
 N: 96460.772
 E: 150990.814
 EL: 1284.365

SET:
 US 287 CM-MP 123.2
 GPS PROJECT STATION
 N: 95953.401
 E: 151007.170
 EL: 1278.419

SET:
 F 37 1933
 GPS PROJECT STATION
 N: 97229.144
 E: 150938.120
 EL: 1286.396

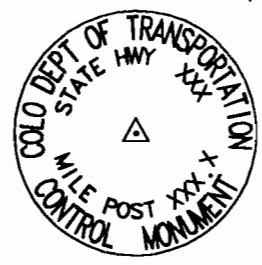

TYPICAL:
 CM-MP - Control Monuments were set CDOT. They were CDOT type 2 monuments, a 3-1/4" dia. aluminum control monument cap (as shown) on a 3' X 3/4" dia. flined aluminum security rod on a 3' X 3/4" dia. smooth aluminum rod.



AS CONSTRUCTED		
NO REVISIONS	REVISED	VOID

FEDERAL ROAD REGION NO.	DIVISION	PROJECT NO.	SHEET NUMBER
XIII	COLORADO	2873 - 086	

KIT CARSON - SOUTH

DEPARTMENT OF TRANSPORTATION - STATE OF COLORADO CONTROL SURVEY DIAGRAM

Project 2873 - 086
 S.H. 287 MP 122.8 to MP 133.2
 Sections 8, 9, 15, 16, 21, 22,
 27, 28, 33, & 34, T.15 S., R. 48 W.
 Sections 3, 9, 10, 15, 16, 21, 22,
 27, 28, 33, & 34, T. 16 S. R. 48 W.
 CHEYENNE COUNTY, COLORADO

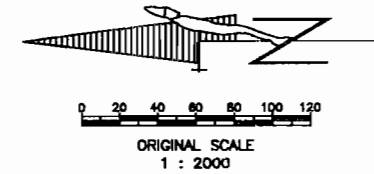
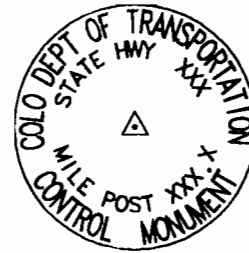

TYPICAL:
 CM-MP - Control Monuments were set CDOT. They were CDOT type 2 monuments, a 3-1/4" dia. aluminum control monument cap (as shown) on a 3" X 3/4" dia. finned aluminum security rod on a 3" X 3/4" dia. smooth aluminum rod.

SET:
 US 287 CM-MP 123.0
 GPS PROJECT STATION
 N: 95651.803
 E: 151017.428
 EL: 1276.695

FOUND:
 CP 71
 GPS PROJECT STATION
 N: 95386.102
 E: 150999.285
 EL: 1278.271

FOUND:
 CP 70
 GPS PROJECT STATION
 N: 95190.114
 E: 151032.279
 EL: 1274.380

