

U.S. ROAD DIST. NO.	STATE	U.S.P.W. PROJ. NO.	SHEET NO.	TOTAL SHEETS
2	COL.	N.R.M. 74 & 191	1	1

Rev. 3-16-34 HSD
Rev. 3-25-35 A.Z.

COLORADO STATE HIGHWAY DEPARTMENT

PLAN AND PROFILE OF PROPOSED U.S.P.W. PROJECT NOS N.R.M. 74 & 191 STATE HIGHWAY NOS 2 & 13 MOFFAT COUNTY

INDEX OF SHEETS

SHEET No 1	TITLE SHEET - COMBINED
2	TYPICAL SECTIONS & SUMMARY - COMBINED
3	PLAN & PROFILE, PROJ. N.R.M. 74
4	PLAN & PROFILE, PROJ. N.R.M. 191

CONVENTIONAL SIGNS

CENTER LINE OF SURVEY	—+—
RIGHT OF WAY LINE	—=—
PROPERTY LINE	—- - -
TOWNSHIP LINE	—+—+—+—
SECTION LINE	—+—+—+—+—
ONE QUARTER SECTION LINE	—+—+—+—+—+—
POLE LINES	—+—+—+—+—+—+—

SCALES
ON PLAN, 1 IN. = 100 FT.
ON PROFILE 1 IN. = 100 FT. HORIZONTAL
1 IN. = 10 FT. VERTICAL
GRADE LINE ON PROFILE IS SHOWN AS GRADE OF FINISHED ROAD
GROSS LENGTH OF PROJECT 3,180.2 FT. = 0.602 MI. = N.R.M. 74
NET LENGTH OF PROJECT 2,610.0 FT. = 0.494 MI. = N.R.M. 191

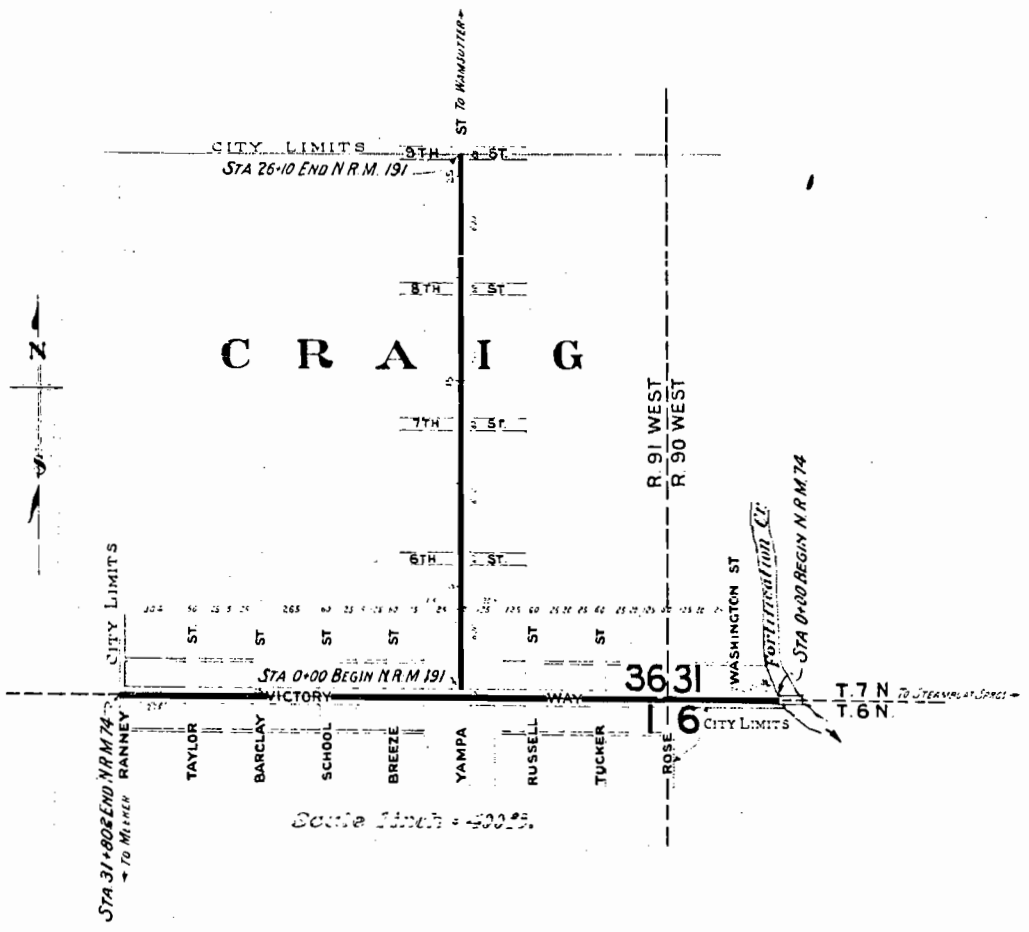

FILE COPY
Do Not Remove

RECOMMENDED FOR APPROVAL 3/10/34
[Signature]
 ASSISTANT ENGINEER
 APPROVED
[Signature]
 STATE HIGHWAY ENGINEER
 RECOMMENDED FOR APPROVAL
 DIST. ENG. BUREAU PUBLIC ROADS
 RECOMMENDED FOR APPROVAL
 CHIEF ENG. BUREAU PUBLIC ROADS
 APPROVED
 DIRECTOR BUREAU PUBLIC ROADS

CRAIG

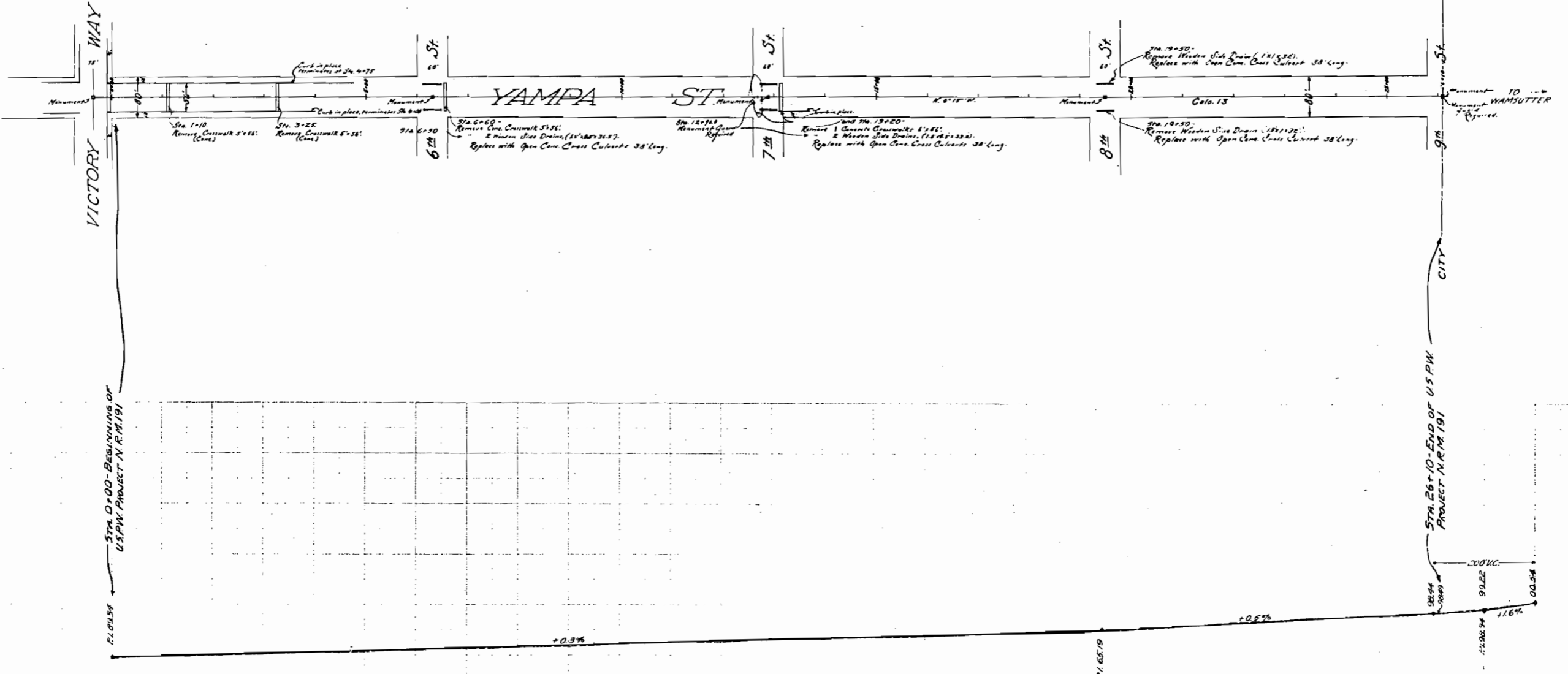

10-31-21
 10-31-21
 10-31-21

STA. 0+00 - BEGINNING OF
 USPW PROJECT N.R.M. 191

STA. 26+10 - END OF USPW
 PROJECT N.R.M. 191

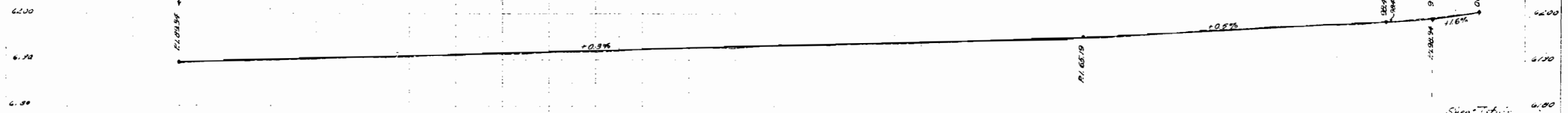

Prelim Data
 EXCAVATION
 EMBANKMENT +1.5%

20	62	57	52	50	50	44	27	15	15	15	24	19	37	37	7	11	15	20	19	6	7	46	61	46	48	24	19
0	0	0	0	0	0	0	6	3	10	22	22	20	8	5	10	15	17	18	8	13	17	3	5	5	5	5	0

Sheet 15 of 15
 EMBANKMENT
 END OF PROJECT