

INDEX OF SHEETS

COLORADO

STATE HIGHWAY DEPARTMENT

PLAN AND PROFILE OF PROPOSED
P.W.A. DOCKET COLO. 8007-B
FEDERAL AID PROJECT NO. 6007-B

STATE HIGHWAY NO. _____

CONVENTIONAL SIGNS

- Center line of project _____
- Right of way lines _____
- Township or range lines _____
- Section lines _____
- Quarter section lines _____
- Railroad center line _____
- Barbed wire fence _____
- Wire cable guard fence _____
- Combination fence _____
- Board and slab fence _____
- Picket fence _____
- Telephone lines _____
- Power lines _____
- Power lines (Steel towers) _____

SCALES
 ON PLAN 1 INCH = 100 FT.
 ON PROFILE 1 INCH = 100 FT. HORIZONTAL
 1 INCH = 10 FT. VERTICAL
 GRADE LINE ON PROFILE IS SHOWN AS GRADE OF FINISHED ROAD
 CROSS LENGTH OF PROJECT _____
 NET LENGTH OF PROJECT _____

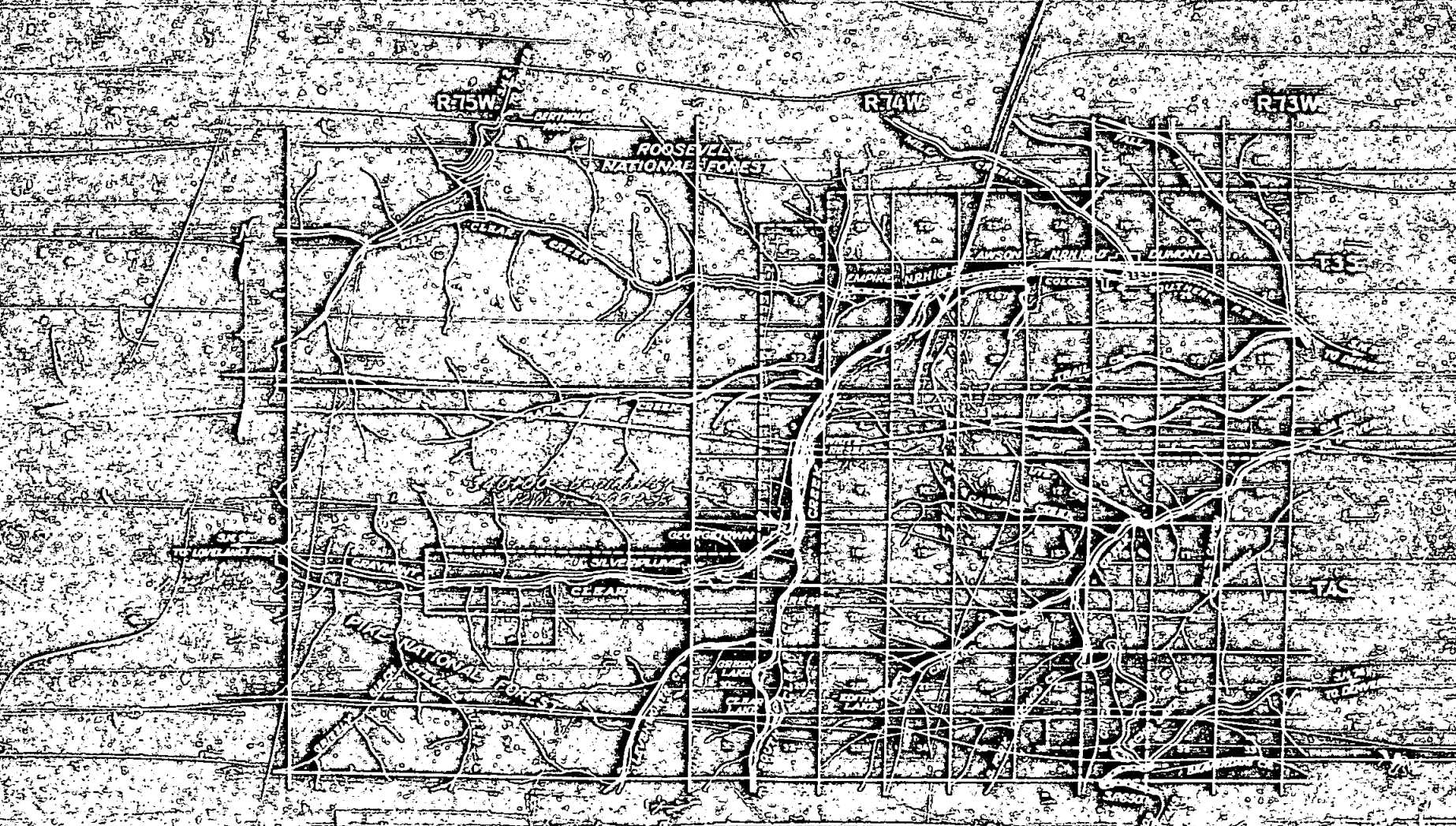

Note:
 It is recommended that holders on this project
 review the plan details with one of the following
 field representatives of this department:
 E.E. Montgomery, Division Engineer, Denver, Colo.
 B.F. Miller, Resident Engineer, Denver, Colo.

Scale 1 in. = 1 mi.

1027
S.G.
1027
S.G.
1027
S.G.

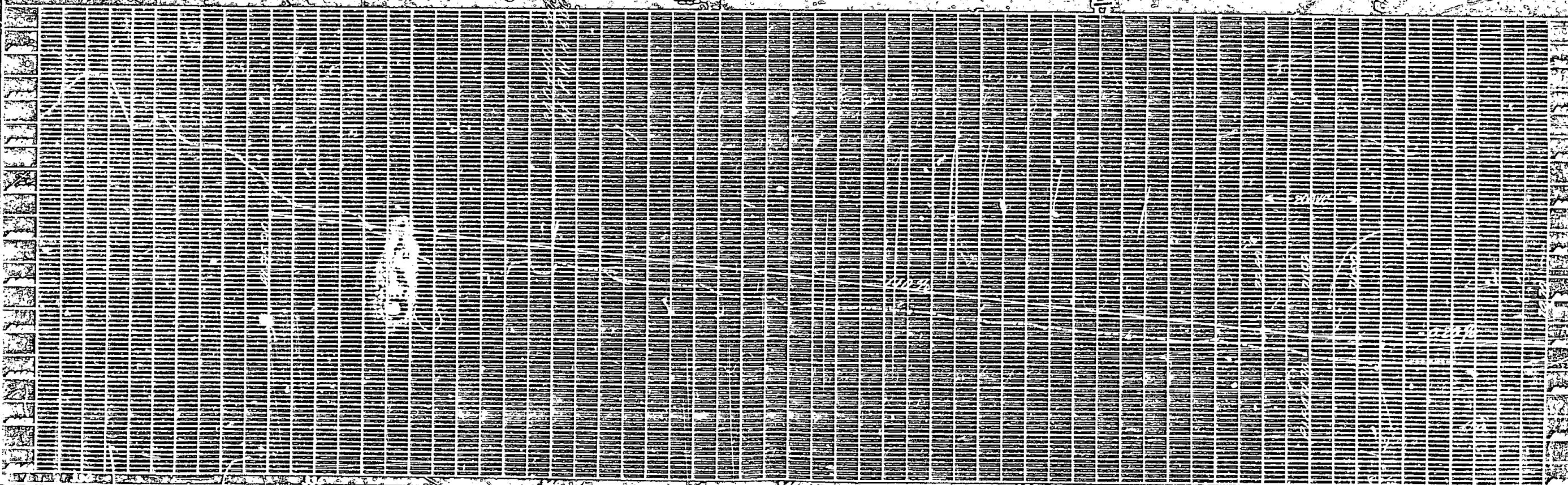
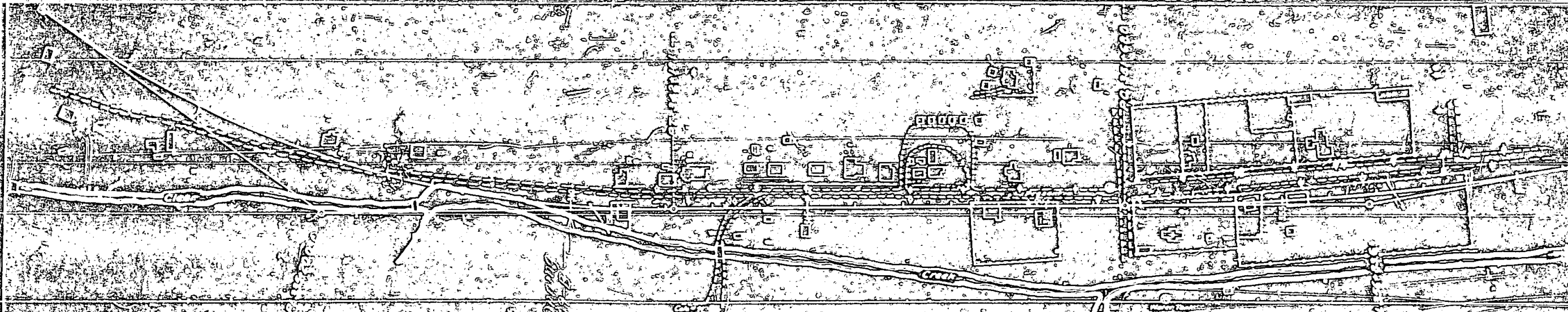

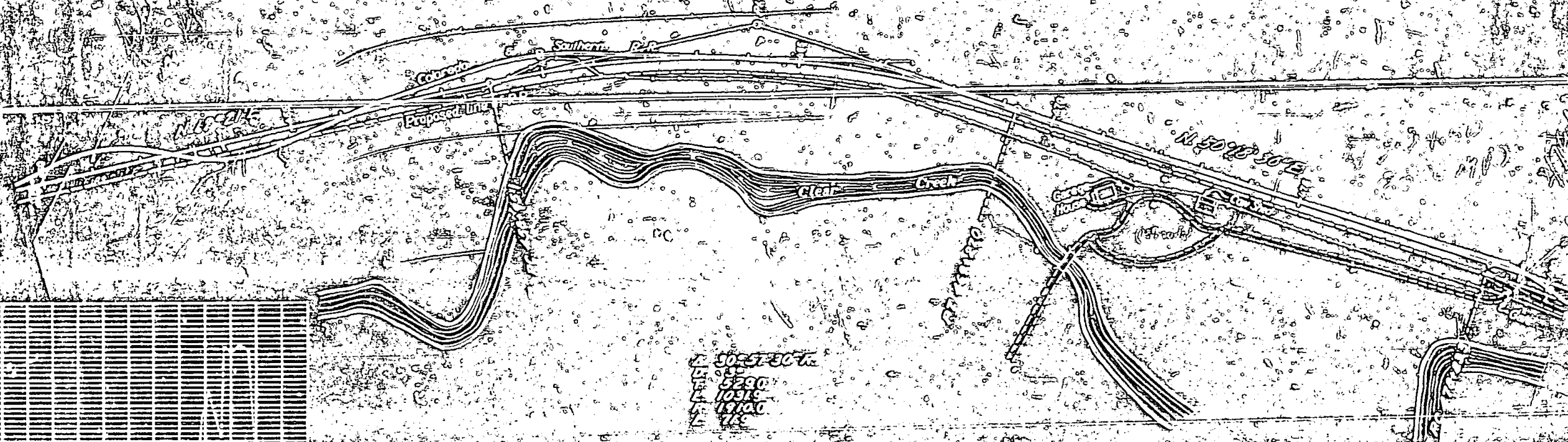

50-57-30 W
 T. 5290
 R. 10919
 S. 19100
 T. 78

1/4 Sec. 10 and 11, T. 5290, R. 10919, S. 19100

1/4 Sec. 10 and 11, T. 5290, R. 10919, S. 19100

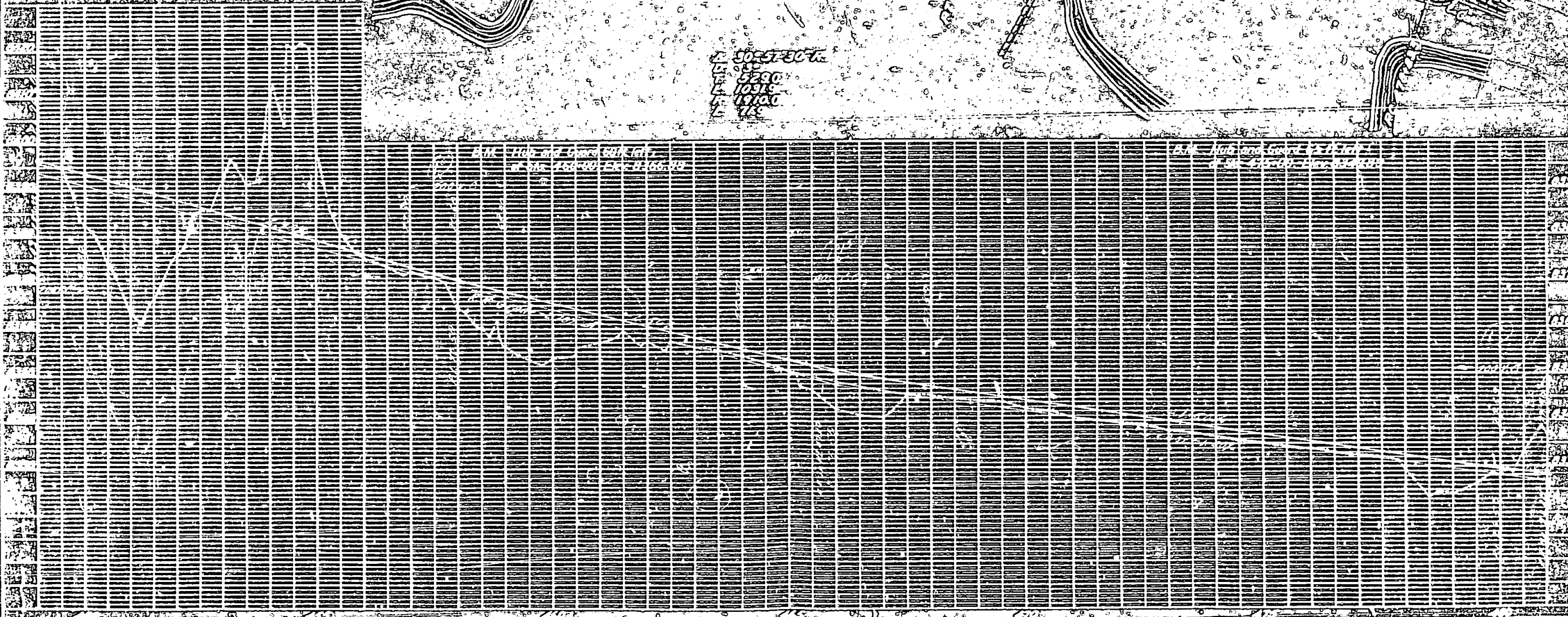

U.S. GEOLOGICAL SURVEY
STATE OF CALIFORNIA
COUNTY OF COLOSADO

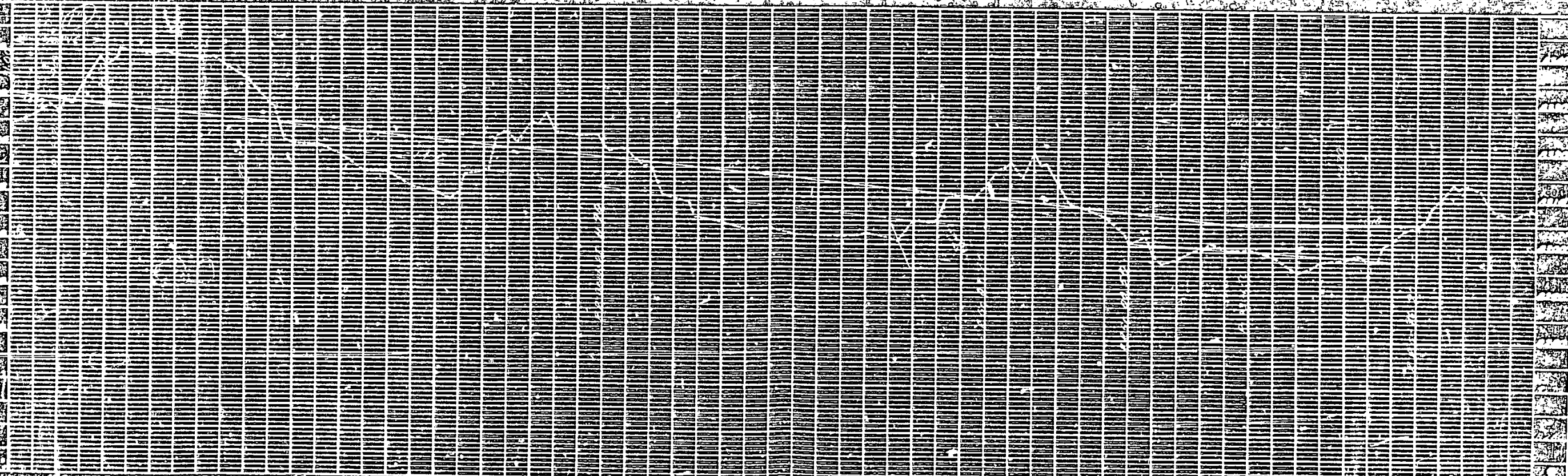
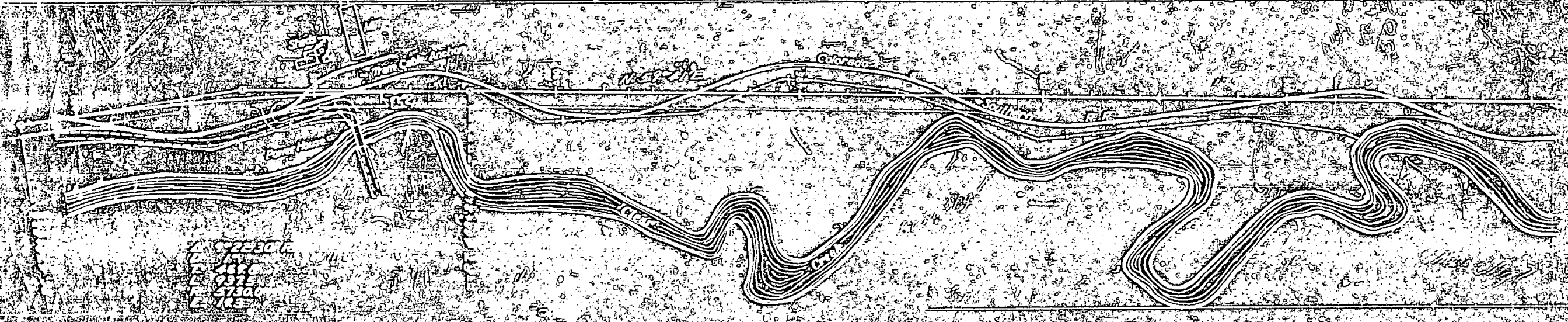

FEDERAL ROAD DISTRICT NO.	STATE	CONTRACT NO.	SECTION	DATE
1	COLORADO	1000		

