

# STATE DEPARTMENT OF HIGHWAYS DIVISION OF HIGHWAYS - STATE OF COLORADO

FEDERAL ROAD REGION NO.	DIVISION	PROJECT NO.	SHEET NO.	TOTAL SHEETS
VIII	COLORADO	RS(CX) 0096(24)	1	4

RIGHT OF WAY				
JCT. SH 165				
REVISIONS				
DATE	BY	DESCRIPTION	POST	AP
7/91		CHANGED PROJECT NUMBER		MS

## RIGHT OF WAY PLAN OF PROPOSED FEDERAL AID PROJECT NO. RS(CX) 0096(24) STATE HIGHWAY NO 96 CUSTER COUNTY RIGHT OF WAY

### CONVENTIONAL SIGNS

County Line	-----
Township or Range Line	-----
Land Lines Section Line 1/4 Section Line 1/16 Section Line	-----
Property or Tract Line	-----
City Limits	-----
Railroad	-----
Existing Road	-----
New Road	-----
Control of Access	-----
Access denied by Deed	-----
Right of Way Line	-----
Protected by Freeway (Virgin Location)	-----
Top of Cuts	-----
Toe of Fills	-----
Barbed Wire Fence	-----
Chain Link Fence	-----
Woven Wire-Combination Fence	-----
Snow Fence	-----
Wood Fence	-----
Deer Fence	-----
Trees	Deciduous:  Coniferous:
Tel. & Teleg. Lines	-----
Electric Lines	-----
Elec. Trans. Tower	-----
Buried Tel. Cable	-----
Buried Electric Cable	-----
Gas Main	-----
Oil Main	-----
Water Main	-----
Sanitary Sewers	-----
Storm Sewers	-----
Road Approaches	-----
Section Corner	-----
Culverts & Drains	-----
Bridges	-----

### SCALES OF ORIGINAL DRAWINGS

PLAN SHEETS 1" = 100'  
R.O.W. LENGTH OF PROJECT = 1,417.38 FEET OR 0.27 MILES

### INDEX OF SHEETS

- 1 TITLE SHEET
- 2 TABULATION OF PROPERTIES SHEET
- 3 CONTROL AND MONUMENTATION SHEET
- 4 PLAN SHEET

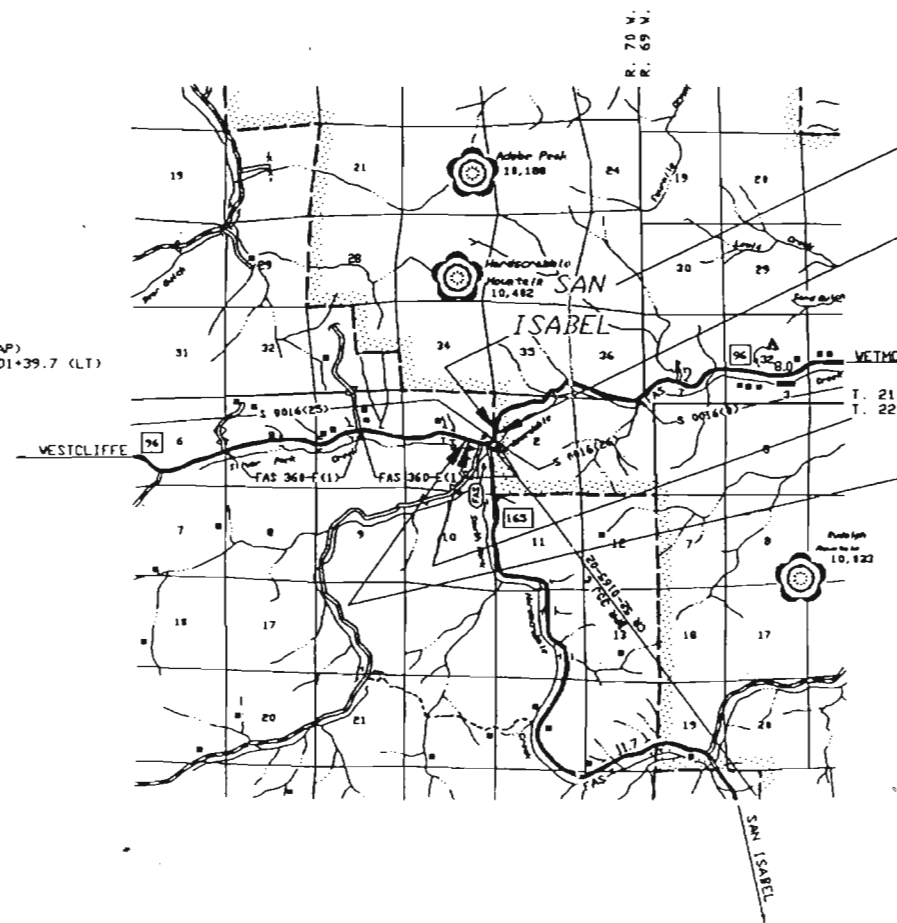

STA P.D.C. 26+67.38 END R.O.W. PROJECT RS(CX) 0096(24)  
0.30' RT. OF STA P.D.C. 297+75.91 PROJECT S 0016(26)  
MILE POST 16.75

STA P.D.C. 26+18.94 END CONSTR. PROJECT RS(CX) 0096(24)  
MILE POST 16.74

STA 14+98.13 BEGIN CONSTR. PROJECT RS(CX) 0096(24)  
MILE POST 16.53

STA 12+50.00 BEGIN R.O.W. PROJECT RS(CX) 0096(24)  
0.19' LT OF STA 282+36.93 PROJECT FAS 360-E(1)  
MILE POST 16.48

### BASIS OF BEARINGS

ALL BEARINGS ARE REFERENCED TO A LINE CONNECTING COLORADO DEPARTMENT OF HIGHWAYS ROW MARKERS (BRASS CAPS SET IN CONCRETE) STAMPED FAS 360-E(1) STA 294+58.9 (RT) AND S 0016(26) STA 301+39.7 (LT) HAVING AN ASSUMED BEARING OF N. 1° 45' 06" E.

CDM ROW MARKER (BRASS CAP)  
STAMPED S 0016(26) STA 301+39.7 (LT)  
SURVEY PNT 54

694.57'  
N. 01° 45' 06" E.

CDM ROW MARKER (BRASS CAP)  
STAMPED FAS 360-E(1) STA 294+58.9 (RT)  
SURVEY PNT 51

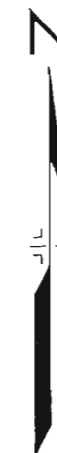
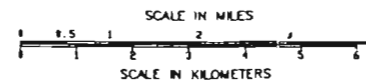

DEPARTMENT OF TRANSPORTATION FEDERAL HIGHWAY ADMINISTRATION	
AUTHORIZED _____	DATE _____
DMSION ADMINISTRATOR	

05/14/91 \89060596\ACAD\890605HI.DWG PRUDICA

DATE: MARCH 1991  
SUBACCOUNT: 89060  
DISTRICT II



DIVISION	PROJECT NO.	SHEET NO.
VIII COLORADO	RS(CX) 0096(24)	3

DATE	REVISIONS	INIT
7/91	CHANGED PROJ. NUMBER	NS

CONTROL SURVEY  
RS(CX) 0096(24)  
CUSTER COUNTY  
TOWNSHIP 22 SOUTH, RANGE 70 WEST  
OF THE 6TH PRINCIPLE MERIDIAN

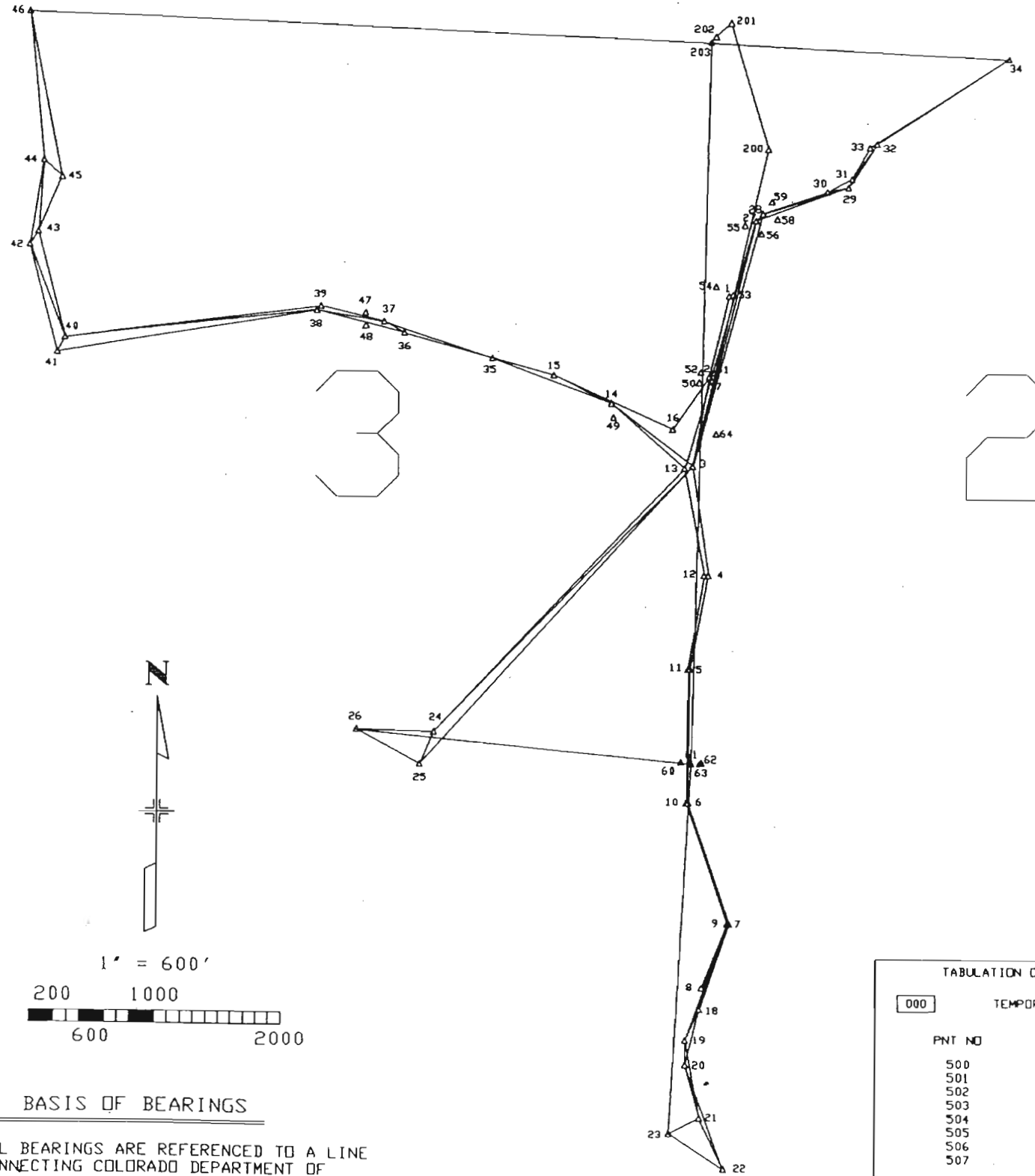

Pt No	Northing	Easting	Elev	Description
1	10000.0226	9999.8944	2951.890	SH 96 MP 16.82 CONTROL MONUMENT
2	9353.1636	9841.6870	2973.3000	SH 96 MP 16.69 #4 REBAR
3	8635.8571	9713.1732	3007.0400	SH 165 MP 0.10 CONTROL MONUMENT
4	7750.2926	9839.7646	3023.2500	SH 165 MP 0.25 CONTROL MONUMENT
5	7087.3231	9692.0732	3048.4200	SH 165 MP 0.40 CONTROL MONUMENT
6	5944.8945	9680.6470	3090.4600	SH 165 MP 0.60 #4 REBAR
7	4975.2999	10014.4092	3130.7900	SH 165 MP 0.80 CONTROL MONUMENT
8	4463.2547	9791.2424	3144.2100	SH 165 MP 0.90 CONTROL MON (DESTROYED)
9	4973.6641	9995.1885	<Null>	SH 165 MP 0.80 # 4 REBAR
10	5944.2690	9669.1843	3088.9700	SH 165 MP 0.60 CONTROL MONUMENT
11	7088.5613	9680.2724	<Null>	SH 165 MP 0.40 #4 REBAR
12	7761.8818	9805.0250	<Null>	SH 165 MP 0.25 #4 REBAR
13	8616.8667	9649.2873	3083.9700	SH 165 MP 0.10 #4 REBAR
14	9135.3665	9067.9788	3014.2500	SH 96 MP 16.54 CONTROL MONUMENT
15	9356.5430	8611.1039	3031.6600	SH 96 MP 16.42 CONTROL MONUMENT
16	8929.5381	9551.5308	2997.2000	SH 165 MP 0.01 #4 REBAR
17	9346.5010	9838.4784	2973.0200	SH 96 MP 16.69 #4 REBAR
18	4295.0473	9775.5611	<Null>	CONTROL MONUMENT BA SH 165
19	4055.0043	9665.2894	<Null>	SPIKE 18 SH 165
20	3859.6253	9664.6774	<Null>	CONTROL MONUMENT 20 SH 165
21	3432.4292	9778.1944	<Null>	SPIKE 19 SH 165
22	3030.8406	9978.4162	<Null>	CONTROL MONUMENT 21 SH 165
23	3388.9069	9537.3993	<Null>	QUARTER COR 10111 BRASS CAP
24	6500.2222	7658.5379	<Null>	SPIKE 30
25	6241.3045	7544.5590	<Null>	SPIKE 31
26	6516.8880	7039.4132	<Null>	QUARTER COR 3/10 MARKED STONE
27	18604.2121	10217.5936	<Null>	SPIKE 23 SH 96
28	18657.5050	10273.2515	<Null>	SPIKE 24 SH 96
29	18870.7269	10957.7079	<Null>	SPIKE 25 SH 96
30	18833.9355	10789.5548	<Null>	SPIKE 26 SH 96
31	18940.4887	10984.8750	<Null>	SPIKE 27 SH 96
32	11215.3533	11182.8760	<Null>	SPIKE 28 SH 96
33	11188.8373	11122.9296	<Null>	SPIKE 29 SH 96
34	11889.8035	12244.0623	<Null>	QUARTER COR 25/2 BRASS CAP/MOUND
35	9491.5111	8118.8638	<Null>	SPIKE 43 SH 96
36	9692.6892	7412.7837	<Null>	SPIKE 42 SH 96
37	9788.1196	7250.3942	<Null>	SPIKE 41 SH 96
38	9868.8520	6788.1169	<Null>	SPIKE 34 SH 96
39	9982.9470	6741.1907	<Null>	SPIKE 33 SH 96
40	9653.2584	4694.2582	<Null>	SPIKE 35 SH 96
41	9532.2715	4635.1174	<Null>	SPIKE 36
42	10387.1722	4415.5126	<Null>	SPIKE 38
43	10495.0695	4483.9663	<Null>	SPIKE 37
44	11035.6976	4529.3242	<Null>	SPIKE 40
45	10924.7797	4673.3562	<Null>	SPIKE 39
46	12241.5567	4419.7573	<Null>	SECTION COR 33-34-4-3 BRASS CAP
47	9851.3320	7102.8340	<Null>	ROW MARKER SH 96 264+12 LT
48	9749.5518	7103.8146	<Null>	ROW MARKER SH 96 264+36 RT
49	9023.5699	9085.2714	<Null>	ROW MARKER SH 96 285+50 RT
50	9383.4578	9761.8085	<Null>	ROW MARKER SH 96 293+60 LT
51	9383.5165	9876.2049	<Null>	ROW MARKER SH 96 294+58.9 RT
52	9387.0536	9776.7241	<Null>	ROW MARKER SH 96 294+58.9 LT
53	10813.8892	10033.0730	<Null>	ROW MARKER SH 96 301+39.7 RT
54	10077.7607	9897.4348	<Null>	ROW MARKER SH 96 301+39.7 LT
55	10565.3386	10127.1215	<Null>	ROW MARKER SH 96 306+78.1 LT
56	10581.0215	10262.9842	<Null>	ROW MARKER SH 96 306+78.1 RT
58	10612.8631	10390.5298	<Null>	ROW MARKER SH 96 309+14.1 RT
59	10755.3975	10345.3791	<Null>	ROW MARKER SH 96 309+14.1 LT
60	6266.5919	9623.8560	<Null>	ROW MARKER SH 165 301+85 LT
61	6253.1077	9785.6594	<Null>	SEC COR 2-2-10-11 TYPE 3 MONUMENT
62	6259.8847	9786.0356	<Null>	ROW MARKER SH 165 301+85 RT
63	6252.1413	9771.6057	<Null>	LS CAP HIGH COUNTRY #3553
64	8893.0164	9897.6075	<Null>	BEARING TREE 98 LKS W/STONE BESIDE
200	11171.6365	10316.8675	<Null>	TRAVERSE SPIKE
201	12170.1774	10015.7333	<Null>	TRAVERSE SPIKE
202	12962.2782	9894.8432	<Null>	TRAVERSE SPIKE
203	12015.3000	9855.7148	<Null>	SECTION COR 34-35-2-3 BRASS CAP

**GENERAL NOTES**

- This Right of Way plan is not a complete boundary survey of all adjoining owners and is prepared for Highway Department purposes only.
- Survey Control Points set with a higher degree of accuracy than R.O.W. Markers.
- NOTICE: According to Colorado law you must commence any legal action based upon any defect in this survey within three years after you first discover such defect in no event may any action based upon any defect in this survey be commenced more than ten years from the date of the certification shown hereon.
- All R.O.W. Markers set from survey control points.
- All centerline and offset stationing is theoretical only and may not represent the centerline as constructed in the field. All stationing is approximate.
- All coordinates listed are assumed project coordinates only.
- Field survey control precision computed to exceed 1/20,000.

TABULATION OF ROW MONUMENTS TO BE SET		
PNT NO.	NORTHING	EASTING
400	9284.021	8841.898
401	9227.226	9108.177
402	9245.193	9500.839
403	9713.816	9780.196
404	9359.685	8301.102
405	9042.104	9249.333
406	9012.093	9338.941
407	9485.734	9905.229

TABULATION OF EASEMENTS TO BE STAKED		
TEMPORARY EASEMENTS		
PNT NO	NORTHING	EASTING
500	5001.621	9375.901
501	6983.943	9358.223
502	6978.210	9387.670
503	8995.888	9405.348
504	9437.215	9891.581
505	9437.215	9932.832
506	9477.215	9932.832
507	9477.215	9902.832

TABULATION OF ALIQUOT CORNERS TO BE SET			
PNT NO	NORTHING	EASTING	DESCRIPTION
89	8914.616	9753.971	1/4 COR. 2-3, T22S, R70W

**QUANTITY OF MONUMENTS SET**

CAP TYPE	MONUMENT TYPE							
	1	1A	2	2A	3	3A	4	5
REFERENCE								
RIGHT OF WAY								
CONTROL			12					
ALIQUOT CORNER						1		
WITNESS POST								

SEAL

**SURVEYOR CERTIFICATE (FIELD)**

CONTROL SURVEY AND MONUMENTATION WAS DONE UNDER MY SUPERVISION AND CHECKING.  
NAME \_\_\_\_\_ P.L.S. NO. \_\_\_\_\_  
DATE \_\_\_\_\_

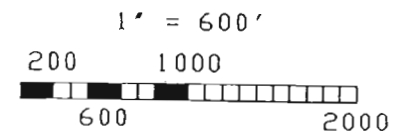

**BASIS OF BEARINGS**

ALL BEARINGS ARE REFERENCED TO A LINE CONNECTING COLORADO DEPARTMENT OF HIGHWAYS ROW MARKERS (BRASS CAPS SET IN CONCRETE) STAMPED FAS 360-E(1) STA 294+58.9 (RT) AND S 0016(26) STA 301+39.7 (LT) HAVING AN ASSUMED BEARING OF N. 1 45' 06' E.

