

STATE DEPARTMENT OF HIGHWAYS DIVISION OF HIGHWAYS — STATE OF COLORADO

PLAN AND PROFILE OF PROPOSED
FEDERAL AID PROJECT NO. RS 0014(II)

STATE HIGHWAY NO. 14
LARIMER COUNTY

RIGHT OF WAY

SCALE OF ORIGINAL DRAWINGS
PLAN SHEETS 1" = 50'
DETAIL SHEETS 1" = 1"
OWNERSHIP MAPS 1" = 1"

ROW LENGTH OF PROJECT = 0.321 MILES

INDEX OF SHEETS

- 1 TITLE SHEET
- 2 TABULATION OF PROPERTIES
- 3 PLAN SHEET

FEDERAL AID PROJECT NO.	DIVISION	COLORADO	PROJECT NO.	SHEET NO.
RS 0014(II)			RS 0014(II)	1
RIGHT OF WAY IN POUDRE CANYON STR. B-13-B				
REVISIONS				

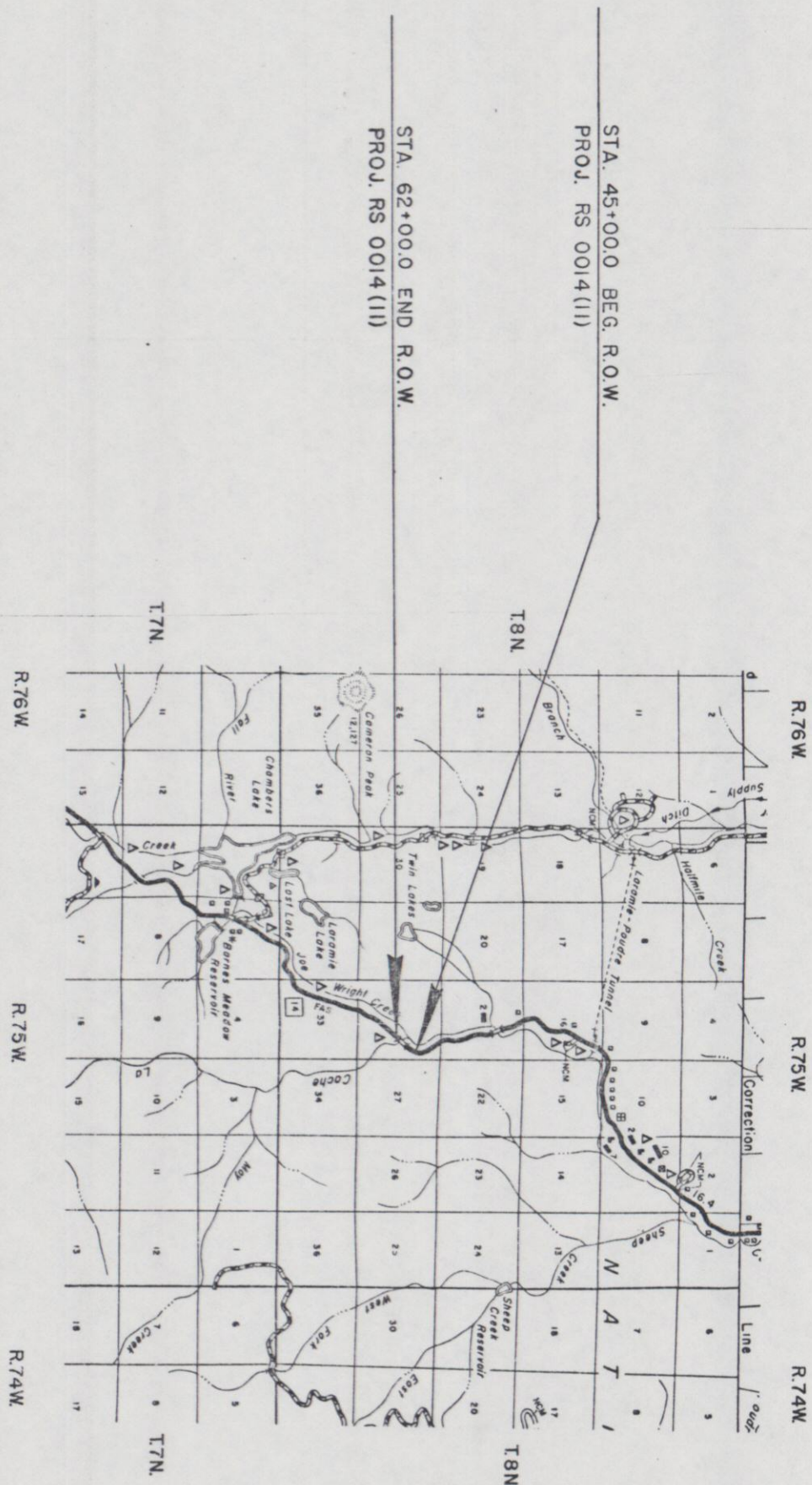
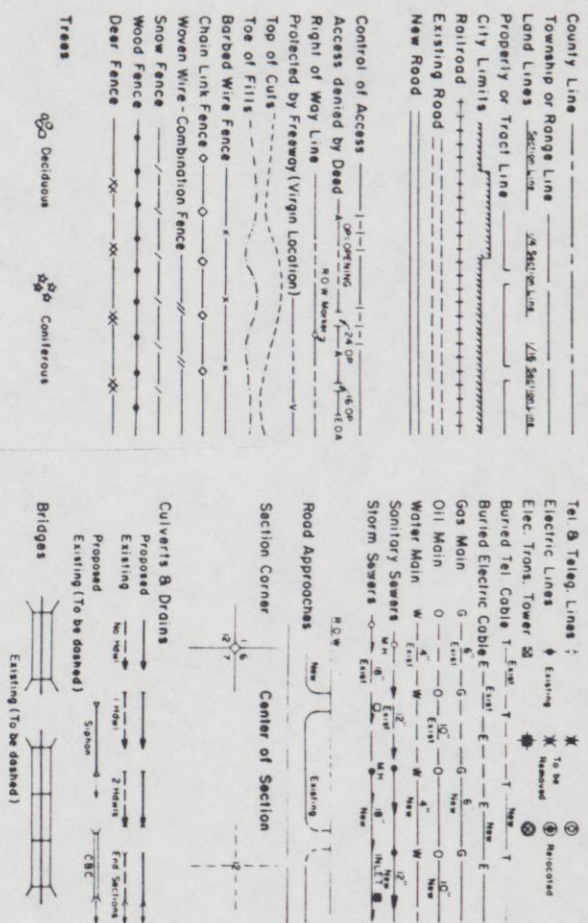

GM. 12-80
DIST. 4
SUB/DIST. 80076

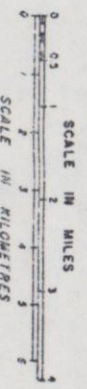

DIVISION OF HIGHWAYS

APPROVED: *R. P. [Signature]* 12-12-80
A.S.S. CHIEF ENGINEER DATE

DEPARTMENT OF TRANSPORTATION
FEDERAL HIGHWAY ADMINISTRATION

APPROVED: _____ DATE _____
DIVISION ADMINISTRATOR

