

See Standard M-100-A for STANDARD SYMBOLS

STATE DEPARTMENT OF HIGHWAYS DIVISION OF HIGHWAYS—STATE OF COLORADO

FE & ROW Under this Project.

FEDERAL ROAD DISTRICT NO.	DIVISION	PROJECT NO.	SHEET NO.
III	COLORADO	RS 0014 (II)	1

AS CONSTRUCTED			
NO REVISIONS	REVISED	10-9-81	VOID

TABULATION OF LENGTH AND DESIGN DATA

STATION	DESCRIPTION	ROADWAY		MAJOR STR. B-13-D
		LIN. FT.	LIN. FT.	
47+00	BEGIN RS 0014 (II) ON C06-0014(24) AND C06-0014(29)			
54+44.05	STR NO B-13-D	744.05		95.22
55+39.27				
59+19.02 BK	EQUATION	379.75		
59+25.96 AH				
60+00	END RS 0014 (II) ON C06-0014(24) AND C06-0014(29)	74.04		
TOTALS		1197.84	95.22	

SUMMARY

	LIN. FT.	MILES
ROADWAY	1197.84	0.227
MAJOR STRUCTURE	95.22	0.018
TOTALS (NET AND GROSS LENGTH)	1293.06	0.245

DESIGN DATA

MAXIMUM DEGREE OF CURVE	2° 30'
MAXIMUM GRADE	3.929%
MINIMUM SSD HORIZONTAL	1165'
MINIMUM SSD VERTICAL	>1300'
MAXIMUM DESIGN SPEED	60 mph
2000 DESIGN TRAFFIC VOLUME	ADT 900 DHW 300

PLAN AND PROFILE OF PROPOSED FEDERAL AID PROJECT NO. RS 0014 (II) STATE HIGHWAY NO. 14 LARIMER COUNTY

SCALES OF ORIGINAL DRAWINGS
ON PLAN, 1 IN. = 50 FT.
ON PROFILE { 1 IN. = 50 FT. HORIZONTAL
1 IN. = 5 FT. VERTICAL
GRADE LINE ON PROFILE IS SHOWN AS GRADE OF FINISHED ROAD

AS CONSTRUCTED PLANS
RETURN TO DIST. 4 DESIGN

SHEET NO.

- 1
- 2
- 3
- 4-5
- 6
- 7
- 8-19
- 20
- 21-23
- 2A-27
- 28-29
- 30
- 1, 2-8, 12, 20
- 2, 9-11, 13-19, 21-23

INDEX OF SHEETS

- 1 TITLE SHEET, SKETCH MAP AND TABULATION OF LENGTH AND DESIGN DATA AND INDEX OF SHEETS.
- 2 INDEX OF STANDARDS
- 3 TYPICAL SECTIONS AND GENERAL NOTES
- 4-5 SUMMARY OF APPROXIMATE QUANTITIES.
- 6 SUMMARY OF EARTHWORK QUANTITIES, STRUCTURE QUANTITIES, BASE COURSE AND SURFACE COURSE PLAN, DELINEATORS, GUARD RAIL, SCHEDULE OF CONSTRUCTION TRAFFIC SIGNS AND WETTING QUANTITIES.
- 7 PIT SKETCH
- 8-19 BRIDGE PLANS, STR NO. B-13-D
- 20 PLAN AND PROFILE SHEET
- 21-23 STANDARD M-206-AB (SPECIAL THIS PROJECT)
- 2A-27 ROARING CREEK TRAIL BORROW PIT
- 28-29 BORROW PIT STA. 37+ RT.
- 30 CHANNEL CHANGE
- REVISED SHEETS
- NO REVISIONS

STA. 60+00 END RS 0014 (II)
ON C 06-0014 (24)
AND C 06-0014 (29)

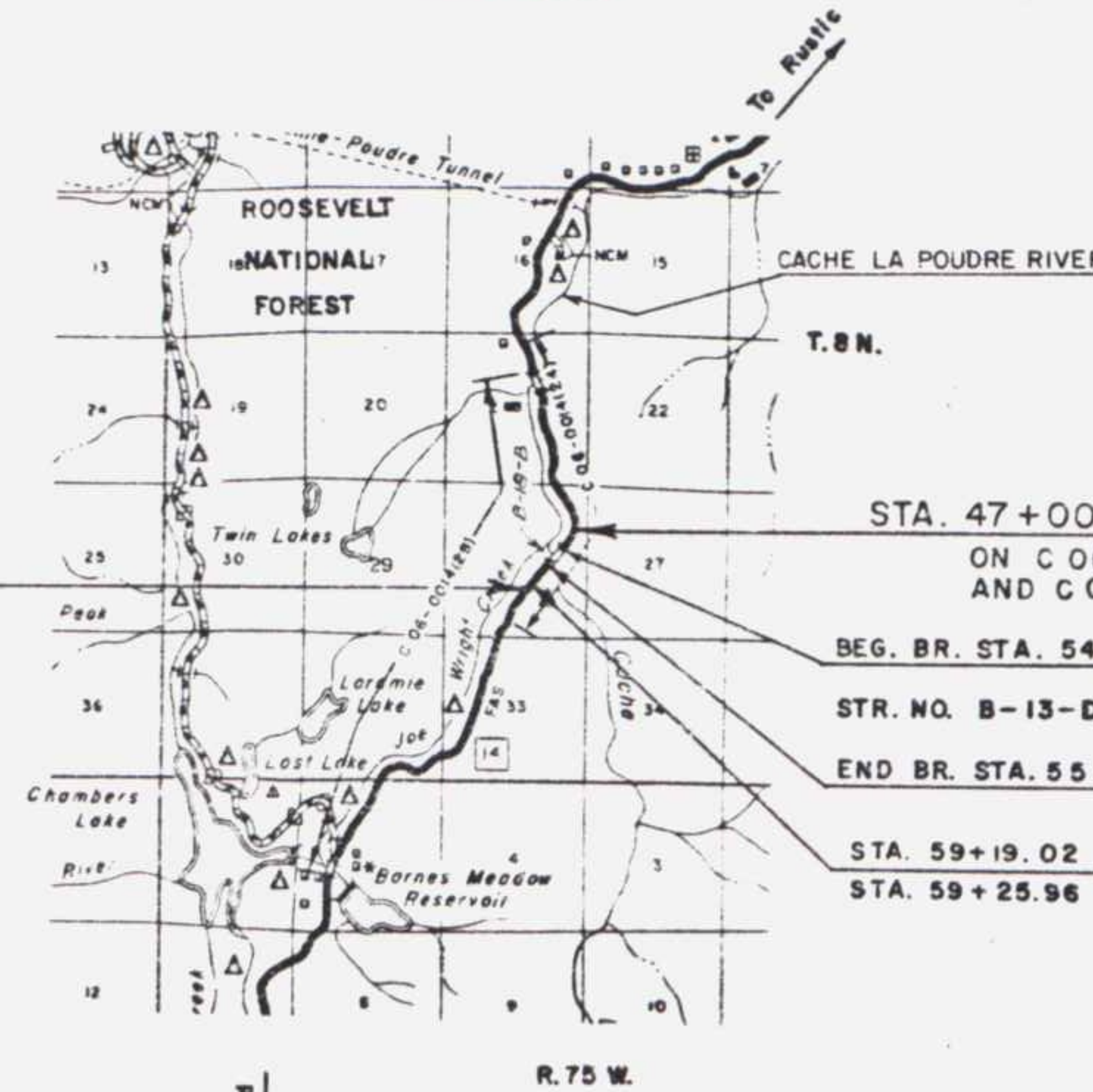

STA. 47+00 BEGIN RS 0014 (II)
ON C 06-0014 (24)
AND C 06-0014 (29)

BEG. BR. STA. 54+44.05

STR. NO. B-13-D

END BR. STA. 55+39.27

STA. 59+19.02 BK. =
STA. 59+25.96 AH.

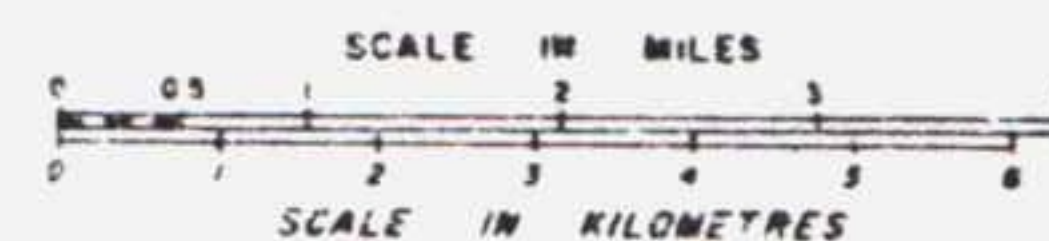

NEW & REV. STANDARDS

- M-606-AC GUARD RAIL, TYPE 3, W-BEAM, 7-01-80 (8 SHEETS)
- M-620-E FIELD LABORATORY CLASS 1, 5-30-80

DIVISION OF HIGHWAYS	
APPROVED:	
<i>EN. Wallace B. Peterson</i>	12-26-80
CHIEF ENGINEER	DATE

AS CONSTRUCTED INFORMATION	
CONTRACTOR	BAILEY CONSTRUCTION Co.
RESIDENT ENGINEER	Don Atkins
(Project or Revision)	R. THE FARLAND
PROJECT STARTED	2-16-81
PROJECT COMPLETED	10-9-81
AS CONSTRUCTED PLANS APPROVED	<i>W. Peterson</i>
	12/26/81
TITLE	DATE