

See Standard M-100-A for STANDARD SYMBOLS

STATE DEPARTMENT OF HIGHWAYS DIVISION OF HIGHWAYS — STATE OF COLORADO

PLAN AND PROFILE OF PROPOSED FEDERAL AID PROJECT NO. RS 0014(4) STATE HIGHWAY NO. 14 LOGAN COUNTY

**AS CONSTRUCTED PLANS
RETURN TO DIST. 4 DESIGN**

SHEET NO

- 1 TITLE PAGE, SKETCH MAP AND TABULATION OF LENGTH & DESIGN DATA
- 2 TYPICAL SECTIONS
- 3 GENERAL NOTES AND SUMMARY OF EARTHWORK QUANTITIES
- 4 - 5 SUMMARY OF ~~APPROXIMATE~~ QUANTITIES
- 6 - 8 STRUCTURE QUANTITIES
- 9 SURFACING PLAN
- 10 MATERIAL PITS

- 11 TABULATIONS OF FENCING & DELINEATORS AND DETAIL OF TRANSITION STA. 96+00 TO STA. 104+00
- 12 - 16 PLAN AND PROFILE SHEETS
- 17 - ~~18~~ ~~19~~ ~~20~~ ~~21~~ ~~22~~ ~~23~~ ~~24~~ ~~25~~ ~~26~~ ~~27~~ ~~28~~ ~~29~~ ~~30~~ ~~31~~ ~~32~~ ~~33~~ ~~34~~ ~~35~~ ~~36~~ ~~37~~ ~~38~~ ~~39~~ ~~40~~ ~~41~~ ~~42~~ ~~43~~ ~~44~~ ~~45~~ ~~46~~ ~~47~~ ~~48~~ ~~49~~ ~~50~~ ~~51~~ ~~52~~ ~~53~~ ~~54~~ ~~55~~ ~~56~~ ~~57~~ ~~58~~ ~~59~~ ~~60~~ ~~61~~ ~~62~~ ~~63~~ ~~64~~ ~~65~~ ~~66~~ ~~67~~ ~~68~~ ~~69~~ ~~70~~ ~~71~~ ~~72~~ ~~73~~ ~~74~~ ~~75~~ ~~76~~ ~~77~~ ~~78~~ ~~79~~ ~~80~~ ~~81~~ ~~82~~ ~~83~~ ~~84~~ ~~85~~ ~~86~~ ~~87~~ ~~88~~ ~~89~~ ~~90~~ ~~91~~ ~~92~~ ~~93~~ ~~94~~ ~~95~~ ~~96~~ ~~97~~ ~~98~~ ~~99~~ ~~100~~ ~~101~~ ~~102~~ ~~103~~ ~~104~~ ~~105~~ ~~106~~ ~~107~~ ~~108~~ ~~109~~ ~~110~~ ~~111~~ ~~112~~ ~~113~~ ~~114~~ ~~115~~ ~~116~~ ~~117~~ ~~118~~ ~~119~~ ~~120~~ ~~121~~ ~~122~~ ~~123~~ ~~124~~ ~~125~~ ~~126~~ ~~127~~ ~~128~~ ~~129~~ ~~130~~ ~~131~~ ~~132~~ ~~133~~ ~~134~~ ~~135~~ ~~136~~ ~~137~~ ~~138~~ ~~139~~ ~~140~~ ~~141~~ ~~142~~ ~~143~~ ~~144~~ ~~145~~ ~~146~~ ~~147~~ ~~148~~ ~~149~~ ~~150~~ ~~151~~ ~~152~~ ~~153~~ ~~154~~ ~~155~~ ~~156~~ ~~157~~ ~~158~~ ~~159~~ ~~160~~ ~~161~~ ~~162~~ ~~163~~ ~~164~~ ~~165~~ ~~166~~ ~~167~~ ~~168~~ ~~169~~ ~~170~~ ~~171~~ ~~172~~ ~~173~~ ~~174~~ ~~175~~ ~~176~~ ~~177~~ ~~178~~ ~~179~~ ~~180~~ ~~181~~ ~~182~~ ~~183~~ ~~184~~ ~~185~~ ~~186~~ ~~187~~ ~~188~~ ~~189~~ ~~190~~ ~~191~~ ~~192~~ ~~193~~ ~~194~~ ~~195~~ ~~196~~ ~~197~~ ~~198~~ ~~199~~ ~~200~~ ~~201~~ ~~202~~ ~~203~~ ~~204~~ ~~205~~ ~~206~~ ~~207~~ ~~208~~ ~~209~~ ~~210~~ ~~211~~ ~~212~~ ~~213~~ ~~214~~ ~~215~~ ~~216~~ ~~217~~ ~~218~~ ~~219~~ ~~220~~ ~~221~~ ~~222~~ ~~223~~ ~~224~~ ~~225~~ ~~226~~ ~~227~~ ~~228~~ ~~229~~ ~~230~~ ~~231~~ ~~232~~ ~~233~~ ~~234~~ ~~235~~ ~~236~~ ~~237~~ ~~238~~ ~~239~~ ~~240~~ ~~241~~ ~~242~~ ~~243~~ ~~244~~ ~~245~~ ~~246~~ ~~247~~ ~~248~~ ~~249~~ ~~250~~ ~~251~~ ~~252~~ ~~253~~ ~~254~~ ~~255~~ ~~256~~ ~~257~~ ~~258~~ ~~259~~ ~~260~~ ~~261~~ ~~262~~ ~~263~~ ~~264~~ ~~265~~ ~~266~~ ~~267~~ ~~268~~ ~~269~~ ~~270~~ ~~271~~ ~~272~~ ~~273~~ ~~274~~ ~~275~~ ~~276~~ ~~277~~ ~~278~~ ~~279~~ ~~280~~ ~~281~~ ~~282~~ ~~283~~ ~~284~~ ~~285~~ ~~286~~ ~~287~~ ~~288~~ ~~289~~ ~~290~~ ~~291~~ ~~292~~ ~~293~~ ~~294~~ ~~295~~ ~~296~~ ~~297~~ ~~298~~ ~~299~~ ~~300~~ ~~301~~ ~~302~~ ~~303~~ ~~304~~ ~~305~~ ~~306~~ ~~307~~ ~~308~~ ~~309~~ ~~310~~ ~~311~~ ~~312~~ ~~313~~ ~~314~~ ~~315~~ ~~316~~ ~~317~~ ~~318~~ ~~319~~ ~~320~~ ~~321~~ ~~322~~ ~~323~~ ~~324~~ ~~325~~ ~~326~~ ~~327~~ ~~328~~ ~~329~~ ~~330~~ ~~331~~ ~~332~~ ~~333~~ ~~334~~ ~~335~~ ~~336~~ ~~337~~ ~~338~~ ~~339~~ ~~340~~ ~~341~~ ~~342~~ ~~343~~ ~~344~~ ~~345~~ ~~346~~ ~~347~~ ~~348~~ ~~349~~ ~~350~~ ~~351~~ ~~352~~ ~~353~~ ~~354~~ ~~355~~ ~~356~~ ~~357~~ ~~358~~ ~~359~~ ~~360~~ ~~361~~ ~~362~~ ~~363~~ ~~364~~ ~~365~~ ~~366~~ ~~367~~ ~~368~~ ~~369~~ ~~370~~ ~~371~~ ~~372~~ ~~373~~ ~~374~~ ~~375~~ ~~376~~ ~~377~~ ~~378~~ ~~379~~ ~~380~~ ~~381~~ ~~382~~ ~~383~~ ~~384~~ ~~385~~ ~~386~~ ~~387~~ ~~388~~ ~~389~~ ~~390~~ ~~391~~ ~~392~~ ~~393~~ ~~394~~ ~~395~~ ~~396~~ ~~397~~ ~~398~~ ~~399~~ ~~400~~ ~~401~~ ~~402~~ ~~403~~ ~~404~~ ~~405~~ ~~406~~ ~~407~~ ~~408~~ ~~409~~ ~~410~~ ~~411~~ ~~412~~ ~~413~~ ~~414~~ ~~415~~ ~~416~~ ~~417~~ ~~418~~ ~~419~~ ~~420~~ ~~421~~ ~~422~~ ~~423~~ ~~424~~ ~~425~~ ~~426~~ ~~427~~ ~~428~~ ~~429~~ ~~430~~ ~~431~~ ~~432~~ ~~433~~ ~~434~~ ~~435~~ ~~436~~ ~~437~~ ~~438~~ ~~439~~ ~~440~~ ~~441~~ ~~442~~ ~~443~~ ~~444~~ ~~445~~ ~~446~~ ~~447~~ ~~448~~ ~~449~~ ~~450~~ ~~451~~ ~~452~~ ~~453~~ ~~454~~ ~~455~~ ~~456~~ ~~457~~ ~~458~~ ~~459~~ ~~460~~ ~~461~~ ~~462~~ ~~463~~ ~~464~~ ~~465~~ ~~466~~ ~~467~~ ~~468~~ ~~469~~ ~~470~~ ~~471~~ ~~472~~ ~~473~~ ~~474~~ ~~475~~ ~~476~~ ~~477~~ ~~478~~ ~~479~~ ~~480~~ ~~481~~ ~~482~~ ~~483~~ ~~484~~ ~~485~~ ~~486~~ ~~487~~ ~~488~~ ~~489~~ ~~490~~ ~~491~~ ~~492~~ ~~493~~ ~~494~~ ~~495~~ ~~496~~ ~~497~~ ~~498~~ ~~499~~ ~~500~~ ~~501~~ ~~502~~ ~~503~~ ~~504~~ ~~505~~ ~~506~~ ~~507~~ ~~508~~ ~~509~~ ~~510~~ ~~511~~ ~~512~~ ~~513~~ ~~514~~ ~~515~~ ~~516~~ ~~517~~ ~~518~~ ~~519~~ ~~520~~ ~~521~~ ~~522~~ ~~523~~ ~~524~~ ~~525~~ ~~526~~ ~~527~~ ~~528~~ ~~529~~ ~~530~~ ~~531~~ ~~532~~ ~~533~~ ~~534~~ ~~535~~ ~~536~~ ~~537~~ ~~538~~ ~~539~~ ~~540~~ ~~541~~ ~~542~~ ~~543~~ ~~544~~ ~~545~~ ~~546~~ ~~547~~ ~~548~~ ~~549~~ ~~550~~ ~~551~~ ~~552~~ ~~553~~ ~~554~~ ~~555~~ ~~556~~ ~~557~~ ~~558~~ ~~559~~ ~~560~~ ~~561~~ ~~562~~ ~~563~~ ~~564~~ ~~565~~ ~~566~~ ~~567~~ ~~568~~ ~~569~~ ~~570~~ ~~571~~ ~~572~~ ~~573~~ ~~574~~ ~~575~~ ~~576~~ ~~577~~ ~~578~~ ~~579~~ ~~580~~ ~~581~~ ~~582~~ ~~583~~ ~~584~~ ~~585~~ ~~586~~ ~~587~~ ~~588~~ ~~589~~ ~~590~~ ~~591~~ ~~592~~ ~~593~~ ~~594~~ ~~595~~ ~~596~~ ~~597~~ ~~598~~ ~~599~~ ~~600~~ ~~601~~ ~~602~~ ~~603~~ ~~604~~ ~~605~~ ~~606~~ ~~607~~ ~~608~~ ~~609~~ ~~610~~ ~~611~~ ~~612~~ ~~613~~ ~~614~~ ~~615~~ ~~616~~ ~~617~~ ~~618~~ ~~619~~ ~~620~~ ~~621~~ ~~622~~ ~~623~~ ~~624~~ ~~625~~ ~~626~~ ~~627~~ ~~628~~ ~~629~~ ~~630~~ ~~631~~ ~~632~~ ~~633~~ ~~634~~ ~~635~~ ~~636~~ ~~637~~ ~~638~~ ~~639~~ ~~640~~ ~~641~~ ~~642~~ ~~643~~ ~~644~~ ~~645~~ ~~646~~ ~~647~~ ~~648~~ ~~649~~ ~~650~~ ~~651~~ ~~652~~ ~~653~~ ~~654~~ ~~655~~ ~~656~~ ~~657~~ ~~658~~ ~~659~~ ~~660~~ ~~661~~ ~~662~~ ~~663~~ ~~664~~ ~~665~~ ~~666~~ ~~667~~ ~~668~~ ~~669~~ ~~670~~ ~~671~~ ~~672~~ ~~673~~ ~~674~~ ~~675~~ ~~676~~ ~~677~~ ~~678~~ ~~679~~ ~~680~~ ~~681~~ ~~682~~ ~~683~~ ~~684~~ ~~685~~ ~~686~~ ~~687~~ ~~688~~ ~~689~~ ~~690~~ ~~691~~ ~~692~~ ~~693~~ ~~694~~ ~~695~~ ~~696~~ ~~697~~ ~~698~~ ~~699~~ ~~700~~ ~~701~~ ~~702~~ ~~703~~ ~~704~~ ~~705~~ ~~706~~ ~~707~~ ~~708~~ ~~709~~ ~~710~~ ~~711~~ ~~712~~ ~~713~~ ~~714~~ ~~715~~ ~~716~~ ~~717~~ ~~718~~ ~~719~~ ~~720~~ ~~721~~ ~~722~~ ~~723~~ ~~724~~ ~~725~~ ~~726~~ ~~727~~ ~~728~~ ~~729~~ ~~730~~ ~~731~~ ~~732~~ ~~733~~ ~~734~~ ~~735~~ ~~736~~ ~~737~~ ~~738~~ ~~739~~ ~~740~~ ~~741~~ ~~742~~ ~~743~~ ~~744~~ ~~745~~ ~~746~~ ~~747~~ ~~748~~ ~~749~~ ~~750~~ ~~751~~ ~~752~~ ~~753~~ ~~754~~ ~~755~~ ~~756~~ ~~757~~ ~~758~~ ~~759~~ ~~760~~ ~~761~~ ~~762~~ ~~763~~ ~~764~~ ~~765~~ ~~766~~ ~~767~~ ~~768~~ ~~769~~ ~~770~~ ~~771~~ ~~772~~ ~~773~~ ~~774~~ ~~775~~ ~~776~~ ~~777~~ ~~778~~ ~~779~~ ~~780~~ ~~781~~ ~~782~~ ~~783~~ ~~784~~ ~~785~~ ~~786~~ ~~787~~ ~~788~~ ~~789~~ ~~790~~ ~~791~~ ~~792~~ ~~793~~ ~~794~~ ~~795~~ ~~796~~ ~~797~~ ~~798~~ ~~799~~ ~~800~~ ~~801~~ ~~802~~ ~~803~~ ~~804~~ ~~805~~ ~~806~~ ~~807~~ ~~808~~ ~~809~~ ~~810~~ ~~811~~ ~~812~~ ~~813~~ ~~814~~ ~~815~~ ~~816~~ ~~817~~ ~~818~~ ~~819~~ ~~820~~ ~~821~~ ~~822~~ ~~823~~ ~~824~~ ~~825~~ ~~826~~ ~~827~~ ~~828~~ ~~829~~ ~~830~~ ~~831~~ ~~832~~ ~~833~~ ~~834~~ ~~835~~ ~~836~~ ~~837~~ ~~838~~ ~~839~~ ~~840~~ ~~841~~ ~~842~~ ~~843~~ ~~844~~ ~~845~~ ~~846~~ ~~847~~ ~~848~~ ~~849~~ ~~850~~ ~~851~~ ~~852~~ ~~853~~ ~~854~~ ~~855~~ ~~856~~ ~~857~~ ~~858~~ ~~859~~ ~~860~~ ~~861~~ ~~862~~ ~~863~~ ~~864~~ ~~865~~ ~~866~~ ~~867~~ ~~868~~ ~~869~~ ~~870~~ ~~871~~ ~~872~~ ~~873~~ ~~874~~ ~~875~~ ~~876~~ ~~877~~ ~~878~~ ~~879~~ ~~880~~ ~~881~~ ~~882~~ ~~883~~ ~~884~~ ~~885~~ ~~886~~ ~~887~~ ~~888~~ ~~889~~ ~~890~~ ~~891~~ ~~892~~ ~~893~~ ~~894~~ ~~895~~ ~~896~~ ~~897~~ ~~898~~ ~~899~~ ~~900~~ ~~901~~ ~~902~~ ~~903~~ ~~904~~ ~~905~~ ~~906~~ ~~907~~ ~~908~~ ~~909~~ ~~910~~ ~~911~~ ~~912~~ ~~913~~ ~~914~~ ~~915~~ ~~916~~ ~~917~~ ~~918~~ ~~919~~ ~~920~~ ~~921~~ ~~922~~ ~~923~~ ~~924~~ ~~925~~ ~~926~~ ~~927~~ ~~928~~ ~~929~~ ~~930~~ ~~931~~ ~~932~~ ~~933~~ ~~934~~ ~~935~~ ~~936~~ ~~937~~ ~~938~~ ~~939~~ ~~940~~ ~~941~~ ~~942~~ ~~943~~ ~~944~~ ~~945~~ ~~946~~ ~~947~~ ~~948~~ ~~949~~ ~~950~~ ~~951~~ ~~952~~ ~~953~~ ~~954~~ ~~955~~ ~~956~~ ~~957~~ ~~958~~ ~~959~~ ~~960~~ ~~961~~ ~~962~~ ~~963~~ ~~964~~ ~~965~~ ~~966~~ ~~967~~ ~~968~~ ~~969~~ ~~970~~ ~~971~~ ~~972~~ ~~973~~ ~~974~~ ~~975~~ ~~976~~ ~~977~~ ~~978~~ ~~979~~ ~~980~~ ~~981~~ ~~982~~ ~~983~~ ~~984~~ ~~985~~ ~~986~~ ~~987~~ ~~988~~ ~~989~~ ~~990~~ ~~991~~ ~~992~~ ~~993~~ ~~994~~ ~~995~~ ~~996~~ ~~997~~ ~~998~~ ~~999~~ ~~1000~~ ~~1001~~ ~~1002~~ ~~1003~~ ~~1004~~ ~~1005~~ ~~1006~~ ~~1007~~ ~~1008~~ ~~1009~~ ~~1010~~ ~~1011~~ ~~1012~~ ~~1013~~ ~~1014~~ ~~1015~~ ~~1016~~ ~~1017~~ ~~1018~~ ~~1019~~ ~~1020~~ ~~1021~~ ~~1022~~ ~~1023~~ ~~1024~~ ~~1025~~ ~~1026~~ ~~1027~~ ~~1028~~ ~~1029~~ ~~1030~~ ~~1031~~ ~~1032~~ ~~1033~~ ~~1034~~ ~~1035~~ ~~1036~~ ~~1037~~ ~~1038~~ ~~1039~~ ~~1040~~ ~~1041~~ ~~1042~~ ~~1043~~ ~~1044~~ ~~1045~~ ~~1046~~ ~~1047~~ ~~1048~~ ~~1049~~ ~~1050~~ ~~1051~~ ~~1052~~ ~~1053~~ ~~1054~~ ~~1055~~ ~~1056~~ ~~1057~~ ~~1058~~ ~~1059~~ ~~1060~~ ~~1061~~ ~~1062~~ ~~1063~~ ~~1064~~ ~~1065~~ ~~1066~~ ~~1067~~ ~~1068~~ ~~1069~~ ~~1070~~ ~~1071~~ ~~1072~~ ~~1073~~ ~~1074~~ ~~1075~~ ~~1076~~ ~~1077~~ ~~1078~~ ~~1079~~ ~~1080~~ ~~1081~~ ~~1082~~ ~~1083~~ ~~1084~~ ~~1085~~ ~~1086~~ ~~1087~~ ~~1088~~ ~~1089~~ ~~1090~~ ~~1091~~ ~~1092~~ ~~1093~~ ~~1094~~ ~~1095~~ ~~1096~~ ~~1097~~ ~~1098~~ ~~1099~~ ~~1100~~ ~~1101~~ ~~1102~~ ~~1103~~ ~~1104~~ ~~1105~~ ~~1106~~ ~~1107~~ ~~1108~~ ~~1109~~ ~~1110~~ ~~1111~~ ~~1112~~ ~~1113~~ ~~1114~~ ~~1115~~ ~~1116~~ ~~1117~~ ~~1118~~ ~~1119~~ ~~1120~~ ~~1121~~ ~~1122~~ ~~1123~~ ~~1124~~ ~~1125~~ ~~1126~~ ~~1127~~ ~~1128~~ ~~1129~~ ~~1130~~ ~~1131~~ ~~1132~~ ~~1133~~ ~~1134~~ ~~1135~~ ~~1136~~ ~~1137~~ ~~1138~~ ~~1139~~ ~~1140~~ ~~1141~~ ~~1142~~ ~~1143~~ ~~1144~~ ~~1145~~ ~~1146~~ ~~1147~~ ~~1148~~ ~~1149~~ ~~1150~~ ~~1151~~ ~~1152~~ ~~1153~~ ~~1154~~ ~~1155~~ ~~1156~~ ~~1157~~ ~~1158~~ ~~1159~~ ~~1160~~ ~~1161~~ ~~1162~~ ~~1163~~ ~~1164~~ ~~1165~~ ~~1166~~ ~~1167~~ ~~1168~~ ~~1169~~ ~~1170~~ ~~1171~~ ~~1172~~ ~~1173~~ ~~1174~~ ~~1175~~ ~~1176~~ ~~1177~~ ~~1178~~ ~~1179~~ ~~1180~~ ~~1181~~ ~~1182~~ ~~1183~~ ~~1184~~ ~~1185~~ ~~1186~~ ~~1187~~ ~~1188~~ ~~1189~~ ~~1190~~ ~~1191~~ ~~1192~~ ~~1193~~ ~~1194~~ ~~1195~~ ~~1196~~ ~~1197~~ ~~1198~~ ~~1199~~ ~~1200~~ ~~1201~~ ~~1202~~ ~~1203~~ ~~1204~~ ~~1205~~ ~~1206~~ ~~1207~~ ~~1208~~ ~~1209~~ ~~1210~~ ~~1211~~ ~~1212~~ ~~1213~~ ~~1214~~ ~~1215~~ ~~1216~~ ~~1217~~ ~~1218~~ ~~1219~~ ~~1220~~ ~~1221~~ ~~1222~~ ~~1223~~ ~~1224~~ ~~1225~~ ~~1226~~ ~~1227~~ ~~1228~~ ~~1229~~ ~~1230~~ ~~1231~~ ~~1232~~ ~~1233~~ ~~1234~~ ~~1235~~ ~~1236~~ ~~1237~~ ~~1238~~ ~~1239~~ ~~1240~~ ~~1241~~ ~~1242~~ ~~1243~~ ~~1244~~ ~~1245~~ ~~1246~~ ~~1247~~ ~~1248~~ ~~1249~~ ~~1250~~ ~~1251~~ ~~1252~~ ~~1253~~ ~~1254~~ ~~1255~~ ~~1256~~ ~~1257~~ ~~1258~~ ~~1259~~ ~~1260~~ ~~1261~~ ~~1262~~ ~~1263~~ ~~1264~~ ~~1265~~ ~~1266~~ ~~1267~~ ~~1268~~ ~~1269~~ ~~1270~~ ~~1271~~ ~~1272~~ ~~1273~~ ~~1274~~ ~~1275~~ ~~1276~~ ~~1277~~ ~~1278~~ ~~1279~~ ~~1280~~ ~~1281~~ ~~1282~~ ~~1283~~ ~~1284~~ ~~1285~~ ~~1286~~ ~~1287~~ ~~1288~~ ~~1289~~ ~~1290~~ ~~1291~~ ~~1292~~ ~~1293~~ ~~1294~~ ~~1295~~ ~~1296~~ ~~1297~~ ~~1298~~ ~~1299~~ ~~1300~~ ~~1301~~ ~~1302~~ ~~1303~~ ~~1304~~ ~~1305~~ ~~1306~~ ~~1~~

FEDERAL ROAD REGION NO.	DIVISION	PROJ. NO.	SHEET NO.	TOTAL SHEETS
VIII	COLORADO	RS 0014(4)	2	

AS CONSTRUCTED
NO REVISIONS DATE 11 OCT 74

TYPICAL SECTION A
 Sta. 103+00 To Sta. 230+00

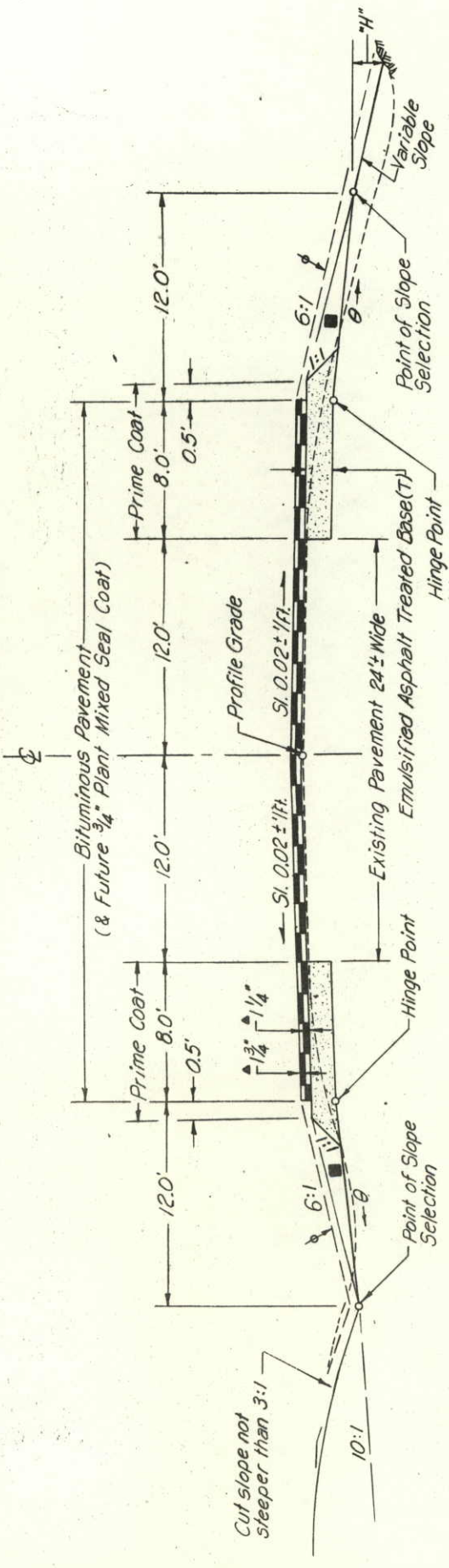

NOTE: See Standards for details of cut slope treatment, flaring and widening.
 Excavation below 6:1 slope and/or 10:1 slope will not be permitted.
 The depth and width of the side ditch shall be varied where necessary in order to provide proper drainage.
 Break points on slopes and in bottoms of ditches shall be rounded on construction for a pleasing appearance.

TYPICAL SECTION B
 Sta. 96+ To Sta. 108+00

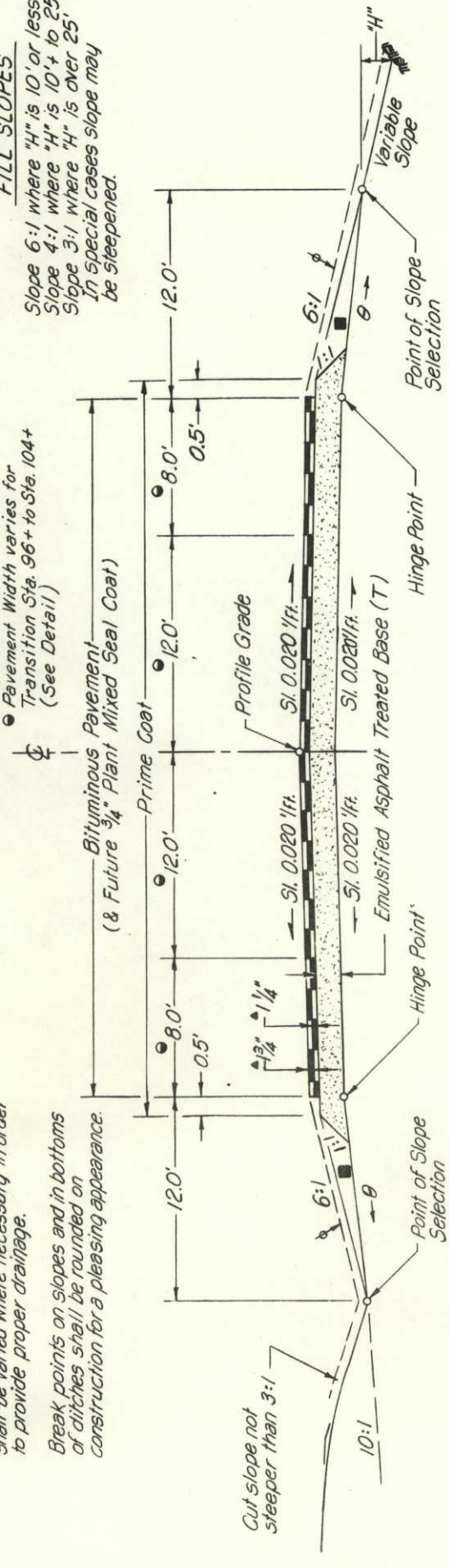

FILL SLOPES
 Slope 6:1 where "H" is 10' or less
 Slope 4:1 where "H" is 10' to 25'
 Slope 3:1 where "H" is over 25'.
 In special cases slope may be steepened.

θ Subgrade slope to vary with depth of treated base.

Slope Table

T (in.)	θ ft./ft.
3	0.125
5	0.111
6	0.104
8	0.090

Material shall be placed in separate courses at the following rates per 100 lin.ft. of roadway:

	Section A	Section B
Bituminous Pavement	Top Layer ... 42 tons	42 tons
Bottom Layer	... 30 tons	30 tons

Rate for Emulsified Asphalt Treated Base Cl. 7, Based on 101.6 lb./yd.²/in.

FEDERAL ROAD REGION NO.	DIVISION	PROJ. NO.	SHEET NO.	TOTAL SHEETS
VII	COLORADO	RS 0014(4)	3	

GENERAL NOTES
AS CONSTRUCTED
REVISED DATE 11 OCT 74

FINAL SUMMARY OF EARTHWORK QUANTITIES

INDEX	BOOK PAGE SHEET
Form 305	305
Form 305	305
Form 305	305
Form 305	305
Form 305	305
Form 75	75

UNCLASSIFIED EXCAVATION
 * ROADWAY (FROM ELECTRONIC COMPUTER) (RUN No. 2) 6,491.00
 STRUCTURE QUANTITIES AS EXCAV. 190
 STRUCTURE QUANTITIES AS DITCH 22
 EST. FOR CUT SLOPE TREATMENT 30
 TOTAL FOR PAY QUANTITY 6,491.00

* INCLUDES TRANSITION STA. 96+ & WIDENED CUT STA. 175+ RT.

BORROW
 FOR ROADWAY EMBANKMENT 10,461.00
 FOR SHOULDER FINISHING 27,730.00
 STRUCTURE QUANTITIES AS EMB. 948
 TOTAL FOR PAY QUANTITY 387.00
 REMOVING OVERBURDEN 4,440
 REPLACING OVERBURDEN 4,440

STRIPPING
 TOTAL FOR PAY QUANTITY 10,461.00
 REMOVING OVERBURDEN 387.00
 REPLACING OVERBURDEN 249.00

EMPAVEMENT (NET)
 BASE OF CUTS AND FILLS 10,954.00
 STRUCTURE QUANTITIES AS EMB. (NET) 11,186.00
 TOTAL FOR PAY QUANTITY 636.00

CONPACTION (ASPH. 1.80)
 (MOISTURE AND DENSITY CONTROL)
 EMBANKMENT (NET) 7781
 BASE OF CUTS AND FILLS 14144
 STRUCTURE QUANTITIES AS EMB. (NET) 428
 TOTAL FOR PAY QUANTITY 22,730.00

HAUL
 FROM MASS DIAGRAM (Elec. Comp.) (RUN No. 4) 13,428.00
 EST. FOR SHOULDER FINISHING 446
 EST. FOR STRUCTURE QUANTITIES AS EMB. 2000
 TOTAL FOR PAY QUANTITY 13,428.00

ROADWAY QUANTITIES BALANCE [FOR INFORMATION ONLY]
 EXCAVATION UNCLASSIFIED 6,491.00
 BORROW 10,461.00
 TOTAL 16,952.00
 EMBANKMENT NET 10,954.00
 (ROADWAY FROM ELECTRONIC COMPUTER) (RUN No. 2) 590.00
 STRUCTURE QUANTITY AS EMB. 11,544.00

EMBANKMENT X 1.44 1,448.46
 (ROADWAY FROM ELECTRONIC COMPUTER) 16,952.00

COMPACTON H.B.P. (WATER-LIME MIXTURE) 354.00 M-GAL.
 TOTAL FOR PAY QUANTITY 132.00 M-GAL.
 486.00 M-GAL.

FOR PRELIMINARY PLAN QUANTITIES OF BITUMINOUS MATERIALS THE FOLLOWING RATES OF APPLICATION WERE USED:

PRIME COAT LIQUID ASPHALTIC MATERIAL (MC-70) 0.152 GALS. PER SQ. YD.
 TACK COAT DILUTED ENUL. ASPH. (CSS-1) 0.10 GALS. PER SQ. YD.
 0.05

DILUTED EMULSIFIED ASPHALT FOR TACK COAT SHALL CONSIST OF 1 PART EMULSIFIED ASPHALT AND 1 PART WATER.

RATES OF APPLICATION SHALL BE AS DETERMINED BY THE ENGINEER AT THE TIME OF APPLICATION.

WATER SHALL BE USED AS A DUST PALLIATIVE WHERE REQUIRED. LOCATIONS SHALL BE AS ORDERED.

ANY LAYER OF BITUMINOUS PAVEMENT THAT IS TO HAVE A SUCCEEDING LAYER PLACED THEREON SHALL BE COMPLETED FULL WIDTH BEFORE SUCCEEDING LAYER IS PLACED.

THE FOLLOWING SHALL BE FURNISHED WITH EACH BITUMINOUS PAYER.

1. A SKI TYPE DEVICE AT LEAST 30 FEET IN LENGTH.
2. SHORT SKI OR SHOE.

ROAD APPROACHES WHICH REQUIRE BITUMINOUS PAVEMENT SHALL BE PRIMED AND A 2" THICKNESS OF PAVEMENT PLACED AS FOLLOWS:

PUBLIC APPROACHES AND ENTRANCES TO BUILDINGS OR RESIDENCES SHALL BE PAVED 50 FT. OUT FROM EDGE OF SHOULDER OR TO THE RIGHT OF WAY LINE WHICHEVER IS LESS. FIELD ENTRANCES SHALL BE PAVED 4 FT. OUT FROM EDGE OF SHOULDER.

DEPTH OF MOISTURE-DENSITY CONTROL FOR THIS PROJECT SHALL BE AS FOLLOWS:

- FULL DEPTH OF ALL EMBANKMENTS.
- BASES OF CUTS 1/2 FOOT.
- BASES OF FILLS 1/2 FOOT.

EXCAVATION REQUIRED FOR COMPACTION OF BASES OF CUTS AND FILLS WILL BE CONSIDERED AS SUBSIDIARY TO THAT OPERATION AND WILL NOT BE PAID FOR SEPARATELY.

THE MINIMUM THICKNESS OF TOPSOIL SHALL BE 4 INCHES. IT IS ESTIMATED 5,700 CU. YDS. WILL BE REQUIRED AND WILL BE OBTAINED FROM DOLLERSCHWELL PIT.

EARTH SLOPES SHALL BE DISCED OR ROUGHENED BY OTHER APPROVED METHODS FOR MULCHING OR EROSION PROTECTION.

SEEDING OF SLOPES WILL BE DONE BY STATE FORCES.

GUARD POSTS AND DELINEATORS WILL BE REMOVED BY STATE FORCES.

IT IS ESTIMATED THAT 1400 HOURS OF FLAGGING FOR CONTROLLING TRAFFIC WILL BE REQUIRED FOR THIS PROJECT.

THE CONTRACTOR SHALL PROVIDE ON-THE-JOB TRAINING AIMED AT DEVELOPING FULL JOURNEYMAN IN THE TYPE OF TRADE INVOLVED. THE NUMBER OF TRAINEES TO BE TRAINED UNDER THIS CONTRACT WILL BE 1.

INCLUDED IN ROADWAY QUANTITIES

FINAL SUMMARY OF APPROXIMATE QUANTITIES

AS CONSTRUCTED
REVISED DATE 11 OCT 74

FEDERAL ROAD DISTRICT NO. VIII
DIVISION COLORADO
PROJ. NO. RS 0014 (4)
SHEET NO. 4
TOTAL SHEETS

INDEX	CONTRACT ITEM NO.	CONTRACT ITEM	UNIT							PROJECT TOTALS	FINAL PROJECT TOTALS	OVERRUN UNDERWR
Form 305	202	Removal of Structure	Each							11	15	4
Form 305	202	Removal of Fence	Lin. Ft.							500	458.00	42.00
Plan's 3	203	Unclassified Excavation	Cu. Yd.							7,000	6,491.00	509.00
Plan's 3	203	Borrow	Cu. Yd.							9,000	10,461.00	1,461.00
Plan's 3	203	Stripping	Cu. Yd.							2,900	636.00	2,246.00
Plan's 3	203	Compaction (AASHTO T 180)	Cu. Yd.							24,000	22,730.00	1,270.00
Plan's 3	204	Haul	Yd. Mi.							14,400	13,428.00	972.00
Form 100	204	Haul	Ton Mi.							81,800	83,121.00	1,321.00
Form 305	206	Structure Excavation	Cu. Yd.							470	430.00	40.00
Form 305	206	Structure Backfill (Class 2)	Cu. Yd.							210	205.00	5.00
Plan's 17	207	Topsoil (Haul)	Cu. Yd.							5,700	3,109.00	2,591.00
Form 7s	209	Wetting	M Gal.							590	486.00	104.00
Form 305	210	Reset Mailbox Structure	Each							26	27	1
Form 305	210	Relay Pipe (24 Inch)	Lin. Ft.							216	180.00	36.00
Form 87s	303	Emulsified Asphalt Treated Base (Class 7)	Ton							11,400	11,434.30	34.30
Form 87s	403	Hot Bituminous Pavement (Grading F) (Hydrated Lime)	Ton							10,700	10,455.75	244.25
Form 49s	411	Asphalt Cement (MC-57) (AC-10)	Ton							720	738.57	18.57
Form 49	411	Emulsified Asphalt (CSS-1)	Gal.							111,100	101,406.00	9,694.00
Form 49	411	Liquid Asphaltic Material (MC-70)	Gal.							7,500	5,730.00	1,770.00

FINAL SUMMARY OF APPROXIMATE QUANTITIES

AS CONSTRUCTED
REVISED DATE 11 OCT 74

FEDERAL AID DISTRICT NO.	DIVISION	PROJ. NO.	SHEET NO.	TOTAL SHEETS
VIII	COLORADO	RS 0014 (4)	5	

INDEX	CONTRACT ITEM NO.	CONTRACT ITEM	UNIT							PROJECT TOTALS	FINAL PROJECT TOTALS	OVERRUN	UNDERRUN
Form 305	603	18 Inch Corrugated Steel Pipe	Lin. Ft.							506	524	18.00	-
Form 305	603	24 Inch Corrugated Steel Pipe	Lin. Ft.							20	20	-	-
Form 305	603	36 Inch Corrugated Steel Pipe	Lin. Ft.							84	78	-	6.00
Form 305	603	18 Inch Steel End Section	Each							36	46	-	-
Form 305	603	24 Inch Steel End Section	Each							14	14	-	-
Form 305	603	36 Inch Steel End Section	Each							2	2	-	-
Form 305	607	Corner and Line Brace Post	Each							2	2	-	-
Form 305	607	Fence Barbed Wire with Metal Posts	Lin. Ft.							500	456	-	44.00
Form 305	612	Delineator (Type II)	Each							8	8	-	-
Form 7's	614	Flagging	Hour							1,500	1,146	-	354.00
Form 305	620	Field Laboratory	Each							1	1	-	-
Form 305	620	Sanitary Facility	Each							1	1	-	-
Form 305	626	Mobilization	Lump Sum							1	1	-	-
W.O.# 04757		<u>FORCE ACCOUNT</u> On - The - Job Trainee	Each							1	1	-	-
		<u>STATE FORCES</u> Seeding	Lump Sum							1			
		<u>UTILITIES</u> Relocate Power Poles (Work by Highline Electric Assoc. Forces)	Lump Sum							1	1	-	-
Form 305		<u>NON-FEDERAL AID</u> Signing and Striping (State Forces)	Lump Sum							1	1	-	-

FINAL STRUCTURE QUANTITIES

AS CONSTRUCTED
REVISED DATE 11 OCT 74

MISCELLANEOUS

INDEX	BOOK PAGE SHEET	LOCATION	UNCLASSIFIED EXCAVATION		STRUCTURE EXCAVATION	STRUCTURE BACKFILL	REMOVAL OF STRUCTURE	HOT BITUMINOUS PAVERMENT (GRADING F.)	EMULSIFIED ASPHALT TREATED BASE	RELAY PIPE		CORRUGATED STEEL PIPE			"H" OVER CULV. FT.	STEEL END SECTION EACH			
			EXCAV. CUBIC YARD	EMB. DITCH						CUBIC YARD	CUBIC YARD	CL. 2	CL. 1	CL. 7		TON	TON	TON	TON
Form 305		96+ to 104+	Δ						*										
↑		96+41						27	58										
		98+09						7	15										
		100+80			24	8	1	8	18		42			4		2			
		101+93			31	21		9	20		70	8		2		2			
		102+95			24	8	1	9	20		42			4		2			
		104+54						9	20										
		104+62			1	1		2	18										
		106+85						2	18										
		109+12						8	18										
		110+52						8	18										
		113+30						28	70										
		114+00						29	71										
		116+50		Δ-5	3	3		33	70										
		117+50						10	70										
		118+00						10	71										
		119+09						10	45										
		121+45		Δ-5	3	3		22	45			4	1						
		125+73	Δ+0					2	15										
		127+40	Δ+0					9	20										
		128+22	Δ+0					9	20										
		131+50	Δ+0					13	31										
		133+92			58	23		7	15		84		4						
		136+00		10				7	15										
		136+22		10				7	15										
		141+75	Δ+0					8	18										
		142+78	Δ+0					9	20										
		145+32	Δ+0					9	20										
		149+62		20				9	20										
		151+95			35	4		9	20										
		158+96	Δ+0		4	4		7	15										
		161+95	Δ+0		4	3		2	15										
↑		162+88		10				2	15										
Form 305		163+15		10				11	24										

Δ Quantities included in Earthwork Summary.
* Quantities included in Surfacing Plan.

FINAL

STRUCTURE QUANTITIES

AS CONSTRUCTED
 REVISED DATE 11 OCT 74

INDEX BOOK PAGE SHEET	LOCATION	UNCLASSIFIED EXCAVATION CUBIC YARD		REMOVAL OF STRUCTURE EACH	HOT BITUMINOUS PAVEMENT (GRADING F.) TON	EMULSIFIED ASPHALT TREATED BASE (CL. 7) TON	CORRUGATED STEEL PIPE LIN. FT.			"H" OVER CULV. FT.	STEEL END SECTION EACH		MISCELLANEOUS
		EXCAV.	DITCH				RELAY PIPE LIN. FT.	24"	18"		18"	24"	
Form 305 ↑	211+48	10			8	18				2	2		
	212+42	10		1	5	18				2	2		
	213+00	10			5	20				2	2		
	214+34	10			7	15				2	2		
	214+67	10			9	20				2	2		
	217+15	10			8	18				2	2		
	218+57	10			7	15				2	2		
	220+24	10			9	20							
	221+63	10			8	18							
	222+00	10			7	15							
223+00	10				11	24							
225+26	10				9	20							
226+11	10				11	24				2			
226+92	10				8	18							
229+22	10				8	18							
Form 305 ↑	230+00-233+00	675	25		*	*							
	Entire Project	170	590	115	729	1664	216	596	20	84	36	14	2
	TOTAL	170	590	115	729	1664	216	596	20	84	36	14	2

27
~~26~~-Reset Manhole Structure

Δ Quantities included in Earthwork Summary.
 * Quantities included in Surfacing Plan.

AS CONSTRUCTED
REVISED DATE 11 OCT 74

FEDERAL ROAD DISTRICT NO.	DIVISION	PROJ. NO.	SHEET NO.	TOTAL SHEETS
III	COLORADO	RS 0014(4)	9	

SURFACING PLAN

STATION	Source Thick.	QUANTITY - TONS				HAUL - TON MILE			
		Base Course		Hot Bituminous Pavement		Base Course		Hot Bituminous Pavement	
		EATB Cl. 7	Final Totals	Bottom Layer Gr. F	Top Layer Gr. F	Final Totals	Bottom Layer	Top Layer	Final Totals
<u>Main Line</u>									
96+44.3 ~ 104+00 (Transition)	3	753	907.60	325	455	3,728	4,545.22	1,609	4,114.00
104+00 ~ 105+00	3	75	58.50	30	42	356	288.22	146	205
105+00 ~ 108+00	5	364	362.75	90	126	1,759	1,773.49	435	609
108+00 ~ 124+00	5	813	1,000.25	480	672	3,782	4,710.27	2,233	3,126
124+00 ~ 145+00	3	640	934.80	630	882	2,753	4,074.52	2,710	3,794
145+00 ~ 172+00	5	1,372	1,784.20	810	1,154	5,278	6,965.80	3,116	4,562
172+00 ~ 220+00	8	3,902	4,219.00	1,440	2,016	12,239	13,475.19	4,577	6,323
220+00 ~ 230+00	6	610	860.25	300	420	1,578	2,275.09	777	1,087
104+00 ~ 230+00									31,973.00
Approach to Project		91		90		210		209	107.64
Structure Quantities		1,661	1,306.95	729		6,106	4,849.39	4,680	3,969.85
Estimated for Correcting Irregularities		1,028				3,779			
TOTALS		11,307	11,434.30	4,924	15,747	41,568	42,957.19	18,432	40,164.49

▶ Included in Roadway Quantities

See Greeley Form 100

Note: Stabilization Based on

- 1. E. D. L. A. 18K 81
- 2. Regional Factor 1.25
- 3. Serviceability Index 2.5
- 4. Hot Bituminous Pavement 0.35 (R₁ = 28)
- 5. Emulsified Asphalt Treated Base 0.25 (R₁ = 101)
- 6. Future Seal Coat 0.25
- 7. Borrow R Value 66 to 74

AS CONSTRUCTED
REVISED DATE 11 OCT 74

FEDERAL ROAD REGION NO.	DIVISION	PROJ. NO.	SHEET NO.	TOTAL SHEETS
XIII	COLORADO	RS 0014 (4)	10	

CITY OF STERLING PIT

Owner: City of Sterling, 214 Poplar St., Sterling, Colorado of Logan County Colorado.
 Location: S.E. 1/4 Sec. 35, T. 8 N., R. 53 W.
 Use: Borrow
 Quantity Available: 24,500 Cu. Yds.
 Stripping: Removing Overburden 500 Cu. Yds. Replacing Overburden 500 Cu. Yds.
 Haul Distance: 0.8 miles to Sta. 96 +

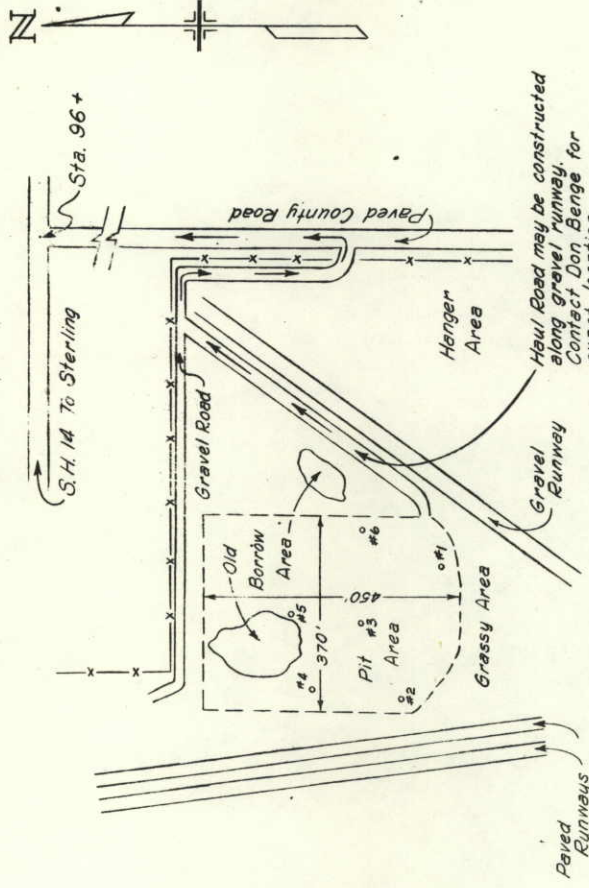

NOTE: Sketch not drawn to scale. Distances are approximate only.

LOG OF TEST HOLE
 Sample No. 1696

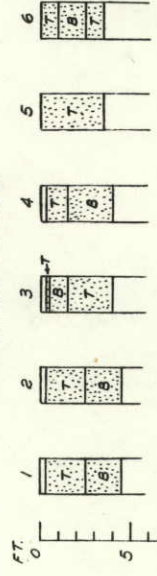

LEGEND

- Weeds
- Tan Clean Sand
- Brown Sand

Water Table unknown as of Mar. 5, 1974

DOLLERSCHHELL PIT

Owner: Agnes Dollerschell % H.L. Graves, 1138 Beattie Dr., Sterling, Colorado 80751 of Logan County Colorado.
 Location: N.W. 1/4 Sec. 21, T. 8 N., R. 53 W.
 Use: Aggregate for Hot Bituminous Pavement and Emulsified Asphalt Treated Base & Topsoil
 Quantity Available: 33,000 Cu. Yds.
 Stripping: Removing Overburden 950 Cu. Yds. Replacing Overburden 950 Cu. Yds.
 Haul Distance: 2.55 miles to Sta. 230 +

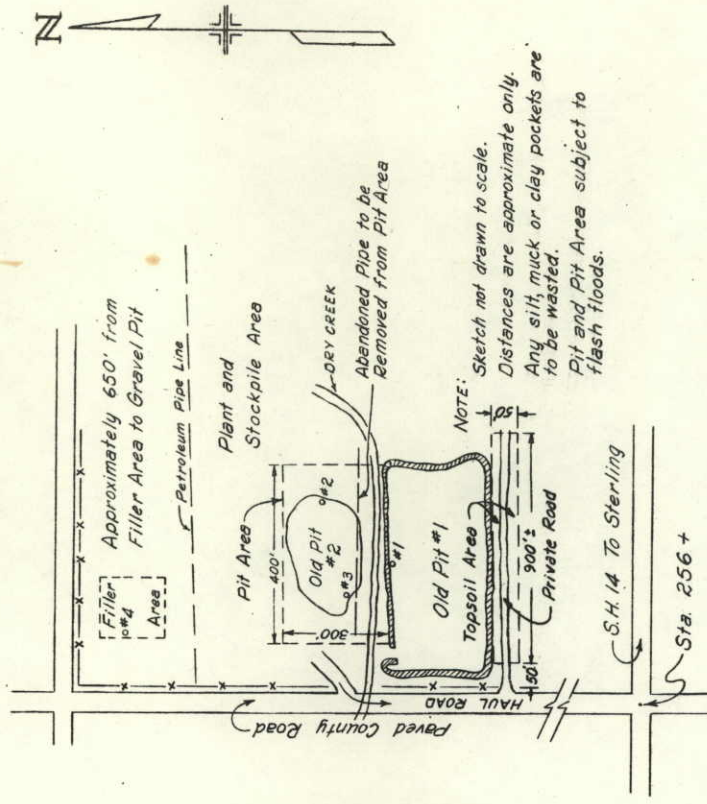

NOTE: Sketch not drawn to scale. Distances are approximate only. Any silt, muck or clay pockets are to be wasted. Pit and Pit Area subject to flash floods.

LOG OF TEST HOLE
 Sample No. 1695

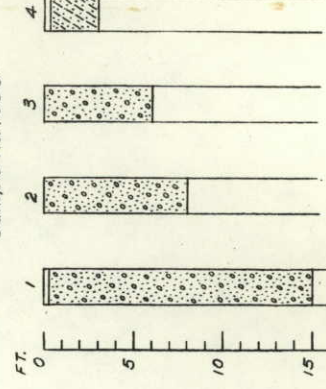

LEGEND

- Sod
- Sand & Gravel
- Filler (Silty Sand)

Water Table unknown as of Feb. 9, 1974

AS CONSTRUCTED
REVISED DATE 11 OCT 74

FEDERAL ROAD DISTRICT NO.	DIVISION	PROJ. NO.	SHEET NO.	TOTAL SHEETS
VII	COLORADO	ES 0014(4)	11	

FENCING

LOCATION STA. TO STA.	SIDE	REMOVAL OF FENCE LIN. FT.	FENCE BARBED WIRE WITH METAL POSTS LIN. FT.
172+00 176+20	RT.	400-458	420-456
TOTALS		420-458	400-456

DELINEATORS

STATION	SIDE	SPACING	TYPE EACH
96+00 TO 104+00 (TRANSITION)	RT.	200'	5
96+40 (TRANSITION) - 100+00	RT.	200'	5
100+00 TO 104+00 (TRANSITION)	LT.	200'	3
TOTAL			8

IT IS ESTIMATED THERE WILL BE 2 CORNER AND LINE BRACE POSTS REQUIRED FOR THIS PROJECT.

DETAIL OF TRANSITION STA. 96+00 TO STA. 104+00

