

# COLORADO STATE HIGHWAY DEPARTMENT

## PLAN AND PROFILE OF PROPOSED STATE PROJECT NO. 721 (1938) STATE HIGHWAY NO. 105 DOUGLAS COUNTY

### CONVENTIONAL SIGNS

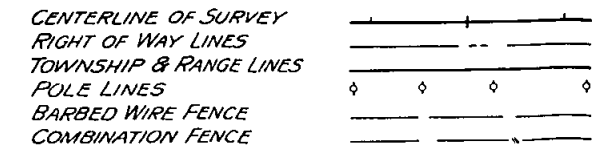

### INDEX OF SHEETS

SHEET NO.	1	TITLE SHEET TYPICAL SECTION AND SUMMARY
"	2	DETAILS OF BRIDGE STA 4+
"	3	STANDARD TIMBER GUARD POSTS.....M19A
"	4	" MARKER POSTS.....M24F
"	5	" STRUCTURE NUMBER LETTERING.....M10A
"	6	" METHODS FOR SUPERELEVATION AND WIDENING OF CURVES.....M1B
"	7	TYPICAL SIDE APPROACH ROADS/TRAFFIC SIGNS.....M2B
"	8	PLAN AND PROFILE
"	9-12	CROSS SECTIONS

### SUMMARY OF APPROXIMATE QUANTITIES

No	ITEM	UNIT	ROADWAY	BRIDGE STA 4+
10a	Clearing and Grubbing Entire Project	Lp Sm		
12D	Removing & Rebuilding Fence	Lin Ft	2450	
13C	Unclassified Excavation	Cu Yd	4500	
14a	Dry Rock Excavation (Structural)	"		5
14b	Dry Common	"		100
14c	Wet Rock	"		5
14d	Wet Common	"		5
18a	Station yard Overhaul	Sq Yd	1000	
42a	Untreated Bridge Timber	M Ft Dm		19
42b	Treated Bridge Timber	M Ft Dm		40.8
43	Asphalt Plank Wearing Surface	Sq Ft		2300
53D	18" Corrugated Metal Culvert Pipe	Lin Ft	40	
60a	Treated Timber Piling	"		1352
60e	Metal Pile Shoes	Each		52
74x	Timber Guard Posts	"	20	
81d	Right of Way Markers	"	8	
89D	Drain Pipe (Timber Floor)	"		8

### TYPICAL SECTION

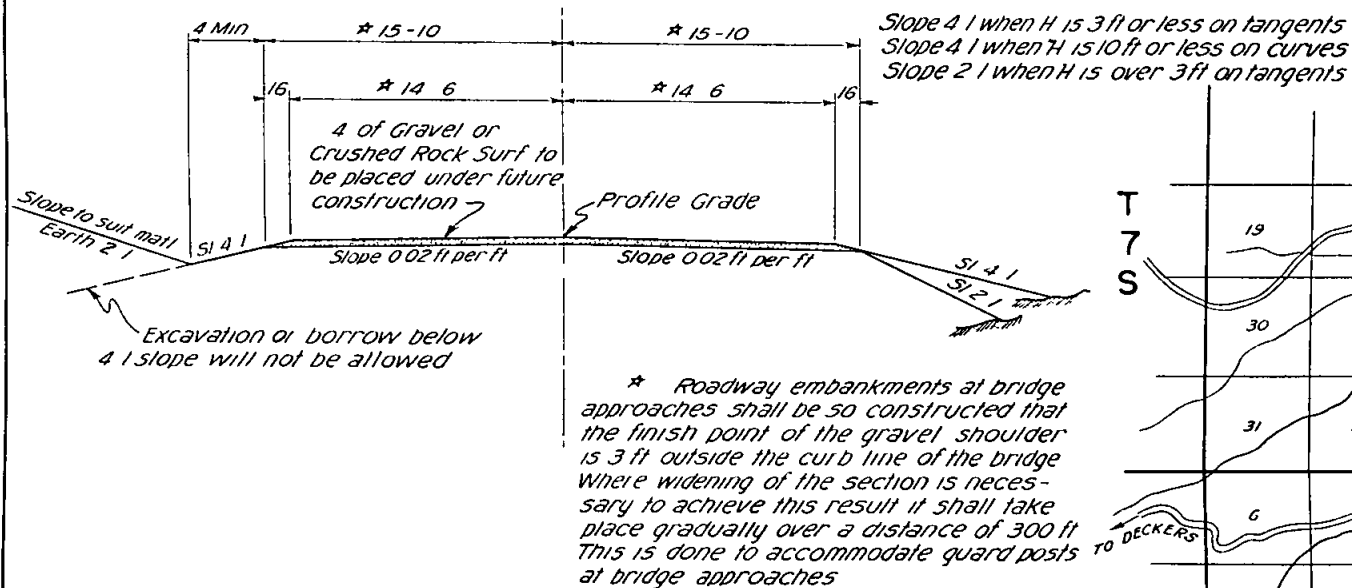

### GENERAL NOTES

This Project is to be constructed in conformity with the Standard Specifications of the Colorado State Highway Department, adopted June 1, 1937.

All quantities on the preliminary plans are to be considered approximate only.

All roadway excavation required to construct the Project is to be obtained as indicated on the plans. Quantities involved beyond the limits of the ditch as shown are to be classified and paid for as "Unclassified Excavation". These quantities are to be staked as part of the original excavation at locations indicated on the plans. Slope stakes beyond the limits of the Typical Section as shown are subject to change by the Engineer to fit embankment conditions actually encountered during construction.

The entire Project is to be cleared for the full width of the right of way and the cost thereof included in the lump sum price bid for Clearing and Grubbing the entire Project.

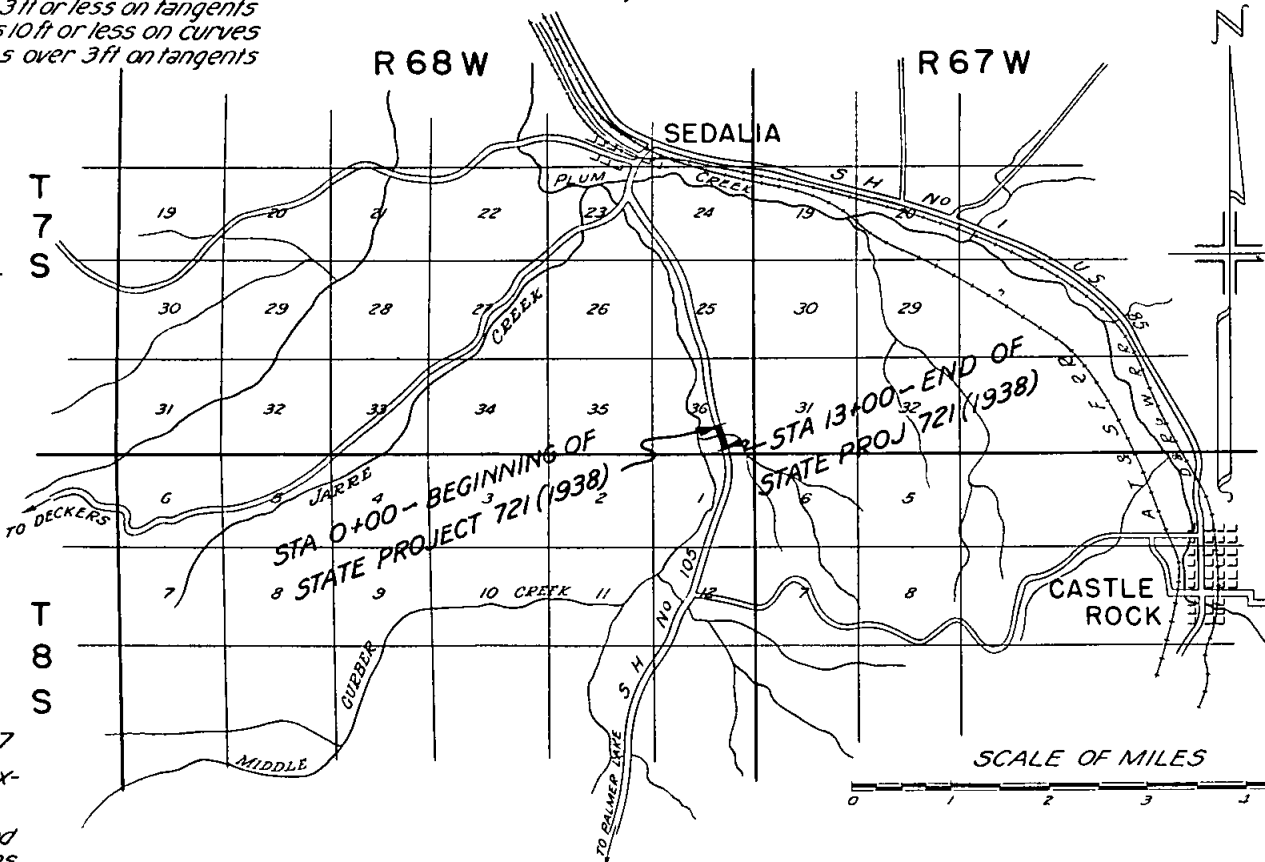

**SCALES OF ORIGINAL TRACINGS**  
 ON PLAN 1 IN = 50 FT  
 ON PROFILE 1 IN = 50 FT HORIZONTAL  
 1 IN = 10 FT VERTICAL  
 GRADE LINE ON PROFILE IS SHOWN AS GRADE OF FINISHED ROAD  
 GROSS LENGTH OF PROJECT } 1300 FT = 0.246 MI  
 NET LENGTH OF PROJECT }



- NOTE -

It is recommended that bidders on this Project go over the plan details with one of the following field representatives of this Department:

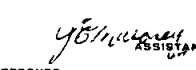
Ernest Montgomery	Division Engineer	Colorado Springs
V. H. Littlefield	Resident Engineer	Colorado Springs

RECOMMENDED FOR APPROVAL  
  
 ASSISTANT  
 APPROVED  
  
 STATE HIGHWAY

All pole lines encroaching on the Project are to be moved by owners

FED ROAD DIST NO	STATE	STATE PROJ NO	SHEET NO	TOTAL SHEETS
3	COLO	721 (1938)	8	

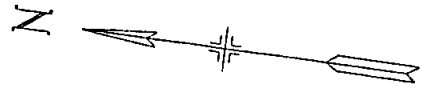

4+24 to 5+175 - Reqd Bridge as per details on Sheet NO 2 (Present bridge to be removed by County forces)

5+95 - Reqd 200 cu yds Embankment for Road Approach on right

11+00 - Reqd 250 cu yds Uncl Excav for Road Approach on left & 18'x40 C.M.P. Side Drain

Δ 16°31' Lt  
D 2°00'  
R 4158  
L 28650  
L 8258

STA 0+00 - BEGINNING OF STATE PROJECT NO 721 (1938)

0+00 - Reqd 4 Right of Way Markers Lt & Rt

3+60 to 5+815 - Reqd 20 Timber Guard Posts

0+00 to 13+00 - Remove and rebuild 2450 lin ft of Fence Lt & Rt

SE 1/4 Sec 36 T 75 R 68 W

STRUCTURE NOTES FOR BRIDGE - STA 4+24 to 5+175  
STRUCTURE NO G-17-AL

PRESENT STRUCTURE	PROPOSED STRUCTURE
SPAN 4 @ 20	SPAN 4 @ 23 STD P 116BH
CLEAR ROADWAY 15	CLEAR ROADWAY 25'
CLEAR WATERWAY 480'	CLEAR WATERWAY 670'
TYPE OF SUPERSTRUCTURE: TIMBER TRESTLE	TREATED TIMBER TRESTLE
SUBSTRUCTURE: PILES	TREATED PILES
REMOVE THIS STRUCTURE	RR SIDING SEDALIA HAUL TO SITE 3 MI
DRAINAGE AREA 3 SQ MI	NORMAL STAGE 617' DRIFT MEDIUM SCOUR

13+00 - Reqd 4 Right of Way Markers Lt & Rt

STA 13+00 - END OF STATE PROJECT NO 721 (1938)

SCALE 1"=50'

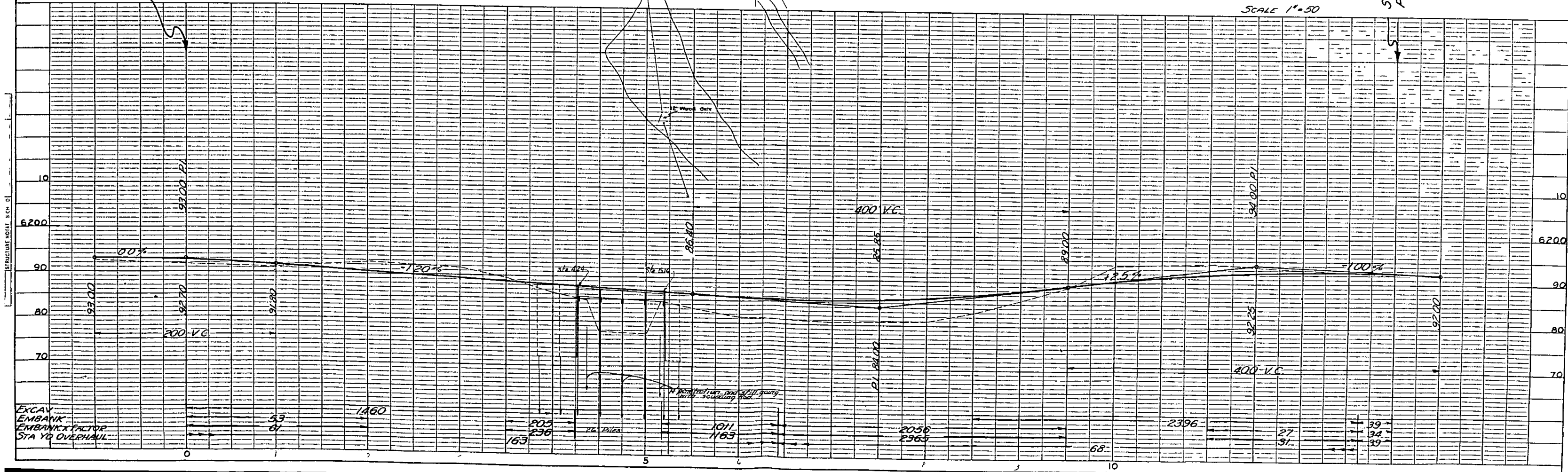

PLATE 1 - PLAN - PROFILE