



CONTROL SURVEY DIAGRAM

COLORADO DEPARTMENT OF TRANSPORTATION

PROJECT NO. STR 0119-044

SR 119 – HWY. 6 to BLACKHAWK (MP 0.05-MP 7.30)

SECTIONS 7, 8, 17, 20, 21, 26, 27, 28, 35 & 36, T. 3 S., R. 72 W., 6th P.M.

GILPIN COUNTY, COLORADO

SHEET 1 OF 4

Note: This Control Survey was completed under Project Number: STR 0119-044; Project Code: 12878 on January 1, 2000. The information contained hereon has been approved by the CDOT Region Survey Coordinator for re-use on Project Number: STA 119A-058; Project Code: 17796. All future survey data for this project was acquired using the information on this Control Survey Diagram.

GPS COORDINATE SUMMARY TABLE (ADJUSTED FIELD DATA)

PROJECT COORDINATE SUMMARY TABLE (ADJUSTED FIELD DATA)

POINT NAME	GEODETIC COORDINATES NAD-83(92) (CHARN)		ELEV. m (NAVD '88)	MAPPING ANGLE	SCALE	NAD 83(92) ZONE 0502		DESCRIPTION	POINT NO.	NAD 83(92) ZONE 0502		ELEV. m (NAVD '88)	PROJECT COORDINATES		ELEV. ft. (NAVD '88)
	LATITUDE	LONGITUDE				NORTHING m	EASTING m			NORTHING m	EASTING m		NORTHING ft	EASTING ft	
CM-MP 0.05 GPS PROJECT STATION	39° 44' 52.0154" N	105° 23' 53.3054" W	2108.453	0° 03' 51.270"	0.9999999562	517330.632	923131.920	SET: CDOT TYPE 2 CONTROL MONUMENT	5	517330.632	923131.920	2108.453	1697871.181	3029704.769	6917.484
CM-MP 0.20 GPS PROJECT STATION	39° 45' 00.2482" N	105° 23' 55.8765" W	2115.715	0° 03' 49.649"	1.000000014	517584.481	923070.423	FOUND: CDOT TYPE 2 CONTROL MONUMENT	20	517584.481	923070.423	2115.715	1698704.310	3029502.939	6941.309
CM-MP 0.40 GPS PROJECT STATION	39° 45' 07.5788" N	105° 23' 59.1849" W	2123.192	0° 03' 47.562"	1.0000000417	517810.480	922991.411	FOUND: CDOT TYPE 2 CONTROL MONUMENT	40	517810.480	922991.411	2123.192	1699446.034	3029243.620	6965.839
CM-MP 0.60 GPS PROJECT STATION	39° 45' 11.6239" N	105° 24' 07.4351" W	2128.961	0° 03' 42.359"	1.0000000640	517935.026	922794.874	SET: CDOT TYPE 2 CONTROL MONUMENT	60	517935.026	922794.874	2128.961	1699854.793	3028598.591	6984.765
CM-MP 0.75 GPS PROJECT STATION	39° 45' 15.6387" N	105° 24' 13.8215" W	2134.208	0° 03' 38.331"	1.0000000862	518058.690	922642.708	SET: CDOT TYPE 2 CONTROL MONUMENT	75	518058.690	922642.708	2134.208	1700260.657	3028099.184	7001.981
CM-MP 0.85 GPS PROJECT STATION	39° 45' 17.4910" N	105° 24' 21.6607" W	2140.491	0° 03' 33.387"	1.0000000965	518115.617	922456.036	SET: CDOT TYPE 2 CONTROL MONUMENT	85	518115.617	922456.036	2140.491	1700447.489	3027486.528	7022.593
CM-MP 1.00 GPS PROJECT STATION	39° 45' 19.3062" N	105° 24' 32.7901" W	2149.561	0° 03' 26.368"	1.0000001065	518171.335	922191.043	SET: CDOT TYPE 2 CONTROL MONUMENT	100	518171.335	922191.043	2149.561	1700630.356	3026616.825	7052.353
CM-MP 1.15 GPS PROJECT STATION	39° 45' 27.7433" N	105° 24' 38.6333" W	2155.548	0° 03' 22.682"	1.0000001534	518431.411	922051.692	SET: CDOT TYPE 2 CONTROL MONUMENT	115	518431.411	922051.692	2155.548	1701483.920	3026159.478	7071.995
CM-MP 1.30 GPS PROJECT STATION	39° 45' 31.7996" N	105° 24' 45.5657" W	2160.280	0° 03' 18.310"	1.0000001759	518556.352	921886.552	SET: CDOT TYPE 2 CONTROL MONUMENT	130	518556.352	921886.552	2160.280	1701893.974	3025617.490	7087.517
CM-MP 1.50 GPS PROJECT STATION	39° 45' 38.8388" N	105° 24' 57.3934" W	2175.185	0° 03' 10.851"	1.0000002152	518773.189	921604.808	SET: CDOT TYPE 2 CONTROL MONUMENT	150	518773.189	921604.808	2175.185	1702605.632	3024692.811	7136.419
CM-MP 1.65 GPS PROJECT STATION	39° 45' 40.6272" N	105° 25' 06.6404" W	2178.176	0° 03' 05.019"	1.0000002252	518828.143	921384.652	SET: CDOT TYPE 2 CONTROL MONUMENT	165	518828.143	921384.652	2178.176	1702785.990	3023970.265	7146.233
CM-MP 1.75 GPS PROJECT STATION	39° 45' 40.8605" N	105° 25' 15.8858" W	2186.403	0° 02' 59.188"	1.0000002265	518835.143	921164.581	SET: CDOT TYPE 2 CONTROL MONUMENT	175	518835.143	921164.581	2186.403	1702808.962	3023247.995	7173.225
CM-MP 1.90 GPS PROJECT STATION	39° 45' 45.2412" N	105° 25' 25.8319" W	2195.274	0° 02' 52.915"	1.0000002510	518970.054	920927.723	SET: CDOT TYPE 2 CONTROL MONUMENT	190	518970.054	920927.723	2195.274	1703251.737	3022470.629	7202.327
CM-MP 2.10 GPS PROJECT STATION	39° 45' 49.7516" N	105° 25' 36.4328" W	2205.205	0° 02' 46.229"	1.0000002763	519108.953	920675.277	SET: CDOT TYPE 2 CONTROL MONUMENT	210	519108.953	920675.277	2205.205	1703707.602	3021642.104	7234.910
CM-MP 2.20 GPS PROJECT STATION	39° 45' 48.1161" N	105° 25' 43.7945" W	2211.150	0° 02' 41.586"	1.0000002672	519058.374	920500.092	SET: CDOT TYPE 2 CONTROL MONUMENT	220	519058.374	920500.092	2211.150	1703541.605	3021067.151	7254.415
CM-MP 2.30 GPS PROJECT STATION	39° 45' 49.1498" N	105° 25' 51.2306" W	2214.074	0° 02' 36.896"	1.0000002729	519090.112	920323.072	SET: CDOT TYPE 2 CONTROL MONUMENT	230	519090.112	920323.072	2214.074	1703645.766	3020486.173	7264.007
CM-MP 2.40 GPS PROJECT STATION	39° 45' 46.7257" N	105° 25' 54.6179" W	2215.650	0° 02' 34.760"	1.0000002594	519015.285	920242.510	SET: CDOT TYPE 2 CONTROL MONUMENT	240	519015.285	920242.510	2215.650	1703400.186	3020221.769	7269.178
CM-MP 2.50 GPS PROJECT STATION	39° 45' 44.1147" N	105° 26' 01.3489" W	2220.854	0° 02' 30.515"	1.0000002447	518934.641	920082.352	SET: CDOT TYPE 2 CONTROL MONUMENT	250	518934.641	920082.352	2220.854	1703135.513	3019696.134	7286.253
CM-MP 2.60 GPS PROJECT STATION	39° 45' 43.8454" N	105° 26' 08.0452" W	2225.615	0° 02' 26.291"	1.0000002432	518926.221	919922.969	SET: CDOT TYPE 2 CONTROL MONUMENT	260	518926.221	919922.969	2225.615	1703107.880	3019173.042	7301.871
CM-MP 2.70 GPS PROJECT STATION	39° 45' 41.3128" N	105° 26' 11.2573" W	2231.636	0° 02' 24.266"	1.0000002290	518848.057	919846.567	SET: CDOT TYPE 2 CONTROL MONUMENT	270	518848.057	919846.567	2231.636	1702851.347	3018922.291	7321.626
CM-MP 2.80 GPS PROJECT STATION	39° 45' 39.6464" N	105° 26' 15.1636" W	2235.502	0° 02' 21.802"	1.0000002197	518796.598	919753.621	SET: CDOT TYPE 2 CONTROL MONUMENT	280	518796.598	919753.621	2235.502	1702682.458	3018617.245	7334.310
CM-MP 2.90 GPS PROJECT STATION	39° 45' 42.7013" N	105° 26' 21.7709" W	2239.969	0° 02' 17.635"	1.0000002368	518890.711	919596.285	SET: CDOT TYPE 2 CONTROL MONUMENT	290	518890.711	919596.285	2239.969	1702991.335	3018100.871	7348.965
CM-MP 3.15 GPS PROJECT STATION	39° 45' 48.4304" N	105° 26' 34.4619" W	2251.761	0° 02' 09.631"	1.0000002689	519067.211	919294.092	SET: CDOT TYPE 2 CONTROL MONUMENT	315	519067.211	919294.092	2251.761	1703570.608	3017109.078	7387.654
CM-MP 3.25 GPS PROJECT STATION	39° 45' 48.9769" N	105° 26' 41.4648" W	2258.812	0° 02' 05.214"	1.0000002720	519083.965	919127.392	SET: CDOT TYPE 2 CONTROL MONUMENT	325	519083.965	919127.392	2258.812	1703625.593	3016561.971	7410.785
CM-MP 3.40 GPS PROJECT STATION	39° 45' 55.5431" N	105° 26' 51.1986" W	2269.749	0° 01' 59.075"	1.0000003089	519286.339	918895.592	SET: CDOT TYPE 2 CONTROL MONUMENT	340	519286.339	918895.592	2269.749	1704289.783	3015801.205	7446.669
CM-MP 3.60 GPS PROJECT STATION	39° 46' 02.4104" N	105° 26' 54.6503" W	2277.704	0° 01' 56.898"	1.0000003476	519498.088	918813.318	SET: CDOT TYPE 2 CONTROL MONUMENT	360	519498.088	918813.318	2277.704	1704984.738	3015531.184	7472.767
CM-MP 3.65 GPS PROJECT STATION	39° 46' 06.0570" N	105° 26' 52.9527" W	2279.987	0° 01' 57.969"	1.0000003682	519610.575	918853.656	SET: CDOT TYPE 2 CONTROL MONUMENT	365	519610.575	918853.656	2279.987	1705353.919	3015663.572	7480.257
CM-MP 3.75 GPS PROJECT STATION	39° 46' 09.3922" N	105° 26' 53.1842" W	2283.614	0° 01' 57.823"	1.0000003870	519713.429	918848.083	SET: CDOT TYPE 2 CONTROL MONUMENT	375	519713.429	918848.083	2283.614	1705691.485	3015645.281	7492.158
CM-MP 3.85 GPS PROJECT STATION	39° 46' 12.3007" N	105° 26' 58.0943" W	2289.834	0° 01' 54.726"	1.0000004035	519803.069	918731.171	SET: CDOT TYPE 2 CONTROL MONUMENT	385	519803.069	918731.171	2289.834	1705985.680	3015261.580	7512.564
CM-MP 3.95 GPS PROJECT STATION	39° 46' 17.7270" N	105° 27' 04.9631" W	2297.124	0° 01' 50.394"	1.0000004343	519970.338	918567.603	SET: CDOT TYPE 2 CONTROL MONUMENT	395	519970.338	918567.603	2297.124	1706534.657	3014724.753	7536.481
CM-MP 4.10 GPS PROJECT STATION	39° 46' 22.9986" N	105° 27' 08.8192" W	2302.609	0° 01' 47.962"	1.0000004642	520132.876	918475.746	SET: CDOT TYPE 2 CONTROL MONUMENT	410	520132.876	918475.746	2302.609	1707068.102	3014423.277	7554.477
CM-MP 4.20 GPS PROJECT STATION	39° 46' 28.1426" N	105° 27' 11.3989" W	2309.276	0° 01' 46.335"	1.0000004936	520291.496	918414.269	SET: CDOT TYPE 2 CONTROL MONUMENT	420	520291.496	918414.269	2309.276	1707588.690	3014221.510	7576.349
CM-MP 4.30 GPS PROJECT STATION	39° 46' 31.9795" N	105° 27' 16.4179" W	2314.568	0° 01' 43.169"	1.0000005155	520409.769	918294.765	SET: CDOT TYPE 2 CONTROL MONUMENT	430	520409.769	918294.765	2314.568	1707976.863	3013829.303	7593.712
CM-MP 4.35 GPS PROJECT STATION	39° 46' 34.6497" N	105° 27' 22.0177" W	2320.657	0° 01' 39.638"	1.0000005307	520492.058	918161.461	SET: CDOT TYPE 2 CONTROL MONUMENT	435	520492.058	918161.461	2320.657	1708246.934	3013391.799	7613.689
CM-MP 4.40 GPS PROJECT STATION	39° 46' 36.8431" N	105° 27' 24.9742" W	2323.852	0° 01' 37.773"	1.0000005433	520559.673	918091.070	SET: CDOT TYPE 2 CONTROL MONUMENT	440	520559.673	918091.070	2323.852	1708468.845	3013160.776	7624.170
CM-MP 4.50 GPS PROJECT STATION	39° 46' 41.9985" N	105° 27' 30.3663" W	2331.309	0° 01' 34.372"	1.0000005728	520718.615	917962.678	SET: CDOT TYPE 2 CONTROL MONUMENT	450	520718.615	917962.678	2331.309	1708990.491	3	

Note: This Control Survey was completed under Project Number: STR 0119-044; Project Code: 12878 on January 1, 2000. The information contained hereon has been approved by the CDOT Region Survey Coordinator for re-use on Project Number: STA 119A-058; Project Code: 17796. All future survey data for this project was acquired using the information on this Control Survey Diagram.

# CONTROL SURVEY DIAGRAM

COLORADO DEPARTMENT OF TRANSPORTATION

PROJECT NO. STR 0119-044

SR 119 - HWY. 6 to BLACKHAWK (MP 0.05-MP 7.30)

SECTIONS 7, 8, 17, 20, 21, 26, 27, 28, 35 & 36, T. 3 S., R. 72 W., 6th P.M.

GILPIN COUNTY, COLORADO

SHEET 2 of 4

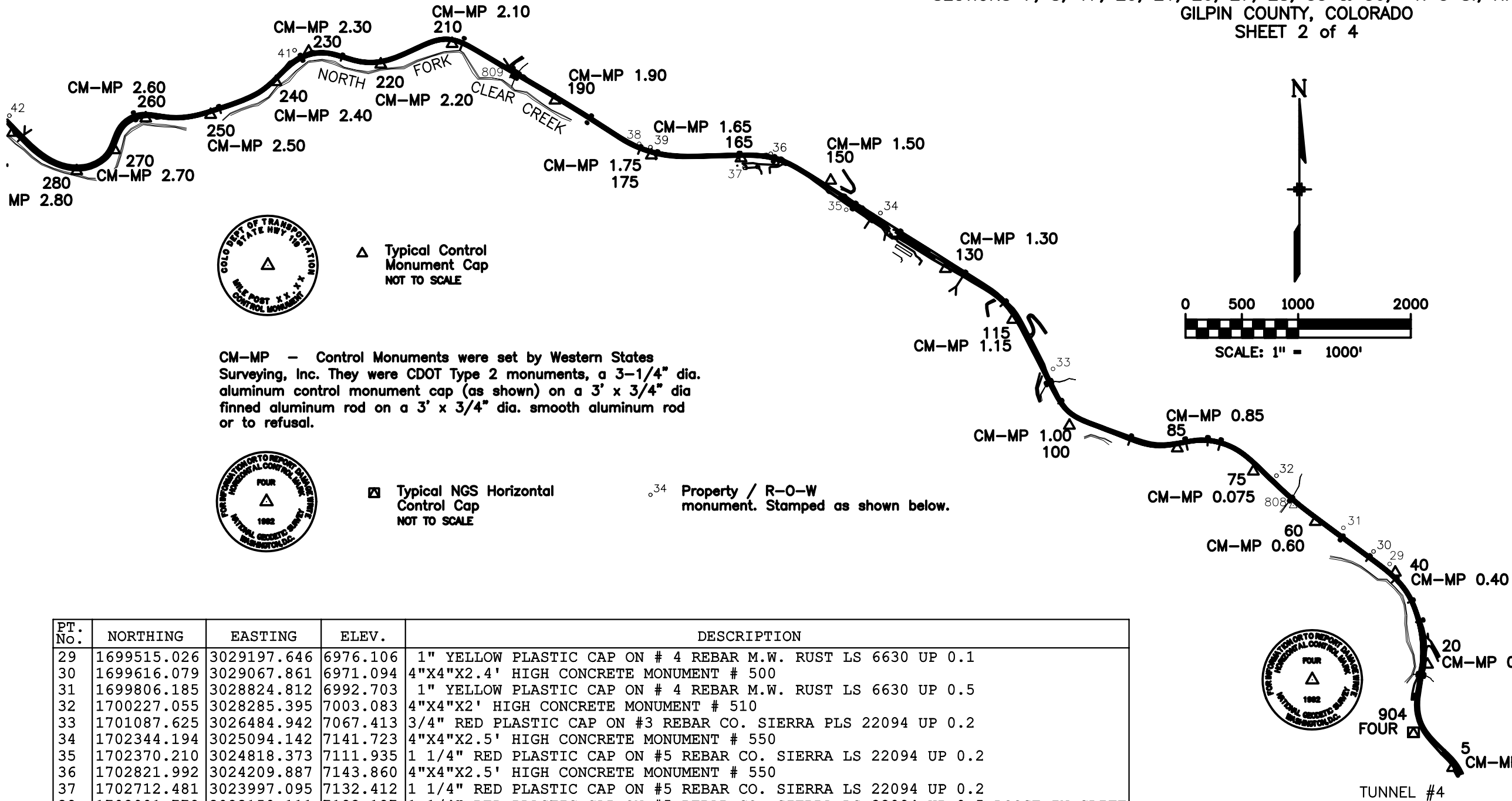

PT. No.	NORTHING	EASTING	ELEV.	DESCRIPTION
29	1699515.026	3029197.646	6976.106	1" YELLOW PLASTIC CAP ON # 4 REBAR M.W. RUST LS 6630 UP 0.1
30	1699616.079	3029067.861	6971.094	4"X4"X2.4' HIGH CONCRETE MONUMENT # 500
31	1699806.185	3028824.812	6992.703	1" YELLOW PLASTIC CAP ON # 4 REBAR M.W. RUST LS 6630 UP 0.5
32	1700227.055	3028285.395	7003.083	4"X4"X2' HIGH CONCRETE MONUMENT # 510
33	1701087.625	3026484.942	7067.413	3/4" RED PLASTIC CAP ON #3 REBAR CO. SIERRA PLS 22094 UP 0.2
34	1702344.194	3025094.142	7141.723	4"X4"X2.5' HIGH CONCRETE MONUMENT # 550
35	1702370.210	3024818.373	7111.935	1 1/4" RED PLASTIC CAP ON #5 REBAR CO. SIERRA LS 22094 UP 0.2
36	1702821.992	3024209.887	7143.860	4"X4"X2.5' HIGH CONCRETE MONUMENT # 550
37	1702712.481	3023997.095	7132.412	1 1/4" RED PLASTIC CAP ON #5 REBAR CO. SIERRA LS 22094 UP 0.2
38	1702901.778	3023150.111	7182.187	1 1/4" RED PLASTIC CAP ON #5 REBAR CO. SIERRA LS 22094 UP 0.5
39	1702874.847	3023240.360	7180.658	4"X4"X2.4' HIGH CONCRETE MONUMENT # 570
41	1703655.962	3020372.539	7274.156	4"X4"X3' HIGH CONCRETE MONUMENT # 600
808	1699986.840	3028420.780	6991.161	2" ALUMINUM CAP ON #4 REBAR WSSI CP 808
809	1703453.390	3022134.020	7216.749	2" ALUMINUM CAP ON #4 REBAR WSSI CP 809

# CONTROL SURVEY DIAGRAM

COLORADO DEPARTMENT OF TRANSPORTATION

PROJECT NO. STR 0119-044

SR 119 - HWY. 6 to BLACKHAWK (MP 0.05-MP 7.30)

SECTIONS 7, 8, 17, 20, 21, 26, 27, 28, 35 & 36, T. 3 S., R. 72 W., 6th P.M.

GILPIN COUNTY, COLORADO

SHEET 3 of 4

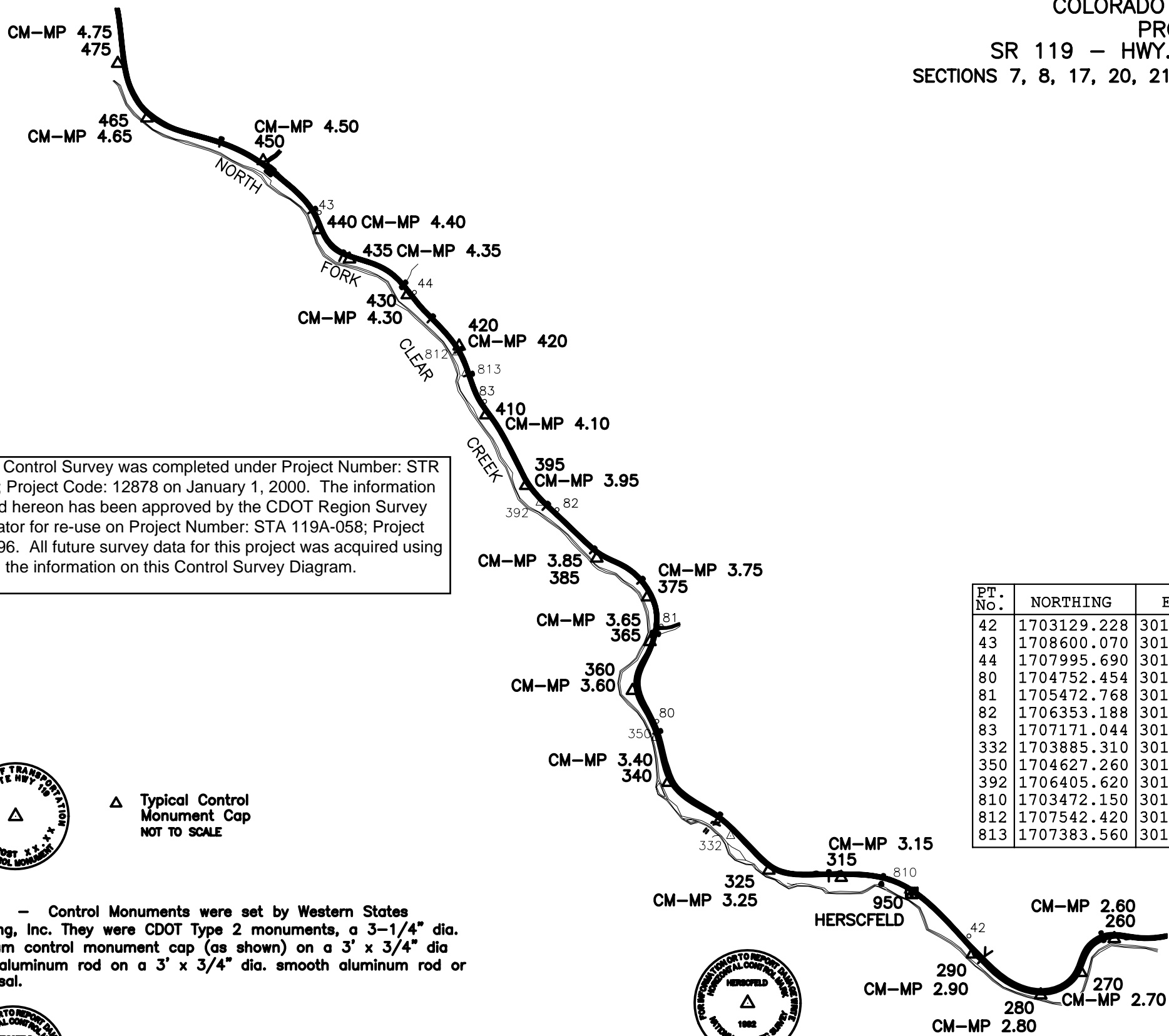

Note: This Control Survey was completed under Project Number: STR 0119-044; Project Code: 12878 on January 1, 2000. The information contained hereon has been approved by the CDOT Region Survey Coordinator for re-use on Project Number: STA 119A-058; Project Code: 17796. All future survey data for this project was acquired using the information on this Control Survey Diagram.

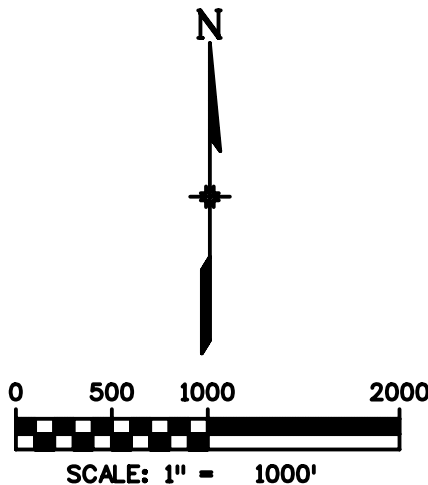

PT. No.	NORTHING	EASTING	ELEV.	DESCRIPTION
42	1703129.228	3018074.280	7356.813	4"x4"x2.7' HIGH CONCRETE MONUMENT # 630
43	1708600.070	3013164.199	7636.396	4"x4"x2' HIGH CONCRETE MONUMENT # 710
44	1707995.690	3013883.030	7612.130	4"x4"x2' HIGH CONCRETE MONUMENT # 700
80	1704752.454	3015715.363	7463.611	4"x4"x1.2' HIGH CONCRETE MONUMENT # 660
81	1705472.768	3015747.674	7490.689	4"x4"x2' HIGH CONCRETE MONUMENT # 670
82	1706353.188	3014961.050	7527.958	4"x4"x2.2' HIGH CONCRETE MONUMENT # 680
83	1707171.044	3014413.801	7576.623	4"x4"x2' HIGH CONCRETE MONUMENT # 690
332	1703885.310	3016273.480	7418.338	2" ALUMINUM CAP ON #4 REBAR WSSI CP 332
350	1704627.260	3015706.040	7453.494	2" ALUMINUM CAP ON #4 REBAR WSSI CP 350
392	1706405.620	3014833.590	7529.346	2" ALUMINUM CAP ON #4 REBAR WSSI CP 392
810	1703472.150	3017615.210	7371.444	2" ALUMINUM CAP ON #4 REBAR WSSI CP 810
812	1707542.420	3014203.340	7571.799	2" ALUMINUM CAP ON #4 REBAR WSSI CP 812
813	1707383.560	3014271.130	7565.507	2" ALUMINUM CAP ON #4 REBAR WSSI CP 813



△ Typical Control Monument Cap  
NOT TO SCALE

CM-MP - Control Monuments were set by Western States Surveying, Inc. They were CDOT Type 2 monuments, a 3-1/4" dia. aluminum control monument cap (as shown) on a 3' x 3/4" dia. finned aluminum rod on a 3' x 3/4" dia. smooth aluminum rod or to refusal.



□ Typical NGS Horizontal Control Cap  
NOT TO SCALE

○<sup>34</sup> Property / R-O-W monument. Stamped as shown below.



FILED CERTIFICATION: \_\_\_\_\_  
DEPOSITED THIS \_\_\_\_\_ DAY OF \_\_\_\_\_ AT \_\_\_\_\_ M. FOR INFORMATION  
ONLY IN BOOK \_\_\_\_\_ OF THE COUNTY LAND SURVEYS/RIGHT OF WAY  
SURVEYS AT PAGE \_\_\_\_\_ RECEPTION NUMBER \_\_\_\_\_  
SIGNED \_\_\_\_\_ DEPT. \_\_\_\_\_

datestamp

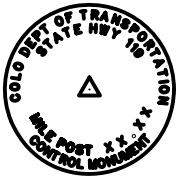

△ Typical Control Monument Cap  
NOT TO SCALE



▣ Typical NGS Horizontal Control Cap  
NOT TO SCALE

CM-MP - Control Monuments were set by Western States Surveying, Inc. They were CDOT Type 2 monuments, a 3-1/4" dia. aluminum control monument cap (as shown) on a 3' x 3/4" dia. smooth aluminum rod or to refusal.

34 Property / R-O-W monument. Stamped as shown below.

PT. No.	NORTHING	EASTING	ELEV.	DESCRIPTION
1	1710728.449	3011421.172	7721.393	4"x4"x1' HIGH CONCRETE MONUMENT IN POOR CONDITION # 740
2	1711107.402	3011142.303	7711.370	2 1/2" ALUMINUM CAP ON A 2" O.D. PIPE CP 2/20903 HWY 119 VICTORIA-2
3	1711629.277	3010976.639	7774.320	4"x4"x2' HIGH CONCRETE MONUMENT # 750
4	1712015.234	3010531.114	7752.877	1 1/4" RED PLASTIC CAP ON # 5 REBAR CLEAR MT. SURVEY PLS 22094
5	1712022.596	3010566.957	7757.380	#4 REBAR UP 0.2
6	1711900.090	3010778.318	7763.145	1 1/4" RED PLASTIC CAP ON # 5 REBAR CLEAR MT. SURVEY PLS 22094
7	1711896.820	3010780.586	7763.901	2 1/2" ALUMINUM CAP CDOT
8	1712359.088	3010243.258	7747.875	1 1/4" RED PLASTIC CAP ON # 5 REBAR CLEAR MT. SURVEY PLS 22094
9	1712401.690	3010338.566	7774.524	4"x4"x2' HIGH CONCRETE MONUMENT # 760
10	1713937.468	3009111.401	7839.924	4"x4"x2' HIGH CONCRETE MONUMENT # 780
11	1715527.342	3008069.429	7889.985	4"x4"x2' HIGH CONCRETE MONUMENT # 800
12	1716046.838	3007636.145	0000.000	1 1/4" RED PLASTIC CAP ON # 5 REBAR CLEAR MT. SURVEY PLS 22094 UP 0.3
15	1716029.226	3007524.968	7902.424	1 1/4" RED PLASTIC CAP ON # 5 REBAR CLEAR MT. SURVEY PLS 22094 UP 0.4
16	1716154.164	3007426.482	7915.817	1 1/4" RED PLASTIC CAP ON # 5 REBAR CLEAR MT. SURVEY PLS 22094 FLUSH
17	1716219.753	3007395.684	7948.683	4"x4"x2.7' HIGH CONCRETE MONUMENT # 810
18	1716152.485	3007342.062	7920.829	1 1/4" RED PLASTIC CAP ON # 5 REBAR CLEAR MT. SURVEY PLS 22094 UP 0.2
19	1716135.492	3007244.680	7926.268	1 1/4" RED PLASTIC CAP ON # 5 REBAR CLEAR MT. SURVEY PLS 22094 UP 0.2
20	1716141.434	3007042.725	7933.535	1 1/4" RED PLASTIC CAP ON # 5 REBAR CLEAR MT. SURVEY PLS 22094 UP 0.4
21	1716360.456	3006895.273	7973.755	1 1/4" YELLOW PLASTIC CAP ON #5 REBAR LINN INC. PLS 14112 UP 0.2
22	1716267.043	3006882.507	7938.108	1 1/4" YELLOW PLASTIC CAP ON #5 REBAR LINN INC. PLS 14112 FLUSH
23	1716261.966	3006815.711	7939.967	1 1/4" RED PLASTIC CAP ON # 5 REBAR CLEAR MT. SURVEY PLS 22094 UP 0.5
24	1716480.443	3006347.777	7953.061	1 1/4" YELLOW PLASTIC CAP ON #5 REBAR LINN INC. PLS 14112 UP 0.1
25	1716489.606	3006079.728	7966.446	1 1/4" YELLOW PLASTIC CAP ON #5 REBAR LINN INC. PLS 14112 UP 0.4
26	1716619.772	3005833.591	8045.183	1 1/4" YELLOW PLASTIC CAP ON #5 REBAR LINN INC. PLS 14112 UP 0.2
27	1716591.290	3004710.027	7999.075	1 1/4" YELLOW PLASTIC CAP ON #5 REBAR LINN INC. PLS 14112 FLUSH
609	1715349.264	3008208.044	7879.139	3 1/4" CDOT ALUMINUM CAP MP 6.10
800	1711453.980	3010998.630	7741.098	2" ALUMINUM CAP ON #6 REBAR WSSI CP 800
801	1712193.580	3010535.580	7775.401	2" ALUMINUM CAP ON #6 REBAR WSSI CP 801
802	1712630.530	3010051.190	7768.725	2" ALUMINUM CAP ON #6 REBAR WSSI CP 802
803	1713589.670	3009495.640	7800.748	2" ALUMINUM CAP ON #6 REBAR WSSI CP 803
804	1713717.430	3009370.400	7806.783	2" ALUMINUM CAP ON #6 REBAR WSSI CP 804
805	1714107.900	3008822.690	7824.549	2" ALUMINUM CAP ON #6 REBAR WSSI CP 805
806	1715629.140	3007678.450	7878.946	2" ALUMINUM CAP ON #6 REBAR WSSI CP 806
807	1716575.670	3004570.210	8005.275	SET PK NAIL WITH 1 1/4" ALUMINUM WASHER STAMPED 807 IN ASPHALT
811	1710164.637	3011545.705	7702.248	2" ALUMINUM CAP ON #4 REBAR WSSI CP 811

# CONTROL SURVEY DIAGRAM

COLORADO DEPARTMENT OF TRANSPORTATION

PROJECT NO. STR 0119-044

SR 119 - HWY. 6 to BLACKHAWK (MP 0.05-MP 7.30)

SECTIONS 7, 8, 17, 20, 21, 26, 27, 28, 35 & 36, T. 3 S., R. 72 W., 6th P.M.

GILPIN COUNTY, COLORADO

SHEET 4 of 4

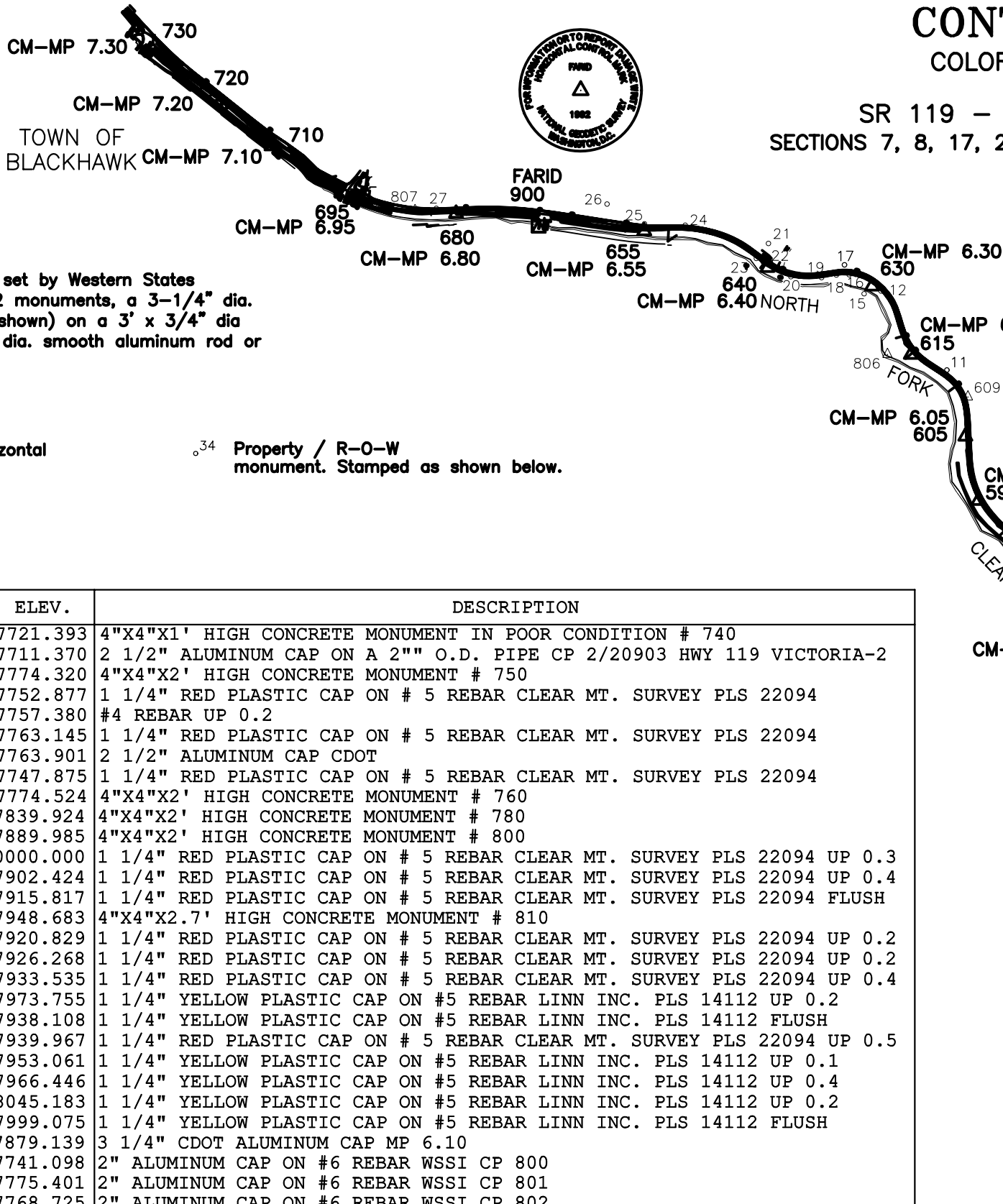

Note: This Control Survey was completed under Project Number: STR 0119-044; Project Code: 12878 on January 1, 2000. The information contained hereon has been approved by the CDOT Region Survey Coordinator for re-use on Project Number: STA 119A-058; Project Code: 17796. All future survey data for this project was acquired using the information on this Control Survey Diagram.

**Western States**  
**Surveying, Inc.**  
AZA DRIVE, SUITE 252  
ADO 80134 (303) 841-7436