



2000 S Holly Street
Denver, CO 80222
Phone: (303) 757-9922 FAX: (303) 757-9390

Region 6:

SLK

Sheet Revisions		
Date	Description	Initials

Sheet Revisions		
Date	Description	Initials

Sheet Revisions		
Date	Description	Initials

Right of Way Plans				
Title Sheet				
Project Number: STU M320-060				
Project Location: Colfax/Galapago/Welton Intersection				
Sec34,T.3S.,R69W., Sec3,T4S.,R68W, 6th PM, Denver Cnty				
Project Code:	Last Mod. Date	Subset Sheets	Sheet No.	
16952	02-25-11	1.01 of 1.01	1.01	

CITY AND COUNTY OF DENVER STATE OF COLORADO

RIGHT OF WAY PLANS OF PROPOSED FEDERAL AID PROJECT NO. STU M320-060 STATE HIGHWAY NO. 40

R.O.W. Length of Project = 0.14 Miles
Const. Length of Project = 0.14 Miles

R68W



PROJECT LOCATION MAP

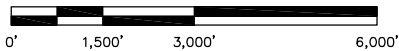

Begin Construction Project
Begin ROW Project
Station: 100+71.75
M.P.: 297.657

End Construction Project
End ROW Project
Station: 104+82.37
M.P.: 297.673

SHEET NO.

1.01
2.01
3.01
4.01-4.04
5.01
6.01
7.01
8.01

INDEX OF SHEETS

(1) Title Sheet
(1) Tabulation of Properties
(NA) Project Control Diagram
(4) Land Survey Control Diagram
(1) Monumentation Sheets
(NA) Tabulation of Road Approach Sheets
(1) Plan Sheets
(NA) Ownership Map
(8) Total Sheets

Scales of Original 11x17 Drawings

Plan Sheets 1"=40'

Ownership Map 1"=40'

Basis of Bearings: Bearings shown, or used in the calculations of coordinates, are based on City and County of Denver local grid bearing of N 83°14'54" E from David Evans' Control Point No. 104 to Control Point No. 102. Both monuments being described hereon and shown on Denver Justice Center Survey and Right of Way Diagram recorded in the City and County of Denver Land Survey Plats at Reception Number L011113. The survey data was obtained from a combination of RTK GPS and terrestrial total station survey

1. This Right-of-Way Plan is not a boundary survey of the adjoining property and is prepared for the Colorado Department of Transportation purposes only.

2. For title information, Stantec Consulting relied on Informational Title Commitment File No. 04665A2011, dated 02-14-2011 at 4:00 p.m. prepared by H. C. Peck and Associates, Inc..

3. This plan set is subject to change and may not be the most current set. It is the user's responsibility to verify with CDOT that this set is the most current. The information contained on the attached drawing is not valid unless this copy bears an original signature of the Professional Land Surveyor hereon named.

NOTICE: According to Colorado law you must commence any legal action based upon any defect in this survey within three years after you first discover such defect. In no event may any action based upon any defect in this survey be commenced more than ten years from the date of the certification shown hereon.

DEPARTMENT OF TRANSPORTATION
FEDERAL HIGHWAY ADMINISTRATION

AUTHORIZED:

DATE

DIVISION ADMINISTRATOR

SURVEYOR STATEMENT (ROW PLAN)

I, Alan Warner, a professional land surveyor licensed in the State of Colorado, do hereby state to the Colorado Department of Transportation that based upon my knowledge, information and belief, research, calculations and evaluation of the survey evidence were performed and this Right-of-Way Plan was prepared under my responsible charge in accordance with applicable standards of practice defined by Colorado Department of Transportation publications. This statement is not a guaranty or warranty, either expressed or implied.

PLS No. 28668

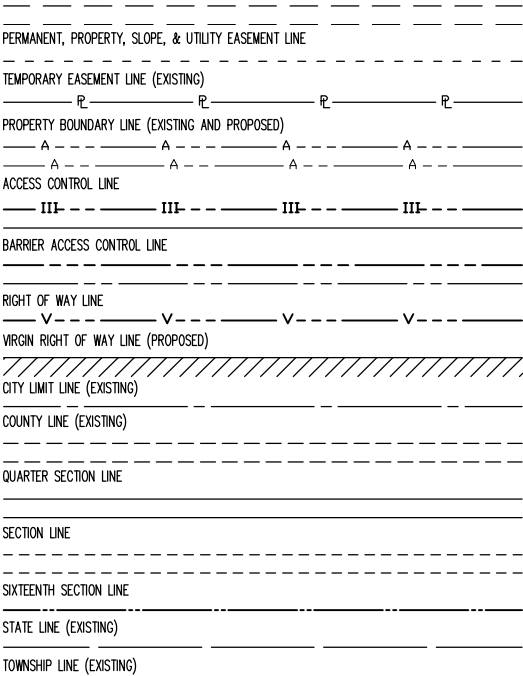
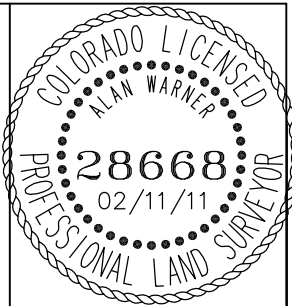

SURVEY/ROW

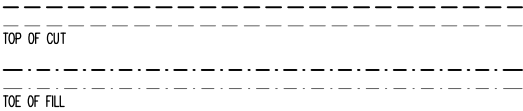

TERRAIN

Note: For a complete listing of symbology used within this set of plans, please refer to the M-100-1 Standard Symbols of the Colorado Department of Transportation M&S Standards Publication dated July 2006. Existing features are shown as screened weight (gray scale), except as noted with the word (existing). Proposed or new features are shown as full weight without screening, except as noted with the word (proposed).

COLORADO DEPARTMENT OF TRANSPORTATION



2000 S Holly Street
Denver, CO 80222
Phone: (303) 757-9922 FAX: (303) 757-9390

Region 6:

SLK

Sheet Revisions			Sheet Revisions			Sheet Revisions		
Date	Description	Initials	Date	Description	Initials	Date	Description	Initials

Land Survey Control Diagram				
Title Sheet				
Project Number: STU M320-060				
Project Location: Colfax/Galapago/Welton Intersection				
Sec34,T.3S.,R69W., Sec3,T4S.,R68W, 6th PM, Denver Cnty				
Project Code:	Last Mod. Date	Subset Sheets	Sheet No.	
16952	02-11-11	4.01 of 4.04	4.01	

DEPARTMENT OF TRANSPORTATION
STATE OF COLORADO
LAND SURVEY CONTROL DIAGRAM

State Highway 40 MP 297.657 to 297.673
Section 34, T. 3 S., R. 68 W.. &
Section 3, T. 4 S., R 68 W.
of the 6th Principle Meridian
City and County of Denver

SHEET NO.	INDEX OF SHEETS
4.01	(1) Title Sheet
4.02	(1) Plan Sheet
4.03	(1) Geodetic Control Coordinate Table
4.04	(1) Monument Coordinate Table

4 Total Sheets	

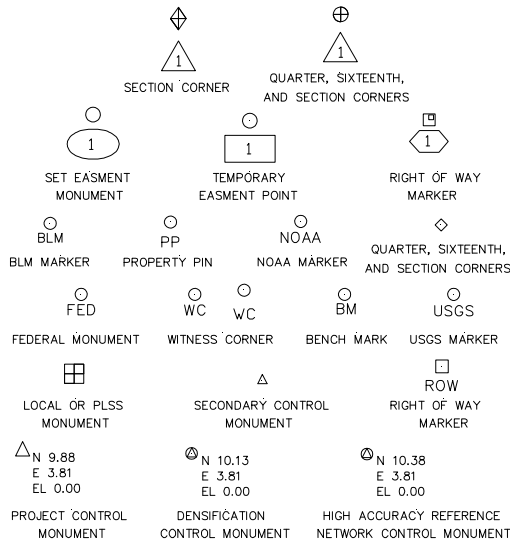

Note: For a complete listing of symbology used within this set of plans, please refer to the M-100-1 Standard Symbols of the Colorado Department of Transportation M&S Standards Publication dated July 2006. Existing features are shown as screened weight (gray scale), except as noted with the word (existing). Proposed or new features are shown as full weight without screening, except as noted with the word (proposed).

General Notes:

1. This Land Survey Control Diagram is not a boundary survey of the adjoining property and is prepared for the Colorado Department of Transportation purposes only. No determination has been made to determine if the found monuments as shown are in their proper position or if they are at the corners they are intended to monument.
2. Title policy, title commitment, and title research are not part of this survey, therefore easements, rights, and restrictions of record were not researched and are not shown on this diagram. The verification of the physical evidence with relation to easements, rights of ways, property boundaries, and restrictions, as described in the instruments of record, were not included in this control survey.
3. This plan set is subject to change and may not be the most current set. It is the user's responsibility to verify with CDOT that this set is the most current. The information contained on the attached drawing is not valid unless this copy bears an original signature of the Professional Land Surveyor hereon named.
4. Refer to the M-629-1 Survey Monuments of the Standard Plans dated July, 2006 found in The Colorado Department of Transportation, M & S Standards for typical survey monument descriptions.

Begin Construction Project
Begin ROW Project
Station: 100+71.75
M.P.: 297.657



End Construction Project
End ROW Project
Station: 104+82.37
M.P.: 297.673

PROJECT LOCATION MAP

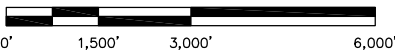

Basis of Bearings: Bearings shown, or used in the calculations of coordinates, are based on City and County of Denver local grid bearing of N 83°14'54" E from David Evans' Control Point No. 104 to Control Point No. 102. Both monuments being described hereon and shown on Denver Justice Center Survey and Right of Way Diagram recorded in the City and County of Denver Land Survey Plats at Reception Number L011113. The survey data was obtained from a combination of RTK GPS and terrestrial total station survey

Basis of Elevations: NAVD 88 Project elevations were established by differential leveling from City of Denver Benchmark No 3B. The published orthometric height of BM 3B is 5214.12 ft NAVD 1988. Site Benchmarks are 2" brass caps marked "DEA" and shown hereon. This information was supplied by the City and County of Denver, order of benchmark is unknown.

COORDINATE DATUM: Project coordinates were derived are based on the City and County of Denver grid known as "ccod_local":

Transverse Mercator Zone: ccd_local
Datum: NAD83-1992
Central Point False Northing = 400,000
False Easting = 600,000
Latitude of Origin = N39°45'19"
Central Meridian = W104°53'53"
Zone width = 6°0'00.0"
Scale Factor at Origin = 1.00025403000
Units are US Survey Feet and decimals thereof.

REFERENCES:

1. Map of the Official Survey of East Denver known as the Bonsall Map.
2. Map of the Official Survey of Witter's First Addition.
3. Miscellaneous City and County of Denver tie books.
4. Land Survey Plats Rec. No.s L002066, L002545, L002928, L006530, L009318 AND L011086.
5. Denver Justice Center Survey and Right of Way Diagram, Rec. No. L011113.
6. Monument Record for the Southwest Corner., Sec. 34, by D. Forde Dated 03/11/02.

NOTICE: According to Colorado law you must commence any legal action based upon any defect in this survey within three years after you first discover such defect. In no event may any action based upon any defect in this survey be commenced more than ten years from the date of the certification shown hereon.

SURVEYOR STATEMENT (ROW PLAN)

I, Alan Warner, a professional land surveyor licensed in the State of Colorado, do hereby state to the Colorado Department of Transportation that this Land Survey Control Diagram was prepared and the field survey it represents was performed under my responsible charge and, based upon my knowledge, information and belief is in accordance with applicable standards of practice defined by Colorado Department of Transportation publications. This statement is not a guaranty or warranty, either expressed or implied.

PLS No. 28668



COLORADO DEPARTMENT OF TRANSPORTATION



2000 S Holly Street
Denver, CO 80222
Phone: (303) 757-9922 FAX: (303) 757-9390

Region 6:

SLK

Sheet Revisions			Sheet Revisions			Sheet Revisions		
Date	Description	Initials	Date	Description	Initials	Date	Description	Initials

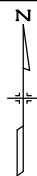

Land Survey Control Diagram

Plan Sheet

Project Number: STU M320-060				
Project Location: Colfax/Galapago/Welton Intersection				
Sec34,T.3S.,R69W., Sec3,T4S.,R68W, 6th PM, Denver Cnty				
Project Code:	Last Mod. Date	Subset Sheets	Sheet No.	
16952	02-11-11	4.02 of 4.04	4.02	



COLORADO STATE BOARD
OF LICENSURE FOR
PROFESSIONAL ENGINEERS AND
PROFESSIONAL LAND
SURVEYORS
RULE 6.1.2(a) SEAL.

SE 1/4,
SEC. 33

SW 1/4,
SEC. 34

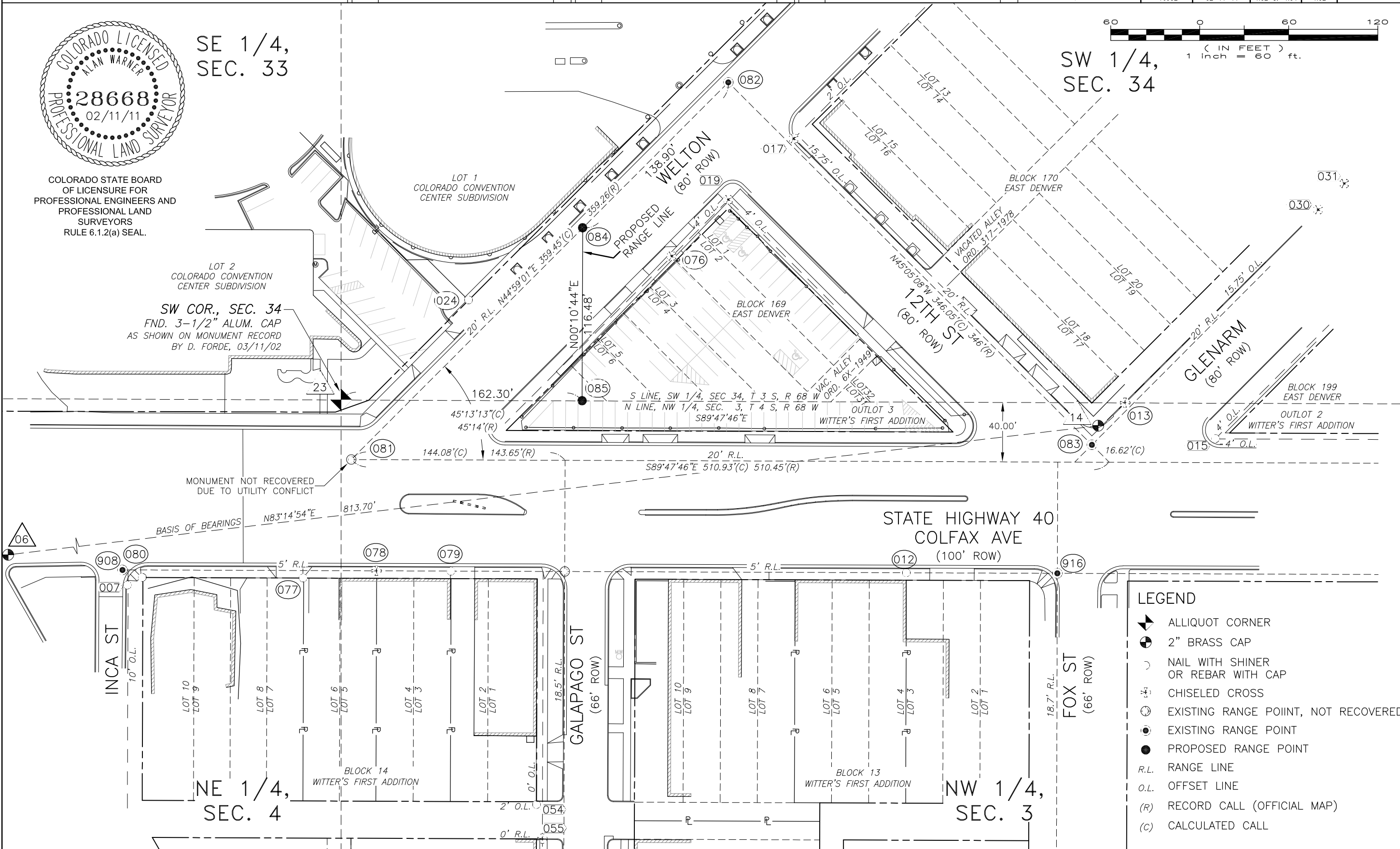

LEGEND

- ALLIQUOT CORNER
- 2" BRASS CAP
- NAIL WITH SHINER
OR REBAR WITH CAP
- CHISELED CROSS
- EXISTING RANGE POINT, NOT RECOVERED
- EXISTING RANGE POINT
- PROPOSED RANGE POINT
- R.L. RANGE LINE
- O.L. OFFSET LINE
- (R) RECORD CALL (OFFICIAL MAP)
- (C) CALCULATED CALL

COLORADO DEPARTMENT OF TRANSPORTATION



2000 S Holly Street
Denver, CO 80222
Phone: (303) 757-9922 FAX: (303) 757-9390

Region 6:

SLK

Sheet Revisions		
Date	Description	Initials

Sheet Revisions		
Date	Description	Initials

Sheet Revisions		
Date	Description	Initials

Land Survey Control Diagram				
Geodetic Control Coordinate Table				
Project Number: STU M320-060				
Project Location: Colfax/Galapago/Welton Intersection				
Sec34,T.3S.,R69W., Sec3,T4S.,R68W, 6th PM, Denver Cnty				
Project Code:	Last Mod. Date	Subset Sheets	Sheet No.	
16952	02-11-11	4.03 of 4.04	4.03	



GEODETIC COORDINATE TABLE										
Point No.	Geodetic Coordinates		Elip Height	Ortho Height	Mapping Angle	Grid Scale Factor	Project Coordinates (Denver Local)			Description
	Latitude	Longitude	(NAVD)(m)	(m)			Northing (Sft)	Easting (Sft)	Elevation	
1	39°44'24.98821"N	104°59'49.09984"W	1572.198	1589.253	0°18'59.59259"	0.999751422	394548.721	572175.442	5214.12	2" Brass Cap CCOD BM 3B
6	39°44'23.85836"N	104°59'53.23679"W	1573.447	1590.495	0°18'59.50669"	0.999751166	394434.725	571852.066	5218.15	2" Brass Cap DEA Control Pnt.
14	39°44'24.80938"N	104°59'42.89636"W	1572.601	1589.663	0°19'06.02851"	0.99975135	394530.090	572660.144	5215.42	2" Brass Cap DEA Control Pnt.
23	39°44'24.97649"N	104°59'49.42690"W	1571.532	1589.586	0°19'01.90954"	0.999751358	394547.563	572149.886		3 1/2" Alum. Cap. PLS 16401

COLORADO STATE BOARD
OF LICENSURE FOR
PROFESSIONAL ENGINEERS AND
PROFESSIONAL LAND
SURVEYORS
RULE 6.1.2(a) SEAL.



COLORADO DEPARTMENT OF TRANSPORTATION



2000 S Holly Street
Denver, CO 80222
Phone: (303) 757-9922 FAX: (303) 757-9390

Region 6:

SLK

Sheet Revisions		
Date	Description	Initials

Sheet Revisions		
Date	Description	Initials

Sheet Revisions		
Date	Description	Initials

Land Survey Control Diagram				
Monument Coordinate Tables				
Project Number: STU M320-060				
Project Location: Colfax/Galapago/Welton Intersection				
Sec34,T.3S.,R69W., Sec3,T4S.,R68W, 6th PM, Denver Cnty				
Project Code:	Last Mod. Date	Subset Sheets	Sheet No.	
16952	02-11-11	4.04 of 4.04	4.04	



FOUND ALIQUOT MONUMENT COORDINATE TABLE			
Point No.	Northing(ft)	Easting(ft)	Description
23	394547.407	572149.940	FOUND 3-1/2" ALUM. CAP

COLORADO STATE BOARD
OF LICENSURE FOR
PROFESSIONAL ENGINEERS AND
PROFESSIONAL LAND
SURVEYORS
RULE 6.1.2(a) SEAL.



FOUND BOUNDARY MONUMENT COORDINATE TABLE			
Point No.	Northing(ft)	Easting(ft)	Description
12	394430.986	394430.986	PK Nail W/Tag PLS Illegible
13	394545.628	572678.220	Chiseled X
24	394614.683	572235.742	PK Nail W/Tag PLS Illegible
76	394644.246	572372.738	Chiseled cross
77	394427.367	572124.560	Yellow Plastic Cap PLS Illegible
78	394432.297	572173.759	Chiseled cross
79	394432.112	572223.952	PK Nail W/Tag PLS Illegible
80	394427.609	572016.227	Yellow Plastic Cap PLS Illegible



FOUND R.O.W. MONUMENT COORDINATE TABLE			
Point No.	Northing(ft)	Easting(ft)	Description
7	394422.507	572006.241	PK Nail W/Tag PLS Illegible
15	394521.400	572739.418	PK Nail W/Tag PLS Illegible
17	394723.597	572454.870	Chiseled cross
19	394682.393	572410.863	Chiseled cross
30	394675.907	572808.276	Chiseled cross
31	394804.706	572936.855	Chiseled cross
54	394274.583	572281.533	PK Nail W/Tag PLS 16408
55	394251.596	572285.473	Chiseled cross
908	394432.893	572005.362	Brass disk in concrete
916	394430.719	572632.410	1-1/2" Aluminum Cap w/ punch



DENVER RANGE POINT MONUMENT COORDINATE TABLE			
Point No.	Northing(ft)	Easting(ft)	Description
81	394507.35900	572156.75600	Calculated Position
82	394761.54100	572410.79300	Set PK Nail W/ Washer PLS 28668
83	394517.21000	572655.85500	Set 2-1/2" Alum. Cap PLS 28668
84	394663.29500	572312.60300	Set PK Nail W/ Washer PLS 28668
85	394546.81900	572312.23900	Set PK Nail W/ Washer PLS 28668

Note: Existing range points (082 & 083) are to be preserved during construction and standard City range point monuments to be set at the end of construction. New range points (084 AND 085) are to be monumented at the end of construction.



COLORADO DEPARTMENT OF TRANSPORTATION

2000 S Holly Street
Denver, CO 80222
Phone: (303) 757-9922 FAX: (303) 757-9390

Region 6:

SLK

Sheet Revisions			Sheet Revisions			Sheet Revisions		
Date	Description	Initials	Date	Description	Initials	Date	Description	Initials

Right of Way Plans					
Monumentation Sheet					
Project Number: STU M320-060					
Project Location: Colfax/Galapago/Welton Intersection					
Sec34,T.3S.,R69W., Sec3,T4S.,R68W, 6th PM, Denver Cnty					
Project Code:	Last Mod. Date	Subset Sheets	Sheet No.		
16952	02-11-11	5.01 of 5.01	5.01		

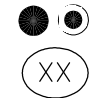

TABULATION OF DENVER RANGE POINT MONUMENTS TO BE SET							
Point No.	Northing(ft)	Easting(ft)	Description	Station (Welton St)	Offset (Welton St)	Station (SH 40)	Offset (SH 40)
82	394761.541	572410.793	Denver Range Point	205+15.46	22.77R	103+97.76	285.15L
84	394663.295	572312.603	Denver Range Point	203+76.56	25.57R	102+99.92	186.55L
85	394546.819	572312.239	Denver Range Point	202+70.08	0.00R	102+99.97	70.08L



TABULATION OF R.O.W. MONUMENTS TO BE SET							
Point No.	Northing(ft)	Easting(ft)	Description	Station (Welton St)	Offset (Welton St)	Station (SH 40)	Offset (SH 40)
86	394526.583	572357.276	Parcel 1	202+49.98	45.10R	103+45.08	50.00L
87	394537.989	572345.211	Parcel 1	202+61.35	33.00R	103+32.97	61.36L
88	394578.939	572345.339	Parcel 1	203+02.30	33.00R	103+32.96	102.31L
89	394621.793	572355.952	Parcel 1 - POB	203+62.69	33.00R	103+43.42	145.20L
96	394526.925	572261.139	Parcel 1 - DO NOT SET	202+50.02	51.04L	102+48.94	50.00L



TABULATION OF TEMPORARY EASEMENT POINTS TO BE STAKED					
Point No.	Northing(ft)	Easting(ft)	Description	Station (Welton St)	Offset (Welton St)
96	394526.483	572388.235	TE1	204+34.68	37.23R
97	394538.483	572388.271	TE1	204+34.68	47.23R
98	394538.572	572381.271	TE1	203+60.44	43.00R
99	394542.288	572355.225	TE1	203+02.30	43.00R
100	394578.907	572355.339	TE1	202+65.67	43.00R
101	394615.834	572364.135	TE1	202+59.98	49.06R
102	394658.272	572408.549	TE1	202+59.97	74.06R
103	394685.342	572389.478	TE1 POB	202+49.97	74.06R

General Notes:

1. All centerline and offset stationing may not represent the centerline as constructed in the field.
2. Refer to the M-629-1 Survey Monuments of the Standard Plans dated July, 2006 found in The Colorado Department of Transportation, M & S Standards for survey monument descriptions.
3. This plan set is subject to change and may not be the most current set. It is the user's responsibility to verify with CDOT that this set is the most current. The information contained on the attached drawing is not valid unless this copy bears an original signature of the Professional Land Surveyor hereon named.
4. For the upgrading or resetting of Denver range points refer to the City adn County of Denver specifications. Type 5 monuments can be used where point falls on concrete surface. The Denver range points will be paid for as a CDOT Type 4 in monument box.

COORDINATE DATUM: Project coordinates were derived are based on the City and County of Denver grid known as "ccod_local":

Transverse Mercator Zone: ccd_local
Datum: NAD83-1992
Central Point False Northing = 400,000, False Easting = 600,000
Latitude of Origin = N39°45'19"
Central Meridian = W104°53'53"
Zone width = 6°0'00.0"
Scale Factor at Origin = 1.00025403000
Units are US Survey Feet and decimals thereof.

NOTICE: According to Colorado law you must commence any legal action based upon any defect in this survey within three years after you first discover such defect. In no event may any action based upon any defect in this survey be commenced more than ten years from the date of the certification shown hereon.

SURVEYOR STATEMENT (R.O.W. MONUMENTS)

I, _____, a professional land surveyor licensed in the State of Colorado, do hereby state to the Colorado Department of Transportation that based upon my knowledge, information and belief, adequate research, calculations and evaluation of survey evidence were performed and the Right-of-Way monuments depicted on this Right-of-Way Plan were set under my responsible charge in accordance with applicable standards of practice defined by Colorado Department of Transportation publications. This statement is not a guaranty or warranty, either expressed or implied.
PLS No.

QUANTITY OF MONUMENTS TO BE SET

CAP TYPE	MONUMENT TYPE									
	1	1A	2	2A	3	3A*	4	5	5(S)	6
REFERENCE										
ROW	4						3			
CONTROL										
ALLOT CORNER										
PERMANENT EASEMENT										
PROJECT POINTS										
WITNESS POST (REQUIRED)										

COLORADO DEPARTMENT OF TRANSPORTATION



2000 S Holly Street
Denver, CO 80222
Phone: (303) 757-9922 FAX: (303) 757-9390

Region 6:

SLK

Sheet Revisions		
Date	Description	Initials

Sheet Revisions		
Date	Description	Initials

Sheet Revisions		
Date	Description	Initials

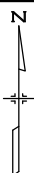

Right of Way Plan				
Plan Sheet				
Project Number: STU M320-060				
Project Location: Colfax/Galapago/Welton Intersection				
Sec34,T.3S.,R.69W., Sec3,T4S.,R.68W, 6th PM, Denver Cnty				
Project Code:	Last Mod. Date	Subset Sheets	Sheet No.	
16952	02-25-11	7.01 of 7.01	7.01	

LINE TABLE			CURVE TABLE					
LINE	BEARING	DISTANCE	CURVE	DELTA	RADIUS	LENGTH	CHORD	
							BEARING	DISTANCE
L1	S00°10'44"W	40.95'	C1	27°27'40"	93.00'	44.57'	S13°54'35"W	44.15'
L2	S46°36'22"E	16.60'						
L3	N89°47'46"W	96.14'	C2	26°26'15"	83.00'	38.30'	S13°23'52"W	37.96'
L4	N44°59'01"E	134.12'						
L5-L10	NOT USED							
L11	N44°59'01"E	61.57'						
L12	S45°00'59"E	10.00'						
L13	S44°59'01"W	60.00'						
L14	S00°10'44"W	36.62'						
L15	S46°36'22"E	8.32'						
L16	S89°47'46"E	25.00'						
L17	S00°12'14"W	10.00'						
L18	N89°47'46"W	28.96'						

