

FED. ROAD DIST. NO.	STATE	U.S.W.P.-H. PROJ. NO.	SHEET NO.	TOTAL SHEETS
3	CCLO.	W.P.S.S. 423	1	

# COLORADO STATE HIGHWAY DEPARTMENT

## PLAN AND PROFILE OF PROPOSED U.S.WORKS PROGRAM HIGHWAY PROJECT NO. W.P.S.S.-423 STATE HIGHWAY NO. 82 LAKE COUNTY

- INDEX OF SHEETS
1. SKETCH MAP AND TITLE PAGE.
  2. TYPICAL CROSS SECTION AND SUMMARY OF QUANTITIES.
  3. STANDARD CATTLE GUARD - 16 FT. ROADWAY. M16A
  4. " WIRE CABLE GUARD FENCE M20G
  5. STANDARD WIRE FENCE (TREATED WOOD POSTS) AND MARKER POSTS. M24F
  6. STANDARD METHODS FOR SUPERELEVATION AND WIDENING OF CURVES. M1A
  7. TYPICAL SIDE APPROACH ROADS / ROADWAY CONSTRUCTION TRAFFIC SIGNS. M2B
  - 8 & 9. ALIGNMENT PLAN AND PROFILE.
  - 10 TO 19. CROSS SECTIONS.

CONVENTIONAL SIGNS

CENTER LINE OF SURVEY ——— 650 ———

RIGHT OF WAY LINES ———

TOWNSHIP OR RANGE LINES ———

SECTION LINES ———

ONE-QUARTER SECTION LINES ———

RAILROAD TRACKS ———

BARBED WIRE FENCE ———

POLE LINES ———

SCALES OF ORIGINAL TRACINGS

ON PLAN, 1 IN. = 100 FT.

ON PROFILE 1 IN. = 100 FT. HORIZONTAL  
1 IN. = 10 FT. VERTICAL

GRADE LINE ON PROFILE IS SHOWN AS GRADE OF FINISHED ROAD

GROSS LENGTH OF PROJECT 3,341.7 FEET = 0.632 MILES

NET LENGTH OF PROJECT

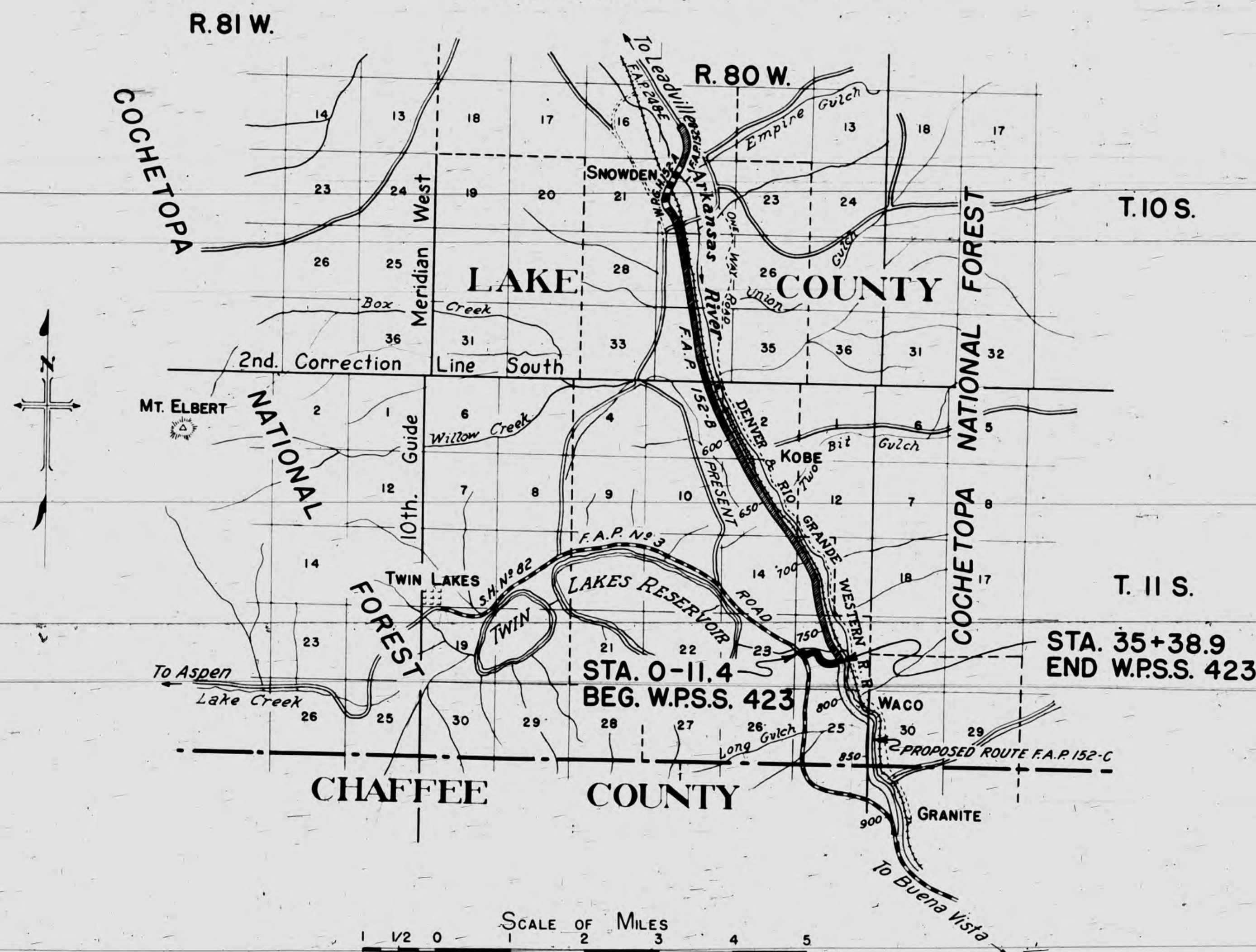

NOTE

It is recommended that bidders on this Project go over the plan details with one of the following field representatives of this department:

Ernest Montgomery Div. Engr. Colorado Springs  
E.W. Oviatt Res. Engr. Buena Vista

RECOMMENDED FOR APPROVAL 3/8/36

*E. H. Calver*  
ASSISTANT ENGINEER

APPROVED

*Chas. D. Hail*  
STATE HIGHWAY ENGINEER

RECOMMENDED FOR APPROVAL

DIST. ENG. BUREAU PUBLIC ROADS

RECOMMENDED FOR APPROVAL

CHIEF ENG. BUREAU PUBLIC ROADS

APPROVED

DIRECTOR BUREAU PUBLIC ROADS



FED. ROAD DIST. NO.	STATE	U.S.W.P.H. PROJ. NO.	SHEET NO.	TOTAL SHEETS
3	COLO.	W.R.S. 423	2	

Revised as constructed - 1-29-37 W.W.H.

# TYPICAL CROSS SECTION OF IMPROVEMENT AND SUMMARY OF QUANTITIES

## GENERAL NOTES

This Project is to be constructed in conformity with the Standard Specifications of the Colorado State Highway Department, adopted August 1, 1935.

All quantities on preliminary plans are to be considered approximate only.

All roadway excavation required to construct the Project is to be obtained as indicated on the plans. Quantities involved beyond the limits of the ditch as shown on the Typical Section, either noted on the Profile as "Borrow" or on Tabulation of Structures as "Embankment," are to be classified and paid for as "Unclassified Excavation."

These quantities are to be staked as part of the original excavation at locations indicated on the plans. Slope stakes, beyond the limits of the Typical Section as shown, are subject to change by the Engineer to fit Embankment requirements actually met in construction.

All curves are to be superelevated and widened as provided by the Standard Superelevation Sheet.

At all places on the Project where the new work lies along the present travelled road, the Contractor shall at his own expense, prosecute construction in such a manner that traffic may readily pass over the road. Also, the Contractor shall maintain in safe condition and at his own expense, all temporary approaches.

Except as noted on the plans, overhaul will be paid for as measured along center line of Project.

Clearing and Grubbing shall be of variable widths and be held to the minimum required for the construction of the road and channel changes and to accommodate visibility. Ordinarily the clearing shall not extend more than a feet beyond the toes of fills or the tops of cut banks.

## TYPICAL SECTION

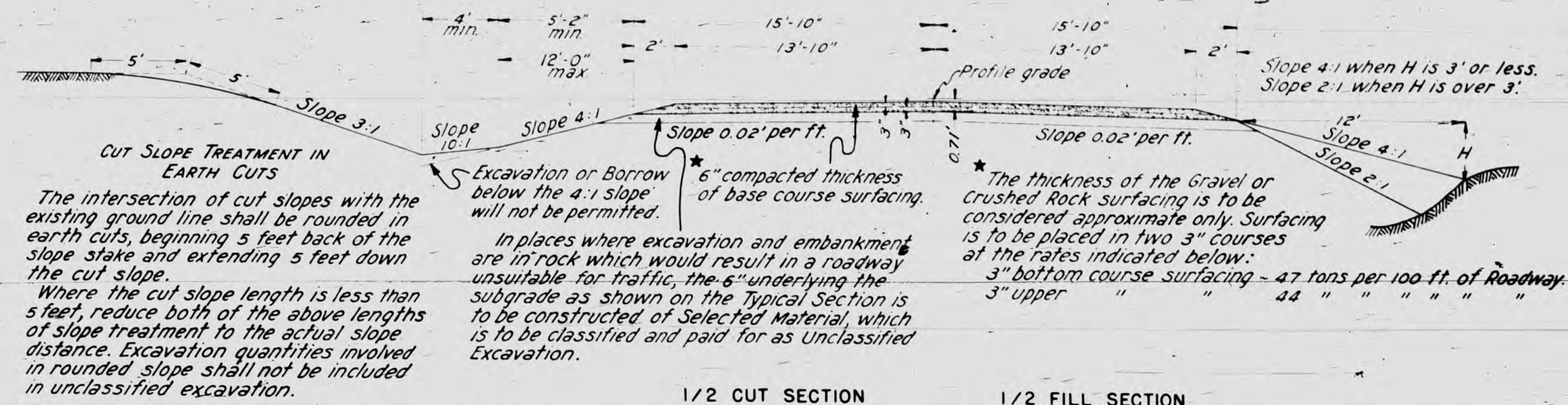

## TABULATION OF STRUCTURES

ACCOUNT OF STRUCTURES													
STATION	DESCRIPTION	EXCAVATION		STRUCTURAL EXCAV.				DRY RUBBLE	CORR. METAL CULV. PIPE				MISCELLANEOUS
		Cu. Yds.		Cu. Yds.				SLOPE PAVING (1 FT. THICK) Sq. Yd.	LIN. FT.				
		EXCAV.		COMMON	DRY	WET			18"	24"	36"		
0+00	Project Marker												
0+89	Extend C.M.P. Cross Culv. 16' Lt. & 24' Rt.			6.0				7.33			{ 16		1-Proj. Marker
6+00	Road Approach & Cattle Guard (16' Rdway) Rt.	181.3									{ 24		1-Cattle Guard
11+50	C.M.P. Cross Culvert			13.0				2.67	50				
14+60	" " " & Channel Change	2201.9		61.4				5.55			60		
16+05	" " " "			7.0	18.8			6.67			60		
17+50	" " " "			1.1				3.55		88			
21+08	" " " "			122					78				
24+00	" " " "			1.3				3.55	74				
30+23	" " " & Ditch change	302.4		18.0				2.33	70				
30+70	Road approach Rt.	223.0											
0-09- 1+85	WIRE CABLE GUARD FENCE: 194 lin. ft. on Left												
0-09- 0+89	98 " " " Right												
13+36-24+56	920 " " " Left												
16+32-18+00	168 " " " Right												
19+40-27+16.6	568 " " " "												
	TOTAL 1948 lin. ft.												
0-11-33+987	FENCING REQUIREMENTS: 3192 lin. ft. B.W. fence (Tr. Wood Posts) Lt.												
0-11-36+703	3308 lin. ft. B.W. Fence (Tr. Wood Posts) Rt.												
1+00	1-Barbed Wire Gate Rt.												
30+70	1-Driveway Gate Rt.												
30+55	1-Walk Gate Rt.												
6+00	1-Barbed wire gate Rt.												
	FORCE ACCOUNT: Remove 3 Buildings, Sta. 30+ Move sawmill off ROW Rt. Sta. 30+												
	TOTALS	2908.6		1200	18.8			31.65	272	88	160		

## SUMMARY OF CONSTRUCTION QUANTITIES

No.	ITEM	UNIT	PROJECT TOTALS
10a	Clearing and Grubbing Entire Project	Lump Sum	
13c	Unclassified Excavation	Cu. Yd.	20,521.8
13d	Cut Slope Treatment	Mile	0.5
14b	Dry Common Excavation (Structural)	Cu. Yd.	120.0
14d	Wet Common " "	" "	18.8
18a	Station Yard Overhaul	Sta. Yd.	82,758.5
18b	Yard Mile Overhaul	Yd. Mile	295.7
25a	Gravel or Crushed Rock Surfacing	Ton	3054.1
33b	18" Corrugated Metal Culvert Pipe	Lin. Ft.	272.0
53c	24" " " " " "	" "	88
53e	36" " " " " "	" "	160
65	Dry Rubble Slope Paving, 1 ft. thick	Sq. Yd.	31.65
74	Wire Cable Guard Fence	Lin. Ft.	1,948.0
76a	Barbed Wire Fence With Treated Wood Posts	" "	6,500.0
76g	" " Gate	Each	2
76h	Driveway " "	" "	1
76i	Walk Gate	" "	1
81a	Project Marker	" "	1
82	Cattle Guard ~ 16 foot Roadway	" "	1
	FORCE ACCOUNT: Remove Sawmill from R.O.W. Sta. 30+ Rt. Removing 3 Buildings, Sta. 30+	Lump Sum	\$25.00
		" "	\$57.50



NOTE

Requirements for line fences and wire cable guard fence are shown on sheet No. 2.

Sta. 0+89  
36" x 48" CMP cross culvert in place  
Extend 16' left and 24' right. Also  
7.33 Sq Yds. Dry Rubble Slope Paving (12" Th)

N.W. 1/4 SEC. 24  
T. 11 S., R. 80 W.

FED. ROAD DIST. NO.	STATE	U.S.N.P.H. PROJ. NO.	SHEET NO.	TOTAL SHEETS
3	COLO.	W.P.S.S. 423	8	

Revised as Constructed 2-1-37 E.H.H.

Sta. 0+00  
Project marker.

$\Delta 63^{\circ}20' L$   
 $D 8^{\circ}$   
 $T 44.8'$   
 $L 791.2'$   
 $R 716.3'$

K.K. Placer Ditch

Sta. 11+50  
Req'd. 18" x 50' CMP cross culvert,  
and 267 Sq Yds. Dry Rubble Slope Paving  
(12" Thick)

STA. 0-11.4  
BEGINNING OF PROJECT  
W.P.S.S. 423

Sta. 6+00  
Req'd. 16' Cattle Guard RI and  
181.3 Cu Yds. Uncl. Excav. for  
Road Approach Rt.

S.W. 1/4 SEC. 24

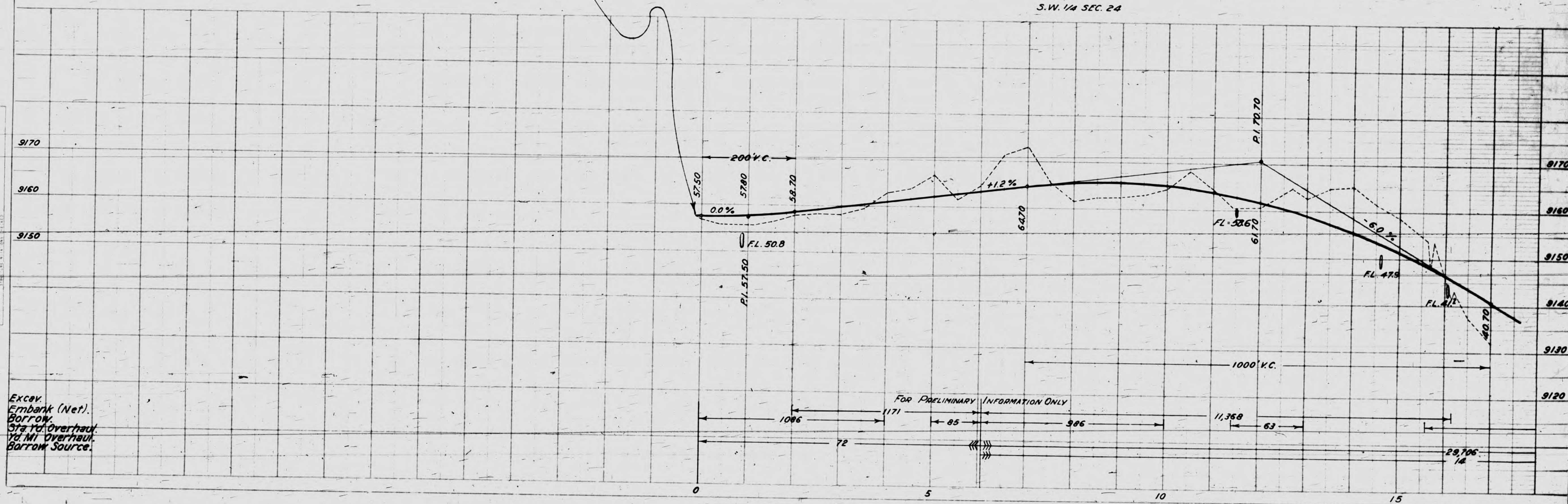



S.W. 1/4 SEC. 24  
T. 11 S., R. 80 W.

S.E. 1/4 SEC. 24

FED. ROAD DIST. NO.	STATE	U.S.W.P.H. PROJ. NO.	SHEET NO.	TOTAL SHEETS
3	COLO.	W.P.S.S. 423	9	

Revised as Constructed 2-1-37 E.H.J.

PLAN  
NOTE BOOK  
# 5737

PROFILE  
NOTE BOOK  
# 5737

